

LET'S CONNECT

We make it easy to connect with our experts and are ready to provide all the support you need. Just call your local support number or visit www.te.com/industrial to chat with a Product Information Specialist.

Technical Support

te.com/support-center

North America	+1 800 522 6752	Asia Pacific	+86 400 820 6015
North America (Toll)	+1 717 986 7777	Japan	+81 044 844 8180
EMEA/South Africa	+800 0440 5100	Australia	+61 2 9554 2695
EMEA (Toll)	+31 73 624 6999	New Zealand	+64 (0) 9 634 4580
India (Toll-Free)	+800 440 5100		

te.com/d-easy

AMP, AGASTAT, CII, DEUTSCH, HARTMAN, KILOVAC, MICRODOT, NANONICS, POLAMCO, Raychem, SEACON, TE, TE Connectivity and the TE connectivity (logo) are trademarks of the TE Connectivity Ltd. family of companies. Other products, logos, and company names mentioned herein may be trademarks of their respective owners.

While TE Connectivity (TE) has made every reasonable effort to ensure the accuracy of the information herein, nothing herein constitutes any guarantee that such information is error-free, or any other representation, warranty or guarantee that the information is accurate, correct, reliable or current. The TE entity issuing this publication reserves the right to make any adjustments to the information contained herein at any time without notice. All implied warranties regarding the information contained herein, including, but not limited to, any implied warranties of merchantability or fitness for a particular purpose are expressly disclaimed. The dimensions herein are for reference purposes only and are subject to change without notice. Specifications are subject to change without notice.

Consult TE for the latest dimensions and design specifications.

© 2016 TE Connectivity Ltd. family of companies All Rights Reserved.

1-1773870-6 03/17



DEUTSCH D-EASY Composite Feedthrough System

Modular Feedthrough Solutions for
Commercial and Military Aircraft

TABLE OF CONTENTS

Presentation	Page 3
Introduction	Page 4
Schematic	Page 5
Part Numbering System	Page 6
D-EASY 12 feedthrough configuration	Page 7
D-EASY 01 feedthrough configuration	Page 8
D-EASY 02 feedthrough configuration	Page 9
D-EASY 03 feedthrough configuration	Page 10 and 11
D-EASY 04 feedthrough configuration	Page 12 and 13
D-EASY 05 feedthrough configuration	Page 14
Sealing Plugs	Page 15
Grommets K	Page 15
Grommets M	Page 16
Grommets P	Page 17 and 18
Masses	Page 19
Equivalences	Page 20
Tooling	Page 21
Torque Values, Preparation and Spacement	Page 22
Quick Wiring Procedure	Page 23

DEUTSCH Modular Composite Feedthrough

D-EASY Fast and Flexible, Reliable and Modular Solution



The D-EASY modular composite feedthrough from TE Connectivity (TE) was designed as the composite evolution of two-part metallic feedthrough components. Saving installation time and reducing weight, the D-EASY modular feedthrough system is approved and standardized by leading aircraft manufacturers around the world for sealing electrical wires and harnesses systems.

More Choice

D-EASY feedthroughs are available in a variety of sizes and configurations to provide exceptional seal integrity in new and retrofit applications. The grommets can also be customized for new wiring configurations and retrofit applications.

Easy to Use

Featuring removable seal fittings for bundle and wire repairs in aerospace applications, D-EASY feedthroughs allow rework of the seal in situ, without wire removal, and are available with or without shielding protection and accessory interfaces.

FAST AND FLEXIBLE

- 96 times faster on final assembly line compared to the old potting version.
- Ability to add or remove cables
- Easy *in situ* installation and repair

RELIABLE

- Provides excellent seal integrity
- Repeatable sealing performance
- Reinforced fuel-resistant version available

MODULAR

- Wide range of housings, gland seals, grommets, and sealing plugs
- Choice of unshielded or shielded, with or without accessories
- Grommets for single and multi-wire harnesses and power feeders



TE Components . . . TE Technology . . . TE Know-how . . .

AMP | AGASTAT | CII | HARTMAN | KILOVAC | MICRODOT | NANONICS | POLAMCO | Raychem | Rochester | DEUTSCH
SEACON Phoenix | LL ROWE | Phoenix Optix | AFP | SEACON

Empower Engineers to Solve Problems, Moving the World Forward.

INTRODUCTION

A complete range of composite feedthrough configuration that is a fast, flexible and modular solution.



D-EASY 12



D-EASY 01



D-EASY 02



D-EASY 03



D-EASY 04

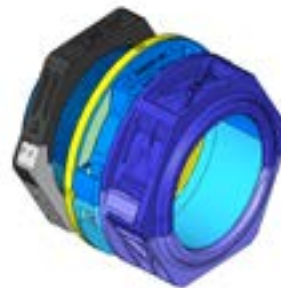

D-EASY 05

Specifications

MECHANICAL

- **Housing and Accessories:** Composite
- **Housing Metallization:** Nickel or non-metallized
- **Gasket:** Fluorosilicone
- **Gland Seal:** Fluorosilicone
- **Sealing Performance:** Leakage less than 1 l/min depending on bundle/cable type and/or grommet layout

ENVIRONMENTAL

- **Temperature Range:** -55°C to +105°C
- **Salt Spray Resistance:** 500 hours
- **Environmental Compliance:** ABS1571 and BACS31T/U
- **Reinforced Fuel Resistance:** Consult TE.

MASSES

Configuration (with Gland Seal)	D-EASY Version					
	12	01	02	03	04	05
Without Grommet	52 0.115	126 0.278	185 0.408	167 0.369	198 0.437	448 0.989
With Grommet	—	141 0.311	219 0.483	182 0.402	232 0.512	500 1.104

Masses: **grams** pounds

DIMENSIONS

	Housing External Ø	Panel Cutout Min. Ø	Panel Thickness	Bundle Diameter
D-EASY 12	43 1.690	24 to 24.3 0.945 to 0.957	2.0 to 10.0 0.079 to 0.390	2.0 to 12.0 0.079 to 0.474
D-EASY 01	64 2.520	38.41 to 39.57 1.512 to 1.558	2.0 to 19.3 0.079 to 0.760	2.0 to 22 0.079 to 0.866
D-EASY 02	79 3.110	57.02 to 58.30 2.245 to 2.295	2.0 to 19.3 0.079 to 0.760	15.0 to 35.0 0.059 to 1.378
D-EASY 03	64 2.520	38.40 to 38.70 1.512 to 1.524 Flat 37,5 to 37,8 Flat 1,476 to 1,488	2.0 to 8.0 0.079 to 0.315	2.0 to 22 0.079 to 0.866
D-EASY 04	79 3.110	57 to 57.30 2.244 to 2.256 Flat 55,5 to 55,8 Flat 2,185 to 2,197	2.0 to 8.0 0.079 to 0.315	15.0 to 35.0 0.590 to 1.378
D-EASY 05	101 3.980	75.44 to 76.97 2.970 to 3.030	2.54 to 19.3 0.100 to 0.760	26.4 to 45.7 1.039 to 1.800

Dimensions: **mm** inch

SCHEMATIC

SINGLE WIRE APPLICATIONS

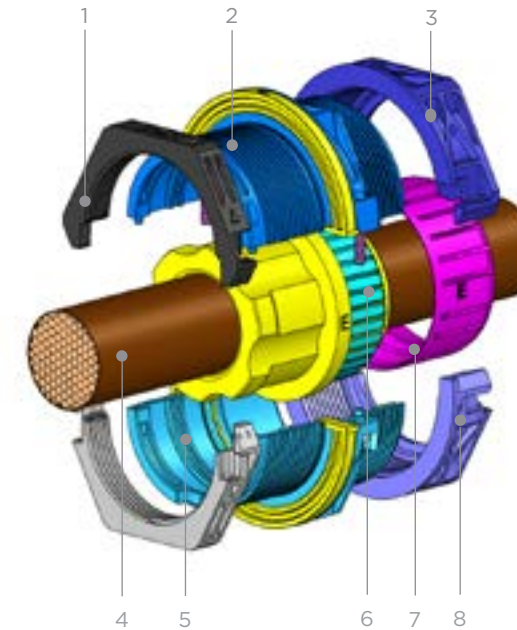

- 1 - Jam nut, half.
- 2 - Housing, half, upper.
- 3 - Compression nut, upper.
- 4 - Wire/cable.
- 5 - Housing, half, lower.
- 6 - Gland seal assembly.
- 7 - Bush.
- 8 - Compression nut, lower.

Order example:
Housing
D-EASY 05
+
Gland seal
054-8002-01 ()

MULTI WIRE OR MULTI BUNDLE APPLICATIONS

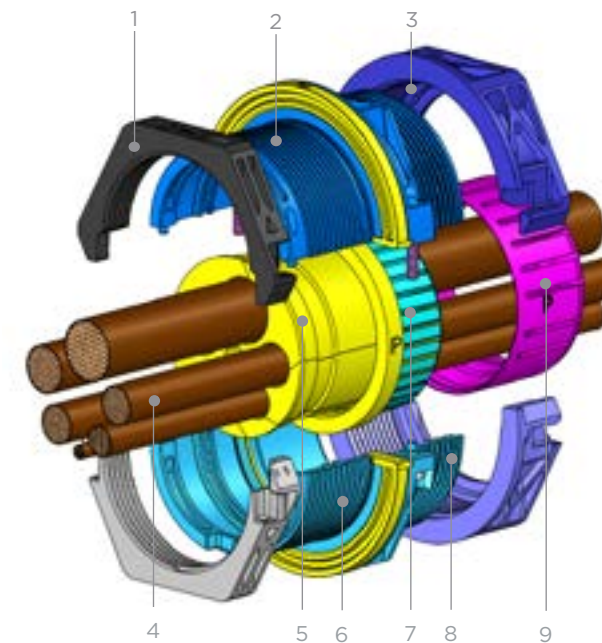

- 1 - Jam nut, half.
- 2 - Housing, half, upper.
- 3 - Compression nut, upper.
- 4 - Wire or mix bundles.
- 5 - Grommet.
- 6 - Housing, half, lower.
- 7 - Gland seal assembly.
- 8 - Compression nut, lower.
- 9 - Bush.

Order example:
Housing
D-EASY 05
+
Gland seal
054-8020-05
+
Grommet
054-8005-15

PART NUMBERING SYSTEM

FOR UNSHIELDED APPLICATIONS

Housing, gland seal, and optional grommet part numbers will be ordered separately.

Bundle Dia. (Max.) (Before Preparation)	Part No.			Panel	
	Housing	Gland Seal Kit	Optional Grommet	Thickness	Min. Curvature
12 0.424	D-EASY 12	D-EASY 12 S 05 D-EASY 12 S 12		2 to 10 0.079 to 0.394	2500 100
22 0.870	D-EASY 01	054-8000-00 054-8000-01	054-8003-xx (Type K)	2 to 19.3 0.079 to 0.760	
35 1.380	D-EASY 02	054-8001-00 054-8001-01	054-8004-xx (Type M)	2 to 19.3 0.079 to 0.760	
45.7 1.800	D-EASY 05	054-8002-00 054-8002-01	054-8005-xx (Type P)	2.54 to 19.3 0.100 to 0.760	

xx = Grommet see pages 15 - 18
Dimensions: **mm** inches

FOR SHIELDED APPLICATIONS

D-EASY supplied as a complete pressure seal system: gland seal and housing are supplied under a single part number. Consult TE for use of optional grommets.

Bundle Dia. (Max.) (Before Preparation)	Part No.	Panel Thickness
12 0.474	D-EASY 03 A xx	2 to 10 0.073 to 0.294
22 0.87	D-EASY 03 B xx	
27 1.08	D-EASY 04 C xx	
35 1.38	D-EASY 04 D xx	

xx = Configuration code see pages 11 - 13
Dimensions: **mm** inches

D-EASY 12 FEEDTHROUGH CONFIGURATION

HOUSING AND SEALING SYSTEM

D-EASY 12 HOUSING WITHOUT SEALING SYSTEM

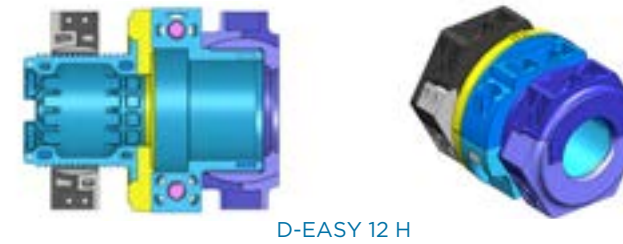

D-EASY 12 H

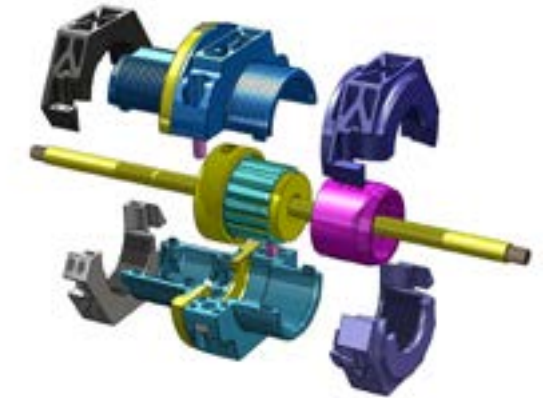

D-EASY 12 HOUSING WITH SEALING SYSTEM

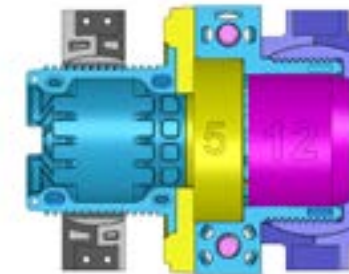

D-EASY 12 H 05

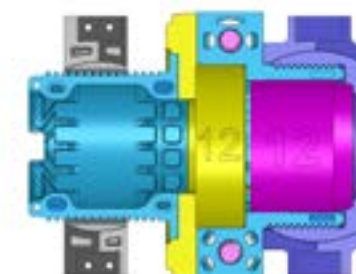

D-EASY 12 H 12

GLAND SEAL FOR WIRE HARNESS

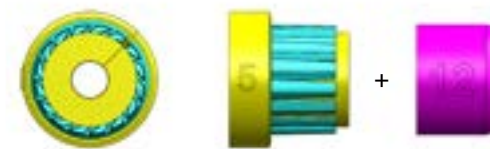

D-EASY 12 S 05
Bundle dimensions Ø 5mm max.
(Ø 0.197 inch max.) before preparation.

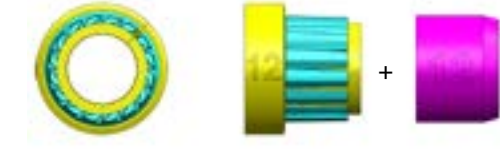

D-EASY 12 S 12
Bundle dimensions Ø 12mm max.
(Ø 0.474 inch max.) before preparation.

MAINTENANCE



JAM NUT KIT
D-EASY 12 J

GLAND NUT KIT
D-EASY 12 G

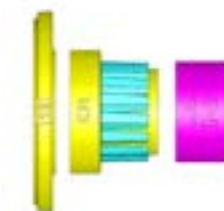

GLAND SEAL KIT
D-EASY 12 S 05 R



GLAND SEAL KIT
D-EASY 12 S 12 R

D-EASY 01 FEEDTHROUGH CONFIGURATION

HOUSING DELIVERED WITHOUT SEAL SYSTEM



D-EASY 01

GLAND SEAL FOR SINGLE HARNESS



054-8000-00
Ø 12mm max. (Ø 0.474 inch max.)
before preparation



054-8000-01
Ø 22mm max. (Ø 0.87 inch max.)
before preparation

GLAND SEAL FOR GROMMET

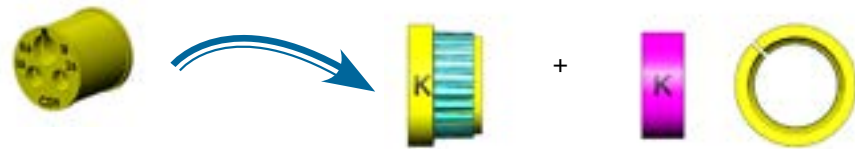

See grommets details on page 15

054-8020-01

MAINTENANCE



GLAND SEAL KIT 054-0032-12 JAM NUT KIT 054-8015-03 GLAND NUT KIT TIE RAP 054-8016-03



GLAND NUT KIT 054-8018-03 SHOULDERED JAM NUT ALUMINUM ALLOY 054-8017-03 SHOULDERED JAM NUT COMPOSITE 054-8062-03

D-EASY 02 FEEDTHROUGH CONFIGURATION

HOUSING DELIVERED WITHOUT SEAL SYSTEM

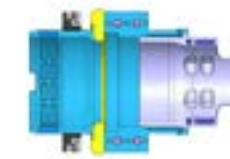

D-EASY 02

GLAND SEAL FOR SINGLE HARNESS

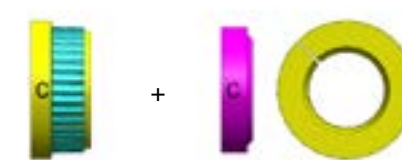

054-8001-00
Ø 27mm max. (Ø 1.08 inch max.)
before preparation



054-8001-01
Ø 35mm max. (Ø 1.38 inch max.)
before preparation

GLAND SEAL FOR GROMMET

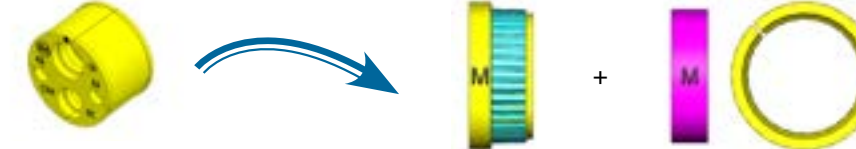

See grommets details on page 16

054-8020-02

MAINTENANCE



GLAND SEAL KIT 054-0032-27 JAM NUT KIT 054-8015-04 GLAND NUT KIT TIE RAP 054-8016-04



GLAND NUT KIT 054-8018-04* SHOULDERED JAM NUT ALUMINUM ALLOY 054-8017-04 SHOULDERED JAM NUT COMPOSITE 054-8062-04

*Consult TE

HOUSING DELIVERED WITH SEAL SYSTEM



Example D-EASY 03 A 03

GLAND SEAL FOR SINGLE HARNESS



054-8000-00
Ø 12mm max. (Ø 0.474 inch max.)
before preparation

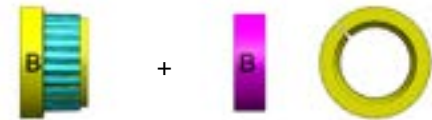

054-8000-01
Ø 22mm max. (Ø 0.87 inch max.)
before preparation

GLAND SEAL FOR GROMMET

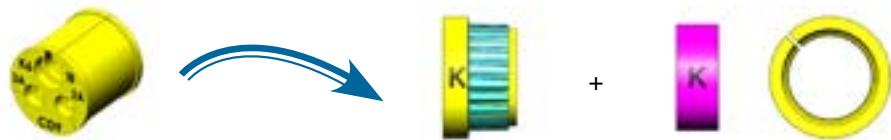

See grommets details on page 15

054-8020-01

MAINTENANCE



GLAND SEAL KIT
054-0032-12 054-0032-22

JAM NUT KIT
054-8015-03

GLAND NUT KIT TIE RAP
054-8016-03

CAP
054-0018-20

CAP
054-0018-28



GLAND NUT KIT
054-8018-03

SHOULDERED JAM NUT
ALUMINUM ALLOY
054-8017-03

SHOULDERED JAM NUT
COMPOSITE
054-8062-03

GLAND SEAL FOR SINGLE HARNESS

GLAND SEAL
A

GLAND SEAL
B

D-EASY 03 A



D-EASY 03 B

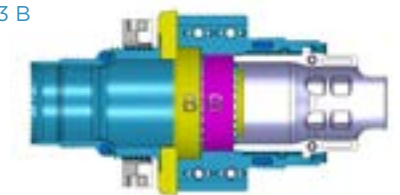

D-EASY 03 A 01

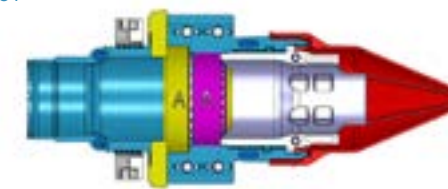

D-EASY 03 B 01

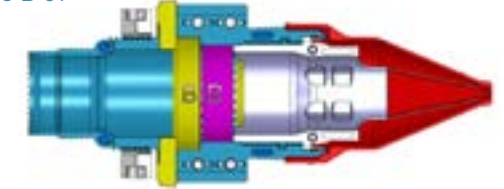

D-EASY 03 A 02

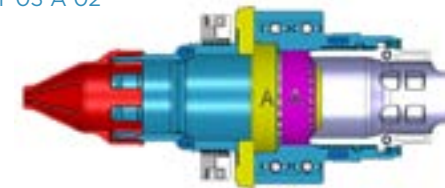

D-EASY 03 B 02

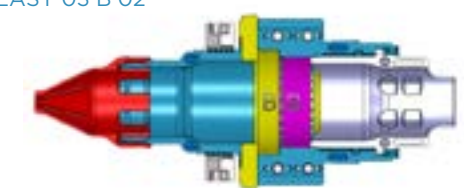

D-EASY 03 A 03

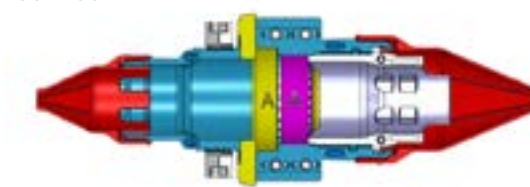

D-EASY 03 B 03

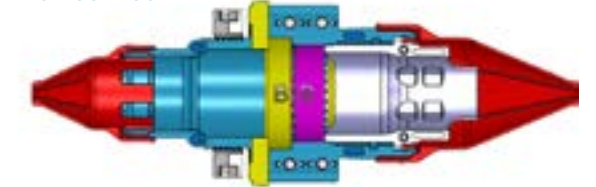

D-EASY 03 A 05

Gland nut without tab.

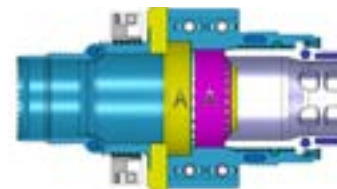

D-EASY 03 B 05

Gland nut without tab.



Others configurations, consult TE.

HOUSING DELIVERED WITH SEAL SYSTEM

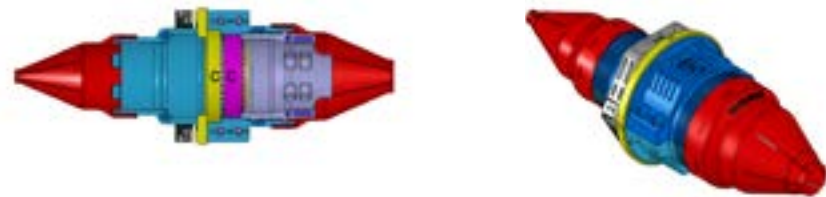

Example D-EASY 04 C 03

GLAND SEAL FOR SINGLE HARNESS

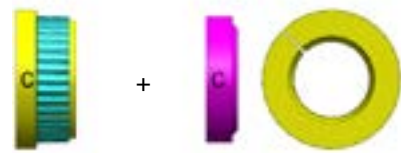

054-8001-00
Ø 27mm max. (Ø 1.08 inch max.)
before preparation

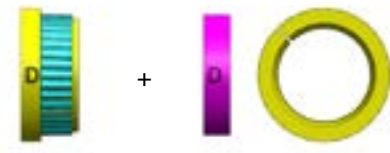

054-8001-01
Ø 35mm max. (Ø 1.38 inch max.)
before preparation

GLAND SEAL FOR GROMMET

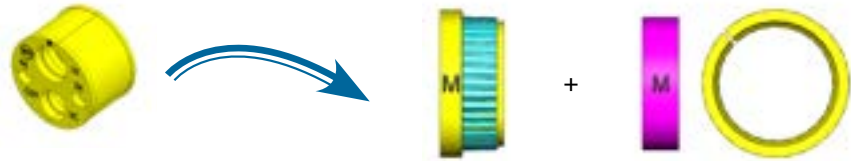

054-8020-02

See grommets details on page 16

MAINTENANCE



GLAND SEAL KIT 054-0032-27 GLAND SEAL KIT 054-0032-35 JAM NUT KIT 054-8015-04 GLAND NUT KIT TIE RAP 054-8016-04 CAP 054-8018-28 CAP 054-8018-36



GLAND NUT KIT 054-8018-04* SHOULDERED JAM NUT ALUMINUM ALLOY 054-8017-04 SHOULDERED JAM NUT COMPOSITE 054-8062-04

*Consult TE

GLAND SEAL FOR SINGLE HARNESS

GLAND SEAL C

GLAND SEAL D

D-EASY 04 C

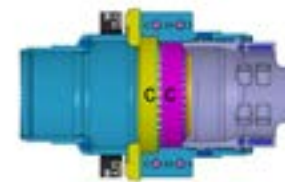

D-EASY 04 D

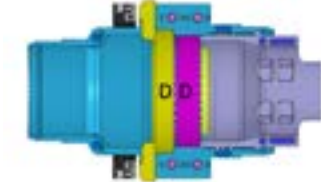

D-EASY 04 C 01

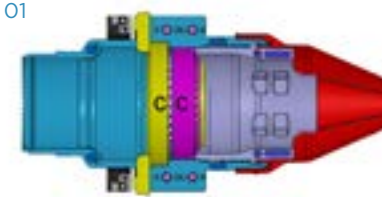

D-EASY 04 D 01

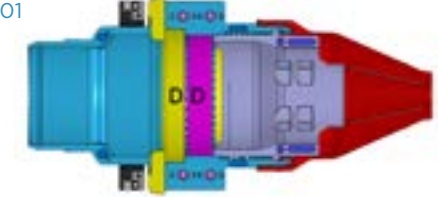

D-EASY 04 C 02



D-EASY 04 D 02



D-EASY 04 C 03

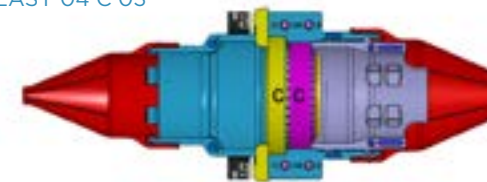

D-EASY 04 D 03

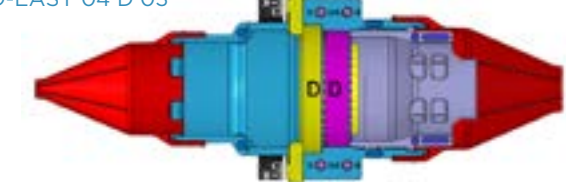

D-EASY 04 C 05

Consult TE for gland nut without tab.

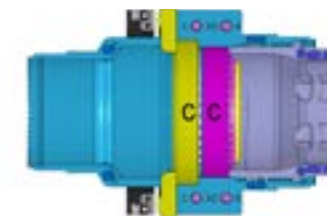

D-EASY 04 D 05

Consult TE for gland nut without tab.

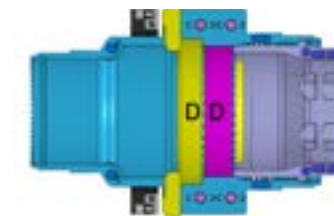

Others configurations, consult TE.

D-EASY 05 FEEDTHROUGH CONFIGURATION

HOUSING DELIVERED WITHOUT SEAL SYSTEM

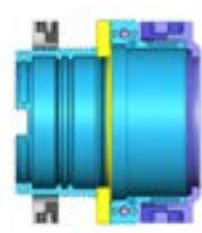

D-EASY 05



GLAND SEAL FOR SINGLE HARNESS



054-8002-00
Ø 37 mm max. (Ø 1.45 inch max.)
before preparation

054-8002-01
Ø 45,70 mm max. (Ø 1.8 inch max.)
before preparation

GLAND SEAL FOR GROMMET



054-8020-05

See grommets details on page 17

MAINTENANCE

Consult TE.

SEALING PLUGS AND GROMMETS K

SEALING PLUGS



054-0053-01



054-0053-02



054-0053-03



054-0053-04



054-0053-05



054-0053-06

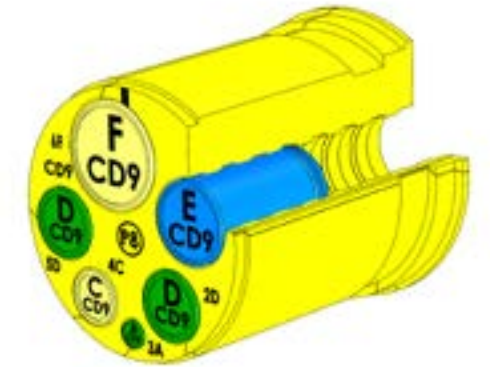

APPLICABLE D-EASY 01 & D-EASY 03 GROMMETS TYPE K



Isometric view

Others grommets, consult TE.



054-8003-01



054-8003-02



054-8003-03



054-8003-04



054-8003-05



054-8003-06



054-8003-07



054-8003-10

K GROMMETS FOR DISCRETE WIRE

Grommet	No. of Wires	Wire Diameter
K1	1	15.2 to 16.2 0.599 to 0.639
K2	2	8.0 to 9.6 0.315 to 0.378
K3	1	12.4 to 13.5 0.490 to 0.530
K4	1	9.0 to 9.6 0.356 to 0.378
K5	1	12.3 to 13.1 0.485 to 0.515
K7	2	8.0 to 9.0 0.314 to 0.354
K10	1	12.6 to 13.5 0.497 to 0.531

Dimensions: mm inches

K GROMMETS FOR WIRE BUNDLES

Grommet	No. of Bundles	Bundle Diameter (After Preparation)
K6	1 (Size B)	7.9 to 9.5 0.310 to 0.375
	2 (Size A)	4.7 to 6.35 0.185 to 0.250

GROMMETS M

APPLICABLE D-EASY O2 & D-EASY O4 GROMMETS TYPE M

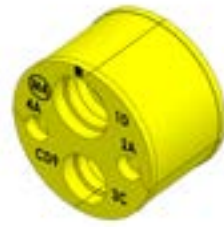

Isometric view

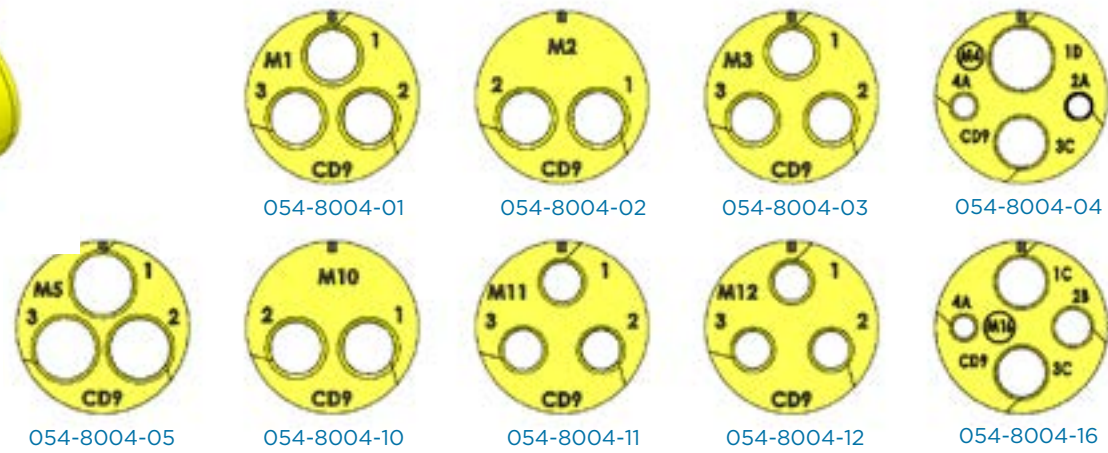

Others grommets, consult TE.

M GROMMETS FOR DISCRETE WIRE

Grommet	No. of Wires	Wire Diameter
M1	3	12.7 to 14.0 0.501 to 0.553
M2	2	12.4 to 13.5 0.490 to 0.530
M3	3	11.1 to 12.4 0.437 to 0.487
M5	3	13.7 to 15.0 0.540 to 0.590
M10	2	11.9 to 12.7 0.469 to 0.501
M11	3	9.9 to 10.7 0.389 to 0.421
M12	3	9.0 to 9.9 0.355 to 0.390

Dimensions: **mm** inches

M GROMMETS FOR WIRE BUNDLES

Grommet	No. of Bundles	Bundle Diameter (After Preparation)
M4	1 (Size C)	11.0 to 12.7 0.435 to 0.500
	1 (Size D)	14.2 to 15.8 0.560 to 0.625
	2 (Size A)	4.7 to 6.35 0.185 to 0.250
M16	1 (Size A)	4.7 to 6.35 0.185 to 0.250
	1 (Size B)	7.9 to 9.5 0.310 to 0.375
	2 (Size C)	11.0 to 12.7 0.435 to 0.500

GROMMETS P

APPLICABLE D-EASY O5 GROMMETS TYPE P

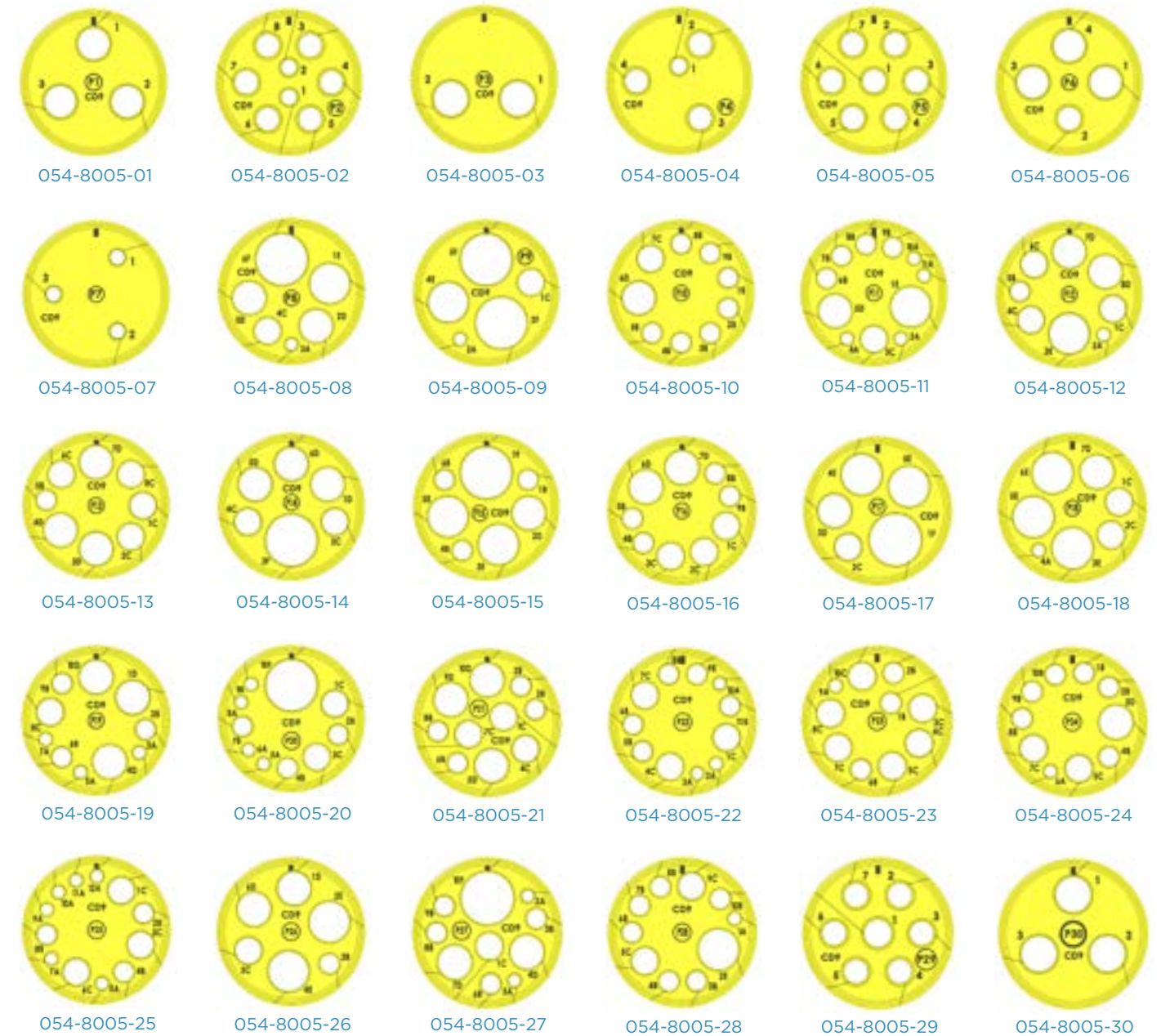

For dimension of harness before and after preparation, see chart page 22

Others grommets, consult TE.

GROMMETS P

P GROMMETS FOR DISCRETE WIRE

Grommet	No. of Wires	Wire Diameter
P1	3	14.1 - 15.7 / 0.556 - 0.620
P2	2	8.0 - 9.0 / 0.314 - 0.354
	6	11.1 - 12.4 / 0.437 - 0.487
P3	2	15.2 - 16.2 / 0.599 - 0.639
P4	1	8.0 - 9.0 / 0.314 - 0.354
	3	11.1 - 12.4 / 0.437 - 0.487
P5	7	11.1 - 12.4 / 0.437 - 0.487
P6	1	11.0 - 11.8 / 0.435 - 0.465
	3	13.7 - 15.0 / 0.540 - 0.590
P7	3	7.32 - 7.82 / 0.288 - 0.308
P29	1	12.7 - 14.0 / 0.500 - 0.550
	6	11.1 - 12.4 / 0.437 - 0.487
P30	3	15.3 - 17.0 / 0.604 - 0.670

P GROMMETS FOR WIRE BUNDLES

Grommet	Bundle Size Diameter (After Preparation)/Number of Bundles					
	Size A 4.7 - 6.35 0.185 - 0.250	Size B 7.9 - 9.5 0.310 - 0.375	Size C 11.0 - 12.7 0.435 - 0.500	Size D 14.2 - 15.8 0.560 - 0.625	Size E 17.4 - 19.0 0.685 - 0.750	Size F 22.5 - 24.0 0.885 - 0.950
P8	1		1	2	1	1
P9	1		1		1	2
P10		7	1	1		
P11	4	4	1	1	1	
P12	1	1	3	2	1	
P13		1	4	3		
P14			2	3		1
P15		3		1	2	1
P16		4	3	2		
P17			1	1	2	1
P18	1		2	1	3	
P19	3	3	1	3		
P20	4	3	2			1
P21		4	3	3		
P22	3	5	3			
P23	1	3	6			
P24	1	6	2	1		
P25	6	3	3			
P26		1	1	2	2	
P27	2	4	1	2		1
P28	1	6	2		1	

Dimensions: mm inches

MASSES

Reference	Mass (g)	Mass (lbs)	Reference	Mass (g)	Mass (lbs)	Reference	Mass (g)	Mass (lbs)
D-EASY 01	110	0.243	054-0032-12	32	0.071	054-8005-09	171	0.377
D-EASY 02	150	0.331	054-0032-22	22	0.049	054-8005-10	200	0.441
D-EASY 03 A	177	0.390	054-0032-27	50	0.110	054-8005-11	191	0.421
D-EASY 03 A 01	190	0.419	054-0032-35	35	0.077	054-8005-12	181	0.399
D-EASY 03 A 02	183	0.403	054-0053-01	1	0.002	054-8005-13	175	0.386
D-EASY 03 A 03	196	0.432	054-0053-02	2	0.004	054-8005-14	172	0.379
D-EASY 03 A 05	175	0.386	054-0053-03	4	0.009	054-8005-15	161	0.355
D-EASY 03 B	167	0.368	054-0053-04	6	0.013	054-8005-16	184	0.406
D-EASY 03 B 01	180	0.397	054-0053-05	8	0.018	054-8005-17	170	0.375
D-EASY 03 B 02	173	0.381	054-0053-06	12	0.026	054-8005-19	189	0.417
D-EASY 03 B 03	186	0.410	054-8000-00	27	0.060	054-8005-20	175	0.386
D-EASY 03 B 05	165	0.364	054-8000-01	16	0.035	054-8005-21	173	0.381
D-EASY 04 C	213	0.470	054-8001-00	44	0.097	054-8005-22	192	0.423
D-EASY 04 C 01	230	0.507	054-8001-01	35	0.077	054-8005-23	166	0.366
D-EASY 04 C 02	226	0.498	054-8002-00	274	0.604	054-8005-23	184	0.406
D-EASY 04 C 03	243	0.536	054-8002-01	204	0.450	054-8005-24	185	0.408
D-EASY 04 C 05	210	0.463	054-8003-01	12	0.026	054-8005-25	194	0.428
D-EASY 04 D	198	0.437	054-8003-02	17	0.037	054-8005-26	177	0.390
D-EASY 04 D 01	215	0.474	054-8003-03	15	0.033	054-8005-27	164	0.362
D-EASY 04 D 02	211	0.465	054-8003-04	18	0.040	054-8005-28	177	0.390
D-EASY 04 D 03	228	0.503	054-8003-05	15	0.033	054-8005-29	210	0.463
D-EASY 04 D 05	195	0.430	054-8003-06	16	0.035	054-8005-30	207	0.456
D-EASY 05	244	0.538	054-8003-07	18	0.040	054-8014-20	40	0.088
D-EASY 05 L 01	266	0.586	054-8004-01	32	0.071	054-8015-03	13	0.029
D-EASY 12 G	10	0.022	054-8004-02	37	0.082	054-8015-04	15	0.033
D-EASY 12 H	44	0.097	054-8004-03	35	0.077	054-8017-03	45	0.099
D-EASY 12 H 05	56	0.123	054-8004-04	34	0.075	054-8017-04	53	0.117
D-EASY 12 H 12	52	0.115	054-8004-05	29	0.064	054-8018-03	17	0.037
D-EASY 12 J	8	0.018	054-8005-01	206	0.454	054-8018-04	27	0.060
D-EASY 12 S 05	12	0.026	054-8005-02	208	0.459	054-8020-01	14	0.031
D-EASY 12 S 05 R	13	0.029	054-8005-03	209	0.461	054-8020-02	21	0.046
D-EASY 12 S 12	8	0.018	054-8005-04	221	0.487	054-8020-05	77	0.170
D-EASY 12 S 12 R	9	0.020	054-8005-05	209	0.461	054-8061-29	247	0.545
054-0018-20	6	0.013	054-8005-06	208	0.459	054-8062-03	20	0.044
054-0018-28	13	0.029	054-8005-07	222	0.489	054-8062-04	23	0.051
054-0018-36	17	0.037	054-8005-08	172	0.379			

EQUIVALENCES

ABS1571 TO TE PART NUMBER CROSS REFERENCE

ABS1571	TE
ABS1571-01A	D-EASY 03 A
ABS1571-01A01	D-EASY 03 A 01
ABS1571-01A02	D-EASY 03 A 02
ABS1571-01A03	D-EASY 03 A 03
ABS1571-01A05	D-EASY 03 A 05
ABS1571-01B	D-EASY 03 B
ABS1571-01B01	D-EASY 03 B 01
ABS1571-01B02	D-EASY 03 B 02
ABS1571-01B03	D-EASY 03 B 03
ABS1571-01B05	D-EASY 03 B 05
ABS1571-02C	D-EASY 04 C
ABS1571-02C01	D-EASY 04 C 01

ABS1571	TE
ABS1571-02C02	D-EASY 04 C 02
ABS1571-02C03	D-EASY 04 C 03
ABS1571-02C05	D-EASY 04 C 05
ABS1571-02D	D-EASY 04 D
ABS1571-02D01	D-EASY 04 D 01
ABS1571-02D02	D-EASY 04 D 02
ABS1571-02D03	D-EASY 04 D 03
ABS1571-02D05	D-EASY 04 D 05
ABS1571-20-24	054-8014-20
ABS1571-20	054-0018-20
ABS1571-28	054-0018-28
ABS1571-36	054-0018-36

ABS1571	TE
ABS1571A	054-0032-12
ABS1571B	054-0032-22
ABS1571C	054-0032-27
ABS1571D	054-0032-35
ABS1571G03	054-8018-03
ABS1571G04	054-8018-04
ABS1571N01	054-8015-03
ABS1571N02	054-8015-04
ABS1571-N03	054-8017-03
ABS1571-N04	054-8017-04
ABS1571-N05	054-8062-03
ABS1571-N06	054-8062-04

BACS31 TO TE PART NUMBER CROSS REFERENCE

BACS31	TE
BACS31T24H	D-EASY 01
BACS31T36H	D-EASY 02
BACS31T48H	D-EASY 05
BACS31T48H1*	D-EASY 05 L 01*
BACS31U24GA	054-8000-00
BACS31U24GB	054-8000-01
BACS31U24GK	054-8020-01
BACS31U24SK1	054-8003-01
BACS31U24SK2	054-8003-02
BACS31U24SK3	054-8003-03
BACS31U24SK4	054-8003-04
BACS31U24SK5	054-8003-05
BACS31U24SK6	054-8003-06
BACS31U24SK7	054-8003-07
BACS31U36GC	054-8001-00
BACS31U36GD	054-8001-01
BACS31U36GM	054-8020-02
BACS31U36SM1	054-8004-01
BACS31U36SM2	054-8004-02
BACS31U36SM3	054-8004-03
BACS31U36SM4	054-8004-04

BACS31	TE
BACS31U36SM5	054-8004-05
BACS31U48GE1	054-8002-00
BACS31U48GF1	054-8002-01
BACS31U48GP1	054-8020-05
BACS31U48SP1	054-8005-01
BACS31U48SP2	054-8005-02
BACS31U48SP3	054-8005-03
BACS31U48SP4	054-8005-04
BACS31U48SP5	054-8005-05
BACS31U48SP6	054-8005-06
BACS31U48SP7	054-8005-07
BACS31U48SP8	054-8005-08
BACS31U48SP9	054-8005-09
BACS31U48SP10	054-8005-10
BACS31U48SP11	054-8005-11
BACS31U48SP12	054-8005-12
BACS31U48SP13	054-8005-13
BACS31U48SP14	054-8005-14
BACS31U48SP15	054-8005-15
BACS31U48SP16	054-8005-16
BACS31U48SP17	054-8005-17

BACS31	TE
BACS31U48SP18	054-8005-18
BACS31U48SP19	054-8005-19
BACS31U48SP20	054-8005-20
BACS31U48SP21	054-8005-21
BACS31U48SP22	054-8005-22
BACS31U48SP23	054-8005-23
BACS31U48SP24	054-8005-24
BACS31U48SP25	054-8005-25
BACS31U48SP26	054-8005-26
BACS31U48SP27	054-8005-27
BACS31U48SP28	054-8005-28
BACS31U48SP29	054-8005-29
BACS31U48SP30	054-8005-30
BACS31U48ST29	054-8061-29
BACS31UP1	054-0053-01
BACS31UP2	054-0053-02
BACS31UP3	054-0053-03
BACS31UP4	054-0053-04
BACS31UP5	054-0053-05
BACS31UP6	054-0053-06

*For panels up to 32 mm (1.250) thick.

Consult TE for additional cross reference information.

TOOLING



Rotation retainer tool



Compression strap wrench (2 sizes)



Crowfoot wrench

Description	D-EASY Size	Tools size	Part number tools	Suppliers
Wrench, Allen (housing hardwares)	12	7/64	Standard	Free source
	01 / 03	7/64		
	02 / 04	7/64		
	05	9/64		
	12	1-7/16		
Rotation retainer tool (for housing flats)	01	1-13/16	Fork wrench	Free source
	02	2-3/8	Fork wrench	Free source
	03	1-13/16 and	Fork wrench	Free source
	04	2-3/8	057-0898-00	TE or Free source
	05	3-1/2	057-0929-05	TE or Free source
Crowfoot wrench, Gland nut	12	1-7/16	AN850823B	Free source
	01 / 03	1-1/8	057-0901-03	TE
	02 / 04	1-5/8	057-0902-04	TE
	05	3-1/2	057-0919-05	TE or Free source
	12	1-7/16	AN850823B	Free source
Crowfoot wrench Jam nut	01 / 03	2"	AN850832B	Free source
	02 / 04	2-5/8	AN850842B	Free source
	05	3-1/2	057-0919-05	TE or Free source
	12	-	057-0750-00	TE
	01 / 02	-		
Compression strap wrench	03 / 04	-	or	
	05	-		
	05*	-	057-0750-05*	

*If bundle diameter > Ø 37mm (Ø 1.45 inch) before preparation.

CONSUMABLES

Designation	Part number	Suppliers	DEUTSCH Proposal part number
Tape, Sealant	5313 dimension 1 x 8 mm	Free source	609-0031-XX * Consult TE
Tape, Silicone	67N	Free source	609-0032-XX * Consult TE
Metallic clamping strip	According to ASNE0805 - Free source		
Tie-rap	According to NSA935401-05 - Free source		

* XX = Number of coils in order.

TORQUE VALUES

	Panel Nuts		Gland Nuts		Housing Screws	
	N.m	Ft.lbf	N.m	Ft.lbf	N.m	In.lbf
D-EASY 12	6	4.4	8	5.9	2	18
D-EASY 01	20	14.8	20	14.8	2	18
D-EASY 02	25	18.5	25	18.5	2	18
D-EASY 03	20	14.8	20	14.8	2	18
D-EASY 04	25	18.5	25	18.5	2	18
D-EASY 05	30	22.1	30	22.1	4	35

TORQUE VALUES FOR CONFORMING TOOLS

Size	N.m	Ft.lbf
057-0750-00	4	3
057-0750-05	8	6

PREPARED BUNDLE DIAMETER IN GROMMET

After Preparation (Tape Overlapping)

Cavity Marking	Bundle Diameter Ø	
	Min.	Max.
A	4.7 0.185	6.35 0.250
B	7.9 0.310	9.50 0.375
C	11 0.435	12.70 0.500
D	14.2 0.560	15.80 0.625
E	17.4 0.685	19.00 0.750
F	22.5 0.885	24.00 0.950

PREPARED BUNDLE DIAMETER IN GLAND SEAL

After Preparation (Tape Overlapping)

Gland Seal	Bundle Diameter Ø	
	Min.	Max.
5	5 0.197	7 0.276
12	12 0.472	14 0.551
A	12 0.472	14 0.551
B	22 0.866	24 0.945
C	27 1.063	29 1.142
D	35 1.378	37 1.457
E	37 1.457	39 1.535
F	46 1.811	48.5 1.909

RECOMMENDED MINIMUM SPACING BETWEEN D-EASY FEEDTHROUGHS

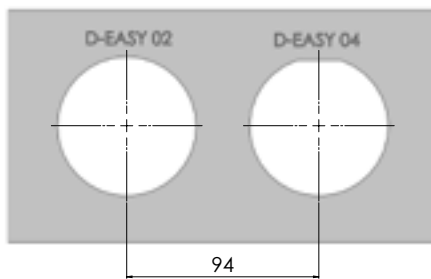

	D-EASY 12	D-EASY 01	D-EASY 02	D-EASY 03	D-EASY 04	D-EASY 05
D-EASY 12	57 2.244	68 2.677	76 2.992	68 2.677	76 2.992	96 3.780
D-EASY 01	68 2.677	77 3.031	86 3.386	77 3.031	86 3.386	107 4.213
D-EASY 02	76 2.992	86 3.386	94 3.701	86 3.386	94 3.701	115 4.528
D-EASY 03	68 2.677	77 3.031	86 3.386	77 3.031	86 3.386	107 4.213
D-EASY 04	76 2.992	86 3.386	94 3.701	86 3.386	94 3.701	115 4.528
D-EASY 05	96 3.780	107 4.213	115 4.528	107 4.213	115 4.528	125 4.921

STEP 1:

Lays wires and cables on sealant.

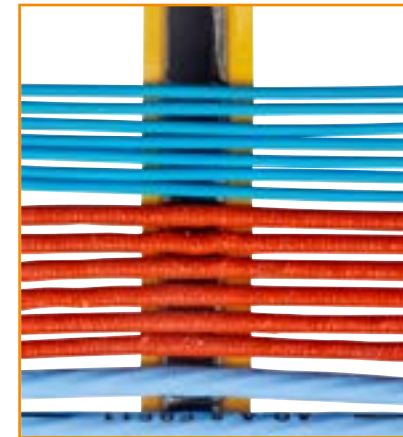

STEP 2:

Form wire bundle with sealant into multi layer.

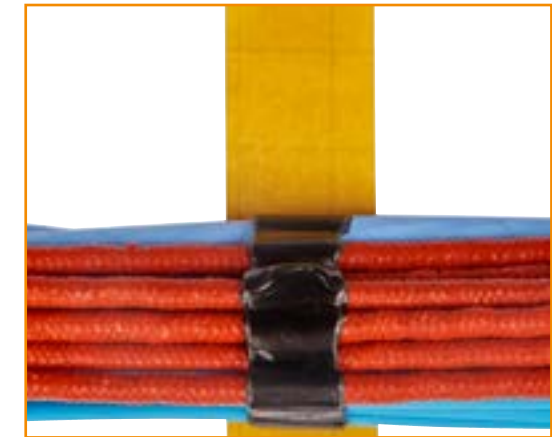

STEP 3:

Wrap wire bundle with self amalgamating tape.



STEP 4:

Compress wire bundle with dedicated compression tool.



STEP 5:

Put into the housing the bundle with sealing system.

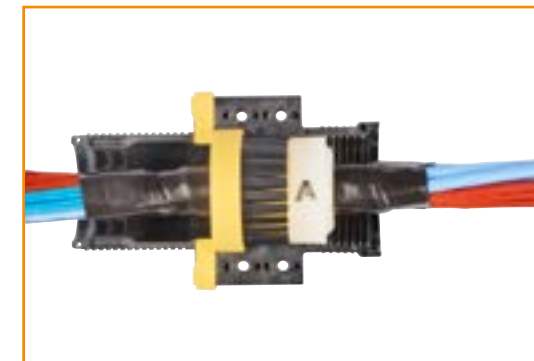

STEP 6:

Close and tighten the nuts.



Consult TE for the D-EASY wiring procedure