

Datasheet

JIS Standard Duplex Thermocouple Connector Plugs

Types K, J, T, E, R/S & B
(JIS Colour Code)

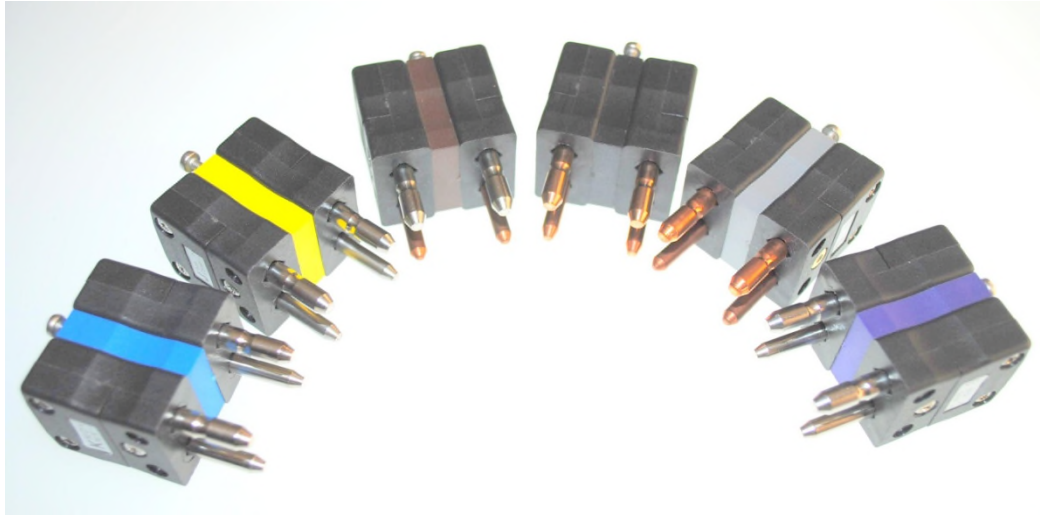

- Duplex (2-channel) standard connector with solid, round plug pins
- Bodies supplied coloured black with spacer in JIS colour coding
- Plugs fitted with solid thermocouple pins
- Rugged glass filled polyester bodies
- Suitable for industrial applications
- Contacts are polarised to prevent incorrect connection
- Available in Thermocouple Types K, J, T, E, R/S & B
- For Types K, J, T & E contacts are made from true Thermocouple alloys
- R/S type has compensating copper/copper nickel alloy contacts (for R or S Type Thermocouples)
- B type has compensating copper/copper contacts (for B Type Thermocouples)
- Colour coded in accordance with JIS specification
- Maximum continuous operating temperature 220°C

T/C Type	Colour Code (JIS)	+Positive Contact (alloy type)	-Negative Contact (alloy type)	Manufacturing Reference	Allied Code	RS order Code
K	Blue	+Nickel Chromium	-Nickel Alloy	JS-K-MD	70652402	771-9076
J	Yellow	+Iron	-Copper Nickel	JS-J-MD	70652400	771-9067
T	Brown	+Copper	-Copper Nickel	JS-T-MD	70652401	771-9073
E	Violet	+Nickel Chromium	-Copper Nickel	JS-E-MD	70652399	771-9063
R/S	Black	+Copper	-Copper Alloy	JS-R/S-MD	70652403	771-9079
B	Grey	+Copper	-Copper	JS-B-MD	70652398	771-9060

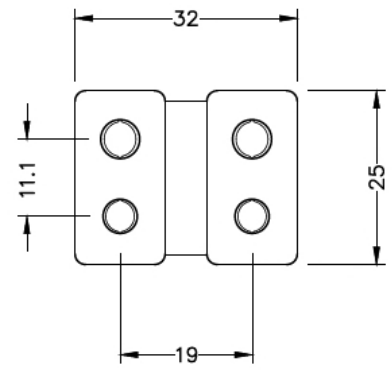
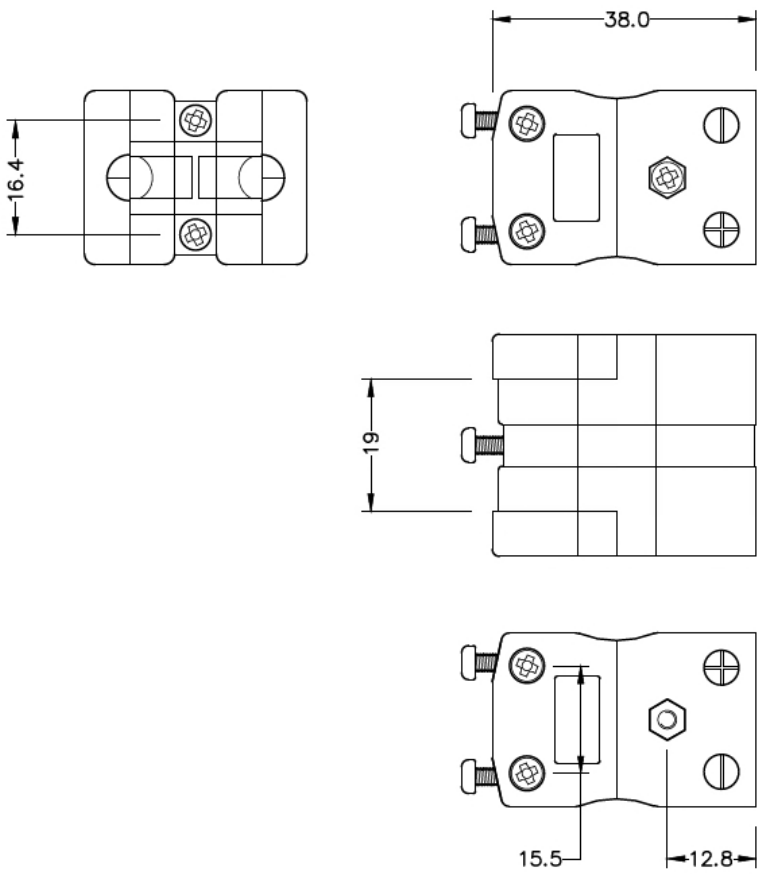

Standard Duplex in-line Socket
(dimensions in mm)