

INTERCONNECTS

SERIES 800, 801, 802, 803 • .100" GRID SOLDER CUP HEADERS AND SOCKETS • SINGLE AND DOUBLE ROW STRIPS

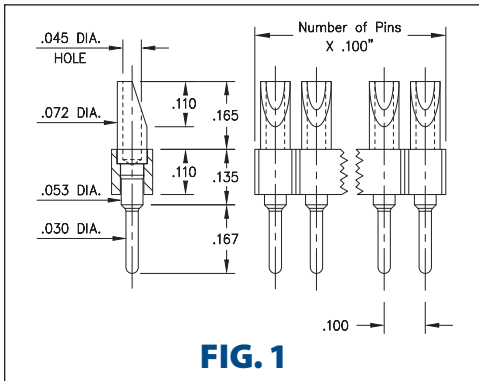

FIG. 1

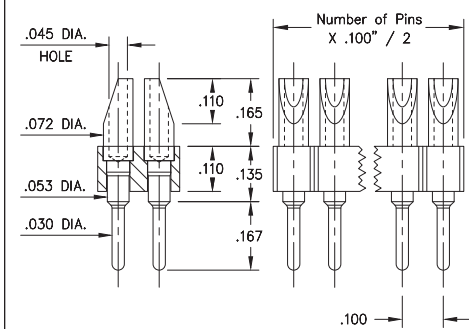

FIG. 2

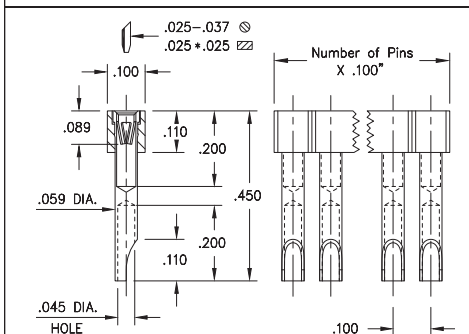

FIG. 3

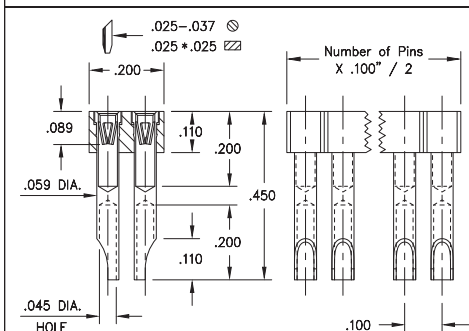
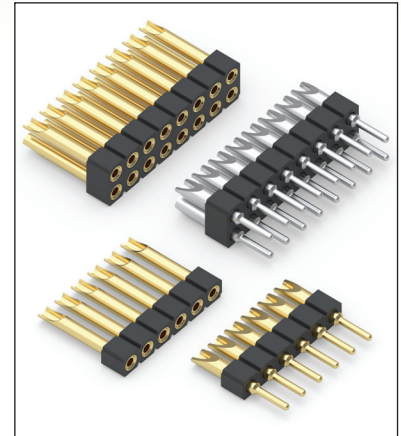

FIG. 4

- Series 800 and 802 use MM #1107 pins. See page 218 for details
- Series 801 and 803 use MM #1134 pin receptacles and accept pin diameters from .025"-.037" and .025" square pins. See page 177 for details
- Series 801 and 803 receptacles use Hi-Rel, 4-finger BeCu #47 contact rated at 4.5 amps. See page 256 for details
- Solder cups are pre-aligned and accept up to 20 AWG wire
- Insulators are high temperature thermoplastic, suitable for all soldering operations



ORDERING INFORMATION

FIG. 1	Series 800...007	Single Row Solder Cup / Solder Tail	
	800-XX-0	-10-007000	02-64
Specify number of pins			
FIG. 2	Series 802...007	Double Row Solder Cup / Solder Tail	
	802-XX-0	-10-007000	02-64
Specify number of pins			
XX=Plating Code See Below For Electrical, Mechanical & Environmental Data, See page 264			
SPECIFY PLATING CODE XX=		10	40
Pin Plating		10 μ" Au	200 μ" Sn

FIG. 3	Series 801...007	Single Row Solder Cup Sockets	
	801-13-0	-10-007000	02-64
Specify number of pins			
FIG. 4	Series 803...007	Double Row Solder Cup Sockets	
	803-13-0	-10-007000	02-64
Specify number of pins			
XX=Plating Code See Below For Electrical, Mechanical & Environmental Data, See page 264			
SPECIFY PLATING CODE XX=		13	
Sleeve (Pin)		10 μ" Au	
Contact (Clip)		30 μ" Au	

