

INTERCONNECTS

SERIES 800, 801, 802, 803 • .100" GRID SOLDER CUP HEADERS AND SOCKETS • SINGLE AND DOUBLE ROW STRIPS

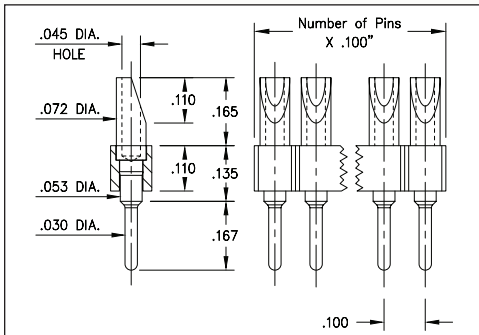

FIG. 1

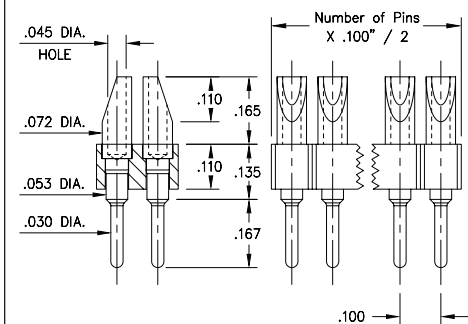

FIG. 2

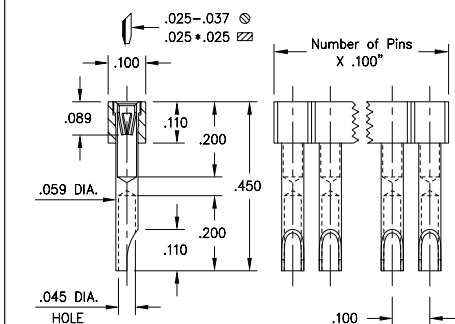

FIG. 3

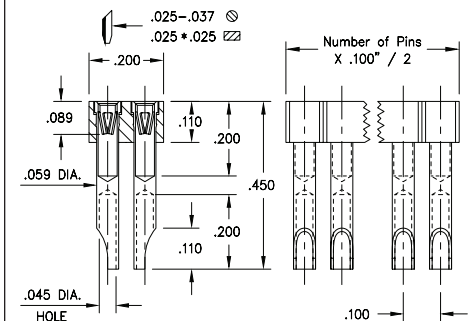
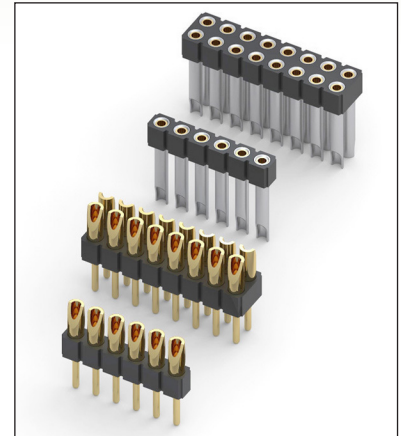

FIG. 4

- Series 800 and 802 use MM #1107 pins. See page 218 for details
- Series 801 and 803 use MM #1134 pin receptacles and accept pin diameters from .025"-.037" and .025" square pins. See page 177 for details
- Series 801 and 803 receptacles use Hi-Rel, 4-finger BeCu #47 contact rated at 4.5 amps. See page 256 for details
- Solder cups are pre-aligned and accept up to 20 AWG wire
- Insulators are high temperature thermoplastic, suitable for all soldering operations



ORDERING INFORMATION









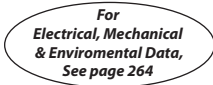

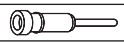

FIG. 1	Series 800...007	Single Row Solder Cup / Solder Tail	
	800-XX-0	-10-007000	02-64
Specify number of pins			
FIG. 2	Series 802...007	Double Row Solder Cup / Solder Tail	
	802-XX-0	-10-007000	02-64
Specify number of pins			
  			
SPECIFY PLATING CODE XX=		10 	40 
Pin Plating 		10 μ" Au	200 μ" Sn

FIG. 3	Series 801...007	Single Row Solder Cup Sockets	
	801-13-0	-10-007000	02-64
Specify number of pins			
FIG. 4	Series 803...007	Double Row Solder Cup Sockets	
	803-13-0	-10-007000	02-64
Specify number of pins			
  			
SPECIFY PLATING CODE XX=		13 	
Sleeve (Pin) 		10 μ" Au	
Contact (Clip) 		30 μ" Au	



Mouser Electronics

Authorized Distributor

Click to View Pricing, Inventory, Delivery & Lifecycle Information:

Mill-Max:

[800-10-010-10-007000](#) [800-10-011-10-007000](#) [800-10-012-10-007000](#) [800-10-013-10-007000](#) [800-10-014-10-007000](#) [800-10-015-10-007000](#) [800-10-016-10-007000](#) [800-10-017-10-007000](#) [800-10-018-10-007000](#) [800-10-019-10-007000](#) [800-10-020-10-007000](#) [800-10-021-10-007000](#) [800-10-022-10-007000](#) [800-10-023-10-007000](#) [800-10-024-10-007000](#) [800-10-025-10-007000](#) [800-10-026-10-007000](#) [800-10-027-10-007000](#) [800-10-028-10-007000](#) [800-10-029-10-007000](#) [800-10-030-10-007000](#) [800-10-031-10-007000](#) [800-10-032-10-007000](#) [800-10-033-10-007000](#) [800-10-034-10-007000](#) [800-10-035-10-007000](#) [800-10-036-10-007000](#) [800-10-037-10-007000](#) [800-10-038-10-007000](#) [800-10-039-10-007000](#) [800-10-040-10-007000](#) [800-10-041-10-007000](#) [800-10-042-10-007000](#) [800-10-043-10-007000](#) [800-10-044-10-007000](#) [800-10-045-10-007000](#) [800-10-046-10-007000](#) [800-10-047-10-007000](#) [800-10-048-10-007000](#) [800-10-049-10-007000](#) [800-10-050-10-007000](#) [800-10-051-10-007000](#) [800-10-052-10-007000](#) [800-10-053-10-007000](#) [800-10-054-10-007000](#) [800-10-055-10-007000](#) [800-10-056-10-007000](#) [800-10-057-10-007000](#) [800-10-058-10-007000](#) [800-10-059-10-007000](#) [800-10-060-10-007000](#) [800-10-061-10-007000](#) [800-10-062-10-007000](#) [800-10-063-10-007000](#) [800-10-064-10-007000](#) [801-13-010-10-007000](#) [801-13-011-10-007000](#) [801-13-012-10-007000](#) [801-13-013-10-007000](#) [801-13-014-10-007000](#) [801-13-015-10-007000](#) [801-13-016-10-007000](#) [801-13-017-10-007000](#) [801-13-018-10-007000](#) [801-13-019-10-007000](#) [801-13-020-10-007000](#) [801-13-021-10-007000](#) [801-13-022-10-007000](#) [801-13-023-10-007000](#) [801-13-024-10-007000](#) [801-13-025-10-007000](#) [801-13-026-10-007000](#) [801-13-027-10-007000](#) [801-13-028-10-007000](#) [801-13-029-10-007000](#) [801-13-030-10-007000](#) [801-13-031-10-007000](#) [801-13-032-10-007000](#) [801-13-033-10-007000](#) [801-13-034-10-007000](#) [801-13-035-10-007000](#) [801-13-036-10-007000](#) [801-13-037-10-007000](#) [801-13-038-10-007000](#) [801-13-039-10-007000](#) [801-13-040-10-007000](#) [801-13-041-10-007000](#) [801-13-042-10-007000](#) [801-13-043-10-007000](#) [801-13-044-10-007000](#) [801-13-045-10-007000](#) [801-13-046-10-007000](#) [801-13-047-10-007000](#) [801-13-048-10-007000](#) [801-13-049-10-007000](#) [801-13-050-10-007000](#) [801-13-051-10-007000](#) [801-13-052-10-007000](#) [801-13-053-10-007000](#) [801-13-054-10-007000](#)