

# PRODUCT NUMBER

77315-YXX-XXLF

- RoHS COMPATIBLE  
SEE NOTE 7
- TOTAL NB OF POSITIONS 01 TO 36
- PACKAGING, NOTE 3
- PIN STYLE SEE SHEET 2
- PLATING SEE SHEET 2

## NOTES:

- HOUSING MAT'L : HIGH TEMPERATURE THERMOPLASTIC. UL94V-0 COLOR: BLACK
- PIN MATERIAL : PHOSPHOR BRONZE
- PACKAGING:
  - PACKAGING POLYBAG
  - "V" BLIBOX PACK FOR CUSTOMER DEDICATED PART
  - "K" TAPE & REEL PACKAGING WITHOUT PICK UP CAP
- 9N MIN RETENTION IN EITHER DIRECTION
- TO DETERMINE DIMENSIONS :  
N = NUMBER OF POSITIONS PER ROW  
EXAMPLE : 8 POS N x 2.54 = 20.32mm
- UNDERPLATING : 1.27µm Ni MIN
- RoHS COMPATIBLE PRODUCT SPECIFICATIONS
  - PLATING:
    - "LF" MEANS THE PRODUCT IS LEAD-FREE, 2µm MINIMUM MATTE TIN OVER 1.27µm MINIMUM NICKEL UNDERPLATE.
  - MANUFACTURING PROCESS COMPATIBILITY
    - THE HOUSING WILL WITHSTAND EXPOSURE TO 260°C ±5°C SOLDER BATH TEMPERATURE FOR 5 SECONDS IN A WAVE SOLDER APPLICATION WITH A 1.6mm MIN THICK CIRCUIT BOARD.
    - REFLOW COMPATIBLE
  - LABELING:
    - MEETS PACKAGING SPECS AS PER GS-14-920
  - LEGAL STATEMENT: SEE GS-47-0004

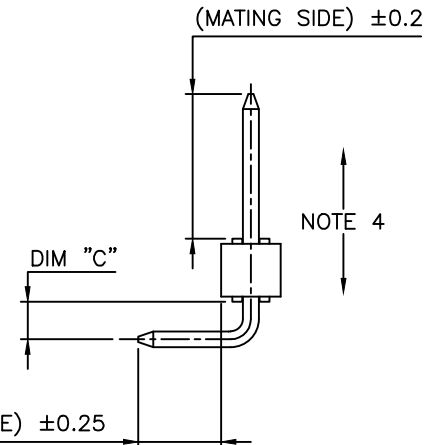
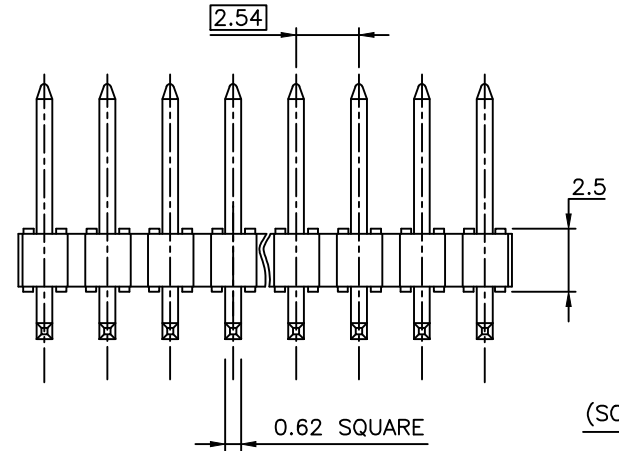
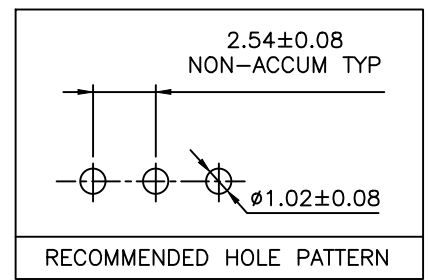
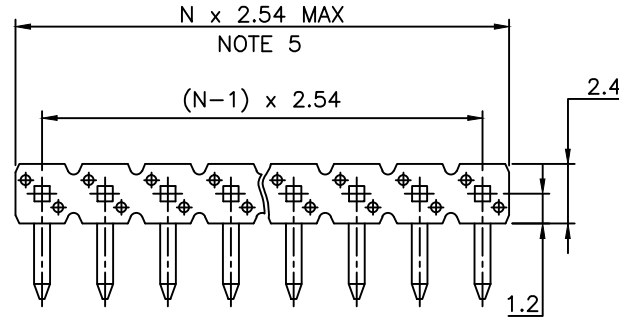

mat'l. code SEE NOTES				surface ISO 1302	tolerance ISO 406 ISO 1101	projection mm	product family BERGSTIK
ltr	ecn no	dr	date	tolerances unless otherwise specified			title
AT	F-23187	AMA	16.02.01	angles	.x ±0.3	mm	UNSHR.HEADER
AU	F-23373	AMA	16.02.26	linear	.xx ±0.15	mm	RA SR TMT
AV	F-23462	LMU	16.03.07		.xxx ±0.05	scale 5:1	
AW	F-23551	LMU	16.03.21	dr	D.LE	01.01.24	dwg no
				enr	JM.C	01.01.24	sheet 1 of 2
AR	B-18916	LMU	14.09.26	chr	JM.C	01.01.24	size
AS	B-19715	BVE	14.12.11	appd	JF.N	01.01.24	A3
sheet	revision	AW	AR				type
index	sheet	1	2				CUSTOMER Drawing



FCIconnect.com

Copyright FCI

## PRODUCT SPECIFICATIONS

PIN	STYLE	MATING	SOLDER	DIM "C"
01		5.72	2.57	1.5
02		5.72	5.11	1.5
03		5.72	7.65	1.5
07		5.72	5.11	3.9
13		5.72	3.45	1.5
18		5.84	3.05	1.5
22		11.71	3.2	1.5
24		6.75	2.85	1.5
25		8.07	3.05	1.5
26		8.2	12.6	1.5
27		5	3.9	1.5
28		3.1	3.1	1.5
29		9.7	2.90	1.5
30		8.30	4.40	1.5
31		11.70	2.80	1.5
32		8.90	3.05	1.5
33		10.20	3.05	1.5
34		10.00	3.25	1.5
35		5.72	12.73	1.5
36	N/A			
37	N/A			
38		8.51	5.51	1.5
39		9.80	9.30	1.5
40		8.13	2.54	3.90
41		14.20	3.05	1.5
42		9.00	7.20	1.5
43		8.08	2.79	1.5
44		15.70	2.79	1.5
45		8.20	2.35	1.5

## PLATING

- 1 = 0.76µm GOLD/GXT ON CONTACT AREA, 2µm TIN MIN ON TAIL  
4 = 3µm-5µm TIN FULL PLATED REFLOW  
5 = 0.25µm GOLD/GXT ON CONTACT AREA, 2µm TIN MIN ON TAIL  
8 = 0.38µm GOLD/GXT ON CONTACT AREA, 2µm TIN MIN ON TAIL  
G = 0.76µm FULL GXT  
S = 0.38µm FULL GXT  
- 1.27µm NICKEL MIN UNDERLAYER FOR ALL PLATING VERSIONS

mat'l. code SEE NOTES				surface ISO 1302 ✓	tolerance ISO 406 ISO 1101	projection 	product family BERGSTIK		
ltr	ecn no	dr	date	tolerances unless otherwise specified			title UNSHR.HEADER RA SR TMT		
AP	F-23462	LMU	16.03.07	angles	linear				
AR	F-23551	LMU	16.03.21						
						scale 5:1	dwg no 77315 type CUSTOMER Drawing		
AK	B-16178	JCO	13.10.31	dr	D.LE	01.01.24			
AL	B-17109	JCO	14.03.06	enr	JM.C	01.01.24			
AM	B-18916	LMU	14.09.26	chr	JM.C	01.01.24	sheet 2 of 2 size A3		
AN	F-23373	AMA	16.02.26	appd	JF.N	01.01.24			
sheet	revision								
index	sheet								