



















Tous droits strictement réservés. Reproduction ou communication a des tiers interdite sous quelque forme que ce soit sans autorisation écrite du propriétaire. Propriété de c FCI. Droits de reproduction FCI.



All rights strictly reserved. Reproduction or issue to third parties in any form whatever is not permitted without written authority from the proprietor. Property of FCI. Copyright FCI.

PRODUCT NO.	ROW S	POWER								SIGNAL					POWER			E1	
		E2	P10	P9	P8	P7	P6	P5	P4	6	5	4	3	2	1	P3	P2		P1
51940-231-- NOTE: 3	D C B A		 PD	 PD	 PD	 PD	 PD	 PA	 PA	 E	 E	 E	 E	 E	 E	 PG	 PH	 PH	

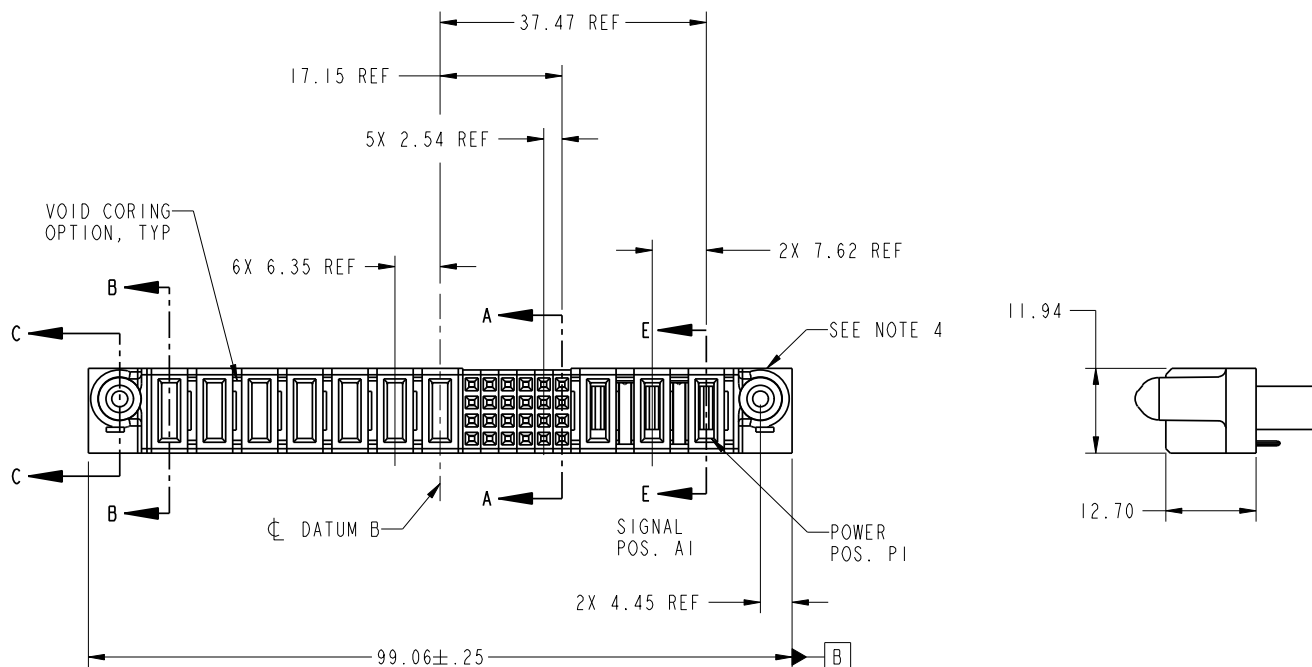

CODE	DIM "M" MATING LENGTH	CONTACT TYPE
E	[N/A]	SIGNAL
PD	[2.34]	POWER
PH	[2.34]	POWER
PG	[1.07]	POWER
PA	[1.07]	POWER

mat'l code				SEE NOTES		tolerances unless otherwise specified		CUSTOMER		FCI	
litr	ecn no.	dr	date	linear		0.X ± 0.3		COPY		www.fciconnect.com	
A	DG07-0282	RYUAN	07/06/07			0.XX ± 0.13		projection		title	
				angles		0.XXX ± 0.051				3ACP + 24S + 7P VERTICAL STB RECEPT	
				dr	RYAN YUAN	06/25/07		scale	1:1	product family	PwrBlade
				enrg	RYAN YUAN	06/25/07				size	dwg no
				chr	GARY HSIEH	06/25/07				A	51940-231
				appd	JOSEPH HSIA	06/25/07					code
sheet index	revision	sheet	A	A	A	A					213
			1	2	3	4					sheet 1 of 4

code code 22526

Pro/E

Tous droits strictement reserves. Reproduction ou communication a des tiers interdite sous quelque forme que ce soit sans autorisation écrite du propriétaire. Propriété de c FCI. Droits de reproduction FCI.



All rights strictly reserved. Reproduction or issue to third parties in any form whatever is not permitted without written authority from the proprietor. Property of FCI. Copyright FCI.

PRODUCT NUMBER

51940-231__
NOTE: 3

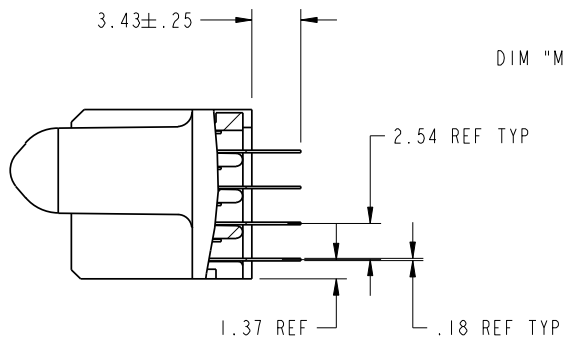

SECTION A-A
SCALE 2:1

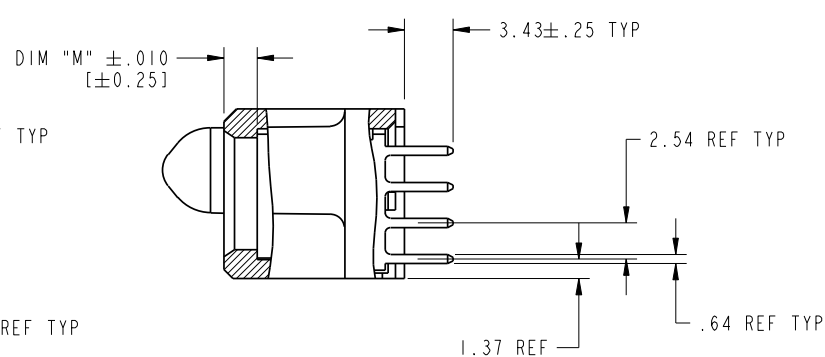

SECTION B-B
SCALE 2:1

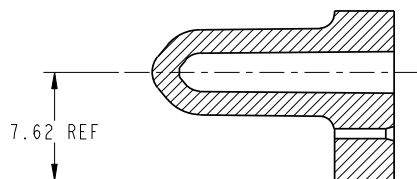

SECTION C-C
SCALE 2:1

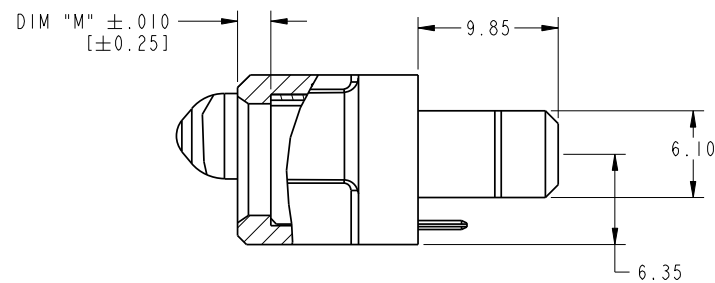

SECTION E-E
SCALE 2:1

mat'l code				tolerances unless otherwise specified		CUSTOMER	
litr	ecr no.	dr	date	linear	0.X ±0.3	COPY	
A					0.XX ±0.13	projection	
				angles	0.XXX ±0.051		title
				dr	0° ±2°	MM	3ACP + 24S + 7P VERTICAL STB RECEPT
				enrg	RYAN YUAN 06/25/07	scale	product family PwrBlade
				chr	GARY HSIEH 06/25/07	1:1	size dwg no
				appd	JOSEPH HSIA 06/25/07		51940-231
sheet index	revision sheet						code
							213
							sheet 2 of 4



www.fciconnect.com

product family PwrBlade
size dwg no 51940-231

cage code 22526

Pro/E

Tous droits strictement reserves. Reproduction ou communication a des tiers interdite sous quelque forme que ce soit sans autorisation écrite du propriétaire. Propriété de c FCI. Droits de reproduction FCI.



All rights strictly reserved. Reproduction or issue to third parties in any form whatever is not permitted without written authority from the proprietor. Property of FCI. Copyright FCI.

PRODUCT NUMBER
51940-231__
NOTE: 3

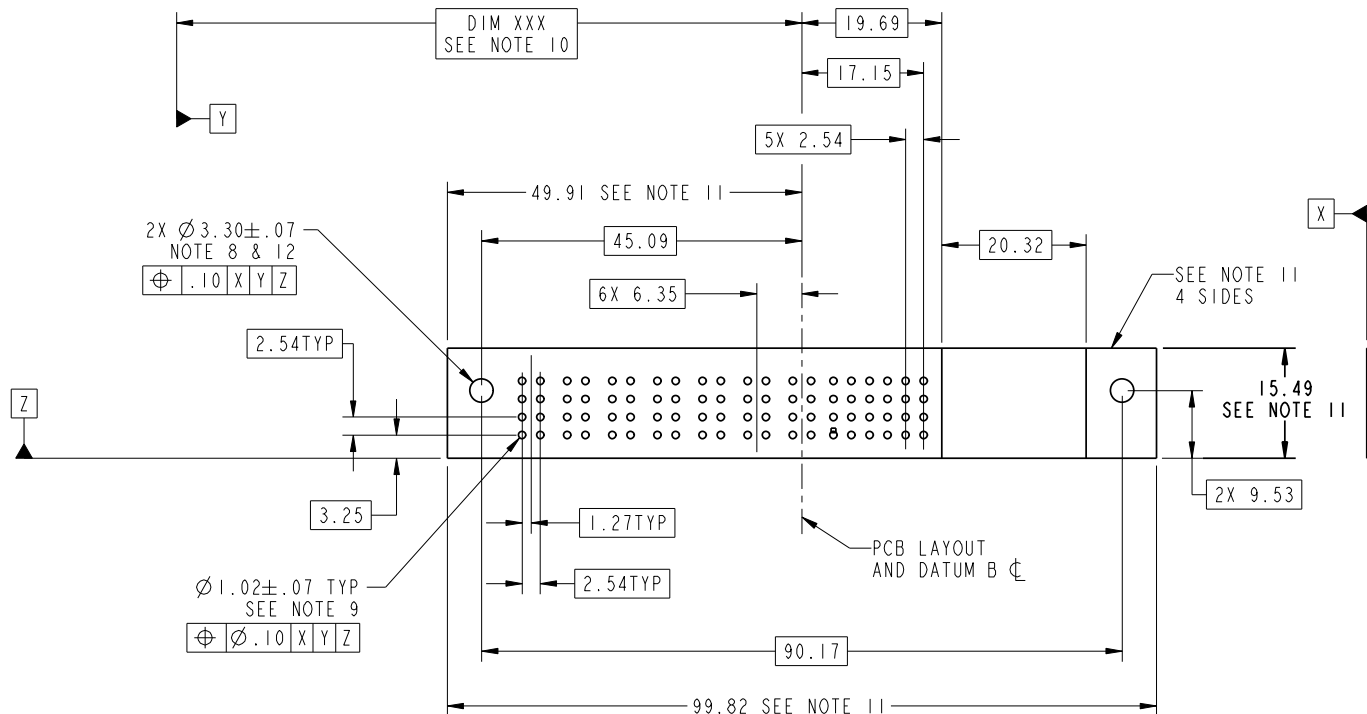

mat'l code				tolerances unless otherwise specified		CUSTOMER	
litr	ecn no.	dr	date	linear	0.X ±0.3	COPY	
A					0.XX ±0.13	projection	
				angles	0.XXX ±0.051		
				dr	0° ±2°		
				engr	RYAN YUAN 06/25/07	MM	
				chr	RYAN YUAN 06/25/07	scale	
				appd	GARY HSIEH 06/25/07	1:1	
					JOSEPH HSIA 06/25/07		
sheet index	revision sheet						



www.fciconnect.com

title
3ACP + 24S + 7P
VERTICAL STB RECEPT

product family PwrBlade code 213

size dwg no 51940-231 sheet 3 of 4

cage code 22526

Pro/E

Tous droits strictement reserves. Reproduction ou communication a des tiers interdite sous quelque forme que ce soit sans autorisation écrite du propriétaire. Propriété de c FCI. Droits de reproduction FCI.



All rights strictly reserved. Reproduction or issue to third parties in any form whatever is not permitted without written authority from the proprietor. Property of FCI. Copyright FCI.

PRODUCT NUMBER																																																																																																					
51940-231__ NOTE: 3																																																																																																					
NOTES:																																																																																																					
1. DIMENSIONS AND TOLERANCES ARE IN ACCORDANCE WITH ASME Y14.5M, 1994 UNLESS OTHERWISE SPECIFIED.																																																																																																					
CONNECTOR NOTES:																																																																																																					
② HOUSING MATERIAL: UL 94 V-0 GLASS FILLED HIGH-TEMP THERMOPLASTIC POWER CONTACT MATERIAL: COPPER ALLOY SIGNAL PIN MATERIAL: COPPER ALLOY																																																																																																					
3. PLATING SPEC. 51940-231, 51940-231LF PLATING SPEC. WAS SHOWN IN THE PRINT OF 10064183.																																																																																																					
④ MANUFACTURER'S NAME, P/N, AND DATE CODE TO APPEAR ON THIS SURFACE.																																																																																																					
5. PRODUCT SPECIFICATION GS-12-149. APPLICATION SPECIFICATION BUS-20-067.																																																																																																					
6. PACKAGED IN TRAYS.																																																																																																					
PCB NOTES:																																																																																																					
7. ALL HOLE DIAMETERS ARE FINISHED HOLE SIZE.																																																																																																					
⑧ MOUNTING HOLES, WHERE APPLICABLE, ARE UNPLATED.																																																																																																					
⑨ $\varnothing 1.151 \pm 0.025$ DRILLED HOLES PLATED WITH 0.008 MIN SnPb OR Sn OVER 0.03 TO 0.08 Cu PLATING TO ACHIEVE $\varnothing 1.02 \pm 0.07$ HOLE.																																																																																																					
⑩ "DIM XXX" TO BE DETERMINED BY THE CUSTOMER.																																																																																																					
⑪ CONNECTOR KEEP-OUT ZONE.																																																																																																					
⑫ RECOMMENDED RETENTION TO PCB $\varnothing .130[3.30]$ THRU HOLE FOR #5 SOCKET HEAD CAP SCREW MAX. HEAD .205[5.21] RECOMMENDED SCREW LENGTH .472 [11.99] + PCB THICKNESS. RECOMMENDED SCREW SEATING TO PCB TORQUE: 2-5 lbf-in (2300-5760 gf-cm).																																																																																																					
<table border="1"><thead><tr><th colspan="4">mat'l code</th><th colspan="2">tolerances unless otherwise specified</th><th colspan="2">CUSTOMER</th><th colspan="2">FCI</th></tr><tr><th>ltr</th><th>ecn no.</th><th>dr</th><th>date</th><th>linear</th><th>angles</th><th colspan="2">COPY</th><th colspan="2">www.fciconnect.com</th></tr></thead><tbody><tr><td>A</td><td></td><td></td><td></td><td>$0.X \pm 0.3$</td><td></td><td colspan="2">projection</td><td colspan="2">title</td></tr><tr><td></td><td></td><td></td><td></td><td>$0.XX \pm 0.13$</td><td></td><td colspan="2"></td><td colspan="2">3ACP + 24S + 7P VERTICAL STB RECEPT</td></tr><tr><td></td><td></td><td></td><td></td><td>$0.XXX \pm 0.051$</td><td></td><td colspan="2"></td><td colspan="2">product family PwrBlade</td></tr><tr><td></td><td></td><td></td><td></td><td>dr RYAN YUAN 06/25/07</td><td></td><td colspan="2">scale 1:1</td><td colspan="2">code 213</td></tr><tr><td></td><td></td><td></td><td></td><td>enrg RYAN YUAN 06/25/07</td><td></td><td colspan="2"></td><td colspan="2">sheet 4 of 4</td></tr><tr><td></td><td></td><td></td><td></td><td>chr GARY HSIEH 06/25/07</td><td></td><td colspan="2"></td><td colspan="2"></td></tr><tr><td></td><td></td><td></td><td></td><td>appd JOSEPH HSIA 06/25/07</td><td></td><td colspan="2"></td><td colspan="2"></td></tr><tr><td>sheet index</td><td>revision sheet</td><td></td><td></td><td></td><td></td><td></td><td></td><td></td><td></td></tr></tbody></table>		mat'l code				tolerances unless otherwise specified		CUSTOMER		FCI		ltr	ecn no.	dr	date	linear	angles	COPY		www.fciconnect.com		A				$0.X \pm 0.3$		projection		title						$0.XX \pm 0.13$				3ACP + 24S + 7P VERTICAL STB RECEPT						$0.XXX \pm 0.051$				product family PwrBlade						dr RYAN YUAN 06/25/07		scale 1:1		code 213						enrg RYAN YUAN 06/25/07				sheet 4 of 4						chr GARY HSIEH 06/25/07										appd JOSEPH HSIA 06/25/07						sheet index	revision sheet								
mat'l code				tolerances unless otherwise specified		CUSTOMER		FCI																																																																																													
ltr	ecn no.	dr	date	linear	angles	COPY		www.fciconnect.com																																																																																													
A				$0.X \pm 0.3$		projection		title																																																																																													
				$0.XX \pm 0.13$				3ACP + 24S + 7P VERTICAL STB RECEPT																																																																																													
				$0.XXX \pm 0.051$				product family PwrBlade																																																																																													
				dr RYAN YUAN 06/25/07		scale 1:1		code 213																																																																																													
				enrg RYAN YUAN 06/25/07				sheet 4 of 4																																																																																													
				chr GARY HSIEH 06/25/07																																																																																																	
				appd JOSEPH HSIA 06/25/07																																																																																																	
sheet index	revision sheet																																																																																																				
Pro/E																																																																																																					
cage code 22526																																																																																																					

Mouser Electronics

Authorized Distributor

Click to View Pricing, Inventory, Delivery & Lifecycle Information:

FCI:

[51940-231LF](#)