

PLATING NO.	PLATING TYPE / PROCESS	THICKNESS	APPLICABLE SPEC.	PLATING AREA
1	ELECTRO MATTE TIN PRE PLATED	50-100μ"		ALL OVER
2	PREVIOUS METAL NICKEL FLASH ALL OVER	FLASH OPTIONAL	NONE	ALL OVER
	SULPHAMATE DUCTILE NICKEL	50μ" MIN	ASTM B 689-90 TYPE 2	#3
	GOLD ELECTRODEPOSITED 99.99 Au MIN-CODE C HARDNESS KNOOP 130-200 HK25	7.0 MIN AT 30μ" MIN.	ASTM B-488-95	#1
	GOLD ELECTRODEPOSITED 99.99 Au MIN-CODE C HARDNESS KNOOP 130-200 HK25	11.1 MIN AT 30μ" MIN.	ASTM B-488-95	#2
	ELECTRO MATTE TIN/LEAD 95/5 (Sn/Pb)	100-300μ"	ES-F8DB-14A229-CA	#4
	OPT: 100% PURE ELECTRO MATTE TIN PREFERRED		ASTM B-545-83	

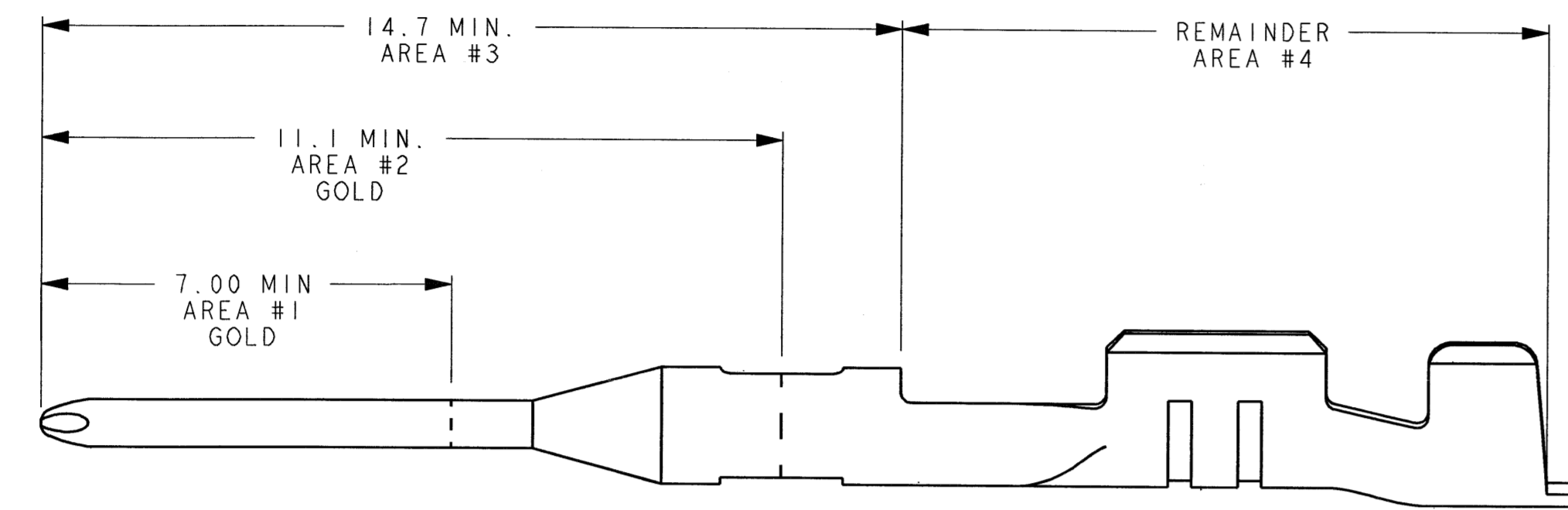

PLATING OPTIONS

NOTE: FOR GOLD OPTIONS 2c AND 2d, PLATING PROCESSES 2a, 2b, 2c & 2f APPLY.

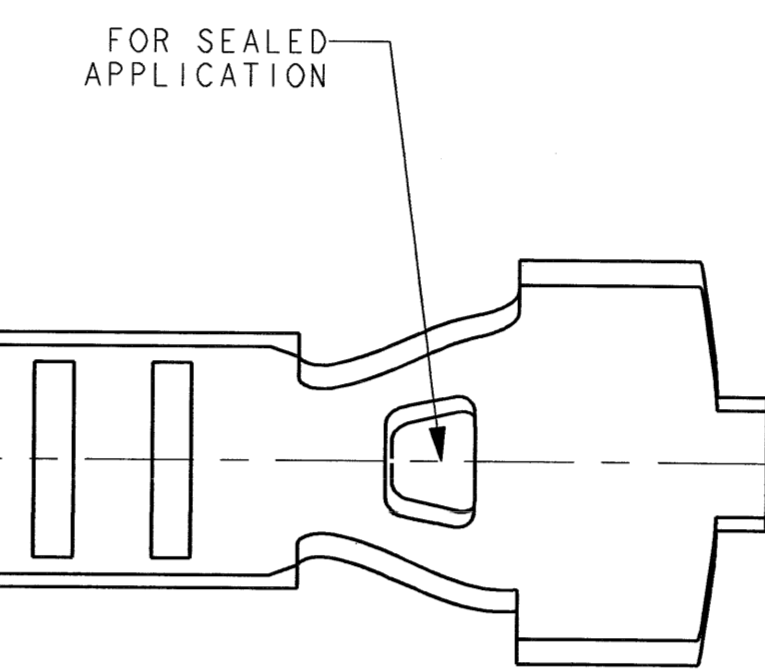
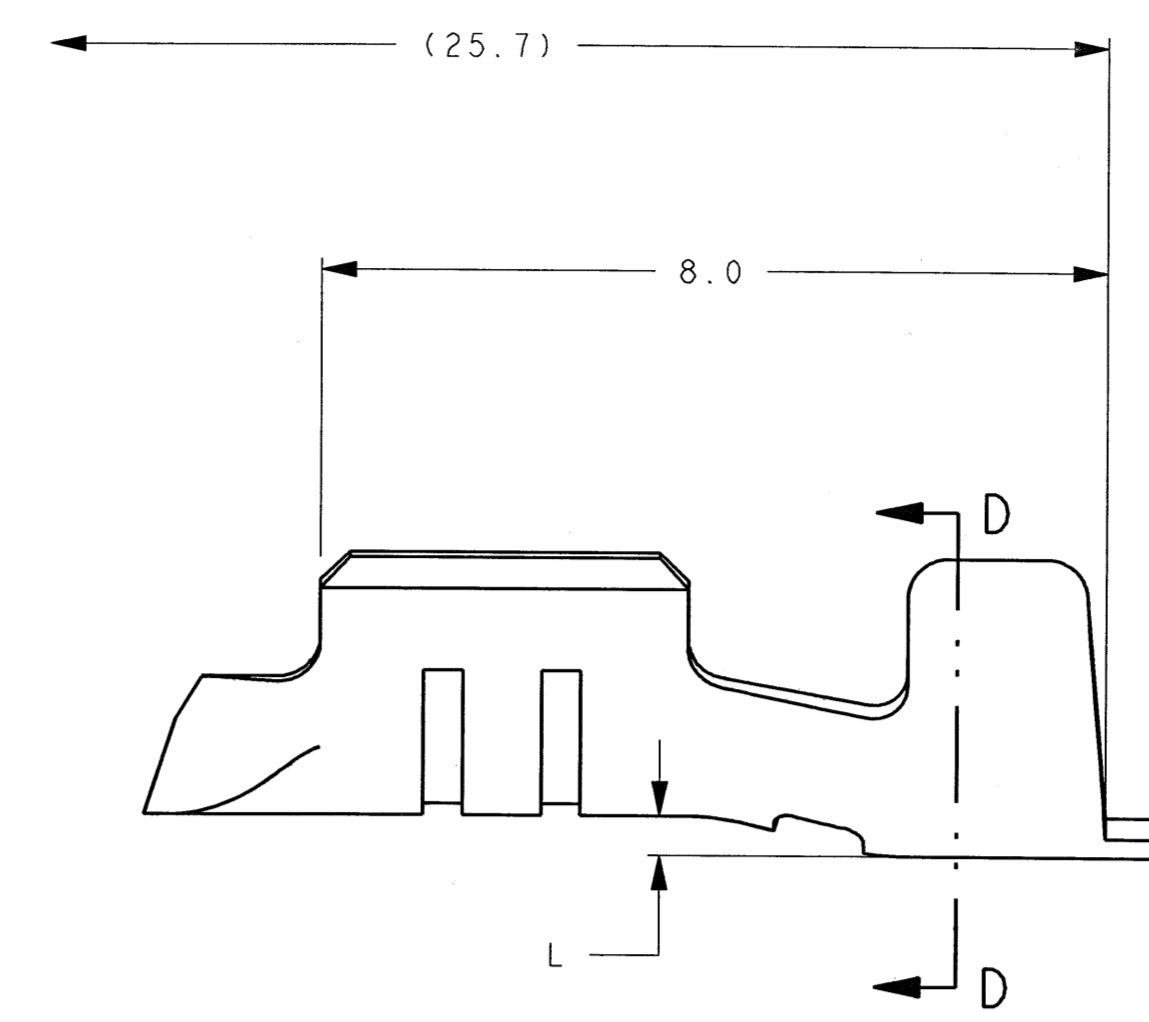

CABLE SEAL GRIP CONFIGURATION

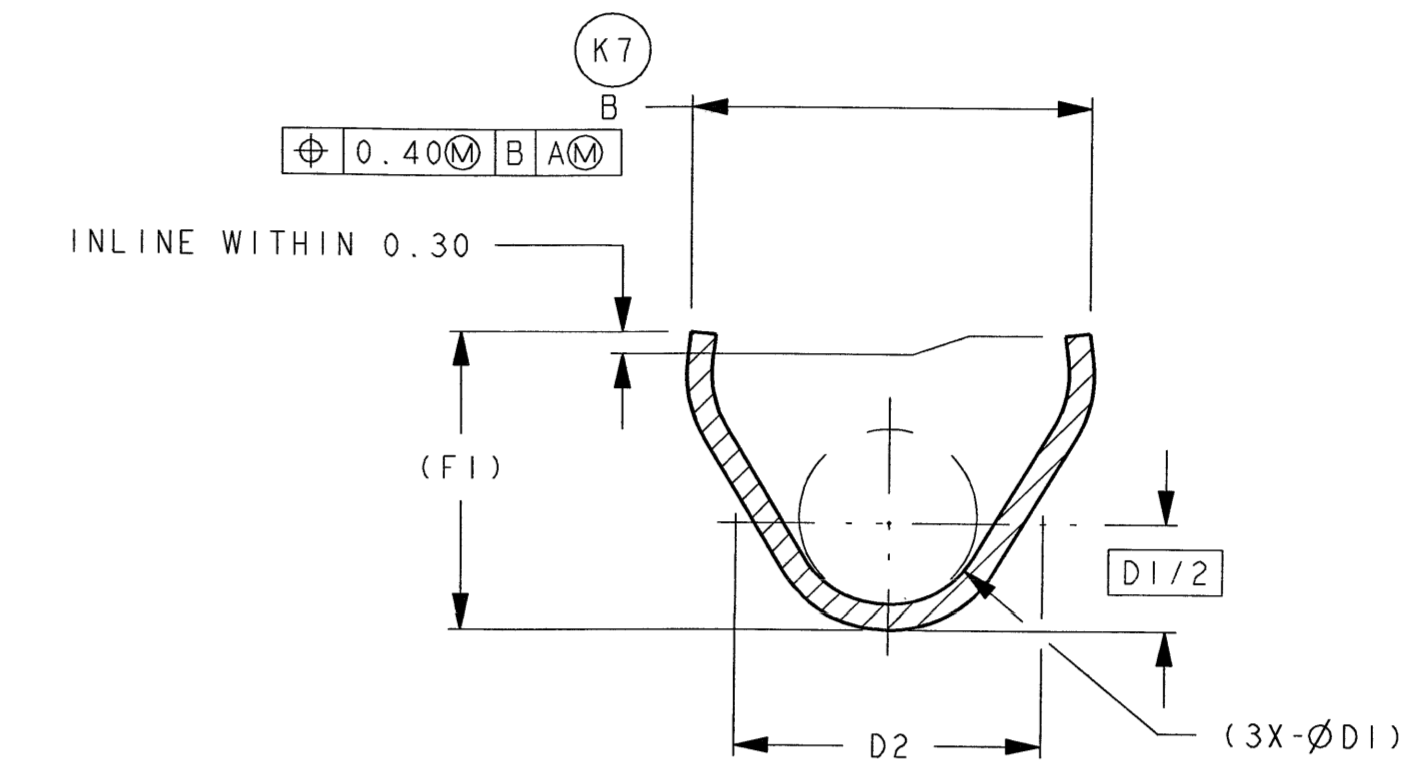

SECTION D-D CABLE SEAL INSULATION

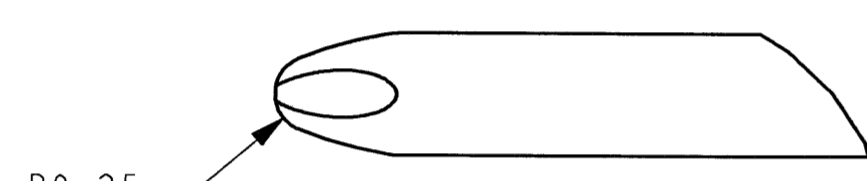

VIEW Y NOSE COIN (K8) MUST BE FREE OF BURRS SCALE 20X

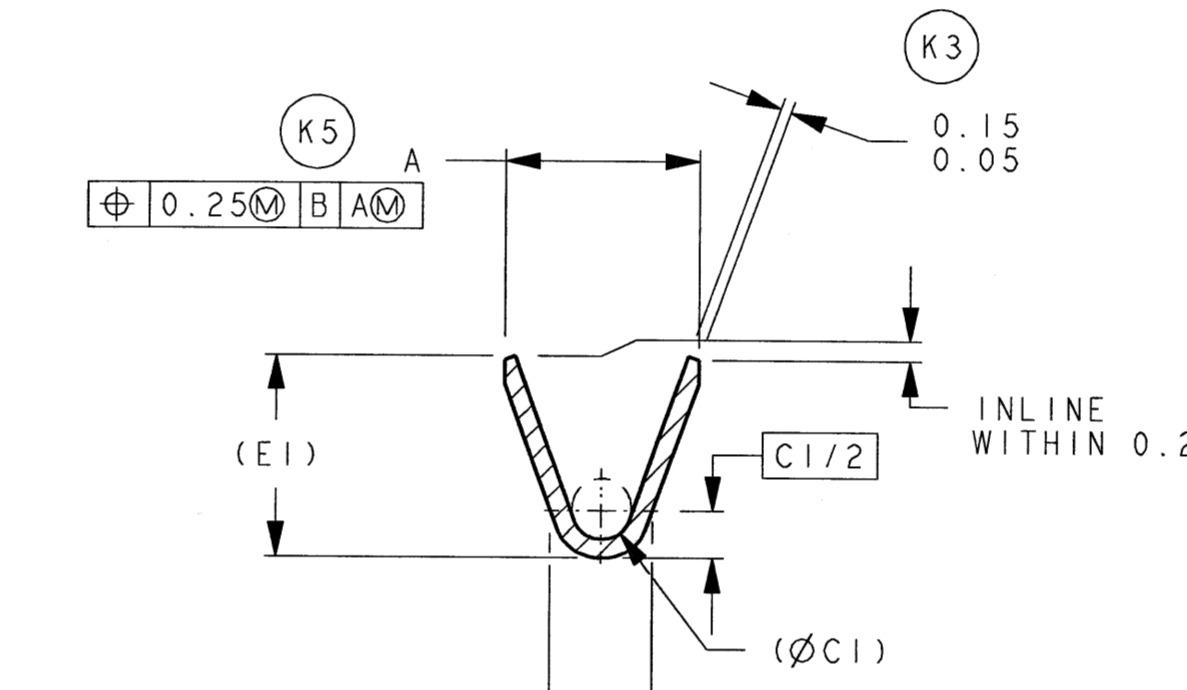
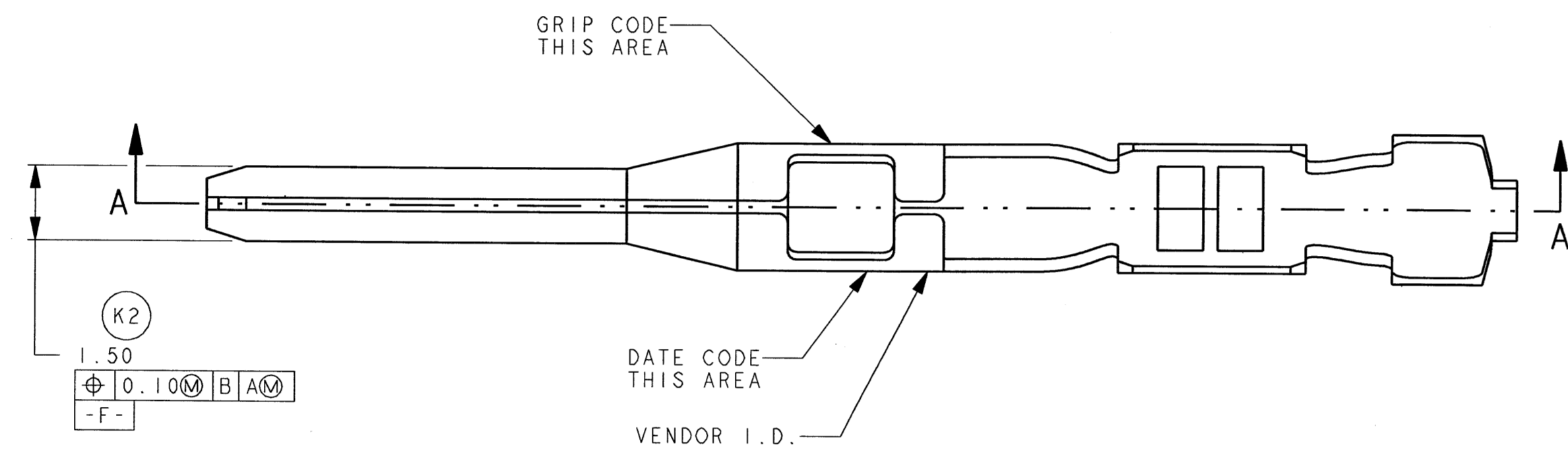

SECTION B-B CONDUCTOR

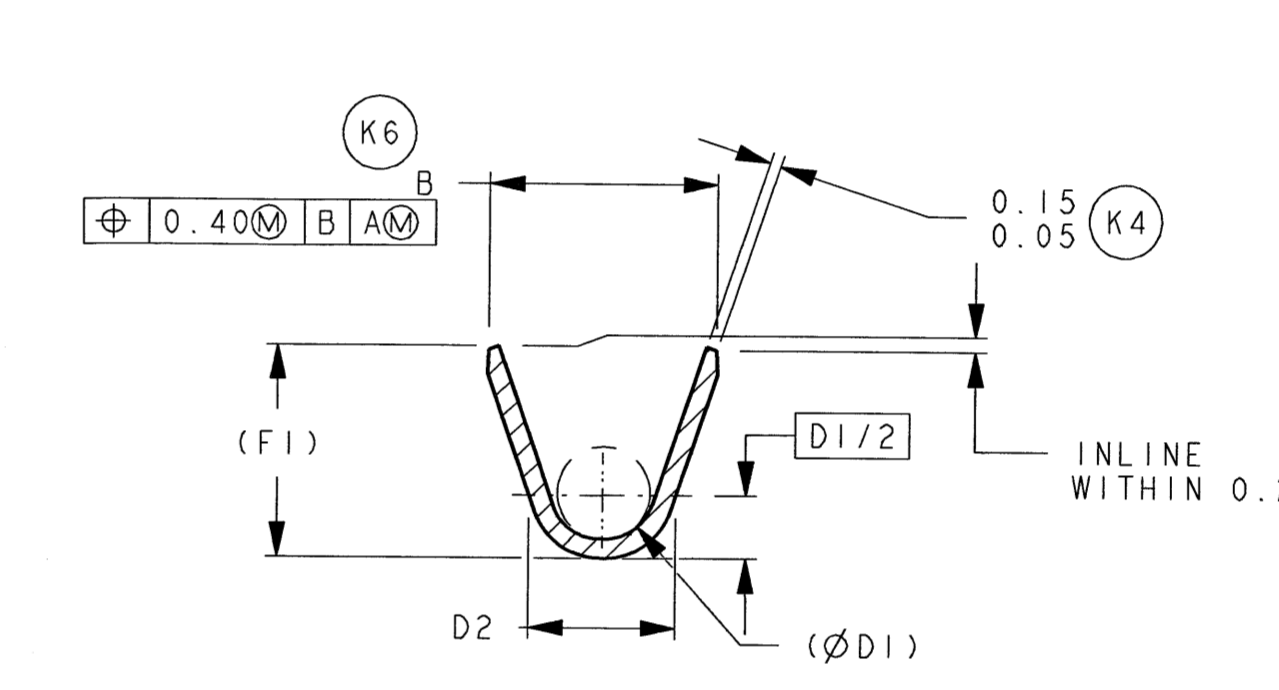

SECTION C-C UNSEALED INSULATION

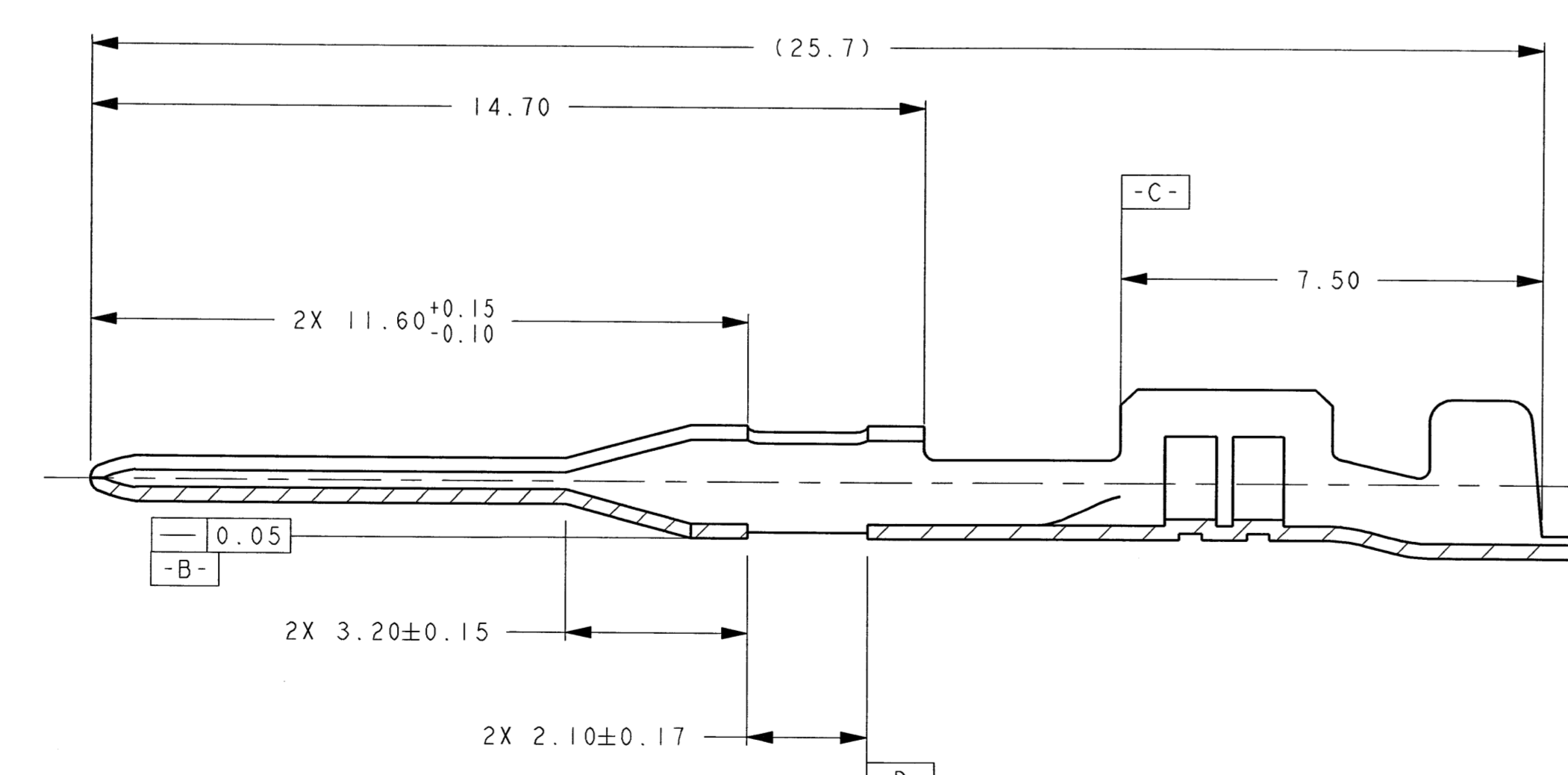
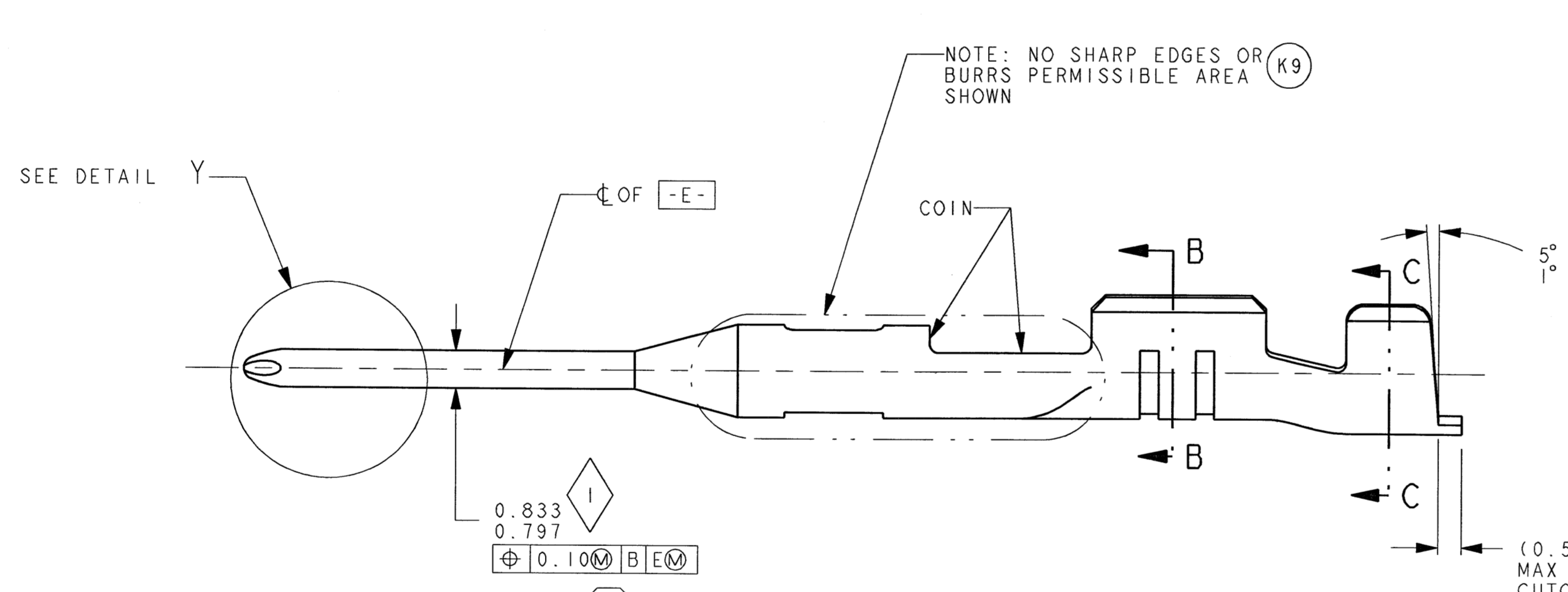
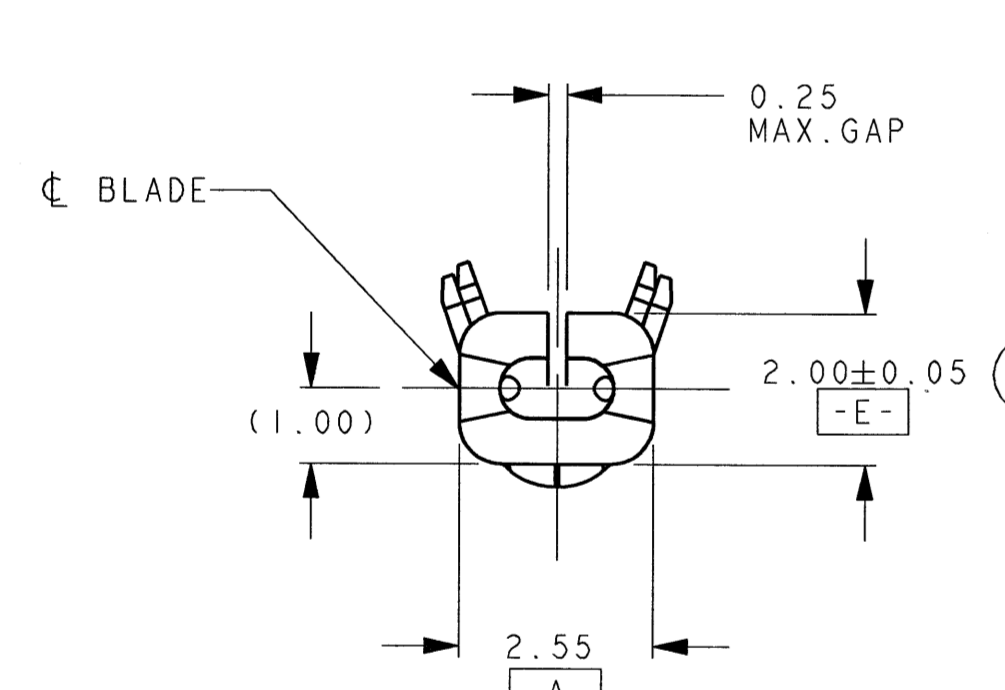

SECTION A-A

FCI PART NUMBER	GRIP CODE	WIRE SIZE	CW	CH	CRIMP STYLE	CW	CH	CRIMP STYLE	
			CONDUCTOR			INSULATION			
54002237	22	AUL	22/24	1.85	1.05	"B"	3.10	3.10	"O"
54001846	18	AUL	18/20	2.05	1.27	"B"	3.50	3.50	"O"
54001438	14	AUL	14/16	2.45	1.55	"B"	4.10	4.10	"O"
54002236	22	AUL	22/24	1.85	1.05	"B"	2.20	1.85	"D"
54001845	18	AUL	18/20	2.05	1.27	"B"	2.60	2.25	"D"
54001437	14	AUL	14/16	2.45	1.55	"B"	3.20	2.65	"D"
54002235	22	AUG	22/24	1.85	1.05	"B"	3.10	3.10	"O"
54001844	18	AUG	18/20	2.05	1.27	"B"	3.50	3.50	"O"
54001436	14	AUG	14/16	2.45	1.55	"B"	4.10	4.10	"O"
54002234	22	AUG	22/24	1.85	1.05	"B"	2.20	1.85	"D"
54001843	18	AUG	18/20	2.05	1.27	"B"	2.60	2.25	"D"
54001435	14	AUG	14/16	2.45	1.55	"B"	3.20	2.65	"D"
54002233	22	22/24	22/24	1.85	1.05	"B"	3.10	3.10	"O"
54001842	18	18/20	18/20	2.05	1.27	"B"	3.50	3.50	"O"
54001434	14	14/16	14/16	2.45	1.55	"B"	4.10	4.10	"O"
54002232	22	22/24	22/24	1.85	1.05	"B"	2.20	1.85	"D"
54001841	18	18/20	18/20	2.05	1.27	"B"	2.60	2.25	"D"
54001433	14	14/16	14/16	2.45	1.55	"B"	3.20	2.65	"D"

SEE FCI PRODUCT EVALUATION LAB APEX TERMINAL CRIMP GUIDELINES FOR CRIMP & WIRE INFORMATION. THESE GUIDELINES MUST BE FOLLOWED, NOT CRIMPING TO THESE GUIDELINES MAY RESULT IN ELECTRICAL OR MECHANICAL FAILURES.

CRIMP TOLERANCES FOR BOTH CONDUCTOR AND INSULATION CRIMPS TO BE AS FOLLOWS.

CRIMP TOLERANCES FOR BOTH CONDUCTOR AND INSULATION CRIMPS TO BE AS FOLLOWS.

CW CRIMP WIDTH ±0.08
CH CRIMP HEIGHT ±0.05

NOTES: MATERIAL: 0.254±.005 C19210 (H07)
TENSILE STRENGTH = 60-70 KSI
YIELD STRENGTH = (60 KSI MIN.)
ELONGATION IN 51MM = 2 MIN.

SEE PLATING OPTION VIEW FOR PLATING NOTES.

(K) QUALITY ASSURANCE REQUIREMENTS SPC DATA REQUIRE

(K) INDICATES IN-PROCESS INSPECTION FOR MANUFACTURING DIMENSIONS OR SPECIFICATIONS

(G) DENOTES GAGE REQUIREMENTS FOR USER AND MANUFACTURER

FCI P/N PART NUMBERS TIN PLATED	GRIP CODE	FCI P/N'S GOLD OPTION 2c	GRIP CODE GOLD 2c	FCI P/N'S GOLD OPTION 2d	GRIP CODE GOLD 2d	CABLE SEAL	UNSEALED OR END SEAL	GAGE	A	B	(ØC1)	C2	(ØD1)	D2	(ØE1)	(ØF1)	L
54002233	22	54002235	22 AUG	54002237	22 AUL	YES	---	22.24	2.6	4.3	0.8	1.4	2.6	3.3	2.6	3.7	0.75
54001842	18	54001844	18 AUG	54001846	18 AUL	YES	---	18.20	3.0	4.7	1.2	1.8	3.0	3.6	3.0	4.3	0.85
54001434	14	54001436	14 AUG	54001438	14 AUL	YES	---	14.16	3.8	5.7	1.4	2.0	3.4	4.3	3.8	4.9	1.05
54002232	22	54002234	22 AUG	54002236	22 AUL	---	YES	22.24	2.6	3.0	0.8	1.4	1.4	2.1	2.6	2.7	0.40
54001841	18	54001843	18 AUG	54001845	18 AUL	---	YES	18.20	3.0	3.8	1.2	1.8	1.8	2.4	3.0	3.3	0.40
54001433	14	54001435	14 AUG	54001437	14 AUL	---	YES	14.16	3.8	4.7	1.4	2.0	2.2	3.0	3.8	4.0	0.40

REV	DATE	BY	CHK	APP	DESCRIPTION
5554	05-18-07	E3	A14.C1		REVISED PER 001 MARK UP OF 001 CHANGES
5063	03-08-07	E2	A11.C5		REVISED PER 000 MARK UP
9272	02-19-07	E1			UPDATED/CORRECTED PER 000 MARK-UP
8157	08-14-06	E	ALL		NEW CUSTOMER DRAWING CREATED