

PRODUCT NUMBER
SEE TABLE

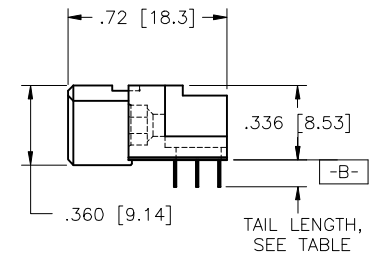

mat'l. code				surface	tolerance	projection	product family
NOTE 3				ISO 1302	ISO 406	ISO 1101	HPC
ltr	ecn no	dr	date	tolerances unless otherwise specified			
J	v00254	JWS	1/13/00	angles	linear	XX±.01/XX±0.3	<div>INCH/MM</div> <div>scale 1:1</div>
K	v01300	HTB	4/13/00			XXX±.006/XX±0.13	
L	v05-0895	DCH	9/20/05	0'±2'		XXXX±.0020/XXX±0.06	
M	v05-1052	DAI	11/17/05	dr	G.PETERS	6/5/96	
N	M06-0283	MHT	7/27/06	engr	S.CLARK	6/3/95	<div>FCI</div> <div>50294</div> <div>A3</div>
P	M07-0099	AGS	2/09/07	chr	S.CLARK	6/5/95	
R	M08-0280	AGS	9/30/08	appd	S.CLARK	6/5/95	
sheet				revision	R	R	
index				sheet	1	2	

PRODUCT NUMBER
SEE TABLE

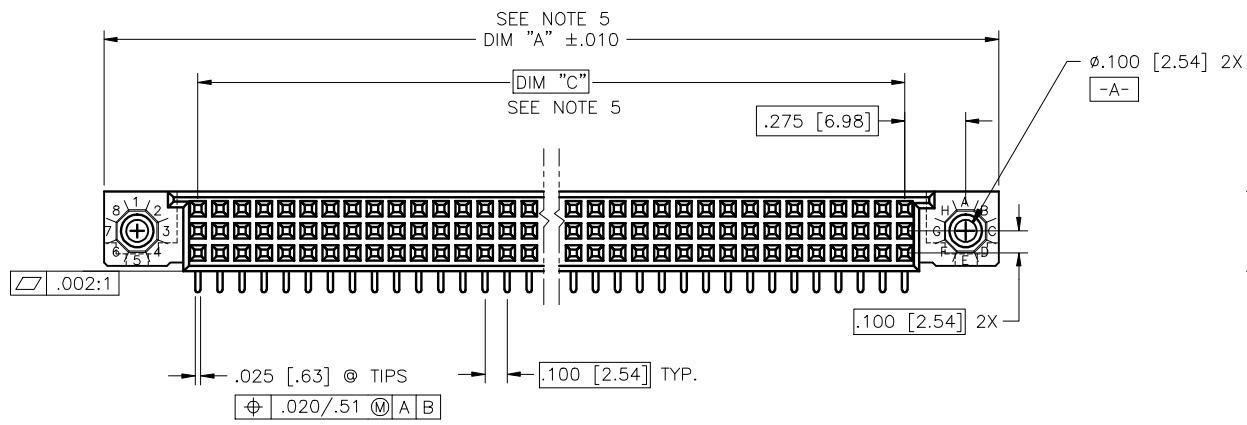
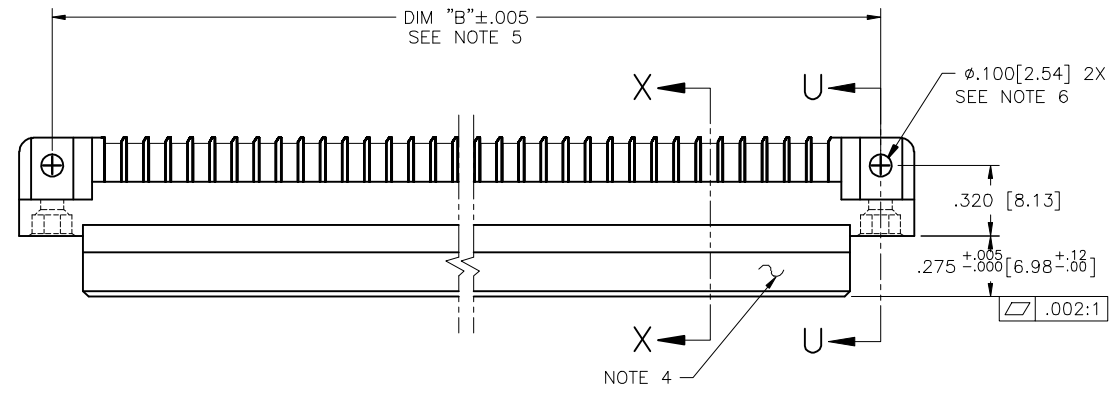
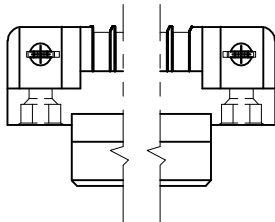

SECTION U-U

SPECIAL FEATURE OPTION "A"
SEE NOTE 6

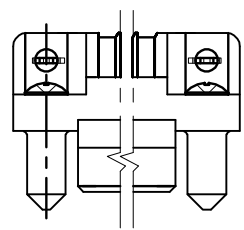

SECTION U-U

SPECIAL FEATURE OPTION "B"
SEE NOTE 6

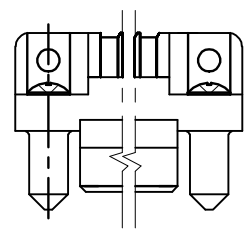

SECTION U-U

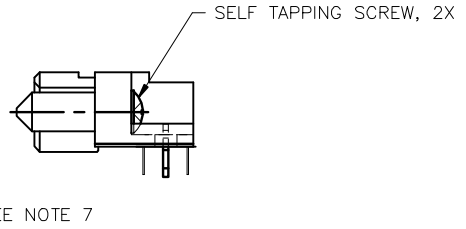
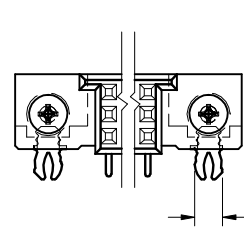

SPECIAL FEATURE OPTION "C"
SEE NOTE 6

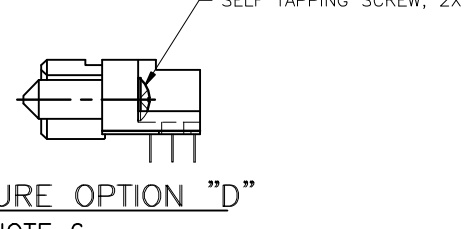
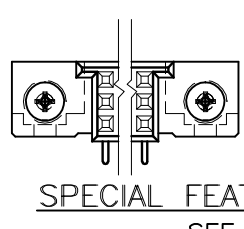

SPECIAL FEATURE OPTION "D"
SEE NOTE 6

mat'l. code NOTE 3				surface ISO 1302	tolerance ISO 406 ISO 1101	projection	product family HPC
ltr	ecn no	dr	date	tolerances unless otherwise specified		INCH/MM	title 3 ROW R/A RECEPTACLE SOLDER TO BOARD, 0 G.P.
R				angles	linear		
						scale 1:1	dwg no
				dr	G.PETERS	6/5/96	sheet 3 of 5 size
				engr	S.CLARK	6/3/95	50294
				chr	S.CLARK	6/5/95	A3
				appd	S.CLARK	6/5/95	type
sheet	revision						Product Customer Drawing
index	sheet						

PRODUCT NUMBER NOTE 1 AND 2	NUMBER OF POSITIONS SEE NOTE 2	TAIL LENGTH ±.010/0.25	SPECIAL FEATURES SEE NOTE 6	TAIL PLATING	CONTACT PLATING SEE NOTE 10
50294-1YYYY	YYY	.125/3.18	NONE	TIN-LEAD	30μ"/0.76μ Au
50294-1YYYEA	YYY	.125/3.18	"A"		30μ"/0.76μ Au
50294-1YYYEB	YYY	.125/3.18	"B"		30μ"/0.76μ Au
50294-1YYYEC	YYY	.125/3.18	"C"		30μ"/0.76μ Au
50294-1YYYED	YYY	.125/3.18	"D"		30μ"/0.76μ Au
50294-1YYYYF	YYY	.145/3.68	NONE		30μ"/0.76μ Au
50294-1YYYFB	YYY	.145/3.68	"B"		30μ"/0.76μ Au
50294-1YYYFC	YYY	.145/3.68	"C"		30μ"/0.76μ Au
50294-1YYYFD	YYY	.145/3.68	"D"		30μ"/0.76μ Au
50294-1YYYYH	YYY	.180/4.57	NONE		30μ"/0.76μ Au
50294-1YYYYHB	YYY	.180/4.57	"B"		30μ"/0.76μ Au
50294-1YYYYHC	YYY	.180/4.57	"C"		30μ"/0.76μ Au
50294-1YYYYHD	YYY	.180/4.57	"D"		30μ"/0.76μ Au
50294-3YYYYE	YYY	.125/3.18	NONE		50μ"/1.27μ Au
50294-3YYYEA	YYY	.125/3.18	"A"		50μ"/1.27μ Au
50294-3YYYEB	YYY	.125/3.18	"B"		50μ"/1.27μ Au
50294-3YYYEC	YYY	.125/3.18	"C"		50μ"/1.27μ Au
50294-3YYYED	YYY	.125/3.18	"D"		50μ"/1.27μ Au
50294-3YYYYF	YYY	.145/3.68	NONE		50μ"/1.27μ Au
50294-3YYYFB	YYY	.145/3.68	"B"		50μ"/1.27μ Au
50294-3YYYFC	YYY	.145/3.68	"C"		50μ"/1.27μ Au
50294-3YYYFD	YYY	.145/3.68	"D"		50μ"/1.27μ Au
50294-3YYYYH	YYY	.180/4.57	NONE		50μ"/1.27μ Au
50294-3YYYYHB	YYY	.180/4.57	"B"		50μ"/1.27μ Au
50294-3YYYYHC	YYY	.180/4.57	"C"		50μ"/1.27μ Au
50294-3YYYYHD	YYY	.180/4.57	"D"	TIN-LEAD	50μ"/1.27μ Au

PRODUCT NUMBER NOTE 1 AND 2	NUMBER OF POSITIONS SEE NOTE 2	TAIL LENGTH ±.010/0.25	SPECIAL FEATURES SEE NOTE 6	TAIL PLATING	CONTACT PLATING SEE NOTE 10
50294-1YYYYELF	YYY	.125/3.18	NONE	TIN	30μ"/0.76μ Au
50294-1YYYEALF	YYY	.125/3.18	"A"		30μ"/0.76μ Au
50294-1YYYEBLF	YYY	.125/3.18	"B"		30μ"/0.76μ Au
50294-1YYYECLF	YYY	.125/3.18	"C"		30μ"/0.76μ Au
50294-1YYYEDLF	YYY	.125/3.18	"D"		30μ"/0.76μ Au
50294-1YYYYFLF	YYY	.145/3.68	NONE		30μ"/0.76μ Au
50294-1YYYFBLF	YYY	.145/3.68	"B"		30μ"/0.76μ Au
50294-1YYYFCLF	YYY	.145/3.68	"C"		30μ"/0.76μ Au
50294-1YYYFDLF	YYY	.145/3.68	"D"		30μ"/0.76μ Au
50294-1YYYYHLF	YYY	.180/4.57	NONE		30μ"/0.76μ Au
50294-1YYYYHBLF	YYY	.180/4.57	"B"		30μ"/0.76μ Au
50294-1YYYYHCLF	YYY	.180/4.57	"C"		30μ"/0.76μ Au
50294-1YYYYHDLF	YYY	.180/4.57	"D"		30μ"/0.76μ Au
50294-3YYYYELF	YYY	.125/3.18	NONE		50μ"/1.27μ Au
50294-3YYYEALF	YYY	.125/3.18	"A"		50μ"/1.27μ Au
50294-3YYYEBLF	YYY	.125/3.18	"B"		50μ"/1.27μ Au
50294-3YYYECLF	YYY	.125/3.18	"C"		50μ"/1.27μ Au
50294-3YYYEDLF	YYY	.125/3.18	"D"		50μ"/1.27μ Au
50294-3YYYYFLF	YYY	.145/3.68	NONE		50μ"/1.27μ Au
50294-3YYYFBLF	YYY	.145/3.68	"B"		50μ"/1.27μ Au
50294-3YYYFCLF	YYY	.145/3.68	"C"		50μ"/1.27μ Au
50294-3YYYFDLF	YYY	.145/3.68	"D"		50μ"/1.27μ Au
50294-3YYYYHLF	YYY	.180/4.57	NONE		50μ"/1.27μ Au
50294-3YYYYHBLF	YYY	.180/4.57	"B"		50μ"/1.27μ Au
50294-3YYYYHCLF	YYY	.180/4.57	"C"		50μ"/1.27μ Au
50294-3YYYYHDLF	YYY	.180/4.57	"D"	TIN	50μ"/1.27μ Au

TABLE CONTINUED ON SHEET 5

mat'l. code NOTE 3				surface ISO 1302	tolerance ISO 406 ISO 1301	projection FIRST ANGLE	product family HPC	
ltr	ecn no	dr	date	tolerances unless otherwise specified			title	
R				angles	linear	XX±.01/XX±0.3 XXX±.005/XXX±0.13 XXXX±.0020/XXXX±0.05	3 ROW R/A RECEPTACLE SOLDER TO BOARD, 0 G.P.	
				0'±2'			scale 1:1	
				dr	G.PETERS	6/5/96	dwg no sheet 4 of 5 size	
				engr	S.CLARK	6/3/95	50294 A3	
				chr	S.CLARK	6/5/95	type Product Customer Drawing	
				appd	S.CLARK	6/5/95		
sheet	revision							
index	sheet							

PRODUCT NUMBER NOTE 1 AND 2	NUMBER OF POSITIONS SEE NOTE 2	TAIL LENGTH ±.010/0.25	SPECIAL FEATURES SEE NOTE 6	TAIL PLATING	CONTACT PLATING SEE NOTE 10
50294-5YYYE	YYY	.125/3.18	NONE	TIN/LEAD	30μ"/0.76μ GXT
50294-5YYYELF	YYY	.125/3.18	NONE	TIN	
50294-5YYYEA	YYY	.125/3.18	"A"	TIN/LEAD	
50294-5YYYEALF	YYY	.125/3.18	"A"	TIN	
50294-5YYYEB	YYY	.125/3.18	"B"	TIN/LEAD	
50294-5YYYEBLF	YYY	.125/3.18	"B"	TIN	
50294-5YYYEC	YYY	.125/3.18	"C"	TIN/LEAD	
50294-5YYYECLF	YYY	.125/3.18	"C"	TIN	
50294-5YYYED	YYY	.125/3.18	"D"	TIN/LEAD	
50294-5YYYEDLF	YYY	.125/3.18	"D"	TIN	
50294-5YYYF	YYY	.145/3.68	NONE	TIN/LEAD	
50294-5YYYFLF	YYY	.145/3.68	NONE	TIN	
50294-5YYYFB	YYY	.145/3.68	"B"	TIN/LEAD	
50294-5YYYFBLF	YYY	.145/3.68	"B"	TIN	
50294-5YYYFC	YYY	.145/3.68	"C"	TIN/LEAD	
50294-5YYYFCLF	YYY	.145/3.68	"C"	TIN	
50294-5YYYFD	YYY	.145/3.68	"D"	TIN/LEAD	
50294-5YYYFDLF	YYY	.145/3.68	"D"	TIN	
50294-5YYYH	YYY	.180/4.57	NONE	TIN/LEAD	
50294-5YYYHLF	YYY	.180/4.57	NONE	TIN	
50294-5YYYHB	YYY	.180/4.57	"B"	TIN/LEAD	
50294-5YYYHBLF	YYY	.180/4.57	"B"	TIN	
50294-5YYYHC	YYY	.180/4.57	"C"	TIN/LEAD	
50294-5YYYHCLF	YYY	.180/4.57	"C"	TIN	
50294-5YYYHD	YYY	.180/4.57	"D"	TIN/LEAD	
50294-5YYYHDLF	YYY	.180/4.57	"D"	TIN	30μ"/0.76μ GXT

mat'l. code NOTE 3				surface ISO 1902	tolerance ISO 406 ISO 1101	projection 	product family HPC
ltr	ecn no	dr	date	tolerances unless otherwise specified			title 3 ROW R/A RECEPTACLE SOLDER TO BOARD, 0 G.P.
R				angles	linear		
				0°±2'	XXX±.01/XX±0.3 XXX±.006/XX±0.13 XXX±.0020/XXX±0.06	scale 1:1	
				dr	G.PETERS	6/5/96	dwg no
				engr	S.CLARK	6/3/95	sheet 5 of 5
				chr	S.CLARK	6/5/95	size
				appd	S.CLARK	6/5/95	A3
sheet	revision						type
index	sheet						Product Customer Drawing

Mouser Electronics

Authorized Distributor

Click to View Pricing, Inventory, Delivery & Lifecycle Information:

FCI:

[50294-1165H](#) [50294-5048E](#) [50294-1150ED](#) [50294-1150EDLF](#) [50294-5156ELF](#)