

## HEYCO



## Heyco®-Tite EMC Brass Liquid Tight Cordgrips

EMC Nickel-Plated Brass with Contact Sleeve

*The Ultimate in Liquid Tight Strain Relief Protection*

- **Ideal for applications where Electromagnetic Compatibility (EMC) is needed.**
- IP 68 rated.
- Nickel-plated finish over brass provides excellent corrosion resistance and durability.
- Excellent 360° shield contact with contact sleeve due to braided shield which runs into the gland.
- Combination of the sealing insert and the contact socket guarantees a constant contact quality with minimal transfer impedance.
- Inner cable protection.
- Long thread for use in standard or thick panels.
- Multiple sizes for flexible cord diameters ranging from .10" (2,5 mm) to 1.00" (25,5 mm).
- For use in clearance or threaded holes.
- Cordgrips are made of nickel plated brass and the gland is made of TPE.
- Temperature range of -40°F (-40°C) to 212°F (100°C).
- EMC locknuts available. See page 3-38.

CABLE DIA. RANGE				PART NO.	THREAD SIZE		PART DIMENSIONS							
Minimum		Maximum					A Clearance Hole Dia.		B Max. O.A. Length		C Thread Length		D Wrenching Nut Flat Size	
in.	mm.	in.	mm.				in.	mm.	in.	mm.	in.	mm.	in.	mm.

### PG Hubs

.18	4,5	.24	6,0	<b>4600</b>	PG7	cRV <sub>US</sub>	.50	12,7	1.06	27,0	.39	10,0	.59	15,0
.24	6,0	.30	7,5	<b>4641</b>										
.24	6,0	.32	8,0	<b>4644</b>	PG9	cRV <sub>US</sub>	.61	15,5	1.18	30,0	.39	10,0	.71	18,0
.32	8,0	.39	10,0	<b>4645</b>										
.22	5,5	.33	8,5	<b>4647</b>	PG11	cRV <sub>US</sub>	.75	19,0	1.22	31,0	.39	10,0	.83	21,0
.33	8,5	.47	12,0	<b>4648</b>										
.32	8,0	.43	11,0	<b>4650</b>	PG13.5	cRV <sub>US</sub>	.83	21,1	1.22	31,0	.39	10,0	.94	24,0
.43	11,0	.55	14,0	<b>4651</b>										
.32	8,0	.43	11,0	<b>4653</b>	PG16	cRV <sub>US</sub>	.91	23,1	1.22	31,0	.39	10,0	.94	24,0
.43	11,0	.55	14,0	<b>4654</b>										
.51	13,0	.63	16,0	<b>4656</b>	PG21	cRV <sub>US</sub>	1.14	29,0	1.45	37,0	.47	12,0	1.18	30,0
.63	16,0	.75	19,0	<b>4657</b>										
.75	19,0	.91	23,0	<b>4659</b>	PG29	cRV <sub>US</sub>	1.48	37,6	1.61	41,0	.47	12,0	1.50	38,0
.91	23,0	1.00	25,5	<b>4660</b>										

### Metric Hubs

.10	2,5	.14	3,5	<b>4613</b>	M8 x 1,25	cRV <sub>US</sub>	.33	8,4	.94	24,0	.39	10,0	.43	11,0
.12	3,0	.16	4,0	<b>4614</b>										
.12	3,0	.16	4,0	<b>4615</b>	M10 x 1,5	cRV <sub>US</sub>	.41	10,4	.98	25,0	.39	10,0	.51	13,0
.16	4,0	.24	6,0	<b>4616</b>										
.18	4,5	.24	6,0	<b>4618</b>	M12 x 1,5	cRV <sub>US</sub>	.50	12,5	1.06	27,0	.39	10,0	.59	15,0
.24	6,0	.30	7,5	<b>4619</b>										
.24	6,0	.32	8,0	<b>4608</b>	M16 x 1,5*	cRV <sub>US</sub>	.64	16,5	.98	25,0	.20	5,0	.71	18,0
.32	8,0	.39	10,0	<b>4607</b>	M16 x 1,5*									
.24	6,0	.32	8,0	<b>4622</b>	M16 x 1,5	cRV <sub>US</sub>	.64	16,5	1.18	30,0	.39	10,0	.71	18,0
.32	8,0	.39	10,0	<b>4623</b>	M16 x 1,5									
.32	8,0	.43	11,0	<b>4625</b>	M20 x 1,5	cRV <sub>US</sub>	.80	20,5	1.22	31,0	.39	10,0	.94	24,0
.43	11,0	.55	14,0	<b>4626</b>	M20 x 1,5									
.51	13,0	.63	16,0	<b>4628</b>	M25 x 1,5	cRV <sub>US</sub>	1.00	25,4	1.41	36,0	.43	11,0	1.18	30,0
.63	16,0	.75	18,0	<b>4629</b>	M25 x 1,5									
.71	18,0	.83	21,0	<b>4631</b>	M32 x 1,5	cRV <sub>US</sub>	1.27	32,3	1.65	42,0	.51	13,0	1.42	36,0
.83	21,0	.98	25,0	<b>4632</b>										

### Metric Hub, High Temperature\*

.024	6,0	.032	8,0	<b>4609</b>	M16 x 1,5	cRV <sub>US</sub>	.64	16,3	.99	25,1	.20	5,1	.71	18,0
------	-----	------	-----	-------------	-----------	-------------------	-----	------	-----	------	-----	-----	-----	------

\*Short .197" (5,0 mm) thread

\*\*Special sealing gland rated to 200°C (392°F)

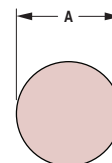
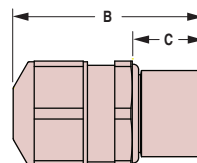
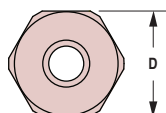

Quick  
Specs

Material	Nickel-Plated Brass W/TPE Sealing Gland		
Certifications		Recognized under the Component Program of Underwriters' Laboratories File E51579 to both Canadian and U.S. requirements	
Temperature Rating	-40°F (-40°C) to 212°F (100°C)		
IP Rating	IP 68, IP 69K		

# Mouser Electronics

Authorized Distributor

Click to View Pricing, Inventory, Delivery & Lifecycle Information:

[Heyco:](#)

[4600](#) [4648](#) [4660](#) [4657](#) [4644](#) [4647](#) [4613](#) [4629](#) [4653](#) [4641](#) [4659](#) [4623](#) [4645](#) [4631](#) [4656](#) [4619](#) [4651](#) [4622](#)  
[4626](#) [4618](#) [4615](#) [4616](#) [4628](#) [4650](#) [4654](#) [4625](#) [4614](#) [4632](#)