

PART NAME	MINIBOX	PART No.	CU-2100-B TO CU-3011-A	REV. DATE	7-11-12
-----------	---------	----------	------------------------	-----------	---------

MATERIAL:

COVER & BASE - 0.040 ALUMINUM

FINISH:

COVER & BASE - SUFFIX "A" NATURAL
 - SUFFIX "B" SMOOTH GRAY

EACH UNIT SLIPS TOGETHER AND MAY BE JOINED BY EITHER BUILT-IN SNAP LOCK OR #6 SHEET METAL SCREWS (PROVIDED).

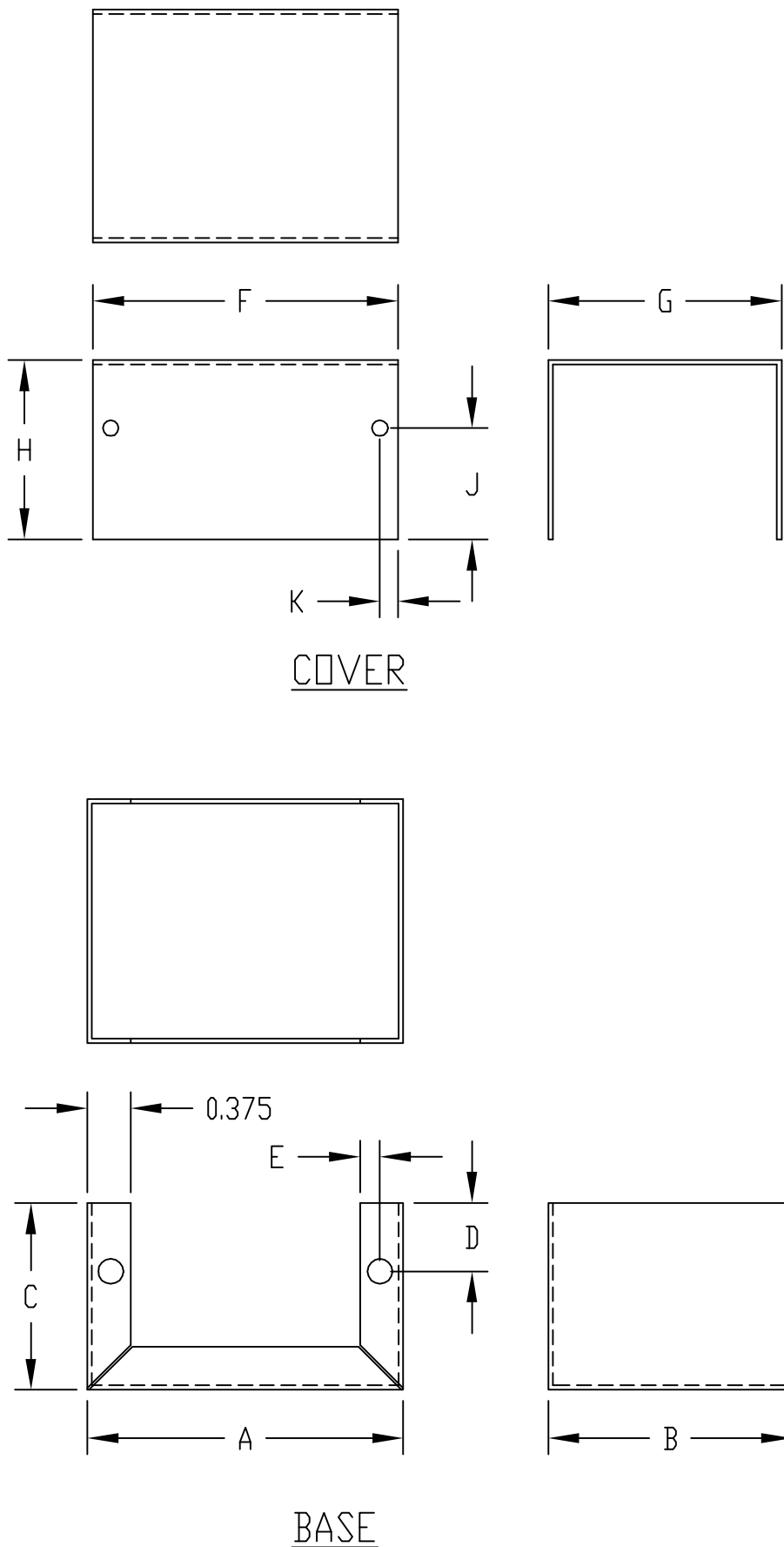

PART No.		BASE					COVER				
PAINTED	NATURAL	A	B	C	D	E	F	G	H	J	K
CU-2100-B	CU-3000-A	2.750	2.125	1.625	0.594	0.172	2.656	2.031	1.562	0.968	0.156
CU-2101-B	CU-3001-A	3.250	2.125	1.625	0.594	0.172	3.156	2.031	1.562	0.968	0.156
CU-2102-B	CU-3002-A	4.000	2.125	1.625	0.594	0.172	3.906	2.031	1.562	0.968	0.156
CU-2103-B	CU-3003-A	4.000	2.250	2.250	1.218	0.172	3.906	2.156	2.188	0.968	0.156
CU-2104-B	CU-3004-A	5.000	2.250	2.250	1.218	0.172	4.906	2.156	2.188	0.968	0.156
CU-2105-B	CU-3005-A	5.000	4.000	3.000	0.844	0.172	4.906	3.906	2.938	2.094	0.156
CU-2106-B	CU-3006-A	5.250	3.000	2.125	1.094	0.172	5.156	2.906	2.062	0.968	0.156
CU-2107-B	CU-3007-A	6.000	5.000	4.000	1.844	0.172	5.906	4.906	3.938	2.094	0.156
CU-2108-B	CU-3008-A	7.000	5.000	3.000	0.836	0.172	6.875	4.875	2.929	2.094	0.141
CU-2109-B	CU-3009-A	8.000	6.000	3.500	1.336	0.156	7.875	5.875	3.429	2.094	0.156
CU-2110-B	CU-3010-A	10.000	6.000	3.500	1.336	0.172	9.875	5.875	3.429	2.094	0.141
CU-2111-B	CU-3011-A	12.000	7.000	4.000	1.836	0.172	11.875	6.875	3.929	2.094	0.141