

BNC5-J-P-GN-ST-TH2D

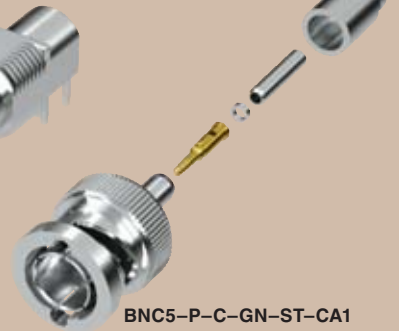

BNC5-J-P-GN-RA-BH2D



BNC5-P-C-GN-ST-CA1

BNC5 SERIES

50Ω BNC JACKS & PLUGS

Mates with:
RF174, RF178, RF316

SPECIFICATIONS

For complete specifications and recommended PCB layouts see www.samtec.com?BNC5-THD or www.samtec.com?BNC5-BHD

Shell Material:

Zinc

Contact Material:

Phosphor Bronze

Insulator Material:

PTFE

Impedance:

50Ω

Frequency Range:

0~4 GHz

V.S.W.R.:

Testing Now!

Working Voltage:

Testing Now!

Dielectric Withstanding:

Testing Now!

Contact Resistance:

Center Contact: Testing Now!

Outer Contact: Testing Now!

Insulator Resistance:

Testing Now!

Operating Temp Range:

-65°C to +125°C

Note: 75Ω version available.
See BNC7T Series.

BNC5

GENDER

TYPE

PLATING

ORIENTATION

TERMINATION

—J
= Jack

—P
= PCB
Mount

—GN
= 10μ"
(0,25 μm)
Gold on
contact,
Nickel on
body

—ST
= Straight
(—TH2D only)

—RA
= Right Angle
(—BH2D only)

—TH2D
= Die Cast
Through-Hole
(—ST only)

—BH2D
= Die Cast
Bulkhead
Through-Hole
(—RA only)

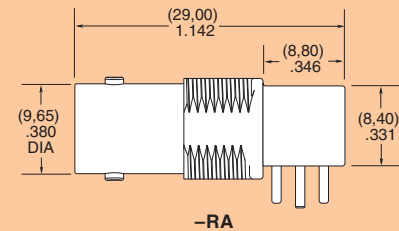
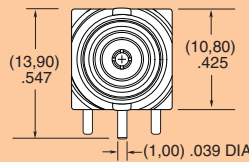
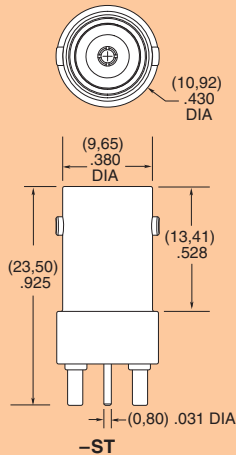

SPECIFICATIONS

For complete specifications and assembly instructions see www.samtec.com?BNC5-CA or www.samtec.com?BNC5-BH

Shell Material:

Brass

Contact Material:

Brass (-P)

Copper Alloy (-J)

Center Contact:

Soldered

Outer Contact:

Crimped

Impedance:

50Ω

Frequency Range:

0~4 GHz

(Cable dependent)

V.S.W.R.:

1.3 max

Working Voltage:

500 Vrms max

Dielectric Withstanding:

1500 Vrms min

Contact Resistance:

Center Contact: 3mΩ max

Outer Contact: 2mΩ max

Insulator Resistance:

5,000 MΩ min

Operating Temp Range:

-65°C to +125°C

BNC5

GENDER

TYPE

PLATING

ORIENTATION

TERMINATION

—P
= Plug

—C
= Cable

—GN
= 10μ"
(0,25 μm)
Gold on
contact,
Nickel on
body

—ST
= Straight

—CA1
= RG 174 &
RG 316 Cable
(—P only)

—CA2
= RG 178 Cable
(—P only)

—BH1
= Bulkhead,
RG 174 &
RG 316 Cable
(—J only)

—BH2
= Bulkhead,
RG 178 Cable
(—J only)

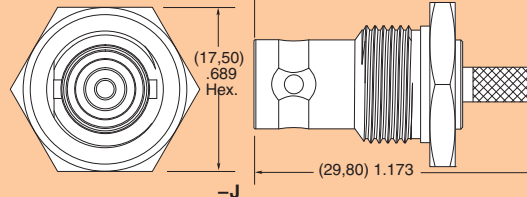
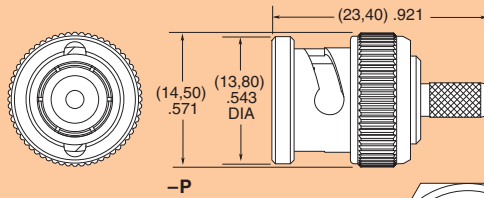

Supplied with pins, washers, nuts, gaskets and ferrules. See website for dimensions.

Due to technical progress, all designs, specifications and components are subject to change without notice.

WWW.SAMTEC.COM