



CONTACT • REQUEST A QUOTE

PRODUCTS

RESOURCES

COMPANY

PART NUMBER SEARCH

search site



« Clamping Knobs

Five Arm (Star) Clamping Knobs

Series #2980

Clamping knobs are available in different materials, thermoplastic, and phenolic for a multiple of applications.

A variety of shapes and diameters with plain, tapped bosses or with studs are available with standard threads to fit the application.

Perfect for the industrial machinery, medical, general equipment and other industrial applications.

Knobs can be decorated or customized to your specific need.

Davies Molding is pleased to introduce our series of soft touch knobs and handles. Our soft touch parts are molded with a soft thermoplastic overmolded "rubber" top with a tough thermoplastic body underneath. The soft feel of the knob provides a comfortable touch with a sure grip.

Colors available upon request.

Please note: Not all variations available are listed below. Please [contact Customer Service](#) to inquire about all available options.



REQUEST CAD DRAWING

REQUEST A QUOTE

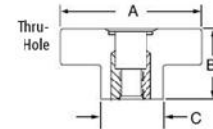
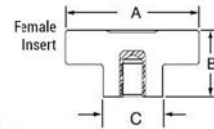
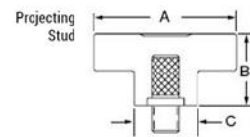

Item #	Diameter A	Height B	Hub C	Material Type	Mounting Diameter	Mounting Type	Thread Length/Depth	Color
2980	2.25	0.78	0.84	Thermoplastic	1/4-20	Thru-Hole		BLACK
2980-A	2.25	0.78	0.84	Thermoplastic	5/16-18	Thru-Hole		BLACK
2980-B	2.25	0.78	0.84	Thermoplastic	3/8-16	Thru-Hole		BLACK
2980-C	2.25	0.78	0.84	Thermoplastic	3/8-24	Thru-Hole		BLACK
2980-E	2.25	0.78	0.84	Thermoplastic	5/16-18	Projecting Stud	0.75	BLACK
2980-F	2.25	0.78	0.84	Thermoplastic	3/8-16	Thru-Hole		BLACK
2980-P	2.25	0.78	0.84	Thermoplastic	3/8-16	Projecting Stud	1	BLACK
2980-S	2.25	0.78	0.84	Thermoplastic	3/8-16	Thru-Hole		BLACK
2980-U	2.25	0.78	0.84	Thermoplastic	3/8-16	Projecting Stud	1.5	BLACK
2980-W	2.25	0.78	0.84	Thermoplastic	3/8-16	Projecting Stud	1.75	BLACK
2980-X	2.25	0.78	0.84	Thermoplastic	1/4-20	Projecting Stud	1	BLACK
2980AA	2.25	0.78	0.84	Thermoplastic	3/8-16	Projecting Stud	1.25	BLACK
2980AC	2.25	0.78	0.84	Thermoplastic	1/4-20	Female Insert	0.375	BLACK
2980AD	2.25	0.78	0.84	Thermoplastic	5/16-18	Female Insert	0.50	BLACK
2980AE	2.25	0.78	0.84	Thermoplastic	3/8-16	Female Insert	0.50	BLACK

2980AH	2.25	0.78	0.84	Thermoplastic	3/8-24	Thru-Hole		BLACK
2980AK	2.25	0.78	0.84	Thermoplastic	1/4-20	Thru-Hole		BLACK
2980AL	2.25	0.78	0.84	Thermoplastic	5/16-18	Thru-Hole		BLACK
2980AP	2.25	0.78	0.84	Thermoplastic	1/4-20	Projecting Stud	1.75	BLACK
2980AS	2.25	0.78	0.84	Thermoplastic	5/16-18	Thru-Hole		BLACK
2980AU	2.25	0.78	0.84	Thermoplastic	1/4-20	Projecting Stud	0.50	BLUE
2980BA	2.25	0.78	0.84	Thermoplastic	3/8-16	Projecting Stud	2.25	BLACK
2980BB	2.25	0.78	0.84	Thermoplastic	5/16-18	Projecting Stud	1	BLACK
2980BD	2.25	0.78	0.84	Thermoplastic	5/16-18	Projecting Stud	0.75	WHITE
2980BE	2.25	0.78	0.84	Thermoplastic	1/4-20	Projecting Stud	1.5	BLACK
2980BM	2.25	0.78	0.84	Thermoplastic	3/8-16	Projecting Stud	1	BLACK
2980BN	2.25	0.78	0.84	Thermoplastic	3/8-16	Female Insert	0.50	WHITE
2980BP	2.25	0.78	0.84	Thermoplastic	1/4-20	Projecting Stud	1	BLACK
2980BQ	2.25	0.78	0.84	Thermoplastic	1/4-20	Thru-Hole		GREEN
2980BR	2.25	0.78	0.84	Thermoplastic	5/16-18	Thru-Hole		BLACK
2980BT	2.25	0.78	0.84	Thermoplastic	1/4-20	Projecting Stud	1.5	BLACK
2980BU	2.25	0.78	0.84	Thermoplastic	5/16-18	Projecting Stud	0.75	BLACK
2980BY	2.25	0.78	0.84	Thermoplastic	5/16-18	Projecting Stud	1.5	BLACK

PRODUCTS

- Knobs
- Handles
- Leveling Feet
- Latches
- Hinges
- Indexing Plungers
- Electronic Enclosures
- Two-Shot / Soft Touch
- Frac Balls
- Custom Molding

RESOURCES

- Engineering Specifications
- Distributor Listing
- Sales Representative Listing

COMPANY

- About Us
- Capabilities
- Certifications
- Contact Us
- Blog
- Careers

QUESTIONS ?

[select your industry]
▼

questions / comments

Copyright © 2016 Davies Molding, LLC. All Rights Reserved.
 350 Kehoe Blvd. | Carol Stream, IL 60188-1818 | Phone: (800) 554-9208 | Fax: (630) 510-9944