

MALE PCB PINS

SOLDER TERMINALS VARIOUS TYPES

2709

2709-X-07-XX-00-00-07-0

Swage mount in .116 hole

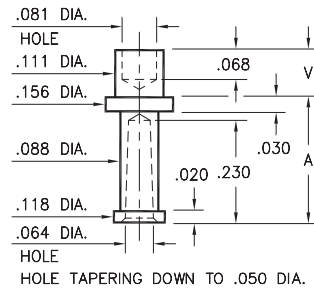

Basic Part Number	Board Thickness	Length V	Length A
2709-2	.062	.109	.281
2709-3	.094	.141	.250

8602

8602-1-00-XX-00-00-07-0

Square press-fit in .032 plated through-hole

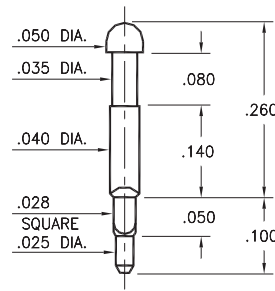

2115

2115-2-00-XX-00-00-07-0

Swage mount in .043 hole

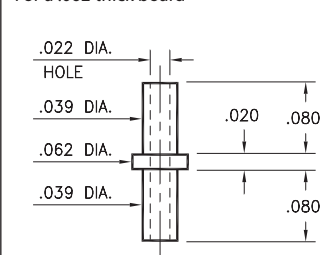

2326

2326-2-00-XX-00-00-07-0

Swage mount in .055 hole
For a .062 thick board

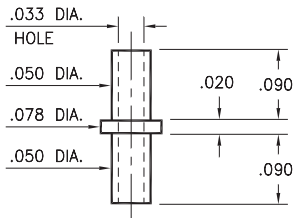

8831

8831-0-00-XX-00-00-03-0

Press-fit in .057 mounting hole

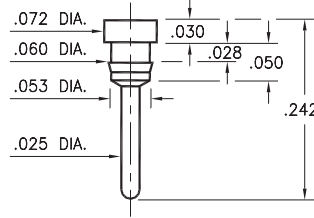

8835

8835-0-00-XX-00-00-03-0

Press-fit in .057 mounting hole

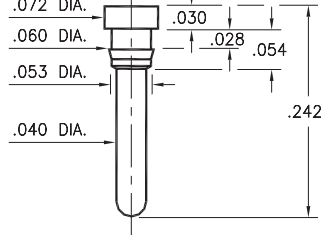

8836

8836-0-00-XX-00-00-03-0

Press-fit in .075 mounting hole

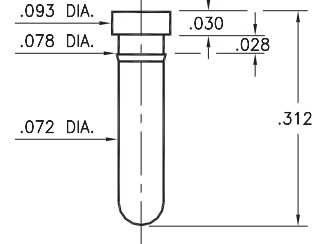

0912/7912

X912-0-00-XX-00-00-03-0

Press-fit in .057 mounting hole

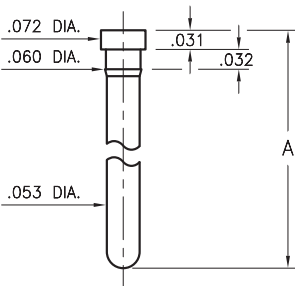

Basic Part Number	Pin Length A
0912-0	.313
7912-0	.510

SPECIFICATIONS:

Pin Material: Brass Alloy 360, 1/2 Hard
(Swage pins are annealed)

Dimensions: Inches

Tolerances On: Lengths: $\pm .005$
Diameters: $\pm .002$
Angles: $\pm 2^\circ$



ORDER CODE: XXXX - X - XX - XX - 00 - 00 - XX - 0

BASIC PART #

SPECIFY PIN FINISH:

- 01 200 μ " TIN/LEAD OVER NICKEL
- ◆ 80 200 μ " TIN OVER NICKEL (RoHS)
- ◆ 44 300 μ " SILVER OVER COPPER (RoHS)
- 50 300 μ " ELECTRO-SOLDER (60/40 SnPb)



Mouser Electronics

Authorized Distributor

Click to View Pricing, Inventory, Delivery & Lifecycle Information:

Mill-Max:

[8835-0-00-01-00-00-03-0](#) [2709-3-07-01-00-00-07-0](#) [2709-3-07-50-00-00-07-0](#) [2709-2-07-01-00-00-07-0](#) [2709-2-07-50-00-00-07-0](#) [2326-2-00-01-00-00-07-0](#) [2326-2-00-50-00-00-07-0](#) [2115-2-00-01-00-00-07-0](#) [2115-2-00-50-00-00-07-0](#)
[8831-0-00-80-00-00-03-0](#) [2709-3-07-80-00-00-07-0](#) [2709-2-07-80-00-00-07-0](#) [2115-2-00-44-00-00-07-0](#) [2326-2-00-44-00-00-07-0](#) [2709-2-07-44-00-00-07-0](#) [2709-3-07-44-00-00-07-0](#) [8602-1-00-44-00-00-07-0](#) [8835-0-00-00-00-00-03-0](#)
[2326-2-00-00-00-00-07-0](#) [2709-2-07-00-00-00-07-0](#) [8831-0-00-00-00-00-03-0](#) [8836-0-00-00-00-00-03-0](#) [2115-2-00-00-00-00-07-0](#) [8602-1-00-00-00-00-07-0](#) [2709-3-07-00-00-00-07-0](#)