

# Metal sleeve

Part no.: 21100-662

**Features:**

- Please consult the order table below for the number of required assembly parts



**Technical information:**

Description	Description	Qty/PU	Application
Metal sleeve, for form hole 5.9 x 3.3, press-in	Stainless steel	100 piece	For shielded front panels

**Delivery comprises:**

Quantity required for IEEE-Plug-in units			
3 U		6 U	
< 8 HP	≥ 8 HP	< 8 HP	≥ 8 HP
1	3	–	2

Quantity required for plug-in units type 2 with extraction handle			
3 U		6 U	
< 8 HP	≥ 8 HP	< 8 HP	≥ 8 HP
2	4	–	–

Quantity required for plug-in units type 2 with fixed handle							
3 U				6 U			
unshielded		shielded		unshielded		shielded	
< 8 HP	≥ 8 HP	< 8 HP	≥ 8 HP	< 8 HP	≥ 8 HP	< 8 HP	≥ 8 HP
–	–	2	4	–	–	2	4

**Note:**

- Metal sleeves must be pressed into the front panels
- Not for front panel 2 HP

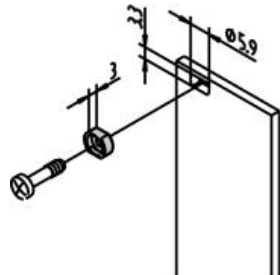
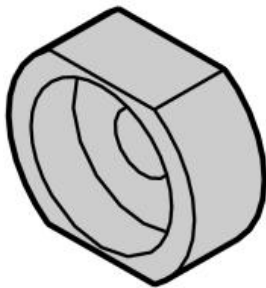

Front panel fixing

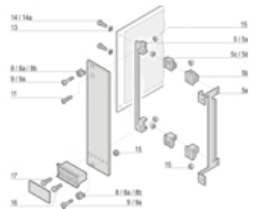

Item 8a, 3 U front panel mounting

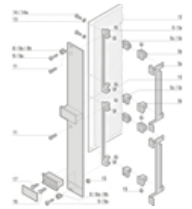

Item 8a, 6 U front panel mounting