

Plug-in units with IEL insertion/extraction handle for CompactPCI/ VME64x applications

Part no.: 20848-585

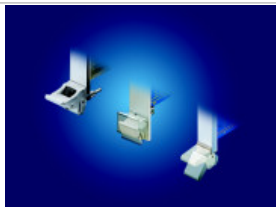

Features:

- To IEEE 1101.10 and IEC 60297-3-102
- Codable to IEC 60297-3-103
- Front panel shielded, without offset
- Suitable for insertion and extraction forces up to 700 N (per pair)
- designed for fitting of microswitches



Technical information:

Description	Height	Width
Front assembly	3 U	4 HP

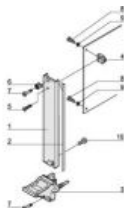

Dimension 3 / 6 U



Delivery comprises: kit

Item	Qty	Description
	3 U	
	<8 HP	
1	1	Front panel (U profile), Al, front anodised, rear conductive
2	1	EMC sealing (textile), Core: foam, Sleeve: textile cladding, CuNi coated
3	1	Handle with integrated alignment pin for perforated strip and guide rails, lever: plastic, PC, black, RAL 9005 Key: Plastic, PC, light grey, RAL 7035
4	1	Board support, die-cast zinc
5	1	Raised Pozidrive countersunk screw M2.5 x 8, St, nickel-plated
6	1	Sleeve, PA, grey
7	2	Pozidrive collar screw, M2.5 x 12.3, St, nickel-plated
8	2	Panhead screw with Torx/slot, M2.5 x 6, St, zinc-plated, self-locking
9	2	Washer A2.7, DIN 125, St, nickel-plated
10	1	Panhead screw with Torx, M2.5 x 7, St, nickel-plated