

Electronic housing - ME 22,5 F-UT GN - 2854131

Please be informed that the data shown in this PDF Document is generated from our Online Catalog. Please find the complete data in the user's documentation. Our General Terms of Use for Downloads are valid (<http://phoenixcontact.com/download>)



Component housing, length: 99 mm, with vents, Lower part, Cross connection: without bus connector, color: green, width: 22.5 mm, height: 84.8 mm, number of positions cross connector: not relevant

Why buy this product

- Item is from the ME product range
- Tool-free mounting
- Available in overall widths from 12.5 mm to 90 mm, modular extension is possible
- Inflammability class V0 according to UL 94
- Variety of connection technologies
- Can be mounted on the DIN rail
- Optional bus connector that is either integrated or mounted on the DIN rail

Key Commercial Data

Packing unit	1 STK
Minimum order quantity	10 STK
GTIN	
GTIN	4017918190163
Weight per Piece (excluding packing)	39.880 g
Custom tariff number	85369010
Country of origin	Germany

Technical data

General

Housing type	Component housing
Housing material	Polyamide

Electronic housing - ME 22,5 F-UT GN - 2854131

Technical data

General

Color (RAL)	green
-------------	-------

Ambient conditions

Ambient temperature (storage/transport)	-40 °C ... 70 °C
Ambient temperature (assembly)	-5 °C ... 100 °C
Ambient temperature (operation)	-40 °C ... 105 °C (depending on power dissipation)

Dimensions

Length	99 mm
Constructional height	84.8 mm
Width	22.5 mm
Depth	99 mm

Technical data

Power dissipation without gap	5.9 W
Power dissipation with 20 mm gap	11.5 W
Number of positions	16
	24

Standards and Regulations

Flammability rating according to UL 94	V0
--	----

Environmental Product Compliance

China RoHS	Environmentally friendly use period: unlimited = EFUP-e
	No hazardous substances above threshold values

Drawings

Electronic housing - ME 22,5 F-UT GN - 2854131

Dimensional drawing

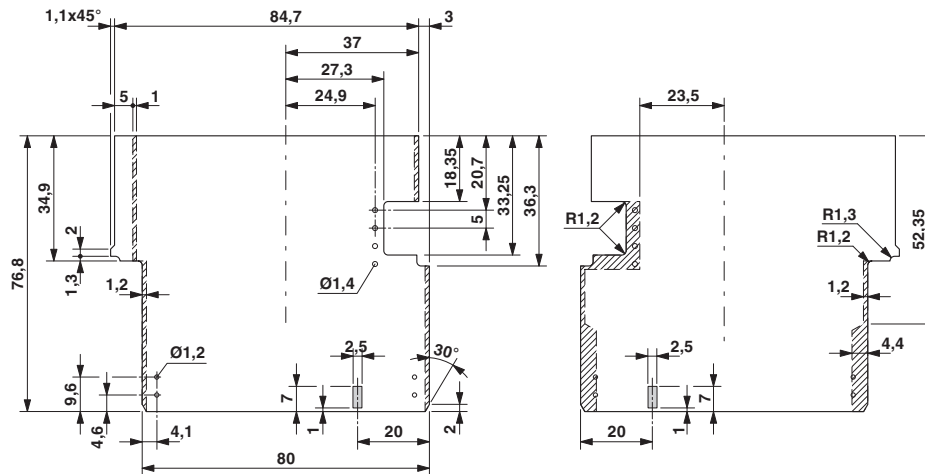

Dimensional drawing of the ME 22.5 flat... printed circuit board if the single-level upper part is used

Dimensional drawing

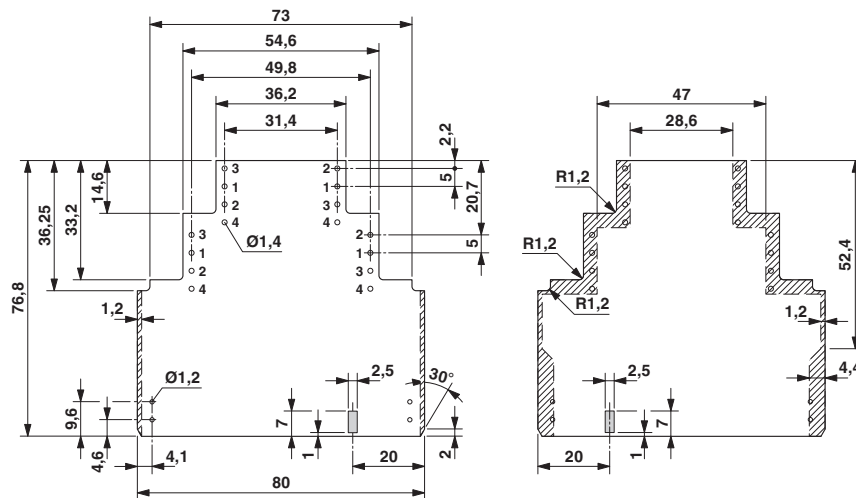

Dimensional drawing of the ME 22.5 flat... printed circuit board if the double level upper part is used

Electronic housing - ME 22,5 F-UT GN - 2854131

Dimensional drawing

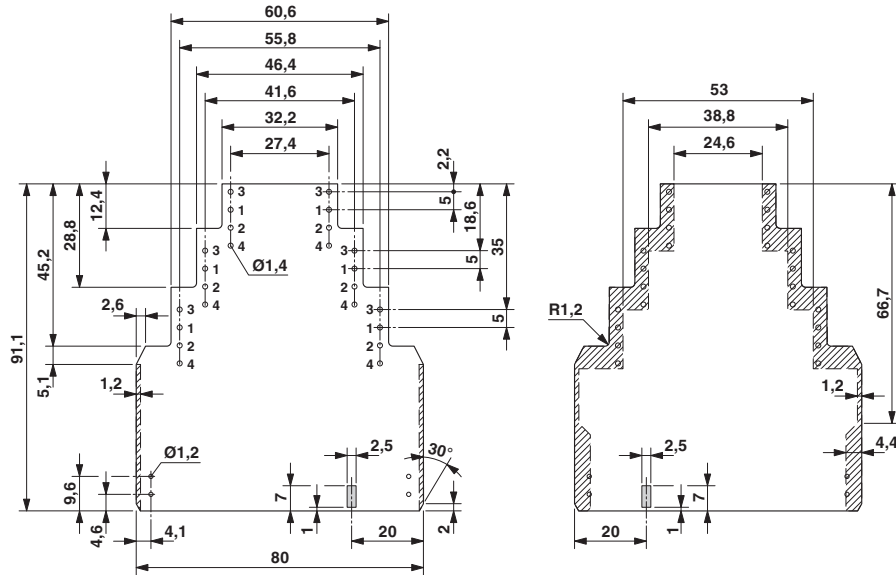

Dimensional drawing of the ME 22.5 flat... printed circuit board if the triple-level upper part is used

Classifications

eCl@ss

eCl@ss 4.0	27180401
eCl@ss 4.1	27180401
eCl@ss 5.0	27180506
eCl@ss 5.1	27180506
eCl@ss 6.0	27180802
eCl@ss 7.0	27182702
eCl@ss 8.0	27182702
eCl@ss 9.0	27182702

ETIM

ETIM 2.0	EC001031
ETIM 3.0	EC001031
ETIM 4.0	EC001031
ETIM 5.0	EC001031
ETIM 6.0	EC001031

UNSPSC

UNSPSC 6.01	31261501
-------------	----------

Electronic housing - ME 22,5 F-UT GN - 2854131

Classifications

UNSPSC

UNSPSC 7.0901	31261501
UNSPSC 11	31261501
UNSPSC 12.01	31261501
UNSPSC 13.2	31261501

Approvals

Approvals

Approvals

UL Recognized

Ex Approvals

Approval details

UL Recognized		http://database.ul.com/cgi-bin/XYV/template/LISEXT/1FRAME/index.htm	FILE E 240868
---------------	---	---	---------------

Accessories

Accessories

Mounting material

Electronic housing - ME LPZS - 2906911



Component housing

Necessary add-on products

Electronic housing - ME 22,5 F-UT GN - 2854131

Accessories

Electronic housing - ME 22,5 OT-1MSTBO GN - 2709558



Component housing, length: 99 mm, Upper part, color: green, width: 22.5 mm, height: 38.5 mm

Electronic housing - ME 22,5 OT-MSTBO GN - 2907169



Component housing, length: 99 mm, Upper part, color: green, width: 22.5 mm, height: 38.5 mm

Electronic housing - ME 22,5 OT-MKDSO GN - 2907172



Component housing, length: 99 mm, Upper part, color: green, width: 22.5 mm, height: 38.5 mm

Electronic housing - ME 22,5 OTU-MKDSO GN - 2278966



Component housing, length: 99 mm, Upper part, color: green, width: 22.5 mm, height: 38.5 mm

Electronic housing - ME 22,5 OT-3MSTBO GN - 2735962



Component housing, length: 99 mm, Upper part, color: green, width: 22.5 mm, height: 51.5 mm
