

Figure 1

1. INTRODUCTION

Insertion Tool 274260-2 is used to insert a MAG-MATE* FASTON* .187 tab terminal (for example, part number 62663-1) into a plastic terminal cavity housing for termination onto a magnet wire. Read these instructions before using the insertion tool.

NOTE *Dimensions in this instruction sheet are in metric units [with U.S. customary units in brackets]. Figures are not drawn to scale.*

Reasons for reissue of this instruction sheet are provided in Section 6, REVISION SUMMARY.

2. DESCRIPTION

The insertion tool features a grooved handle and a slotted jaw which holds the terminal in place during insertion. See Figure 1.

Insertion is accomplished by a variation of the insulation displacement technique — which is inserting a wire into a slotted beam to form a reliable electrical connection between the wire and terminal.

3. INSERTION PROCEDURE (Refer to Figure 1)

1. Place the jaw of the insertion tool over the tab of the terminal, making sure that the tab is fully seated in the terminal slot.

NOTE



The jaw adjustment screw must not be tight when inserting the terminal. There should be a slight drag between the terminal and the terminal slot.

2. Insert the magnet wire into the slot of the terminal cavity housing until it bottoms.
3. Align the insulation displacement slot of the terminal with the magnet wire, and push the terminal into the terminal cavity housing until the jaw of the insertion tool touches the top of the terminal cavity housing.
4. Pull the insertion tool from the terminal.

4. MAINTENANCE AND INSPECTION

4.1. Maintenance

The insertion tool requires little maintenance other than to ensure that it is clean and undamaged, and that no contaminants have become lodged in the terminal slot.

4.2. Inspection

The insertion tool should conform to the dimensions shown in Figure 2.

Regular inspections should be performed by quality control personnel. A record of scheduled inspections should remain with the tool or be supplied to personnel responsible for the tool.

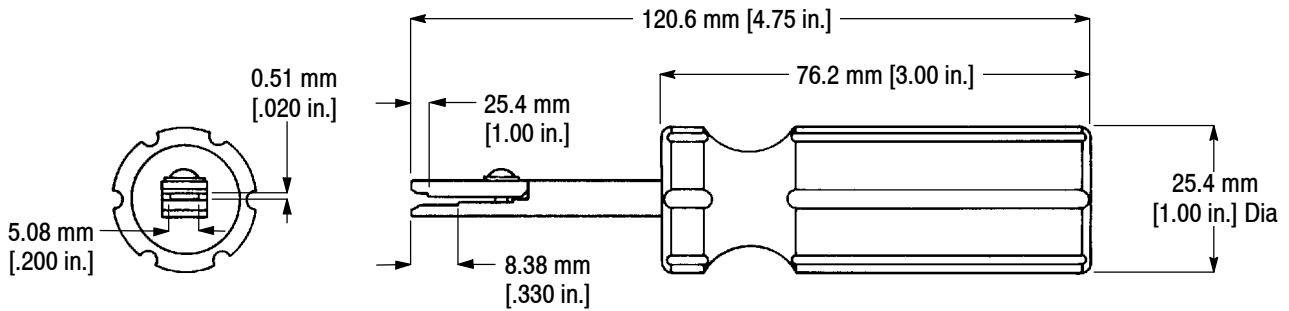

Figure 2

Inspection frequency should be based on amount of use, working conditions, operator training and skill, and established standards.

5. REPLACEMENT

Order replacement insertion tools through your representative, or call 1-800-526-5142, or send a facsimile of your purchase order to 717-986-7605, or write to:

CUSTOMER SERVICE (038-035)
 TYCO ELECTRONICS CORPORATION
 PO BOX 3608
 HARRISBURG PA 17105-3608

6. REVISION SUMMARY

Revisions to this instruction sheet include:

- Updated document to corporate requirements