

## Current transformer - PACT MCR-V2-4012- 70- 400-5A-1 - 2277129

Please be informed that the data shown in this PDF Document is generated from our Online Catalog. Please find the complete data in the user's documentation. Our General Terms of Use for Downloads are valid (<http://phoenixcontact.com/download>)



Window-type current transformer, 400 A AC primary current; 5 A AC secondary current; accuracy class 1; 7.5 VA rated power



### Key Commercial Data

Packing unit	1 STK
GTIN	
GTIN	4046356305075
Weight per Piece (excluding packing)	360.000 g
Custom tariff number	85043129
Country of origin	Germany

### Technical data

#### Dimensions

Primary round conductor (diameter)	33 mm
Primary round conductor (width)	40 mm
Primary round conductor (height)	12 mm
Note on dimensions	2
Primary round conductor (width)	30 mm
Primary round conductor (height)	10 mm
Width	30 mm
Height	90 mm
Depth	70 mm
Width with alternative assembly	70 mm
Height with alternative assembly	90 mm

# Current transformer - PACT MCR-V2-4012- 70- 400-5A-1 - 2277129

## Technical data

### Dimensions

Depth with alternative assembly	30 mm
---------------------------------	-------

### Ambient conditions

Ambient temperature (operation)	-25 °C ... 40 °C
Ambient temperature (storage/transport)	-25 °C ... 40 °C

### Input data

Number of inputs	1
Thermal rated short-time current	$I_{th} = 60 * I_n$
Thermal rated continuous current	$I_d = 1.2 * I_n$
Rated surge current	$I_{dyn} = 2.5 * I_{th}$
Rated frequency: Standard converter	50 Hz ... 60 Hz
Rated frequency: Calibrated converter	50 Hz
Surge current limitation factor	FS 5
Rated power	7.5 VA
Primary rated current $I_{pn}$	0 A ... 400 A
Secondary rated current $I_{sn}$	5 A AC

### Output data

Connection method	Screw connection
-------------------	------------------

### General

Converter type	Plug-on converters
Accuracy class	1
Can be calibrated	no
Rated insulation voltage	1 kV (Phase/neutral conductor)
Standards/regulations	EN 50178
	EN 61869
Color	black
Housing material	PA 6.6

### Standards and Regulations

Standards/regulations	EN 50178
	EN 61869

### Environmental Product Compliance

China RoHS	Environmentally Friendly Use Period = 50
	For details about hazardous substances go to tab "Downloads", Category "Manufacturer's declaration"

## Drawings

## Current transformer - PACT MCR-V2-4012- 70- 400-5A-1 - 2277129

Dimensional drawing

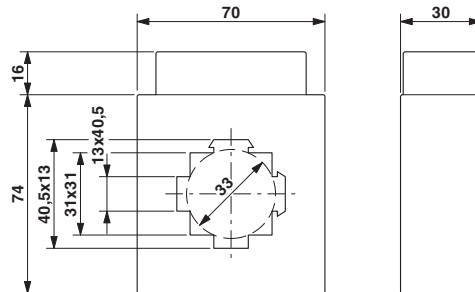

### Classifications

#### eCl@ss

eCl@ss 4.0	27210902
eCl@ss 4.1	27210902
eCl@ss 5.0	27210902
eCl@ss 5.1	27210902
eCl@ss 6.0	27210902
eCl@ss 7.0	27210902
eCl@ss 8.0	27210902
eCl@ss 9.0	27210902

#### ETIM

ETIM 3.0	EC002048
ETIM 4.0	EC002048
ETIM 5.0	EC002048
ETIM 6.0	EC002048

#### UNSPSC

UNSPSC 6.01	30211501
UNSPSC 7.0901	39121019
UNSPSC 11	39121006
UNSPSC 12.01	39121006
UNSPSC 13.2	39121032

### Approvals

#### Approvals

Approvals

EAC

## Current transformer - PACT MCR-V2-4012- 70- 400-5A-1 - 2277129

### Approvals

---

Ex Approvals

---

### Approval details

EAC		EAC-Zulassung
-----	---	---------------

### Accessories

#### Accessories

#### Mounting material

Mounting material - PACT-FAST-MNT-W13-L65 - 2276625



The transformer quick-action mechanism enables the lightning-fast mounting of PACT current transformers on the power rail. The installation can be completed easily by hand without the use of tools. Fixing pins: 65 mm, holding latches: 13 mm

Mounting material - PACT-FAST-MNT-W13-L40 - 2276612



The transformer quick-action mechanism enables the lightning-fast mounting of PACT current transformers on the power rail. The installation can be completed easily by hand without the use of tools. Fixing pins: 40 mm, holding latches: 13 mm