

DATE SHOWN TO SUPPLIER ALL RIGHTS RESERVED

REV	DATE	DESCRIPTION	BY	CHK	APP
00					
E2		REVISED PER ECO-11-005027			

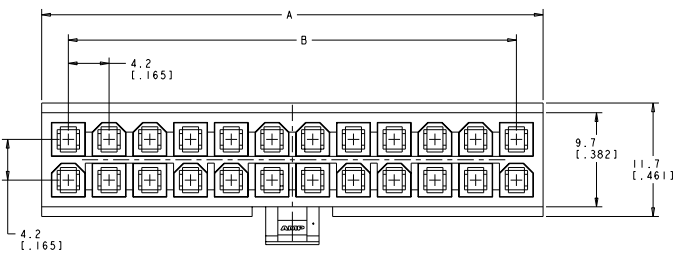

- △ NYLON, UL94V-2, NATURAL.
2. DIMENSIONS IN BRACKETS ARE IN INCHES.
3. FEMALE CONTACTS MUST BE INSERTED SO THAT THE TOP OF THE WIRE AND INSULATION CRIMPS ARE FACING THE CIRCUIT NUMBER OF THE POSITION INTO WHICH IT IS BEING INSERTED OR 180° FROM THE CIRCUIT NUMBER FOR THAT POSITION.

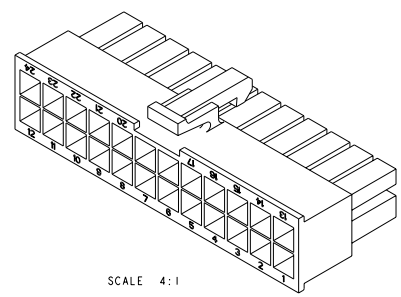
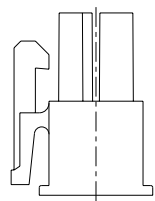
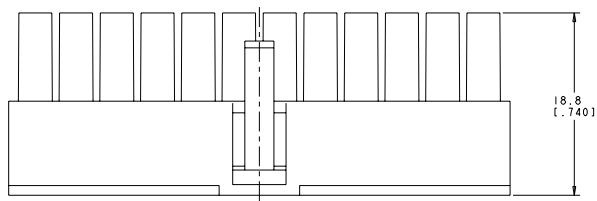

SCALE 4:1

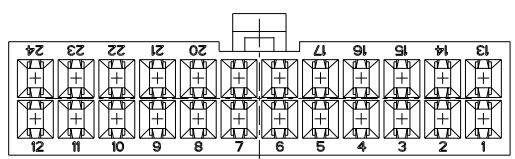

LENGTH mm	LENGTH INCHES	NO OF POSITIONS	NO OF POSITIONS	NO OF POSITIONS	PART NUMBER
4032.2	24	46.2(1.82)	51.7(2.04)	2-106527-4	
3717.6	22	42(1.65)	47.5(1.87)	2-106527-2	
3403.1	20	37.8(1.49)	43.3(1.7)	2-106527-0	
3088.6	18	33.6(1.32)	39.1(1.54)	1-106527-8	
2774	16	29.4(1.16)	34.9(1.37)	1-106527-6	
2459.5	14	25.2(0.99)	30.7(1.21)	1-106527-4	
2145	12	21(0.83)	26.5(1.04)	1-106527-2	
1830.5	10	16.8(0.66)	22.3(0.88)	1-106527-0	
1515.9	8	12.6(0.5)	18.1(0.71)	106527-8	
1201.4	6	8.4(0.33)	13.9(0.55)	106527-6	
886.9	4	4.2(0.17)	9.7(0.38)	106527-4	
575.1	2	0(0)	5.5(0.22)	106527-2	

THIS DRAWING IS A CONTROLLED DOCUMENT.		REV. 00	DATE 27JUN2007
ISSUED BY	DATE	REV. 00	DATE 27JUN2007
DRAWING NO. 00779		TITLE AMP-DUAC(TM) RECEPTACLE HOUSING, 2 TO 24 POSITION.	
CUSTOMER DRAWING		SCALE 4:1	SHEET 1 OF 1



4003 12/01/11  
Pre-ENGINEER DRAWING