

Thermofit[®] Molded Parts
Specification Control Drawing
Limited Distribution

Part Number : 202D232-X-02
Description : Boot, Straight, With Lip

NOTES

- All dimensions are in $\frac{\text{inches}}{[\text{millimeters}]}$
- Dimensions appearing in table are as follows:
 - a - As Supplied
 - b - After Unrestricted Recovery
- Coating is optional. As supplied dimensions appearing in table are for uncoated parts. When coating is added, entry diameters will be reduced by .06 max.

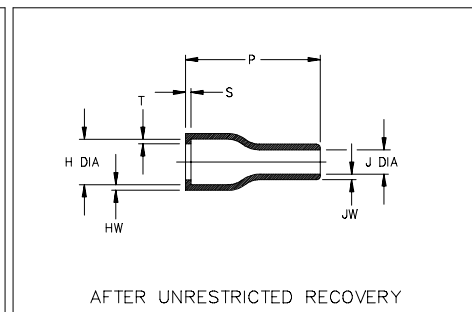
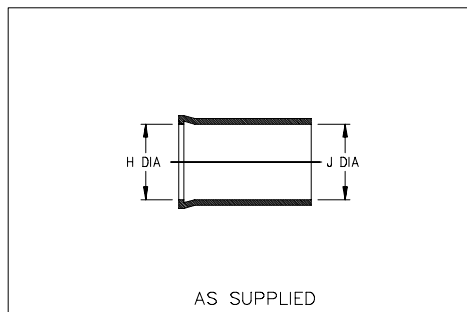

TABLE OF DIMENSIONS									
PART NUMBER	H		J		P	S	T	HW	JW
	Min	Max	Min	Max	±10%	Ref	Ref	±20%	±20%
	a	b	a	b	b	b	b	b	b
202D232-X-02	1.16 [29,5]	.74 [18,8]	1.16 [29,5]	.33 [8,4]	1.32 [33,5]	.12 [3,0]	.04 [1,0]	.07 [1,78]	.045 [1,1]

If this document is printed it becomes uncontrolled.
Check for the latest revision.

Raychem

RAYCHEM CORPORATION
300 CONSTITUTION DRIVE
MENLO PARK, CALIFORNIA 94025

Revision : B
Date : 9/7/95

Part Number : 202D232-X-02
Description : Boot, Straight, With Lip

Thermofit[®] Molded Parts
Specification Control Drawing
Limited Distribution

Part Number : 202D232-X-02
Description : Boot, Straight, With Lip

COMPATABILITY CHART					
MATERIAL DASH NO.	MATERIAL DESCRIPTION	RT SPEC	COATING SLASH NO.	COATING S NO.	COATING DESCRIPTION
-25	Elastomer, Fluid Resistant	RT-1325	N/A		

ORDERING INFORMATION

202D232 -X -02 /XXX

Base part number _____

Material dash number _____
(See Compatability Chart)

Modification number _____
(If necessary, see front of scd binder for a complete list)

Adhesive slash number _____
(If necessary, see Compatability Chart)

THIS DRAWING IS SUBJECT TO CHANGE WITHOUT NOTICE; CONSULT YOUR
NEAREST FIELD REPRESENTATIVE FOR CURRENT REVISION

Raychem

RAYCHEM CORPORATION
300 CONSTITUTION DRIVE
MENLO PARK, CALIFORNIA 94025

Revision : B
Date : 9/7/95

Part Number : 202D232-X-02
Description : Boot, Straight, With Lip

CAD FILE MP95499