

## PSM-SET-BFOC-LINK/2

Order No.: 2799429

The illustration shows versions PSM-SET-BFOC-LINK/2 and PSM-SET-FSMA-LINK/2



<http://eshop.phoenixcontact.de/phoenix/treeViewClick.do?UID=2799429>

Coupling; set consisting of 2 couplings for connecting B-FOC plugs

### Commercial data

GTIN (EAN)	 4 017918 118389
Note	Made-to-order
sales group	H628
Pack	1 pcs.
Customs tariff	85366990
Catalog page information	Page 525 (IF-2009)

### Product notes

WEEE/RoHS-compliant since:  
10/31/2006



<http://www.download.phoenixcontact.com>  
Please note that the data given here has been taken from the online catalog. For comprehensive information and data, please refer to the user documentation. The General Terms and Conditions of Use apply to Internet downloads.

### Technical data

#### General data

Type of plug	B-FOC (ST®) / IEC 60874-10
Attenuation	< 2 dB

**Diagrams/Drawings**

Drilling plan/solder pad geometry

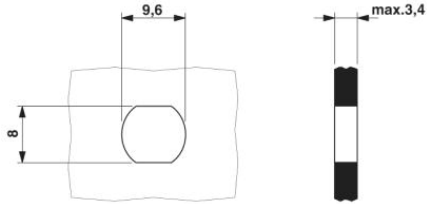

Drilling diagram B-FOC panel feed-through

Dimensioned drawing

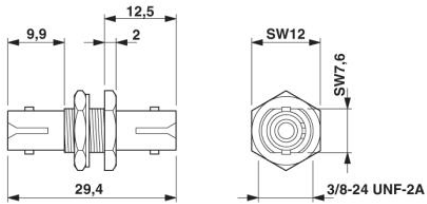

Dimensional drawing B-FOC coupling

**Address**

PHOENIX CONTACT Inc., USA  
586 Fulling Mill Road  
Middletown, PA 17057, USA  
Phone (800) 888-7388  
Fax (717) 944-1625  
<http://www.phoenixcon.com>



© 2011 Phoenix Contact  
Technical modifications reserved;