

## Housing - HC-STA-D07-BWS-PL-BK - 1419265

Please be informed that the data shown in this PDF Document is generated from our Online Catalog. Please find the complete data in the user's documentation. Our General Terms of Use for Downloads are valid (<http://phoenixcontact.com/download>)



Panel mounting base D7, With single locking latch, material: PA, height: 25.5 mm, cable gland: none, gland: no, Standard

RoHS

### Key Commercial Data

Packing unit	1 STK
GTIN	
GTIN	4055626160160

### Technical data

#### Dimensions

Height	25.5 mm
Width	34.2 mm
Length	24.2 mm
Length of the assembly cutout	21.5 mm
Width of the assembly cutout	21.5 mm

#### Ambient conditions

Degree of protection of housing (IP)	IP66
Ambient temperature (operation)	-40 °C ... 125 °C

#### General

Note	for contact inserts HC-A03, A04, D07, D08, Q02, Q03, Q04, Q05, Q07, Q12
Size	D7
Housing type	Panel mounting base
Color	black
Locking type	With single locking latch
Screw connection	none
Housing material	PA

# Housing - HC-STA-D07-BWS-PL-BK - 1419265

## Technical data

### General

Seal material	NBR
Material lock	PA
Flammability rating according to UL 94	V0

### Standards and Regulations

Flammability rating according to UL 94	V0
Note	for contact inserts HC-A03, A04, D07, D08, Q02, Q03, Q04, Q05, Q07, Q12

## Drawings

Dimensional drawing

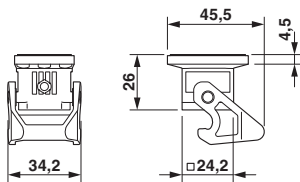

Dimensional drawing

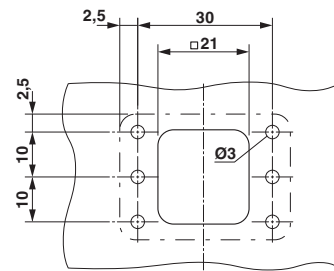

Mounting cutout

## Approvals

### Approvals

---

### Approvals

EAC / EAC / GL

---

### Ex Approvals

---

### Approval details

EAC		EAC-Zulassung
-----	--	---------------

EAC		RU C- DE.AI30.B.01102
-----	--	--------------------------

## Housing - HC-STA-D07-BWS-PL-BK - 1419265

### Approvals

GL		<a href="http://exchange.dnv.com/tari/">http://exchange.dnv.com/tari/</a>	6196614 HH
----	---	---	------------

Phoenix Contact 2018 © - all rights reserved  
<http://www.phoenixcontact.com>

PHOENIX CONTACT GmbH & Co. KG  
Flachsmarktstr. 8  
32825 Blomberg  
Germany  
Tel. +49 5235 300  
Fax +49 5235 3 41200  
<http://www.phoenixcontact.com>