

THIS DRAWING IS UNPUBLISHED. RELEASED FOR PUBLICATION
 © COPYRIGHT BY TYCO ELECTRONICS CORPORATION. ALL RIGHTS RESERVED.

LOC		DIST		REVISIONS			
P	LTR	DESCRIPTION		DATE	DWN	APVD	
FT	0	R	REVISE PER ECN	0G3B-0945-04	10/25/04	SS GS	

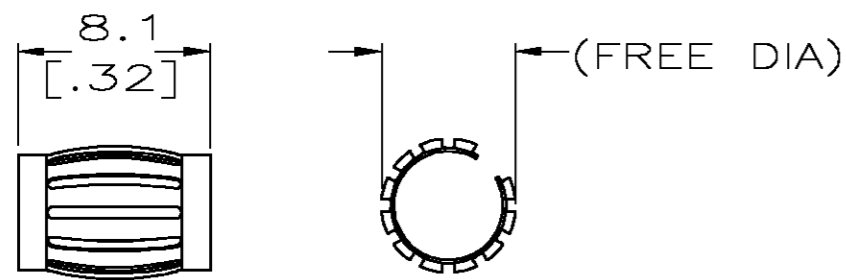

STYLE B
(MALE)

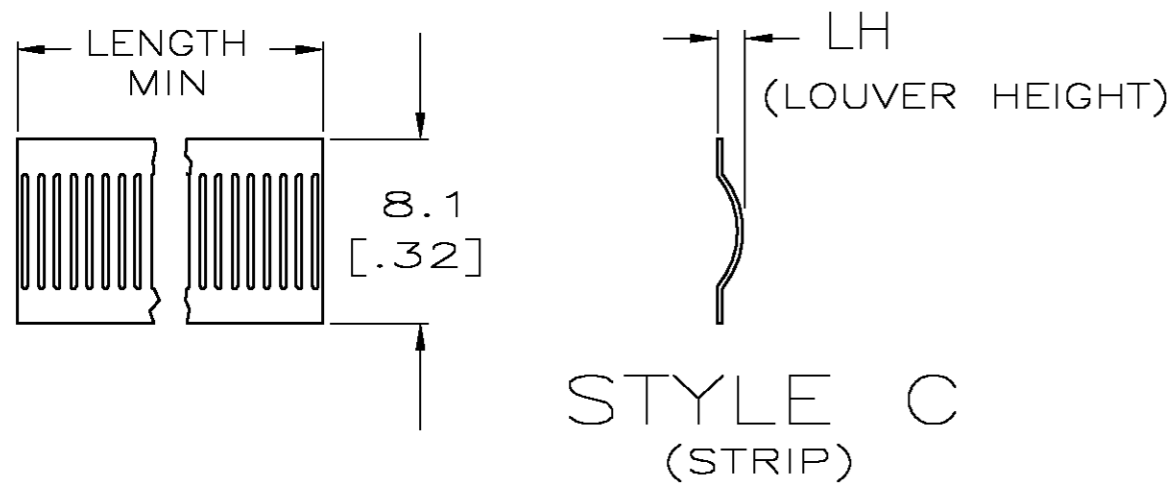

STYLE C
(STRIP)

- FINISH-SILVER PLATE 200 uIN MIN THICK.
- FINISH-NICKEL PLATE 40 uIN MIN THICK.
- FINISH-GOLD PLATE 10 uIN MIN THICK.
- FINISH-GOLD PLATE 50 uIN MIN THICK.
- FINISH-CADMIUM PLATE 300 uIN MIN THICK.
- FINISH-NICKEL PLATE 100 uIN MIN THICK.
- FINISH-TIN PLATE 300 uIN MIN THICK.
-
-
-
- PLATING NOTES ARE TO BE INTERPRETED AS FOLLOWS, 6-8 AS 6 OVER 8.
- PRODUCT IS SOLD BY THE FOOT.
- 12 FOOT STRIP WOUND TO A ONE INCH INSIDE DIAMETER.
- MATERIAL-BeCu (CDA172).
- MATERIAL-STAINLESS STEEL.
- CUT LENGTH 508.0 [20.00] APPROXIMATELY 714 LOUVERS.
- BAND WIDTH .310±.005 FOR P/N 6-192042-6.
- FINISH - GOLD PLATE 30uIN MIN THICK.
- OVERLAPPED WITH GAP.

LOC	DIST	P	LTR	DESCRIPTION	DATE	DWN	APVD
FT	0	R		REVISE PER ECN 0G3B-0945-04	10/25/04	SS	GS
OBSOLETE							
[.022]		--	B	[.40] 14 9.5 [.375] 36 3-2 0.20 [.008]	04133		4-192042-7
OBSOLETE							
[.022]		--	B	[.40] 14 9.5 [.375] 36 1-2 0.15 [.006]	04054		4-192042-6
OBSOLETE							
[.022]		--	B	[.40] 14 9.5 [.375] 36 5 0.15 [.006]	04100		4-192042-5
OBSOLETE							
[.022]		--		[.40] 14 9.5 [.375] 36 UNPL 0.15 [.006]	04156		4-192042-4
OBSOLETE							
[.022]		--		[.40] 14 9.5 [.375] 36 UNPL 0.15 [.006]	04101		4-192042-3
OBSOLETE							
[.024]		--	B	[.30] 14 7.1 [.280] 26 3-2 0.15 [.006]	04132		4-192042-2
OBSOLETE							
[.024]		--		[.30] 14 7.1 [.280] 26 UNPL 0.15 [.006]	04131		4-192042-1
OBSOLETE (PENDING)							
[.024]		--		[.30] 14 7.1 [.280] 26 UNPL 0.15 [.006]	04048		4-192042-0
OBSOLETE							
[.024]		--		[.30] 14 7.1 [.280] 26 UNPL 0.15 [.006]	04173		3-192042-9
OBSOLETE							
[.026]		--	B	[.23] 14 5.5 [.216] 19 6 0.20 [.008]	04043		3-192042-8
OBSOLETE							
[.026]		--	B	[.23] 14 5.5 [.216] 19 3-2 0.20 [.008]	04135		3-192042-7
OBSOLETE							
[.026]		--		[.23] 14 5.5 [.216] 19 1-2 0.20 [.008]	04039		3-192042-6
OBSOLETE							
[.032]		--	B	[.20] 14 4.7 [.185] 15 3-2 0.15 [.006]	04134		3-192042-5
OBSOLETE							
[.032]		--		[.20] 14 4.7 [.185] 15 UNPL 0.15 [.006]	04034		3-192042-4
OBSOLETE							
[.032]		--	B	[.20] 14 4.7 [.185] 15 1-2 0.15 [.006]	04033		3-192042-3
OBSOLETE							
[.032]		--		[.20] 14 4.7 [.185] 15 UNPL 0.15 [.006]	04032		3-192042-2
OBSOLETE							
[.032]		--		[.20] 14 4.7 [.185] 15 UNPL 0.15 [.006]	04063		3-192042-1
OBSOLETE							
[.022]		--	B	[.17] 14 4.0 [.157] 13 4-2 0.15 [.006]	04130		3-192042-0
OBSOLETE							
[.022]		--	B	[.17] 14 4.0 [.157] 13 3-2 0.15 [.006]	04155		2-192042-9
OBSOLETE							
[.022]		--	B	[.17] 14 4.0 [.157] 13 6 0.15 [.006]	04068		2-192042-8
OBSOLETE							
[.022]		--	B	[.17] 14 4.0 [.157] 13 1-2 0.15 [.006]	04088		2-192042-7
OBSOLETE							
[.022]		--	B	[.17] 14 4.0 [.157] 13 UNPL 0.15 [.006]	04087		2-192042-6
OBSOLETE							
[.022]		--	B	[.15] 14 3.5 [.138] 12 3-2 0.15 [.006]	04089		2-192042-5
OBSOLETE							
[.022]		--	B	[.14] 14 3.0 [.118] 10 3-2 0.15 [.006]	04026		2-192042-4
OBSOLETE							
[.022]		--	B	[.14] 14 3.0 [.118] 10 UNPL 0.15 [.006]	04022		2-192042-3
OBSOLETE							
[.022]		--	B	[.13] 14 2.8 [.110] 10 3-2 0.12 [.005]	04021		2-192042-2
OBSOLETE							
[.022]		--	B	[.13] 14 2.5 [.098] 9 3-2 0.15 [.006]	04018		2-192042-1
OBSOLETE							
[.026]		--	B	[.13] 14 2.3 [.091] 9 3-2 0.20 [.008]	04016		2-192042-0
OBSOLETE							
[.022]		--	B	[.11] 14 2.0 [.080] 6 6 0.15 [.006]	04014		1-192042-9
OBSOLETE							
[.022]		--		[.11] 14 2.0 [.080] 6 3-2 0.15 [.006]	04012		1-192042-8
OBSOLETE							
[.022]		--		[.11] 14 2.0 [.080] 6 3-2 0.15 [.006]	04011		192042 -7
OBSOLETE							
[.026]		--	B	[.11] 14 2.0 [.080] 6 3-2 0.12 [.005]	04152		1-192042-6
OBSOLETE							
[.026]		--	B	[.11] 14 2.0 [.080] 6 6 0.12 [.005]	04171		1-192042-5
OBSOLETE							
[.026]		--	B	[.11] 14 2.0 [.080] 6 UNPL 0.12 [.005]	04219		1-192042-4
OBSOLETE							
[.020]		--	B	[.10] 14 2.0 [.080] 6 6 0.10 [.004]	04153		1-192042-3
OBSOLETE							
[.020]		--	B	[.10] 14 2.0 [.080] 6 UNPL 0.10 [.004]	04150		1-192042-2
OBSOLETE							
[.026]	NOTE 13	C	--	14 -- -- 3-2 0.12 [.005]	04151		1-192042-1
OBSOLETE							
[.028]	NOTE 12	C	--	14 -- -- 3-2 0.20 [.008]	04175		1-192042-0
OBSOLETE							
[.028]	NOTE 12	C	--	14 -- -- 1-2 0.20 [.008]	04127		192042-9
OBSOLETE							
[.028]	NOTE 12	C	--	14 -- -- UNPL 0.20 [.008]	04160		192042-8
OBSOLETE							
[.028]	NOTE 12	C	--	14 -- -- 3-2 0.15 [.006]	04161		192042-7
OBSOLETE							
[.026]	NOTE 12	C	--	14 -- -- 1-2 0.15 [.006]	04003		192042-6
OBSOLETE							
[.026]	NOTE 12	C	--	14 -- -- 1-2 0.15 [.006]	04217		192042-5
OBSOLETE							
[.026]	NOTE 12	C	--	14 -- -- UNPL 0.15 [.006]	04085		192042-4
OBSOLETE							
[.026]	NOTE 12	C	--	14 -- -- 1-2 0.12 [.005]	04141		192042-3
OBSOLETE							
[.026]	NOTE 12	C	--	14 -- -- UNPL 0.12 [.005]	--		192042-2
OBSOLETE							
[.016]	NOTE 12	C	--	15 -- -- UNPL 0.12 [.005]	04181		192042-1

THIS DRAWING IS A CONTROLLED DOCUMENT.		DWN RA JAYNE 06-12-92	tyco Electronics	Tyco Electronics Corporation Harrisburg, Pa 17105-3608	
DIMENSIONS: mm		CHK J.TURNER 07-21-93		NAME CONTACT BAND, MALE	
TOLERANCES UNLESS OTHERWISE SPECIFIED:		APVD S.SIEGRIST 07-21-93	PRODUCT SPEC		
0 PLC ± -		APPLICATION SPEC	SIZE A2		
1 PLC ± -		WEIGHT	CAGE CODE 00779		
2 PLC ± 0.5[.02]		SCALE 1:1	DRAWING NO C=192042		
3 PLC ± 0.25[.010]		SHEET 1 OF 2	RESTRICTED TO		
4 PLC ± -		REV R			
ANGLES ± -					
FINISH					
MATERIAL					

