



CONTACT • REQUEST A QUOTE

PRODUCTS

RESOURCES

COMPANY

PART NUMBER SEARCH



« Control Knobs

## Pointer Control Knobs

### Series #1510

Control knobs and levers in thermoplastic, with or without flange and index/graduations.

Knobs can be decorated or customized to your specific need.

Perfect knobs for synthesizers and other electronic applications.

A variety of shapes and diameters with plain, tapped bosses or with studs are available with standard threads to fit the application.

A wide range of soft touch control knobs available in thermoplastic overmold.

Colors available upon request.

Please note: Not all variations available are listed below. Please [contact Customer Service](#) to inquire about all available options.



REQUEST CAD DRAWING

REQUEST A QUOTE

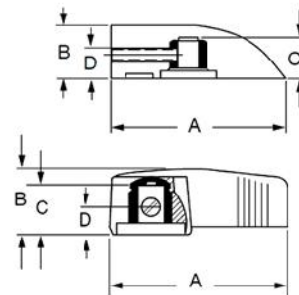

Item #	Diameter A	Height B	Indicator Line	Inlay	Material Type	Mounting Diameter	Mounting Type	Set Screw Thread	Color
1510-Q	0.75	0.56	Yes	No	Thermoset	0.25	Plain Molded Hole		BLACK
1510-Z	0.75	0.56	Yes	No	Thermoset	0.125	Plain Molded Hole		BLACK
1510AH	0.75	0.56	Yes	No	Thermoset	0.25	Plain Molded Hole		BLACK
1510AJ	0.75	0.56	Yes	No	Thermoset	0.25	Knurl Molded Hole		BLACK
1510AM	0.75	0.56	Yes	No	Thermoset	0.125	Plain Molded Hole		BLACK
1510AP	0.75	0.56	Yes	No	Thermoset	0.19	Plain Molded Hole		BLACK
1510AQ	0.75	0.56	Yes	No	Thermoset	0.25	Plain Molded Hole		BLACK
1510AR	0.75	0.56	Yes	No	Thermoset	0.2	Plain Molded Hole		BLACK
1510AV	0.75	0.56	Yes	No	Thermoset	0.25	Plain Molded Hole		BLACK
1510AZ	0.75	0.56	Yes	No	Thermoset	0.25	Plain Molded Hole		WHITE
1510BB	0.75	0.56	Yes	No	Thermoset	0.25	Plain Molded Hole		IVORY
1510BD	0.75	0.56	Yes	No	Thermoset	0.25	Plain Molded Hole		BLACK
1510BG	0.75	0.56	No	No	Thermoset	0.25 flattened to 0.16	Spring		BLACK
1510BH	0.75	0.56	No	No	Thermoset	M6 Flatted to M4.5	Spring		BLACK

PRODUCTS

- Knobs
- Handles
- Leveling Feet
- Latches
- Hinges
- Indexing Plungers
- Electronic Enclosures
- Two-Shot / Soft Touch
- Frac Balls
- Custom Molding

RESOURCES

- Engineering Specifications
- Distributor Listing
- Sales Representative Listing

COMPANY

- About Us
- Capabilities
- Certifications
- Contact Us
- Blog
- Careers

QUESTIONS ?

questions / comments

Copyright © 2016 Davies Molding, LLC. All Rights Reserved.  
350 Kehoe Blvd. | Carol Stream, IL 60188-1818 | Phone: (800) 554-9208 | Fax: (630) 510-9944