

14-040.002 - Indicator actuator

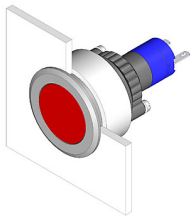

Attention: The preview is based on a sample product. This can differ from your current configuration.

Mounting

Design flush

Other Attributes

Weight 0.050 kg

IP-Rating

Front protection IP 67

Connection Method

Terminal Solder 2.8 x 0.5 mm

Function

Indicator

Dimensions

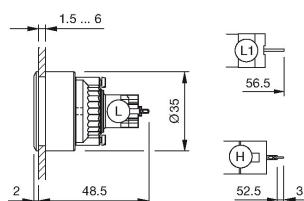

L1 = Solder terminal 2.8 x 0.5 mm

Mounting cut-outs

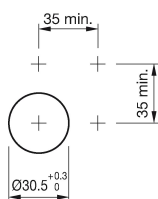

Wiring diagram

