

Printed-circuit board connector - GICV 2,5 HC/12-G-7,62 - 1756582

Please be informed that the data shown in this PDF Document is generated from our Online Catalog. Please find the complete data in the user's documentation. Our General Terms of Use for Downloads are valid (<http://phoenixcontact.com/download>)



Header, Nominal current: 16 A, Rated voltage (III/2): 630 V, Number of positions: 12, Pitch: 7.62 mm, Color: green, Contact surface: Tin, Mounting: Soldering

Why buy this product

- ✓ Compact 7.62 mm pitch
- ✓ CP-MSTB coding profile as protection against mismatching
- ✓ Maximum contact reliability due to integrated double steel spring
- ✓ Inverted GIC 2,5 HC headers with socket contacts for touch-proof device outputs (with GIC 2,5 HCV/... -ST) or a PCB/PCB connection (with GMSTBA 2,5 HC/... -G)



Key commercial data

Packing unit	50 pc
Minimum order quantity	50 pc
GTIN	 4 046356 339360
Weight per Piece (excluding packing)	14.07 g
Custom tariff number	85366990
Country of origin	Germany
Note	Made to Order (non-returnable)

Technical data

Dimensions

Length	10.2 mm
Pitch	7.62 mm
Dimension a	83.82 mm
Pin dimensions	1,2 x 0,5
Hole diameter	1.4 mm

General

Range of articles	GICV 2,5 HC/..-G
Insulating material group	I

Printed-circuit board connector - GICV 2,5 HC/12-G-7,62 - 1756582

Technical data

General

Rated surge voltage (III/3)	6 kV
Rated surge voltage (III/2)	6 kV
Rated surge voltage (II/2)	6 kV
Rated voltage (III/3)	630 V
Rated voltage (III/2)	630 V
Rated voltage (II/2)	1000 V
Connection in acc. with standard	EN-VDE
Nominal current I _N	16 A
Insulating material	PA
Inflammability class according to UL 94	V0
Color	green
Number of positions	12

Classifications

eCl@ss

eCl@ss 4.0	272607xx
eCl@ss 4.1	27260701
eCl@ss 5.0	27260701
eCl@ss 5.1	27260701
eCl@ss 6.0	27260704
eCl@ss 7.0	27440402
eCl@ss 8.0	27440402

ETIM

ETIM 3.0	EC001121
ETIM 4.0	EC002637
ETIM 5.0	EC002637

UNSPSC

UNSPSC 6.01	30211810
UNSPSC 7.0901	39121409
UNSPSC 11	39121409
UNSPSC 12.01	39121409
UNSPSC 13.2	39121409

Approvals

Approvals

Printed-circuit board connector - GICV 2,5 HC/12-G-7,62 - 1756582

Approvals

Approvals

UL Recognized / cUL Recognized / EAC / cULus Recognized

Ex Approvals

Approvals submitted

Approval details

UL Recognized		
	B	D
Nominal current I _N	16 A	10 A
Nominal voltage U _N	250 V	300 V

cUL Recognized		
	B	D
Nominal current I _N	16 A	10 A
Nominal voltage U _N	250 V	300 V

EAC

cULus Recognized		
------------------	--	--

Accessories

Additional products

Plug - GIC 2,5 HCV/12-ST-7,62 - 1745726



Plug component, Nominal current: 16 A, Rated voltage (III/2): 1000 V, Number of positions: 12, Pitch: 7.62 mm, Connection method: Screw connection, Color: green, Contact surface: Tin

Printed-circuit board connector - GICV 2,5 HC/12-G-7,62 - 1756582

Accessories

Base strip - GMSTBA 2,5 HC/12-G-7,62 - 1728950

Header, Nominal current: 16 A, Rated voltage (III/2): 630 V, Number of positions: 12, Pitch: 7.62 mm, Color: green, Contact surface: Tin, Mounting: Soldering



Printed-circuit board connector - GMSTBVA 2,5 HC/12-G-7,62 - 1792452

Header, Nominal current: 16 A, Rated voltage (III/2): 630 V, Number of positions: 12, Pitch: 7.62 mm, Color: green, Contact surface: Tin, Mounting: Soldering



Drawings

Drilling diagram

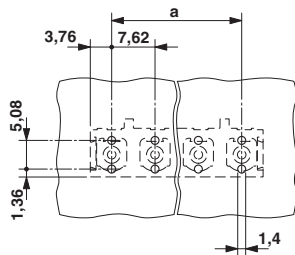

Dimensioned drawing

