

Plug - PTSM 0,5/ 6-PI-2,5 WH - 1709454

Please be informed that the data shown in this PDF Document is generated from our Online Catalog. Please find the complete data in the user's documentation. Our General Terms of Use for Downloads are valid (<http://phoenixcontact.com/download>)



Plug component, Nominal current: 6 A, Rated voltage (III/2): 160 V, Number of positions: 6, Pitch: 2.5 mm, Connection method: Push-in spring connection, Color: white, Contact surface: Tin

Product Features

- White design: Stable color when welding and during use
- Time saving push-in connection, tools not required
- Defined contact force ensures that contact remains stable over the long term
- High current carrying capacity of 6 A in very compact dimensions
- Inverted connector with pin contacts for touch-proof device outputs or free-hanging cable/cable connections

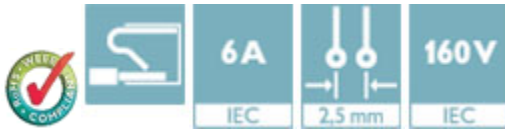

Key Commercial Data

Packing unit	1 pc
Minimum order quantity	100 pc
Weight per Piece (excluding packing)	1.6 g
Country of origin	Germany

Technical data

Dimensions

Length	15.5 mm
Height	5 mm
Width	16.7 mm
Pitch	2.50 mm
Dimension a	12.5 mm

General

Range of articles	PTSM 0,5/..-PI WH
Type of contact	Male connector

Plug - PTSM 0,5/ 6-PI-2,5 WH - 1709454

Technical data

General

Number of positions	6
Connection method	Push-in spring connection
Insulating material group	I
Rated surge voltage (III/3)	1.5 kV
Rated surge voltage (III/2)	2.5 kV
Rated surge voltage (II/2)	2.5 kV
Rated voltage (III/3)	100 V
Rated voltage (III/2)	160 V
Rated voltage (II/2)	320 V
Connection in acc. with standard	EN-VDE
Nominal current I_N	6 A
Nominal cross section	0.5 mm ²
Maximum load current	6 A
Insulating material	PA
Flammability rating according to UL 94	V0
Stripping length	6 mm

Connection data

Conductor cross section solid min.	0.14 mm ²
Conductor cross section solid max.	0.5 mm ²
Conductor cross section flexible min.	0.2 mm ²
Conductor cross section flexible max.	0.5 mm ²
Conductor cross section flexible, with ferrule without plastic sleeve min.	0.25 mm ²
Conductor cross section flexible, with ferrule without plastic sleeve max.	0.5 mm ²
Conductor cross section AWG min.	24
Conductor cross section AWG max.	20

Standards and Regulations

Connection in acc. with standard	EN-VDE
Flammability rating according to UL 94	V0

Classifications

eCl@ss

eCl@ss 4.0	272607xx
eCl@ss 4.1	27260701
eCl@ss 5.0	27260701
eCl@ss 5.1	27141190

Plug - PTSM 0,5/ 6-PI-2,5 WH - 1709454

Classifications

eCl@ss

eCl@ss 6.0	27260704
eCl@ss 7.0	27440402
eCl@ss 8.0	27440309
eCl@ss 9.0	27440309

ETIM

ETIM 3.0	EC001121
ETIM 4.0	EC002638
ETIM 5.0	EC002638

UNSPSC

UNSPSC 6.01	30211810
UNSPSC 7.0901	39121409
UNSPSC 11	39121409
UNSPSC 12.01	39121409
UNSPSC 13.2	39121409

Approvals

Approvals

Approvals

cULus Recognized

Ex Approvals

Approvals submitted

Approval details

cULus Recognized	
	B
mm ² /AWG/kcmil	26-20
Nominal current I _N	5 A
Nominal voltage U _N	150 V

Plug - PTSM 0,5/ 6-PI-2,5 WH - 1709454

Accessories

Accessories

Screwdriver tools

Screwdriver - SZS 0,4X2,0 - 1205202



Micro screwdriver, bladed, size: 0.4 x 2.0 x 60 mm, 2-component grip, with non-slip grip and twist cap

Additional products

Plug - PTSM 0,5/ 6-P-2,5 WH - 1704859



Plug component, Nominal current: 6 A, Rated voltage (III/2): 160 V, Number of positions: 6, Pitch: 2.5 mm, Connection method: Push-in spring connection, Color: white, Contact surface: Tin

Base strip - PTSM 0,5/ 6-HHI-2,5-SMD WHR44 - 1707998



Header, Nominal current: 6 A, Rated voltage (III/2): 160 V, Pitch: 2.5 mm, Color: white, Contact surface: Tin, Mounting: SMD soldering, Article with anti-rotation pin

Base strip - PTSM 0,5/ 6-HHI0-2,5-SMD WHR44 - 1815235



Header, Nominal current: 6 A, Rated voltage (III/2): 160 V, Number of positions: 6, Pitch: 2.5 mm, Color: white, Contact surface: Tin, Mounting: SMD soldering

Plug - PTSM 0,5/ 6-PI-2,5 WH - 1709454

Accessories

Base strip - PTSM 0,5/ 6-HHI-2,5-THR WH R32 - 1815028



Header, Nominal current: 6 A, Rated voltage (III/2): 160 V, Number of positions: 6, Pitch: 2.5 mm, Color: white, Contact surface: Tin, Mounting: THR soldering

Plug - PTSM 0,5/ 6-PL-2,5 WH - 1709463



Plug component, Nominal current: 6 A, Rated voltage (III/2): 160 V, Number of positions: 6, Pitch: 2.5 mm, Connection method: Push-in spring connection, Color: white, Contact surface: Tin

Drawings

Diagram

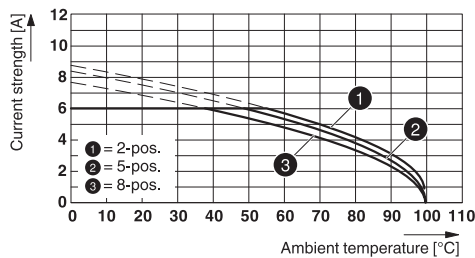

Dimensional drawing

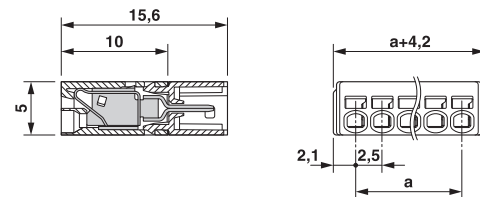

Type: PTSM 0,5/...-PI-2,5 WH with PTSM 0,5/...-HHI0-2,5-SMD WHR...

Mouser Electronics

Authorized Distributor

Click to View Pricing, Inventory, Delivery & Lifecycle Information:

[Phoenix Contact:](#)

[1709454](#)