

# 1045358-1 Product Details

[Share](#) | 
 [Print](#) | 
 [Email](#)

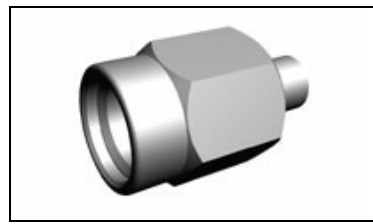

**1045358-1**

## SSMA RF Connectors

Always EU RoHS/ELV Compliant (Statement of Compliance)

### Product Highlights:

- Connector - RF
- Plug
- Mount Type = Free Hanging
- Body Style = Straight
- Frequency = 26 GHz (Max.)

[View all Features](#)

### Quick Links

- ▶ [Pricing & Availability](#)
- ▶ [Search for Tooling](#)
- ▶ [Product Feature Selector](#)
- ▶ [Contact Us About This Product](#)

TE Internal Number: 1045358-1

Active

[View 3D PDF](#)

[Add to My Part List](#) | 
 [Request Sample](#) | 
 [Find Similar Products](#) | 
 [Buy Product](#)

Documentation & Additional Information	
<p><b>Product Drawings:</b></p> <ul style="list-style-type: none"> <li>• <a href="#">ossm straight cable plug direct solder attachment</a> (PDF, English)</li> </ul> <p><b>Catalog Pages/Data Sheets:</b></p> <ul style="list-style-type: none"> <li>• None Available</li> </ul> <p><b>Product Specifications:</b></p> <ul style="list-style-type: none"> <li>• None Available</li> </ul> <p><b>Application Specifications:</b></p> <ul style="list-style-type: none"> <li>• None Available</li> </ul> <p><b>Instruction Sheets:</b></p> <ul style="list-style-type: none"> <li>• <a href="#">OSSM Straight Cable Plug (Direct Solder Attachment) ...</a> (PDF, English)</li> </ul> <p><b>CAD Files: (CAD Format &amp; Compression Information)</b></p> <ul style="list-style-type: none"> <li>• <a href="#">2D Drawing</a> (DXF, Version A)</li> <li>• <a href="#">3D Model</a> (IGES, Version A)</li> <li>• <a href="#">3D Model</a> (STEP, Version A)</li> </ul> <p style="text-align: right;"><a href="#">List all Documents</a></p>	<p><b>Related Products:</b></p> <ul style="list-style-type: none"> <li>• <a href="#">Tooling</a></li> </ul>

Product Features (Please use the Product Drawing for all design activity)	
<p><b>Product Type Features:</b></p> <ul style="list-style-type: none"> <li>• Product Type = Connector - RF</li> <li>• Gender = Plug</li> <li>• Gasket = With</li> <li>• Dielectric Material = TFE Fluorocarbon</li> </ul> <p><b>Electrical Characteristics:</b></p> <ul style="list-style-type: none"> <li>• Frequency = 26 GHz (Max.)</li> </ul> <p><b>Termination Features:</b></p> <ul style="list-style-type: none"> <li>• Termination Style = Direct Solder Attachment</li> </ul> <p><b>Body Features:</b></p> <ul style="list-style-type: none"> <li>• Mount Type = Free Hanging</li> <li>• Body Style = Straight</li> <li>• Hermetically Sealed = No</li> <li>• Gasket Style = O-Ring</li> </ul> <p><b>Contact Features:</b></p> <ul style="list-style-type: none"> <li>• Center Contact = With</li> <li>• Contact Extension = Without</li> <li>• Contact Finish = Gold</li> <li>• Contact Base Material = Beryllium Copper</li> </ul>	<p><b>Housing Features:</b></p> <ul style="list-style-type: none"> <li>• Housing Material = Stainless Steel</li> <li>• Housing Finish = Gold</li> </ul> <p><b>Configuration Features:</b></p> <ul style="list-style-type: none"> <li>• Coaxial Cable Type (RG/U or Mfg.) = 405 Semi-Rigid/2.16 [.085]</li> </ul> <p><b>Industry Standards:</b></p> <ul style="list-style-type: none"> <li>• <a href="#">RoHS/ELV Compliance</a> = RoHS compliant, ELV compliant</li> <li>• <a href="#">Lead Free Solder Processes</a> = Not relevant for lead free process</li> <li>• RoHS/ELV Compliance History = Always was RoHS compliant</li> </ul> <p><b>Conditions for Usage:</b></p> <ul style="list-style-type: none"> <li>• Applies To = Semi-Rigid Cable</li> </ul> <p><b>Other:</b></p> <ul style="list-style-type: none"> <li>• Brand = TE Connectivity</li> </ul>

Feedback

[About TE](#)  
[Investors](#)  
[News Room](#)  
[Supplier Portal](#)  
[Careers](#)  
[Terms & Conditions](#)  
[Privacy Policy](#)  
[AODA Accessibility Policy](#)  
[AODA Multi-Year Accessibility Plan](#)

[Distributor Inventory](#)  
[Product Cross Reference](#)  
[Documents & Drawings](#)  
[Product Compliance Support Center](#)  
[Site Map](#)

[Email or Chat With Us](#)  
[Find a Phone Number](#)  
[Knowledge Base](#)  
[Manage Your Account](#)

