

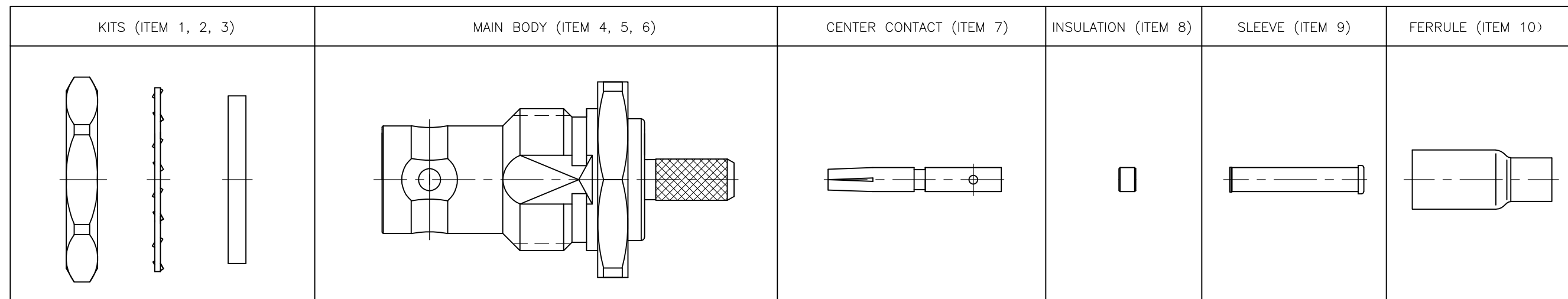

THIS DRAWING IS UNPUBLISHED. RELEASED FOR PUBLICATION FEB ,2006.  
 © COPYRIGHT 2006 By - ALL RIGHTS RESERVED.

LOC	DIST	REVISIONS					
E	B	P	LTR	DESCRIPTION	DATE	DWN	APVD
		D		ECR-14-011285	28SEP2014	RZ	MY

COMPONENTS



ASSEMBLY INSTRUCTIONS

**STEP 1: PREPARATION OF CABLE**

1. TRIM CABLE TO DIMENSIONS SHOWN. BE CAREFUL TO AVOID NICKING THE BRAID.
2. REMOVE ANY RESIDUAL PLASTIC FROM CENTER CONDUCTOR.

**STEP 2: ASSEMBLE FERRULE, SLEEVE AND INSULATOR TO CABLE**

1. SLIDE FERRULE ONTO JACKET OF CABLE AS SHOWN,
2. FLARE THE BRAID WIRES, AND SLIDE SLEEVE ONTO DIELECTRIC OF CABLE AS SHOWN.
3. SLIDE INSULATOR ONTO CENTER CONDUCTOR OF CABLE.

**STEP 3: CRIMP/SOLDERING CENTER CONTACT TO CABLE**

1. INSERT STEP 2 CABLE ASSEMBLY INTO CENTER CONTACT.
2. USING 1.8 (.071") HEX CRIMP TOOLING, OR SOLDERING CENTER CONTACT WITH CABLE.
3. PAY ATTENTION TO THE CRIMP AREA.

**STEP 4: CRIMP FERRULE TO CABLE**

1. INSERT STEP 3 CABLE ASSEMBLY INTO CONNECTOR BODY UNTIL CENTER CONTACT IS SEATED WITH ALL BRAID WIRES ON OUTSIDE OF CONNECTOR BODY.
2. SLIDE FERRULE OVER BRAID WIRES AND CRIMP AS CLOSE TO BODY AS POSSIBLE USING 4.6 (.181") HEX CRIMP TOOLING. PAY ATTENTION TO THE CRIMP AREA.

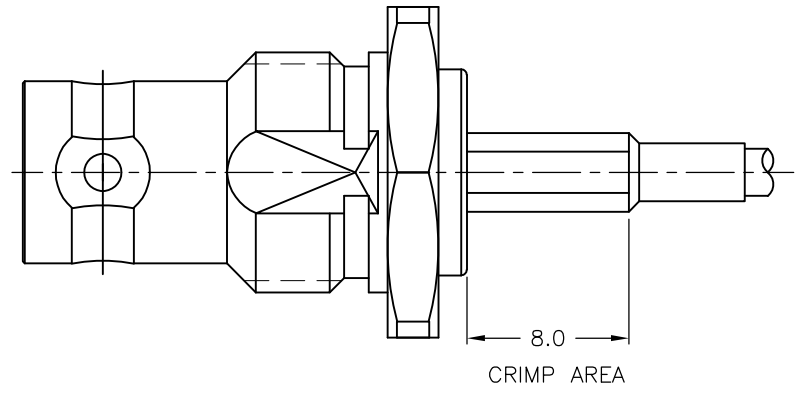

THIS DRAWING IS A CONTROLLED DOCUMENT.		DWN	J.SANDWELL	01FEB06															
DIMENSIONS: mm		CHK	S.PARLOW	01FEB06															
		APVD	F.WHEELER-KING	01FEB06															
<p>TOLERANCES UNLESS OTHERWISE SPECIFIED:</p> <table border="1"> <tr><td>0 PLC</td><td>± -</td></tr> <tr><td>1 PLC</td><td>± -</td></tr> <tr><td>2 PLC</td><td>± -</td></tr> <tr><td>3 PLC</td><td>± -</td></tr> <tr><td>4 PLC</td><td>± -</td></tr> <tr><td>ANGLES</td><td>± -</td></tr> <tr><td>FINISH</td><td>± -</td></tr> </table>		0 PLC	± -	1 PLC		± -	2 PLC	± -	3 PLC	± -	4 PLC	± -	ANGLES	± -	FINISH	± -	PRODUCT SPEC	NAME	
0 PLC	± -																		
1 PLC	± -																		
2 PLC	± -																		
3 PLC	± -																		
4 PLC	± -																		
ANGLES	± -																		
FINISH	± -																		
MATERIAL	SEE TABLE	APPLICATION SPEC	SIZE		A3														
		WEIGHT	CAGE CODE		00779														
		CUSTOMER DRAWING		DRAWING NO	C-1337548														
		SCALE		SHEET	2 OF 2														
				RESTRICTED TO	REV D														

# Mouser Electronics

Authorized Distributor

Click to View Pricing, Inventory, Delivery & Lifecycle Information:

[TE Connectivity:](#)

[1-1337548-0](#)