

# Printed-circuit board connector - MCV 1,5/ 8-GF-3,81 P26 THR - 1707696

Please be informed that the data shown in this PDF Document is generated from our Online Catalog. Please find the complete data in the user's documentation. Our General Terms of Use for Downloads are valid (<http://phoenixcontact.com/download>)

Header, nominal current: 8 A, rated voltage (III/2): 160 V, number of positions: 8, pitch: 3.81 mm, color: black, contact surface: Tin, mounting: THR soldering. User information and design recommendations for through hole reflow technology can be found under "Downloads"



The figure shows a 10-position version of the product

## Why buy this product

- Designed for integration into the SMT soldering process
- Screwable flange for superior mechanical stability
- Vertical connection enables multi-row arrangement on the PCB
- Maximum flexibility when it comes to device design – one header for connectors with different connection technologies

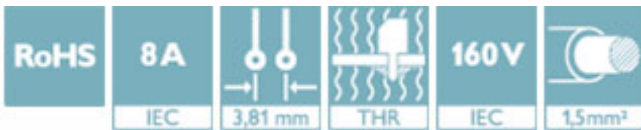

## Key Commercial Data

|              |               |
|--------------|---------------|
| Packing unit | 50 STK        |
| GTIN         |               |
| GTIN         | 4046356034395 |

## Technical data

### Dimensions

|                          |              |
|--------------------------|--------------|
| Length [ l ]             | 7.25 mm      |
| Pitch                    | 3.81 mm      |
| Dimension a              | 26.67 mm     |
| Width [ w ]              | 40.87 mm     |
| Constructional height    | 9.2 mm       |
| Height [ h ]             | 11.8 mm      |
| Length of the solder pin | 2.6 mm       |
| Pin dimensions           | 0,8 x 0,8 mm |
| Hole diameter            | 1.4 mm       |

### General

|                   |                    |
|-------------------|--------------------|
| Range of articles | MCV 1,5/...-GF-THR |
|-------------------|--------------------|

# Printed-circuit board connector - MCV 1,5/ 8-GF-3,81 P26 THR - 1707696

## Technical data

### General

|  |        |
|--|--------|
| Insulating material group              | IIIa   |
| Rated surge voltage (III/3)            | 2.5 kV |
| Rated surge voltage (III/2)            | 2.5 kV |
| Rated surge voltage (II/2)             | 2.5 kV |
| Rated voltage (III/3)                  | 160 V  |
| Rated voltage (III/2)                  | 160 V  |
| Rated voltage (II/2)                   | 250 V  |
| Connection in acc. with standard       | EN-VDE |
| Nominal current $I_N$                  | 8 A    |
| Maximum load current                   | 8 A    |
| Insulating material                    | LCP    |
| Flammability rating according to UL 94 | V0     |
| Color                                  | black  |
| Number of positions                    | 8      |

### Standards and Regulations

|  |        |
|--|--------|
| Connection in acc. with standard       | EN-VDE |
|  | CUL    |
| Flammability rating according to UL 94 | V0     |

### Environmental Product Compliance

|            |   |
|------------|---|
| China RoHS | Environmentally Friendly Use Period = 50  |
|            | For details about hazardous substances go to tab "Downloads", Category "Manufacturer's declaration" |

## Drawings

Diagram

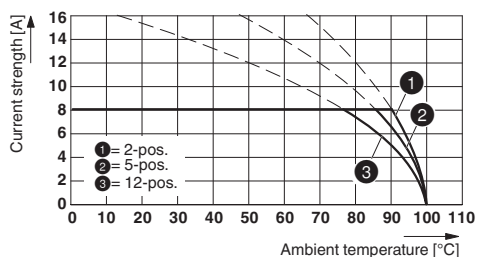

Drilling diagram

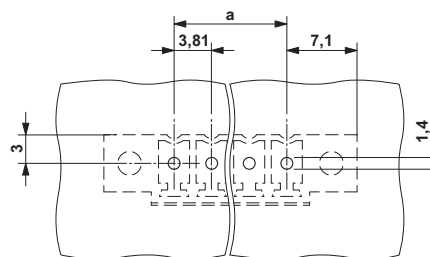

Type: MC 1,5/...-STF-3,81 with MCV 1,5/...-GF-3,81 P26 THR

# Printed-circuit board connector - MCV 1,5/ 8-GF-3,81 P26 THR - 1707696

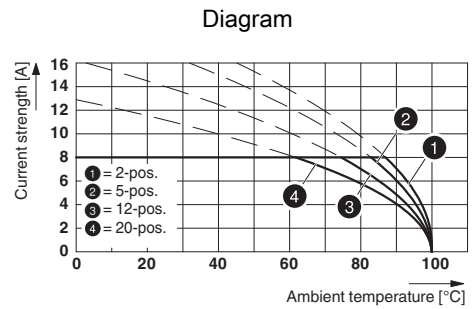
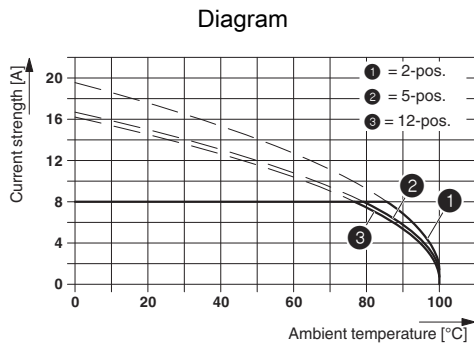

Type: FMC 1,5/...-STF-3,81 with MCV 1,5/...-GF-3,81 P... THR

The figure shows the derating curve for plugs MC 1,5/...-STF-3,81 in combination with header MCV 1,5/...-GF-3,81 P26 THR.

### Dimensional drawing

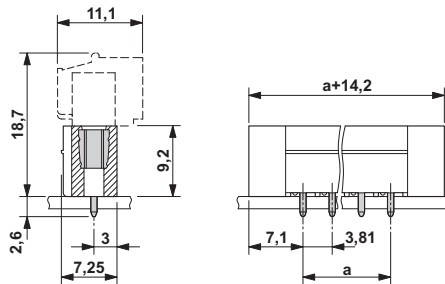

### Approvals

Approvals

---

Approvals

VDE Gutachten mit Fertigungsüberwachung / cULus Recognized / IECCEB Scheme / EAC

---

Ex Approvals

---

### Approval details

|   |       |   |          |
|---|-------|---|----------|
| VDE Gutachten mit Fertigungsüberwachung |       | <a href="http://www.vde.com/en/Institute/OnlineService/VDE-approved-products/Pages/Online-Search.aspx">http://www.vde.com/en/Institute/OnlineService/VDE-approved-products/Pages/Online-Search.aspx</a> | 40011723 |
| Nominal current I <sub>N</sub>          | 8 A   |   |          |
| Nominal voltage U <sub>N</sub>          | 160 V |   |          |

# Printed-circuit board connector - MCV 1,5/ 8-GF-3,81 P26 THR - 1707696

## Approvals

|                    |   |   |                 |
|--------------------|---|---|-----------------|
| cULus Recognized   |  | <a href="http://database.ul.com/cgi-bin/XYV/template/LISEXT/1FRAME/index.htm">http://database.ul.com/cgi-bin/XYV/template/LISEXT/1FRAME/index.htm</a> | E60425-20110128 |
|                    | B   |   | D               |
| Nominal current IN | 8 A   |   | 8 A             |
| Nominal voltage UN | 300 V   |   | 300 V           |

|                    |   |   |                |
|--------------------|---|---|----------------|
| IECEE CB Scheme    |  | <a href="http://www.iecee.org/">http://www.iecee.org/</a> | DE1-59621-B1B2 |
|                    |   |   |                |
| Nominal current IN |   | 8 A   |                |
| Nominal voltage UN |   | 160 V   |                |

|     |  |  |         |
|-----|--|--|---------|
| EAC |  |  | B.01742 |
|-----|--|--|---------|

Phoenix Contact 2017 © - all rights reserved  
<http://www.phoenixcontact.com>

PHOENIX CONTACT GmbH & Co. KG  
Flachsmarktstr. 8  
32825 Blomberg  
Germany  
Tel. +49 5235 300  
Fax +49 5235 3 41200  
<http://www.phoenixcontact.com>