

Control cabinet feed-through - CUC-BH-M12D1PBK-S/R4BE - 1414398

Please be informed that the data shown in this PDF Document is generated from our Online Catalog. Please find the complete data in the user's documentation. Our General Terms of Use for Downloads are valid (<http://phoenixcontact.com/download>)



Control cabinet feed-through, M12, 4-pos., D-coded to RJ45 socket, socket entry: 180°, IP65/IP67

Why buy this product

- Compact design
- 100 Mbps
- IP65/67
- UL



Key Commercial Data

Packing unit	1 STK
GTIN	 4 055626 166759
GTIN	4055626166759
Weight per Piece (excluding packing)	33.900 g
Custom tariff number	85366990
Country of origin	Germany

Technical data

Mechanical characteristics

Number of positions	4
Shielded	yes
Insertion/withdrawal cycles	≥ 100
Cable exit	straight
Color	black
Mounting type	Rear mounting
Degree of protection	IP65/IP67
Design	Straight

Ambient conditions

Control cabinet feed-through - CUC-BH-M12D1PBK-S/R4BE - 1414398

Technical data

Ambient conditions

Ambient temperature (operation)	-25 °C ... 85 °C
---------------------------------	------------------

Material data

Flammability rating according to UL 94	V0
Housing material	PA
Contact material	Copper alloy

Electrical characteristics

Number of positions	4
Nominal voltage U_N	60 V
Nominal current I_N	0.5 A
Transmission characteristics (category)	CAT5 (IEC 11801:2002)
GRP transmission properties	Ethernet
Transmission speed	100 Mbps
Rated current	1.75 A
Rated voltage (III/3)	50 V

Standards and Regulations

Flammability rating according to UL 94	V0
--	----

Environmental Product Compliance

China RoHS	Environmentally Friendly Use Period = 50
	For details about hazardous substances go to tab "Downloads", Category "Manufacturer's declaration"

Drawings

Explosion drawing

Exploded drawing

Dimensional drawing

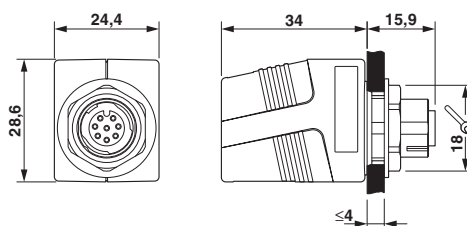

Control cabinet feed-through - CUC-BH-M12D1PBK-S/R4BE - 1414398

Dimensional drawing

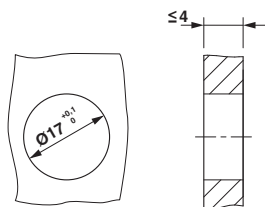

Circuit diagram

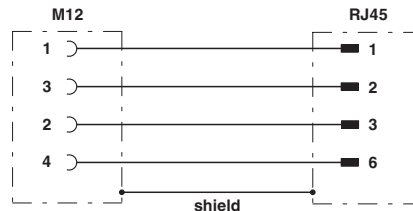

Panel cutout

Circuit diagram

Classifications

eCl@ss

eCl@ss 8.0	27141134
eCl@ss 9.0	27141134

ETIM

ETIM 5.0	EC001283
ETIM 6.0	EC001283

UNSPSC

UNSPSC 13.2	39121410
-------------	----------

Approvals

Approvals

Approvals

UL Listed / cUL Listed / EAC / cULus Listed

Ex Approvals

Approval details

UL Listed		http://database.ul.com/cgi-bin/XYV/template/LISEXT/1FRAME/index.htm E335024-20140306
Nominal current I _N	0.5 A	
Nominal voltage U _N	60 V	

Control cabinet feed-through - CUC-BH-M12D1PBK-S/R4BE - 1414398

Approvals

cUL Listed		http://database.ul.com/cgi-bin/XYV/template/LISEXT/1FRAME/index.htm E335024-20140306
Nominal current I _N		0.5 A
Nominal voltage U _N		60 V

EAC		B.01742
-----	---	---------

cULus Listed	
--------------	---