

PART NUMBER	REV	FIRST USED	POWER UNIT	FEED TYPE	DESCRIPTION
1852590-1	B	122500-1	LEADMAKER	POST FEED	CUTS CARRIER
1852590-2	B	565435-5	BENCH MODEL K	PRE FEED	CUTS CARRIER
1852590-3	B	354500-1	BENCH MODEL G	PRE FEED	CUTS CARRIER
1852590-6	B	122500-1	LEADMAKER	POST FEED	CONTINUOUS CARRIER
7-1852590-7	A	-	-	-	SPARE PARTS

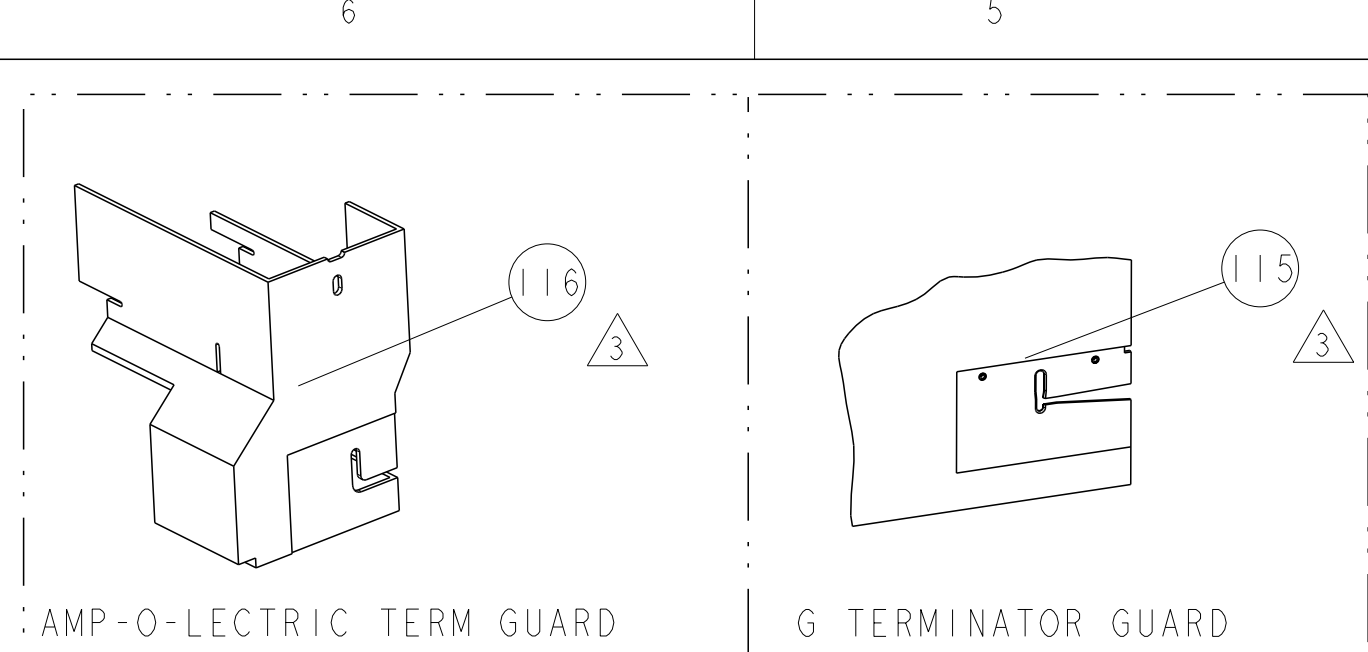

TERMINAL NAME: 2.8mm YESC SEALED

TE P/N	YAZAKI P/N	YAZAKI TERMINAL - YAZAKI CRIMP SPECS		
MALE	FEED 12.32mm			
1572003	7114-4151-02	CRIMP HEIGHT		
-	-	WIRE SIZE		
FEMALE	FEED 16.61mm	1.35±0.05mm [0.053±.002]		
1949535	7116-4151-02	1.30±0.05mm [0.051±.002]		
-	-	1.20±0.05mm [0.047±.002]		
-	-	0.75mm <sup>2</sup>		
-	-	-		
SEAL P/N	CRIMP	SIZE	TYPE	RANGE
1949064-2	7158-3112-70	WIRE 2.29mm [0.090]	F	0.75-1.00mm <sup>2</sup>
1949064-1	7158-3113-40	INSUL 4.19mm [0.165]	O	∅4.32mm [0.170] MAX
WIRE STRIP LENGTH	TERM APPL SPEC	FEED	APPLICATOR INSTRUCTIONS	SET UP GAGE
4.5-5.5mm	NONE	5	408-8040	458637-1

LOC	DIST	REV	DATE	BY	APPD
A	66	A	21NOV2007	RK	GB
		B	15FEB2011	MY	TE

- 1 RECOMMENDED SPARE PARTS
- 2 GREASE LIGHTLY
- 3 GUARD MUST BE IN PLACE WHEN OPERATING APPLICATOR IN A BENCH MACHINE
- 4 APPLY TORO-SEAL IN ALLEN SOCKET TO FILL HOLE AFTER FLAT HD HAS BEEN ADJUSTED TO CORRECT HEIGHT AT QUALIFICATION. APPLY PN 1-23419-5 LOC-TITE TO THREADS.
- 5 FEED ADJUSTMENT REQUIRED WHEN CHANGING BETWEEN MALE & FEMALE TERMINALS  
MALE FEED = 12.32mm  
FEMALE FEED = 16.61mm

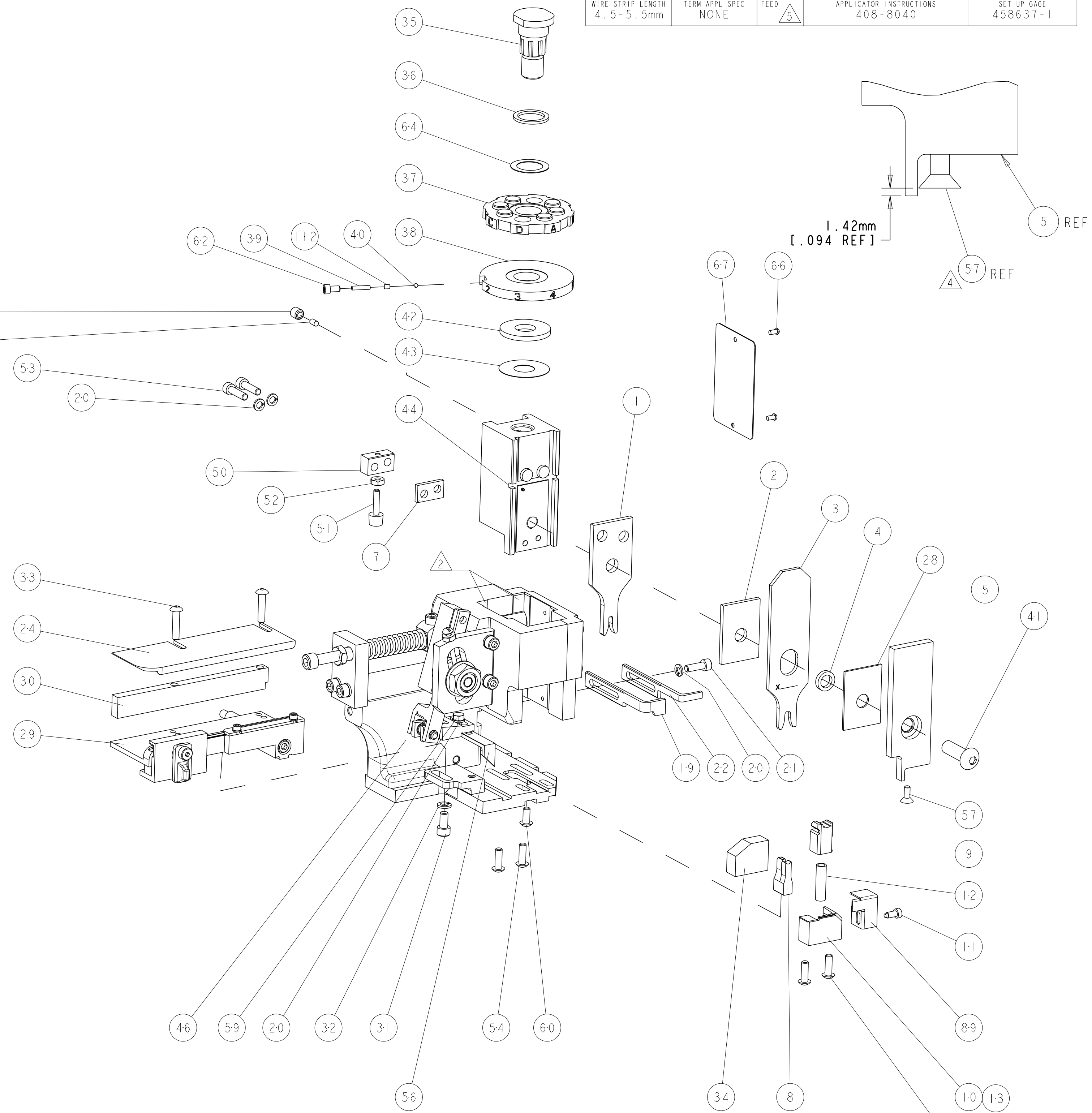
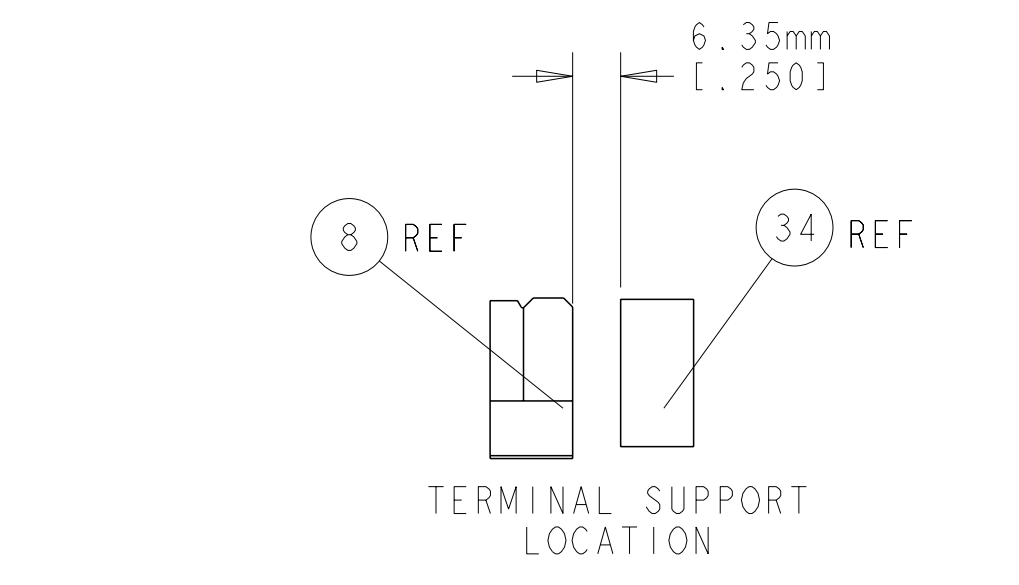
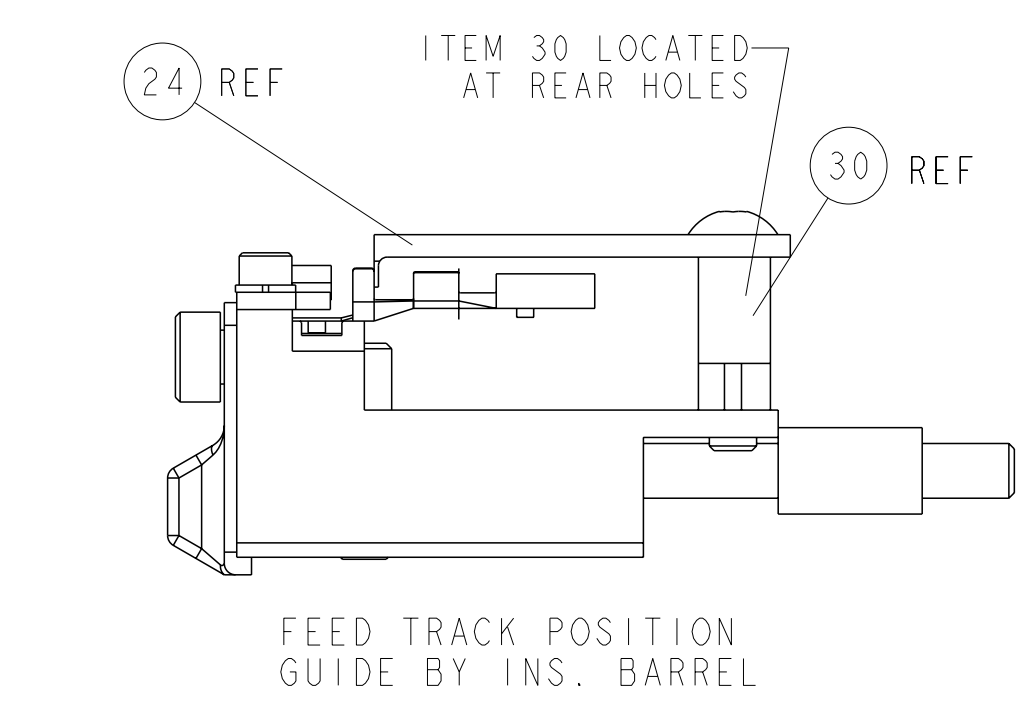
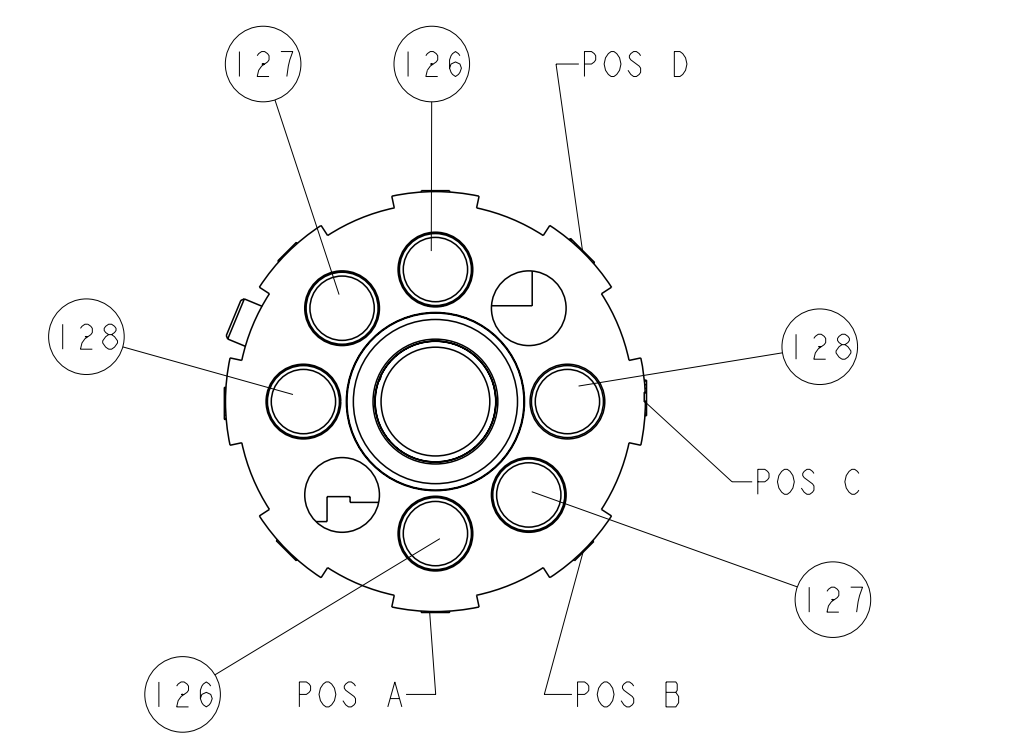

REV	DATE	DESCRIPTION	DATE	BY	APPD		
-	2	2	2	-	3-354779-9	PIN, WIRE DISC, .3185	128
-	2	2	2	-	2-354779-6	PIN, WIRE DISC, .3120	127
-	2	2	2	-	2-354779-2	PIN, WIRE DISC, .3100	126
-	-	REF	-	..	455749-1	GUARD WINDOW	116
-	-	REF	-	..	679532-1	INSERT, GUARD	115
-	1	1	1	-	690603-1	SPRING ASSIST AMP-O-MATOR APPLICATOR	112
-	1	1	1	-	1-21002-7	SCR, BTN SKT HD CAP 6-32 X .375	91
-	1	1	1	-	318563-1	GUARD, FRONT CHIP	89
-	1	1	1	-	4088040	SF APPL INST 408-8040	72
-	1	1	1	-	217238-1	GENERAL INSTRUCTION PKG	71
-	1	1	1	-	461264-1	PLATE, IDENTIFICATION	67
-	2	2	2	-	21017-2	SCREW, DRIVE	66
-	1	1	1	-	986950-1	WASHER, FLAT PRECISION	64
-	1	1	1	-	21009-2	SCR, SET, SELF LOCKING 1/4-20 X .250	63
-	1	1	1	-	23030-1	SCR, SKT HD CAP 6-32 X .25	62
-	1	1	1	-	22733-8	SCR, BHSC, SELF-LOCKING, 8-32 X .375	60
-	1	1	1	-	2-22603-0	SCR, HEX HD CAP 8-32 X .312	59
-	1	1	1	-	1-21003-9	SCR, FLT SKT HD CAP 6-32 X .375	57
-	1	1	1	-	458537-2	PAWL, FEED	56
-	4	4	4	-	2-21002-2	SCR, BTN SKT HD CAP 8-32 X .500	54
-	2	2	2	-	2-21000-8	SCR, SKT HD CAP 8-32 X .625	53
-	1	1	1	-	21018-5	NUT, HEX, REG 6-32	52
-	1	1	1	-	811242-2	BUMPER, HOLD DOWN	51
-	1	1	1	-	690753-1	SPACER, TONKER	50
-	-	-	-	..	690602-6	CAM, PRE FEED, 1 5/8	49
-	-	-	-	..	690602-5	CAM, PRE FEED, 1 1/8	48
-	1	-	-	-	690501-4	CAM, POST-FEED 1 5/8	47
-	1	1	1	-	459456-1	APPL. BASIC SUB ASSY (SIDE WISE MOCA)	46
-	1	1	1	-	690191-1	PLUG, NYLON	45
-	1	1	1	-	819307-4	RAM, SIDE FEED	44
-	1	1	1	-	690125-1	SHIM SUB-ASSY	43
-	1	1	1	-	690124-1	WASHER, RAM (.115)	42
-	1	1	1	-	7-21002-9	SCR, BTN SKT HD CAP 5/16-24 X 1.00	41
-	1	1	1	-	23241-6	BALL, STEEL	40
-	1	1	1	-	690170-1	SPRING, COMPRESSION	39
-	1	1	1	-	1-690142-0	DISC, INSULATION	38
-	1	1	1	-	354777-1	WIRE DISC, ASSEMBLY	37
-	1	1	1	-	22480-5	SPRING, COMPRESSION	36
-	1	1	1	-	690212-1	POST, RAM	35
-	1	1	1	-	690786-1	TERMINAL SUPPORT	34
-	2	2	2	-	2-21002-4	SCR, BTN SKT HD CAP 8-32 X .750	33
-	1	1	1	-	21024-5	WASHER, SPRG LOCK, REG NO 10	32
-	1	1	1	-	3-21000-4	SCR, SKT HD CAP 10-32 X .375	31
-	1	1	1	-	1320908-2	SPACER, STRIP GUIDE	30
-	1	1	1	-	1633091-3	ASSEMBLY, STRIP GUIDE	29
-	1	1	1	-	1-455888-0	SPACER, CRIMPER	28
-	1	1	1	-	1320928-5	PLATE, STRIP GUIDE	24
-	1	-	-	-	690472-2	STRIPPER	22
-	1	1	1	-	2-21000-7	SCR, SKT HD CAP 8-32 X .500	21
-	4	4	4	-	21024-4	WASHER, SPRG LOCK, REG NO 8	20
-	-	-	-	-	691353-1	STRIPPER	19
-	1	-	-	-	679625-2	SHEAR HOLDER, FRONT (NO CUT)	13
-	1	1	1	-	3-22280-3	SPRING, COMPRESSION	12
-	1	1	1	-	690461-2	STOP, SHEAR	11
-	-	-	-	-	1-690459-0	SHEAR HOLDER, FRONT	10
-	1	1	1	-	318707-2	FLOATING SHEAR, FRONT	9
-	1	1	1	-	2-1633110-3	ANVIL, COMBINATION .090	8
-	1	1	1	-	1-240641-6	SPACER	7
-	-	-	-	..	-	-	6
-	1	1	1	-	318701-1	DEPRESSOR, SHEAR	5
-	1	1	1	-	238011-4	BLOCK, CRIMPER SPACER	4
-	1	1	1	-	7-683454-2	CRIMPER, INSULATION 0	3
-	1	1	1	-	2-455888-5	SPACER, CRIMPER	2
-	1	1	1	-	4-456406-4	CRIMPER, WIRE PREMIUM	1

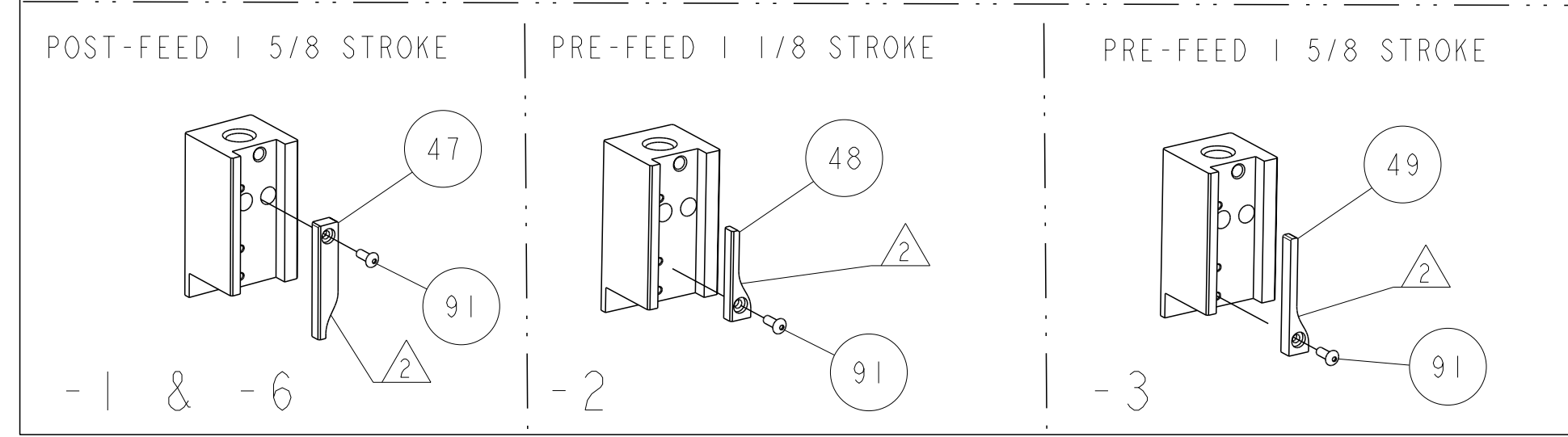

DIMENSIONS:	TOLERANCES UNLESS OTHERWISE SPECIFIED:	FINISH:	WEIGHT:	CAGE CODE:	DRAWING NO:	RESTRICTED TO:
INCHES	9 PLC ±.01 1 PLC ±.01 2 PLC ±.01 3 PLC ±.001 4 PLC ±.0001			A1100779	1852590	