

PART NUMBER	REV	FIRST USED	POWER UNIT	FEED TYPE	DESCRIPTION
1855159-1	A	122500-1	LEADMAKER	POST FEED	CUTS CARRIER
1855159-2	A	565435-5	BENCH MODEL K	PRE FEED	CUTS CARRIER
1855159-3	A	354500-1	BENCH MODEL G	PRE FEED	CUTS CARRIER
1855159-6	A	122500-1	LEADMAKER	POST FEED	CONTINUOUS CARRIER
7-1855159-7	A	-	-	-	SPARE PARTS

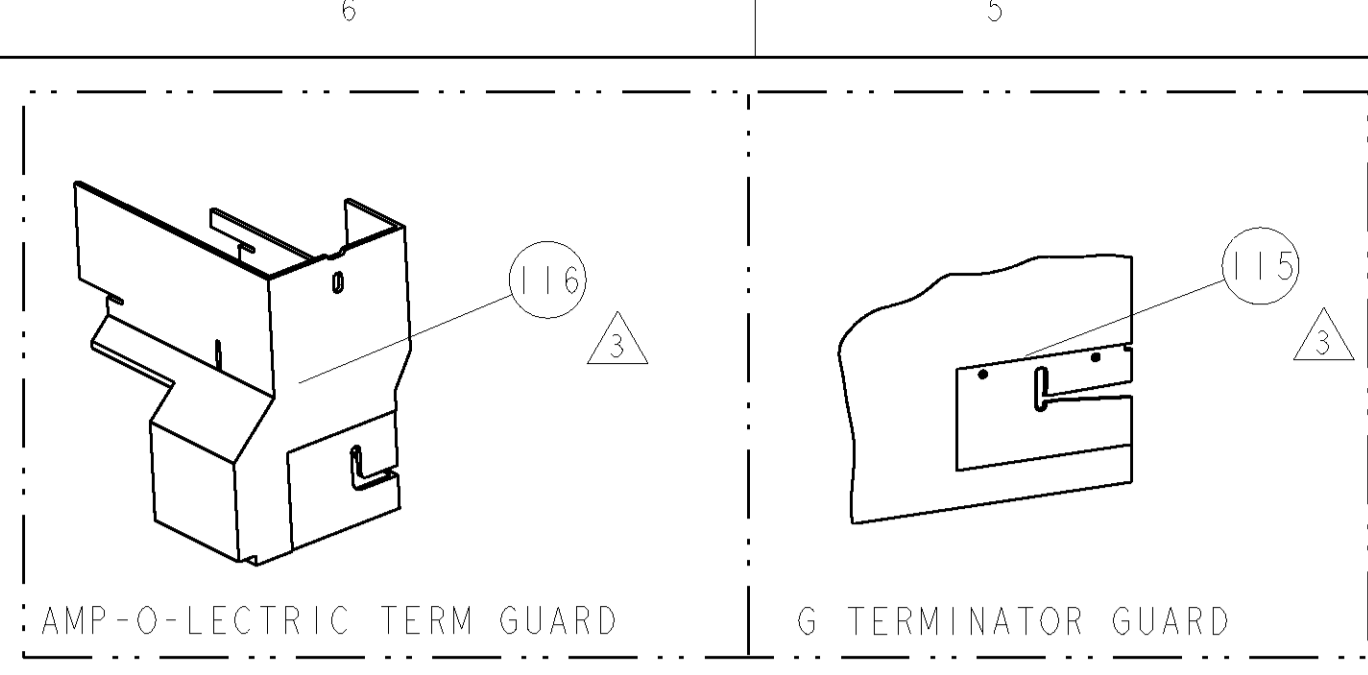

TE	FCI	TERMINAL NAME: DCS-2 Female 1.5mm		
1572788-1	6 000 03 31	AMP TERMINAL - FCI CRIMP SPECS		
1572788-2	6 000 05 31	CRIMP HEIGHT		
1572788-3	6 000 03 34	WIRE SIZE		
1572788-4	6 000 05 34	1.30±0.05mm [.051±.002]	1.00mm2	REF SETTING
1572788-5	6 000 13 34	1.25±0.05mm [.049±.002]	0.75mm2	C0
1949766-1	6 010 02 31	1.20±0.05mm [.047±.002]	0.50mm2	C8
1949766-2	6 010 02 34	-	-	-
1949766-3	6 010 06 31	CRIMP	SIZE	TYPE
1949766-4	6 010 06 34	WIRE	2.05mm [.080]	F
1949766-5	6 010 19 31	INSUL	2.29mm [.090]	O
1949766-6	6 010 19 34	FEED	2.10mm MAX	SET UP GAGE
WIRE STRIP LENGTH	TERM APPL SPEC	APPLICATOR INSTRUCTIONS	SET UP GAGE	
.146 - .161	NONE	408-8040	458637-1	

LOC	DIST	REVISIONS					
A	66	P	LTR	DESCRIPTION	DATE	DWN	APVD
		A1		ECR-08-022103	02SEP2008	RK	GB

- △ RECOMMENDED SPARE PARTS
- △ GREASE LIGHTLY
- △ GUARD MUST BE IN PLACE WHEN OPERATING APPLICATOR IN A BENCH MACHINE
- △ FCI SPECS:
 C33/97/3 REFERS TO 0.50mm2 WIRE
 C35/97/3 REFERS TO 0.75mm2 WIRE
 C36/97/3 REFERS TO 1.00mm2 WIRE

*** WARNING**
 ON INSTALLATION, SET WIRE DISC TO LARGEST WIRE SIZE SETTING. USE OF SETTINGS BELOW MIN. REQUIRED CRIMP HEIGHT SETTING WILL CAUSE DAMAGE TO CRIMP TOOLING.

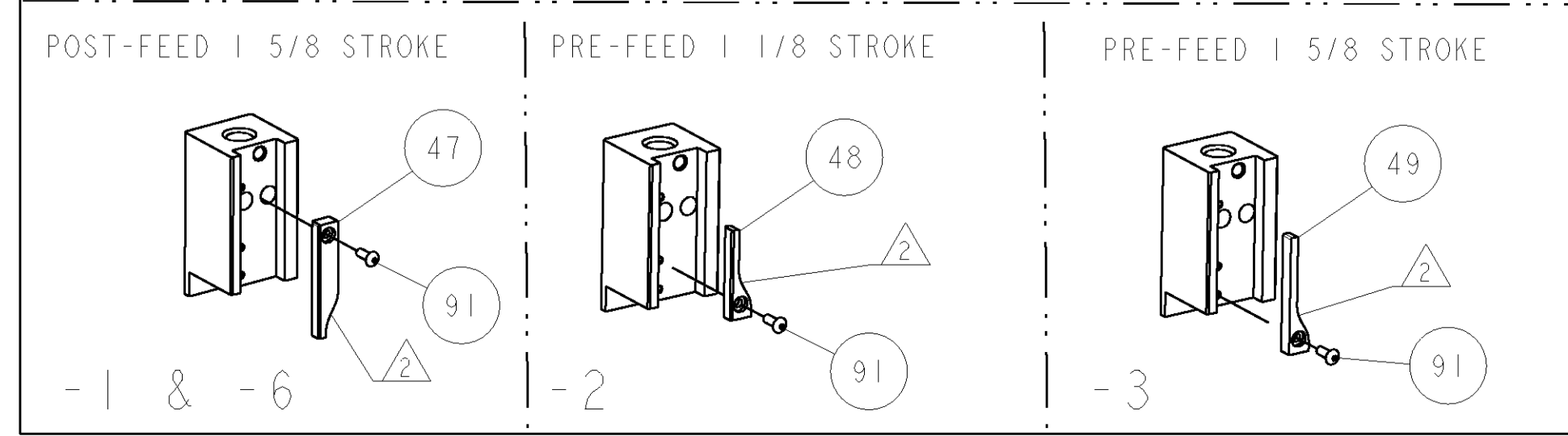
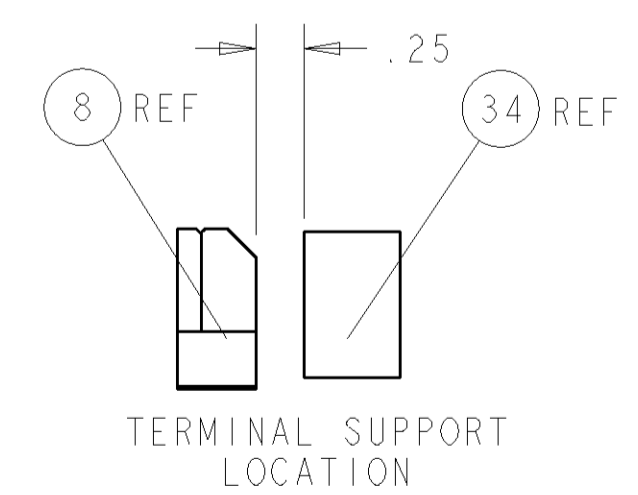
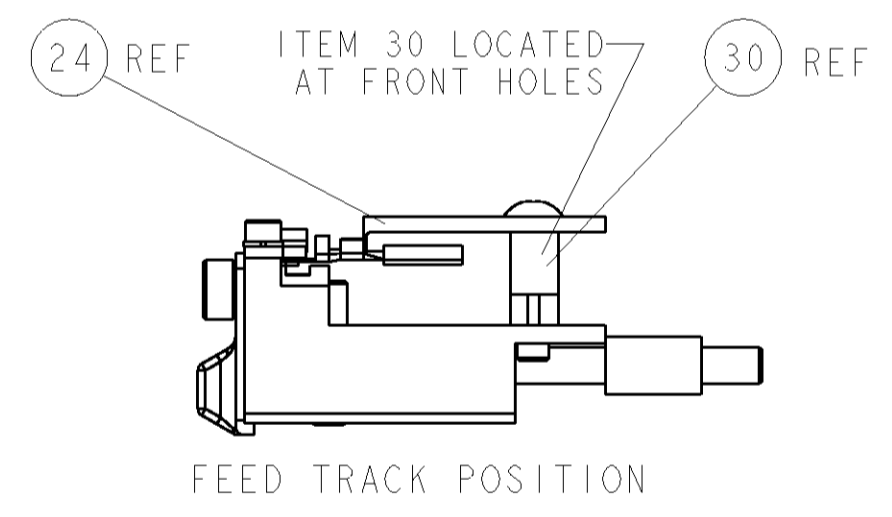
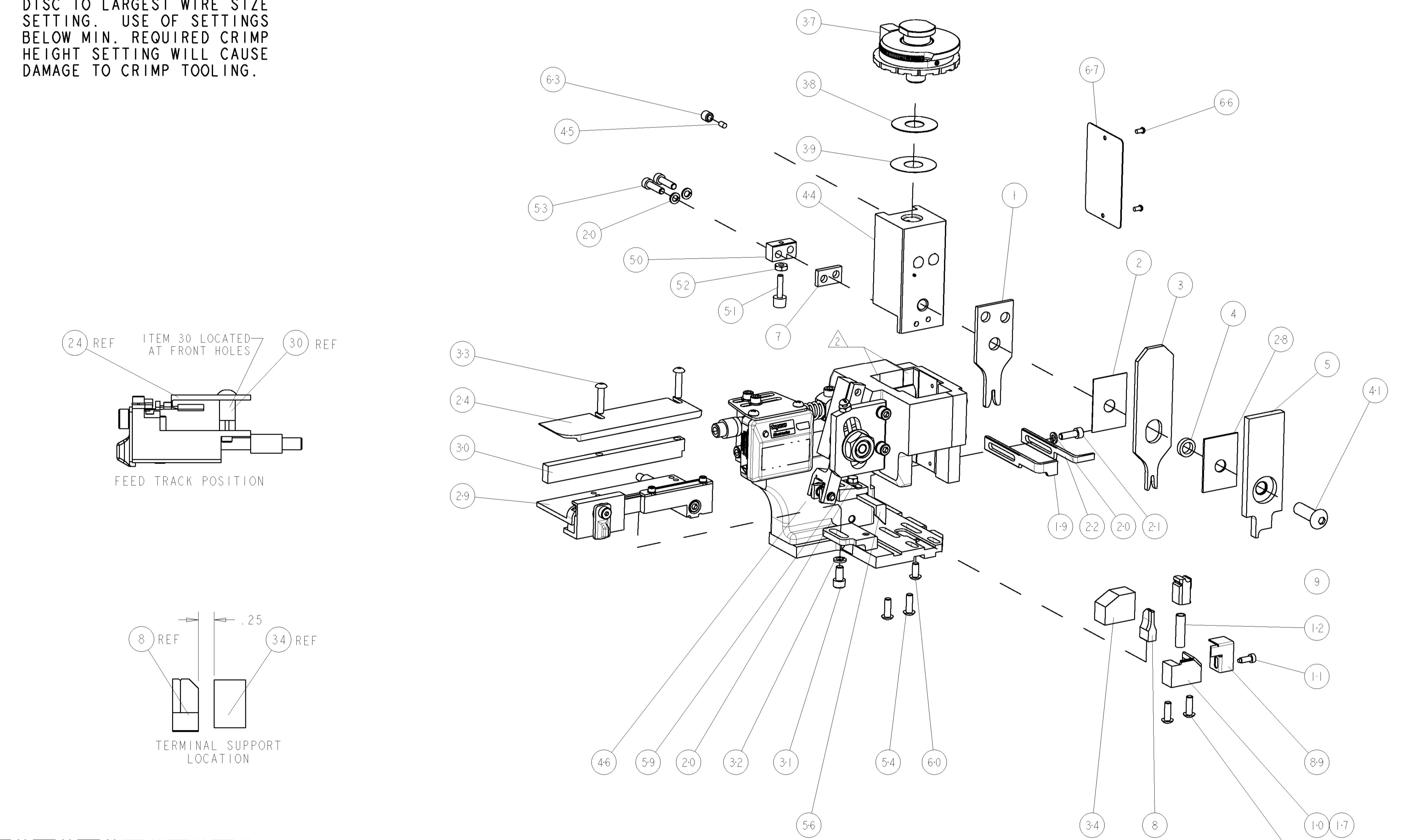

△	-	-	-	REF	-	..	455749-1	GUARD WINDOW	116
△	-	-	REF	-	-	..	679532-1	INSERT, GUARD	115
-	1	1	1	1	1	-	1-21002-7	SCR, BTN SKT HD CAP 6-32 X .375	91
-	1	1	1	1	1	-	318563-1	GUARD, FRONT CHIP	89
-	1	1	1	1	1	-	4088040	SF APPL INST 408-8040	72
-	1	1	1	1	1	-	217238-1	GENERAL INSTRUCTION PKG	71
-	1	1	1	1	1	-	461264-5	PLATE, IDENTIFICATION	67
-	2	2	2	2	2	-	21017-2	SCREW, DRIVE	66
-	1	1	1	1	1	-	21009-2	SCR, SET, SELF LOCKING 1/4-20 X .250	63
-	1	1	1	1	1	-	22733-8	SCR, BHSC, SELF-LOCKING, 8-32 X .375	60
-	1	1	1	1	1	-	2-22603-0	SCR, HEX HD CAP 8-32 X .312	59
-	1	1	1	1	1	-	458537-2	PAWL, FEED	56
-	4	4	4	4	4	-	2-21002-2	SCR, BTN SKT HD CAP 8-32 X .500	54
-	2	2	2	2	2	-	2-21000-8	SCR, SKT HD CAP 8-32 X .625	53
-	1	1	1	1	1	-	21018-5	NUT, HEX, REG 6-32	52
-	1	1	1	1	1	-	811242-2	BUMPER, HOLD DOWN	51
-	1	1	1	1	1	-	690753-1	SPACER, TONKER	50
-	-	-	-	-	-	..	690602-6	CAM, PRE FEED, 1 5/8	49
-	-	-	-	-	-	..	690602-5	CAM, PRE FEED, 1 1/8	48
-	1	-	-	-	-	-	690501-4	CAM, POST-FEED 1 5/8	47
-	1	1	1	1	1	-	459456-1	APPL. BASIC SUB ASSY (SIDE WISE MQCA)	46
-	1	1	1	1	1	-	690191-1	PLUG, NYLON	45
-	1	1	1	1	1	-	455673-1	RAM, SIDE FEED	44
-	1	1	1	1	1	-	7-21002-9	SCR, BTN SKT HD CAP 5/16-24 X 1.00	41
-	1	1	1	1	1	-	690125-1	SHIM SUB-ASSY	39
-	1	1	1	1	1	-	469367-9	SHIM	38
-	1	1	1	1	1	-	879103-3	FINE ADJUST HEAD ASSEMBLY	37
-	1	1	1	1	1	-	690786-3	TERMINAL SUPPORT	34
-	2	2	2	2	2	-	2-21002-4	SCR, BTN SKT HD CAP 8-32 X .750	33
-	1	1	1	1	1	-	21024-5	WASHER, SPRG LOCK, REG NO 10	32
-	1	1	1	1	1	-	3-21000-4	SCR, SKT HD CAP 10-32 X .375	31
-	1	1	1	1	1	-	1-1320908-5	SPACER, STRIP GUIDE	30
-	1	1	1	1	1	-	1633091-4	ASSEMBLY, STRIP GUIDE	29
-	1	1	1	1	1	-	1-455888-0	SPACER, CRIMPER	28
-	1	1	1	1	1	-	1320928-1	PLATE, STRIP GUIDE	24
-	1	1	1	1	1	-	690472-2	STRIPPER	22
-	1	1	1	1	1	-	2-21000-7	SCR, SKT HD CAP 8-32 X .500	21
-	4	4	4	4	4	-	21024-4	WASHER, SPRG LOCK, REG NO 8	20
-	-	-	-	-	-	-	691353-1	STRIPPER	19
△	1	1	1	1	1	-	679625-1	SHEAR HOLDER, FRONT (NO CUT)	17
-	1	1	1	1	1	-	3-22280-3	SPRING, COMPRESSION	12
-	1	1	1	1	1	-	690461-1	STOP, SHEAR	11
△	-	-	-	-	-	-	690459-1	SHEAR HOLDER, FRONT	10
△	-	-	-	-	-	-	462006-1	FLOATING SHEAR, FRONT	9
△	1	1	1	1	1	-	2-1633109-1	ANVIL, COMBINATION .080	8
-	1	1	1	1	1	-	240641-5	SPACER	7
-	1	1	1	1	1	-	1-455889-4	DEPRESSOR, SHEAR	5
-	1	1	1	1	1	-	238011-2	BLOCK, CRIMPER SPACER	4
△	1	1	1	1	1	-	3-1583690-5	CRIMPER, INSUL O	3
△	1	1	1	1	1	-	455888-4	SPACER, CRIMPER	2
△	1	1	1	1	1	-	1-456405-7	CRIMPER, WIRE PREMIUM	1

INCHES	TOLERANCES UNLESS OTHERWISE SPECIFIED:	DIMENSIONS:	FINISH	WEIGHT	CUSTOMER DRAWING
0 PLC	±.001	1 PLC	±.001	-	-
1 PLC	±.001	2 PLC	±.001	-	-
2 PLC	±.001	3 PLC	±.001	-	-
3 PLC	±.001	4 PLC	±.001	-	-
4 PLC	±.001	ANGLES	±.0001	-	-

CUSTOMER VIEWABLE ASSEMBLY