

THIS DRAWING IS UNPUBLISHED. RELEASED FOR PUBLICATION  
 © COPYRIGHT BY TYCO ELECTRONICS CORPORATION. ALL RIGHTS RESERVED.

LOC		DIBT		REVISIONS		
P	LTR	DESCRIPTION	DATE	MIN	APD	
A		ECO-06-004262	25.JUL.06	BSV	MK	

NOTES:

- △ INSULATOR MATERIAL: THRMOPLASTIC POLYESTER, BLACK UL 94V-0
- △ STAMPED CONTACT: BECU, PLATED WITH GOLD FLASH OVER 50-100μ" THK NICKEL
- △ SLEEVE: COPPER, PLATED WITH 180-340μ" THK TIN (LEAD FREE) OVER 75-125μ" THK NICKEL
- 4. PARTS ARE END-TO-END STACKABLE AND BREAKABLE TO CREATE VARIOUS POSITION SIZES

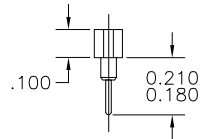
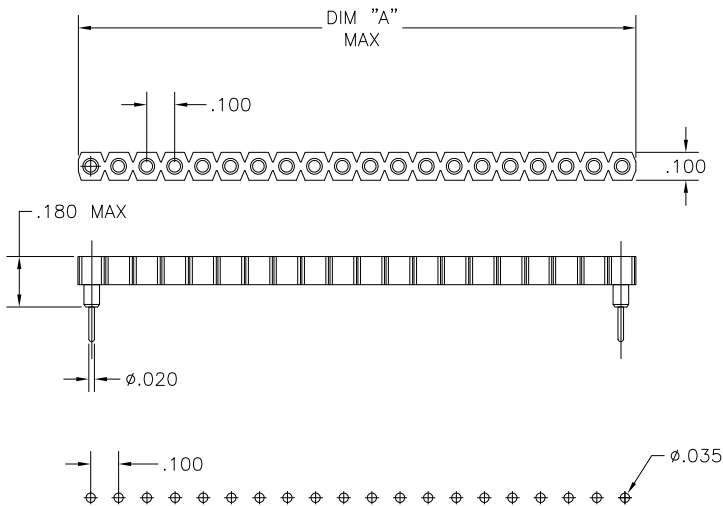

RECOMMENDED HOLE LAYOUT  
 TOLERANCE ±.002 UNLESS  
 OTHERWISE NOTED

1.000	10	1825532-4
0.800	8	1825532-3
0.700	7	1825532-2
1.600	16	1825532-1
DIM "A"	POSITION	PART NO.

THIS DRAWING IS A CONTROLLED DOCUMENT.		DR: S. S. VISWESWARA	25.JUL.06	Tyco Electronics Corporation Harrisburg, Pa 17105-3608	
DIMENSIONS: INCHES		OK	APD: MILLER, KENNETH	NAME: Tyco Electronics	
TOLERANCES UNLESS OTHERWISE SPECIFIED:		PRODUCT SPEC:		ASSEMBLY SOCKET (.510 SERIES S.I.P.)	
0 PLG ± .010 1 PLG ± .010 2 PLG ± .010 3 PLG ± .010 4 PLG ± .010 ANGLES ± .010		APPLICATION SPEC:		SIZE: A2	
MATERIAL: △		FINISH: △△△		CAGE CODE: 00779	
				DRAWING NO: 1825532	
				RESTRICTED TO: -	
		CUSTOMER DRAWING		SCALE: 4:1 SHEET 1 OF 1 REV A	

1825532

A