

HC-B 10-SFQD-74/O1M25

Order No.: 1646502

<http://eshop.phoenixcontact.de/phoenix/treeViewClick.do?UID=1646502>HEAVYCON box mounting base B10, for double locking latch, height
74 mm, with supports 1xM25, with cover**Commercial data**

| | |
|--------------------------|---|
| GTIN (EAN) |  4 017918 985097 |
| Note | Made-to-order |
| sales group | D002 |
| Pack | 10 pcs. |
| Customs tariff | 85389099 |
| Catalog page information | Page 584 (PC-2011) |

Product notesWEEE/RoHS-compliant since:
01/31/2006

<http://www.download.phoenixcontact.com>
Please note that the data given here has been taken from the online catalog. For comprehensive information and data, please refer to the user documentation. The General Terms and Conditions of Use apply to Internet downloads.

Technical data**General data**

| | |
|--------|--|
| Note | For contact inserts HC-B10, BB18, DD42, M, K8/24 |
| Design | B10 |
| Height | 74 mm |
| Width | 57 mm |
| Length | 93 mm |

| | |
|---------------------------------|---|
| Housing type | Box mounting base with cover |
| Locking type | For double locking latch |
| No. of cable exits | 1 |
| Cable exit | Conductor exit direction to the left (looking into the open protective cover) |
| Pg screw connection | None |
| Type of the screw connection | 1x M25 |
| Protective cover | Yes |
| Degree of protection | IP65 protection when the connector is inserted |
| Ambient temperature (operation) | -40 °C ... 125 °C |
| Housing material | Aluminum, die-cast |
| Housing surface material | Powder-coated, gray |
| Seal material | NBR |
| Material, protective cover | PA |

Diagrams/Drawings

Dimensioned drawing

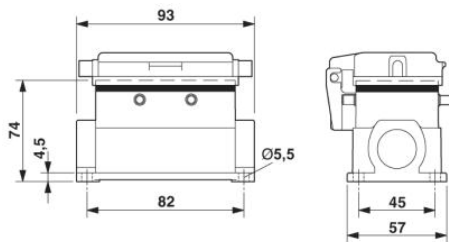

Address

PHOENIX CONTACT Inc., USA
586 Fulling Mill Road
Middletown, PA 17057, USA
Phone (800) 888-7388
Fax (717) 944-1625
<http://www.phoenixcon.com>



© 2011 Phoenix Contact
Technical modifications reserved;