

HC-D 15-SML-52/M1PG16

Order No.: 1772382

<http://catalog.phoenixcontact.net/phoenix/treeViewClick.do?UID=1772382>

Box mounting base, with single locking latch, height 52 mm, with screw connection, 1x Pg16

Commercial data

EAN	 4 017918 037055
sales group	D011
Pack	10 Pcs.
Customs tariff	85389099
Gross weight in pieces	0.23189 KG
Net weight per piece	0.22532 KG
Catalog page information	Page 423 (C-4-2013)

Product notes

WEEE/RoHS-compliant since:
01/31/2006



<http://www.download.phoenixcontact.com>
Please note that the data given here has been taken from the online catalog. For comprehensive information and data, please refer to the user documentation. The General Terms and Conditions of Use apply to Internet downloads.

Technical data**Dimensions**

Height	52 mm
Width	50 mm
Length	93 mm
Wrench size, union nut	22 mm
External cable diameter	7.5 mm ... 15 mm

Ambient conditions

Degree of protection of housing (IP)	IP65
Ambient temperature (operation)	-40 °C ... 125 °C

General

Note	For contact inserts HC-D15, A10
Type	D15
Housing type	Box mounting bases
Locking type	With single locking latch
No. of cable outlets	1
Cable exit	Left (view of the opened single locking latch)
Screw connection	with
Type of the screw connection	1x Pg16
Housing material	Aluminum die-cast
Housing surface material	Powder-coated, gray
Cable gland material	Nickel-plated brass
Cable seal material	NBR
Material lock	Steel, galvanized

Certificates / Approvals



Certification GOST

Certifications applied for:

Certification Ex:

Drawings

Dimensioned drawing

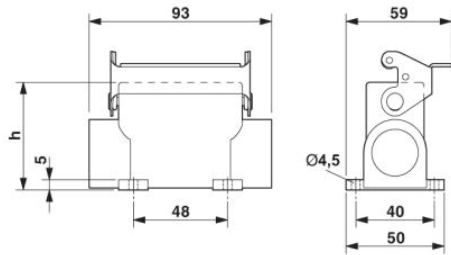

Address

PHOENIX CONTACT Deutschland GmbH
Flachmarktstr. 8
32825 Blomberg, Germany
Phone +49 5235 3 12000
Fax +49 5235 3 41200
<http://www.phoenixcontact.com>



© 2014 Phoenix Contact
Technical modifications reserved;