

## Housing - HC-B 16-KMQ-H-M1PG21 - 1460311

Please be informed that the data shown in this PDF Document is generated from our Online Catalog. Please find the complete data in the user's documentation. Our General Terms of Use for Downloads are valid (<http://phoenixcontact.com/download>)



HEAVYCON B16 coupling housing, with double locking latch, height: 82 mm, with 1 x Pg21 screw connection, straight cable outlet



### Key Commercial Data

Packing unit	1 STK
Weight per Piece (excluding packing)	280.000 g
Custom tariff number	85389099
Country of origin	Germany

### Technical data

#### Dimensions

Height	82 mm
Width	43 mm
Length	94 mm
Wrench size, union nut	28 mm
External cable diameter	10 mm ... 19 mm

#### Ambient conditions

Degree of protection of housing (IP)	IP65
Ambient temperature (operation)	-40 °C ... 125 °C

#### General

Note	For contact inserts HC-B16, BB32, BBB40, D40, DD72, HS6, M, K
Size	B16
Housing type	Coupling housings
Locking type	With double locking latch

# Housing - HC-B 16-KMQ-H-M1PG21 - 1460311

## Technical data

### General

No. of cable outlets	1
Cable exit	straight
Screw connection	with
Type of the screw connection	1x Pg21
Housing material	Aluminum die-cast
Housing surface material	Powder-coated, gray
Seal material	NBR
Material lock	Stainless steel, handle: PA
Material grip body interlock	PA

## Drawings

Dimensional drawing

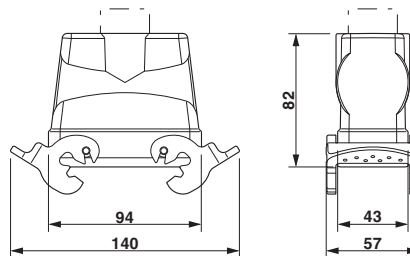

Dimensional drawing

## Classifications

### eCl@ss

eCl@ss 4.0	27140816
eCl@ss 4.1	27140816
eCl@ss 5.0	27143424
eCl@ss 5.1	27143424
eCl@ss 6.0	27143424
eCl@ss 7.0	27440209
eCl@ss 8.0	27440202
eCl@ss 9.0	27440202

### ETIM

ETIM 3.0	EC000437
ETIM 4.0	EC000437
ETIM 5.0	EC000437

# Housing - HC-B 16-KMQ-H-M1PG21 - 1460311

## Classifications

### UNSPSC

UNSPSC 6.01	31261502
UNSPSC 7.0901	31261502
UNSPSC 11	31261502
UNSPSC 12.01	31261502
UNSPSC 13.2	31261502

## Approvals

### Approvals

---

Approvals

EAC

---

Ex Approvals

---

### Approval details

EAC 7500651.22.01.00246
-------------------------

---

# Mouser Electronics

Authorized Distributor

Click to View Pricing, Inventory, Delivery & Lifecycle Information:

[Phoenix Contact:](#)

[1460311](#)