

Alle Rechte vorbehalten/ All rights reserved

Position  
position — 25

e  
d  
c  
b  
a  
Reihe  
row

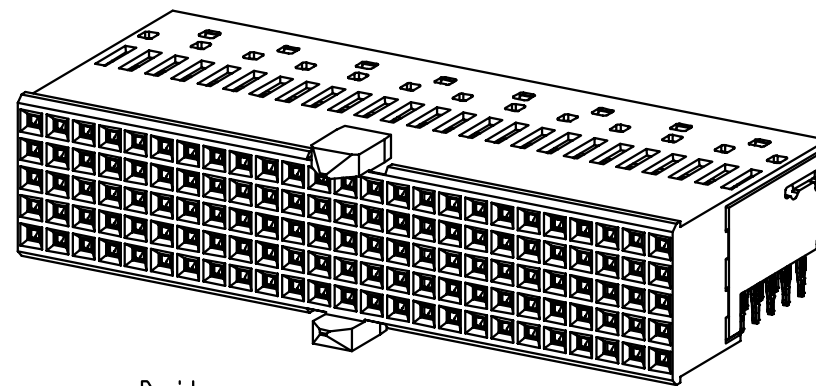
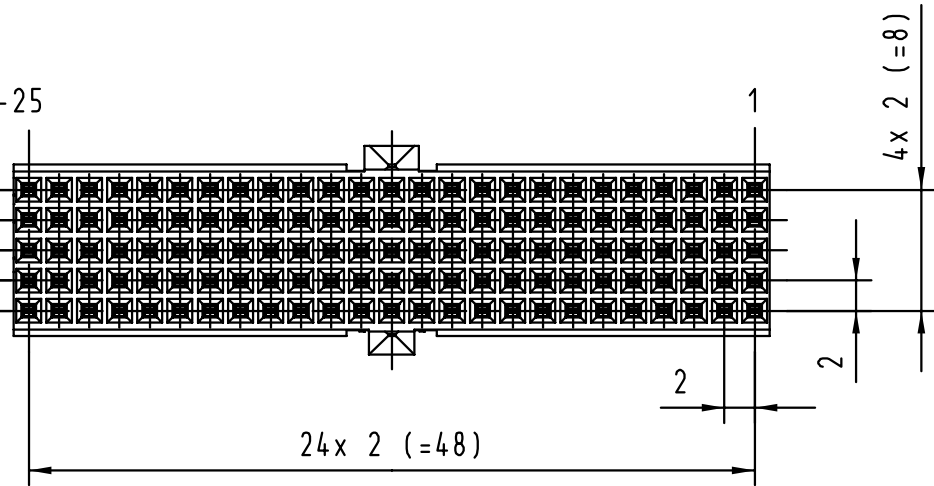

X  
5:1

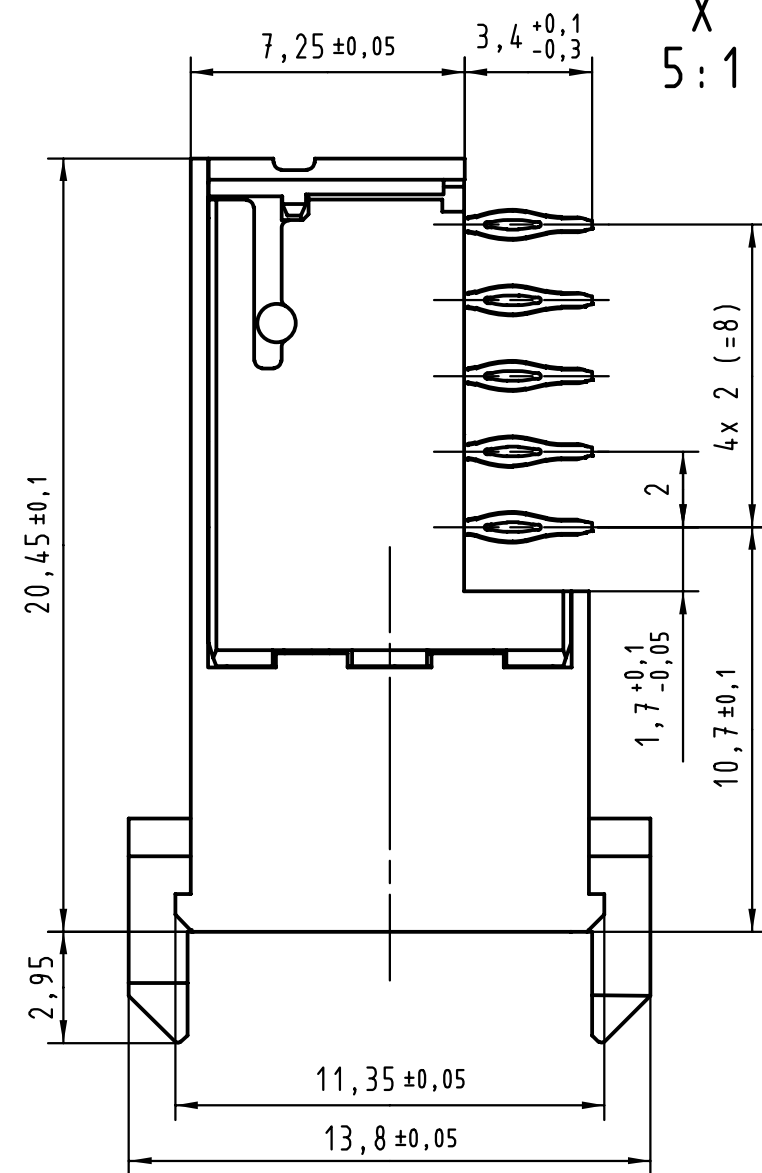

Reihe  
row

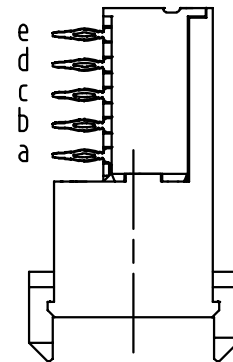

X

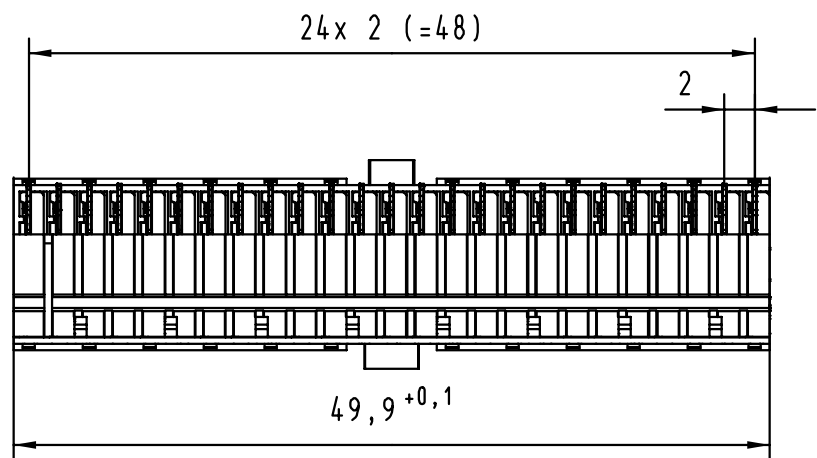
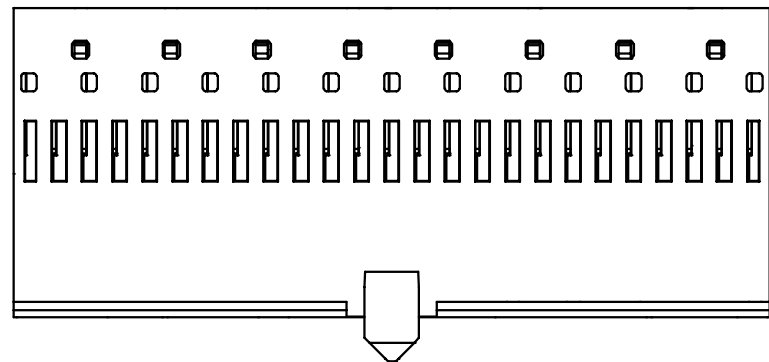

**Lochbild  
Board drillings**

alle Löcher  
all holes

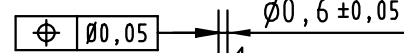

Bohrlochdurchmesser:  $\phi 0,7 \pm 0,02$  mm  
Lochdurchmesser (mit Oberfläche):  $\phi 0,6 \pm 0,05$  mm  
drill hole dia.:  $\phi 0,7 \pm 0,02$  mm  
through hole dia. (after plating):  $\phi 0,6 \pm 0,05$  mm

Position  
position — 25

e  
d  
c  
b  
a  
Reihe  
row

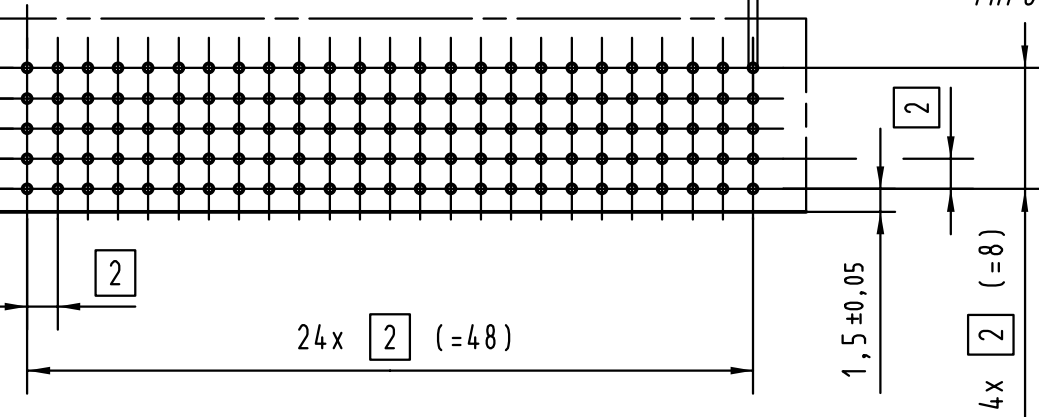

17 35 125 <u>4</u> 101	—	min. 0,76 $\mu$ m (30 $\mu$ m) Au über/over min. 1,27 $\mu$ m (50 $\mu$ m) Ni
17 35 125 <u>2</u> 101	2	Au über/over Ni
17 35 125 <u>1</u> 101	1	Au über/over Ni
Bestell-Nr. Part-No.	Anforderungsstufe nach IEC performance level per IEC	Kontaktoberfläche Contact Plating per IEC

All Dimensions in mm Original Size DIN A 3		Techn. Character.		Nicht tolerierte Maße/Free size tolerances siehe/see IEC 61076-4-101	
				Maßstab/Scale 2:1 5:1	
				har-bus HM Federleiste, Typ AB-25, 125 pol. har-bus HM female connector, type AB-25, 125 pol.	
27619				HARTING KGaA D-32339 ESPELKAMP	
Mod.	Dat.	Name		TB 17 35 125 x101	
				Sub.	

Blatt/ page