

This drawing involves proprietary design rights of Tyco Electronics Corporation, and all design, manufacture, reproduction, use and sale rights regarding the same are expressly reserved. It is submitted for a specific purpose and the recipient by accepting this drawing, assumes custody and control and agrees to take reasonable precautions; (a) that this drawing will not be copied and reproduced, in whole or in part, or its contents revealed in any manner, or to any person except to meet the purpose for which it was delivered and (b) that any special features peculiar to this design will not be incorporated in other projects without the expressed written permission of Tyco Electronics Corporation.

REVISIONS

EC	REV	DESCRIPTION	DATE
10859	A	INITIAL RELEASE	03/05/99
12180	B	CHANGED CONNECTOR FROM MODULAR TO DEDICATED	09/28/00
0S1Q-0234-04	B1	ADDED PART NO. 279-0565-00300. CHANGED DRAWING TO TYCO FORMAT.	06/17/04

7. MODULE INFORMATION

CONNECTOR	TYCO PART #	ELCON PART NUMBER	CATALOG MODULE #		QTY	SIZE NO.	MATING PIN	MAX. CURRENT (PER CONTACT)	CONTACT SPACING	VOLTAGE RATING*			
PIN	1646810-1	279-0565-00100B	FP731	POWER	8	8	1.25 X 7.00 [.049 X .276]	35 AMPERES	7.50 [2.953]	250 VOLTS			
				SIGNAL	6	22	.64 [0.025] SQ.	3 AMPERES	2.50 [0.0984]	125 VOLTS			
				LEFT MOUNTING FLANGE									
				RIGHT MOUNTING FLANGE									
PIN	1646810-2	279-0565-00300B	FP731	POWER	8	8	1.25 X 7.00 [.049 X .276]	35 AMPERES	7.50 [2.953]	250 VOLTS			
				SIGNAL	24	22	.64 [0.025] SQ.	3 AMPERES	2.50 [0.0984]	125 VOLTS			
				LEFT MOUNTING FLANGE									
				RIGHT MOUNTING FLANGE									

*IAW IEC-950

NOTES: UNLESS OTHERWISE SPECIFIED.

1. PART NUMBER CHANGES AND OR DESIGN CHANGES AFFECTING ITEM INTERCHANGEABILITY REQUIRE PRIOR ELCON APPROVAL AND AUTHORIZATION BY REVISION TO THIS DRAWING.

2. MATERIALS:

INSULATORS: THERMOPLASTIC, GLASS REINFORCED, COLOR BLACK. UL94V-0 FLAMMABILITY RATED.

SOLDER SIGNAL PIN: BRASS ALLOY.

COMPLIANT SIGNAL PIN: PHOSPHOR BRONZE ALLOY.

POWER CONTACTS: PHOSPHOR BRONZE ALLOY, COPPER ALLOY.

CROWN BANDS: BERYLLIUM COPPER ALLOY.

3. FINISHES:

CONTACTS: GOLD PLATED PER MIL-G-45204 TYPE II, CLASS 0, .000030" MIN. THK, OVER NICKEL PER QQ-N-290, CLASS 2, .000040" MIN. THK. SOLDER TAILS, TIN/LEAD (90/10) PER ASTM B 545, .000100" MIN. THICK.

4 MOUNTING FLANGES ACCEPT M3 OR NO. 4 SCREWS, (USER SUPPLIED).

5. ITEMS PROVIDED TO THIS SPECIFICATION TO BE PERMANENTLY IDENTIFIED PER THE FOLLOWING IDENTIFIER:

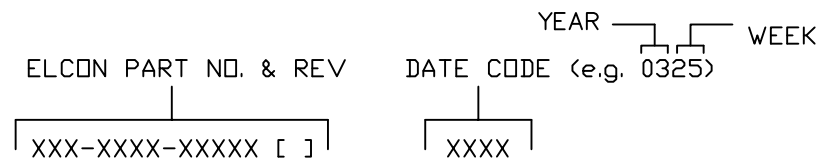

6. THIS CONNECTOR MATES WITH SOCKET CONNECTOR PN 279-0565-00200/-00400.

<p>THIRD ANGLE PROJECTION</p> <p>UNLESS OTHERWISE SPECIFIED DIMENSIONS ARE IN METRIC [INCHES]</p> <p>TOLERANCES</p> <p>ANGLES ± .5°</p> <p>DECIMALS</p> <p>.XX ± .25 [.010]</p> <p>.X ± .5 [.020]</p>	<p>DRAWN</p> <p>R.F.A.</p>	<p>DATE</p> <p>03/05/99</p>	<p>tyco Tyco Electronics Corporation Menlo Park, Ca 94025</p> <p>ELCON</p>		
	CHECKED		TITLE		
	APPROVED		PIN CONNECTOR, FLATPAQ RIGHT ANGLE, SOLDER & COMPLIANT TAILS PN: 279-0565-00100B/279-0565-00300B		
	APPROVED		SIZE	DWG NUMBER	REV.
	D. CHAU	06/17/04	B	C = 1646810	B1
	M. ALIM	07/07/04			
	ACAD FILE NUMBER	C1646810B1.DWG		DWG SCALE	1 = 1 SH 1 OF 4

This drawing involves proprietary design rights of Tyco Electronics Corporation, and all design, manufacture, reproduction, use and sale rights regarding the same are expressly reserved. It is submitted for a specific purpose and the recipient by accepting this drawing, assumes custody and control and agrees to take reasonable precautions; (a) that this drawing will not be copied and reproduced, in whole or in part, or its contents revealed in any manner, or to any person except to meet the purpose for which it was delivered and (b) that any special features peculiar to this design will not be incorporated in other projects without the expressed written permission of Tyco Electronics Corporation.

REVISIONS			
EC	REV	DESCRIPTION	DATE
		SEE SHEET 1	

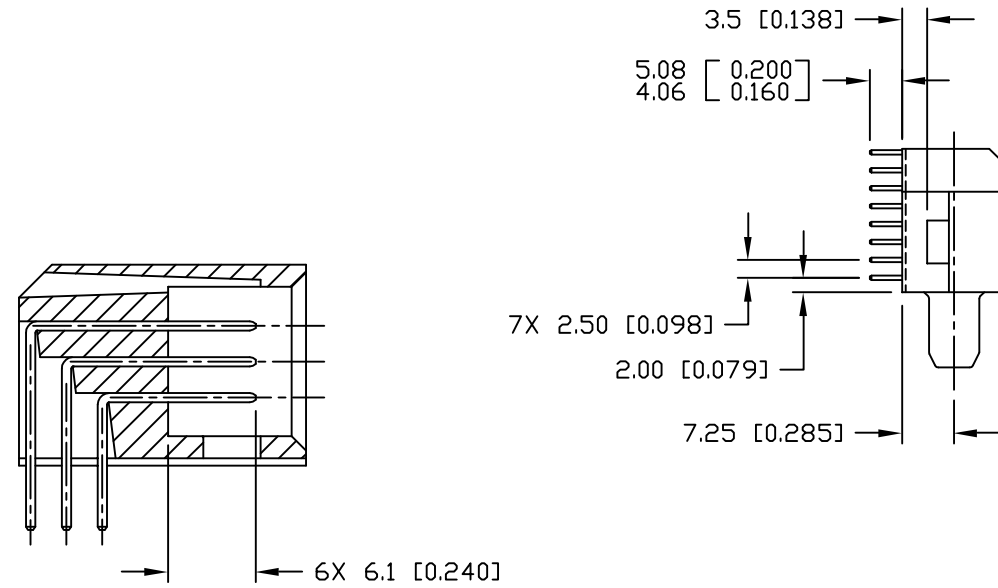

SECTION A-A

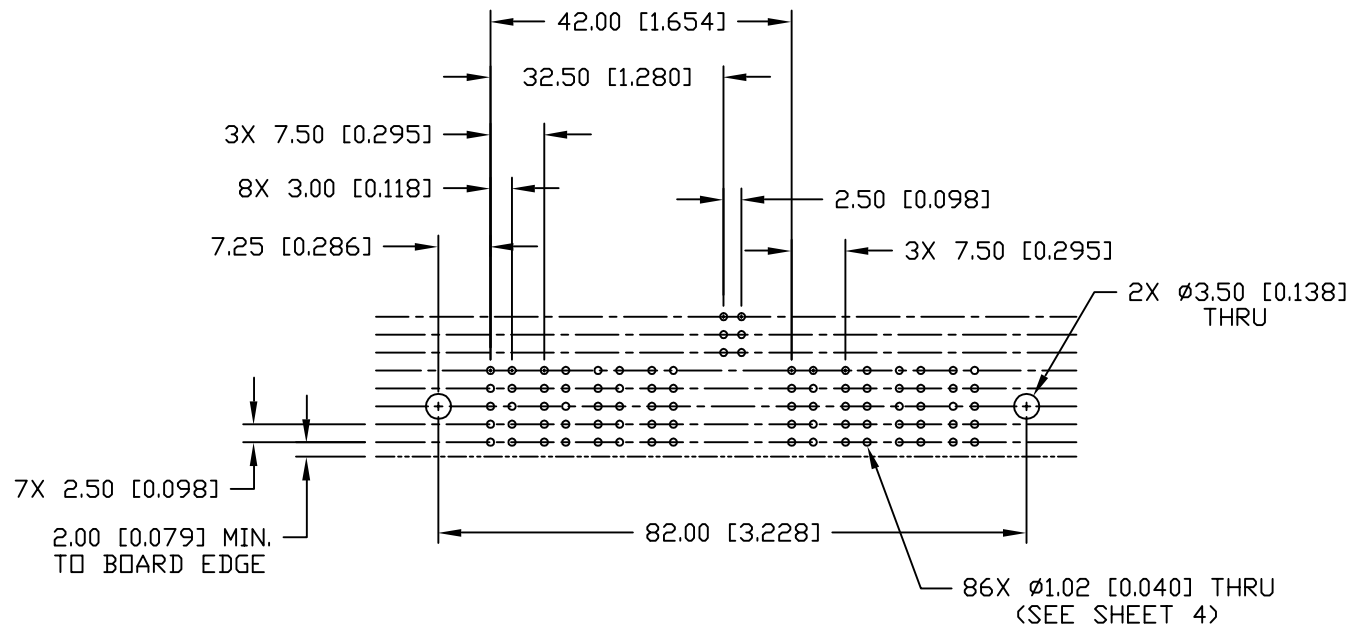
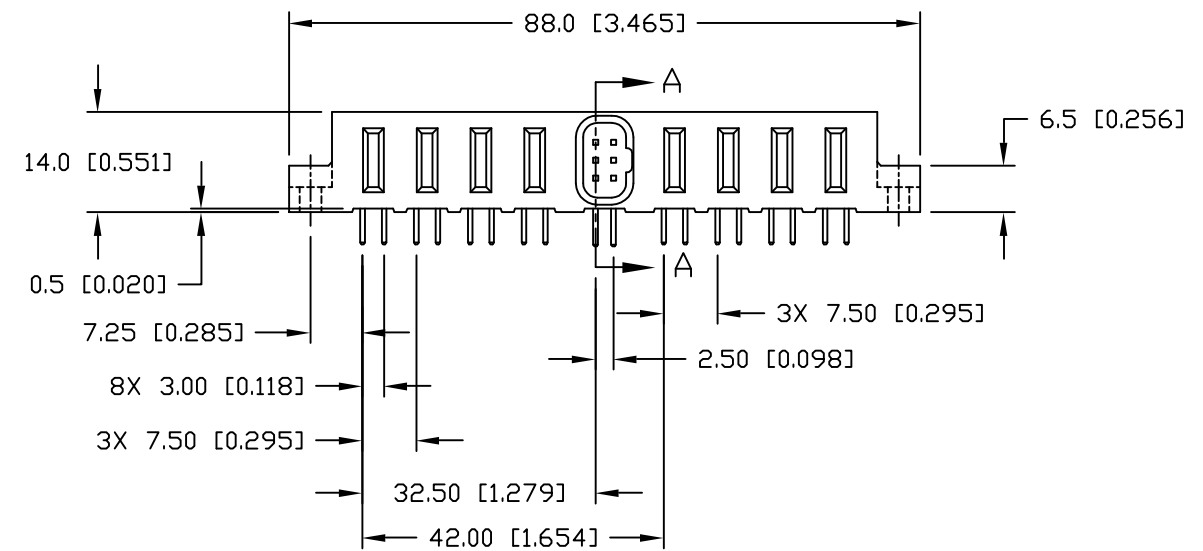
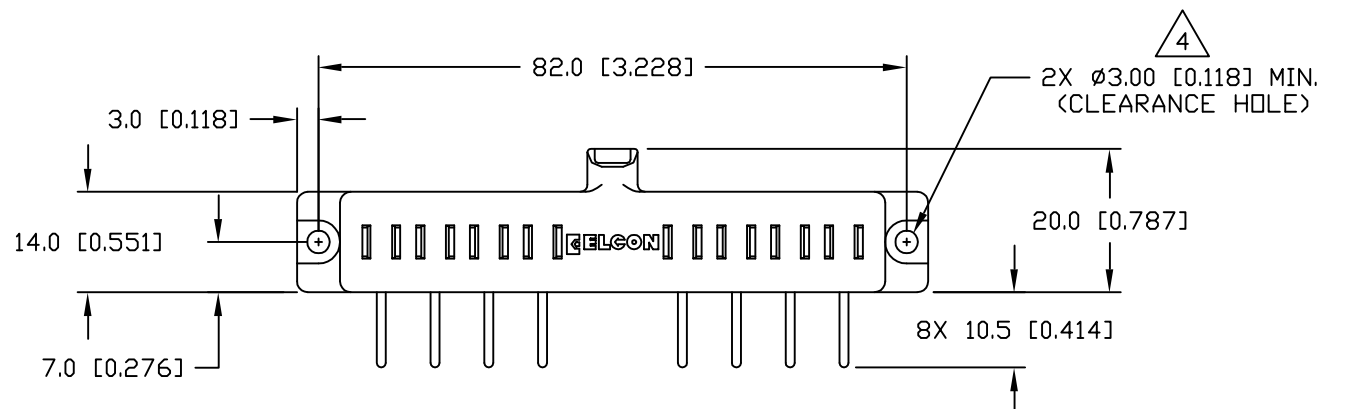

PRINTED CIRCUIT LAYOUT

THIRD ANGLE PROJECTION UNLESS OTHERWISE SPECIFIED DIMENSIONS ARE IN METRIC [INCHES] TOLERANCES ANGLES \pm .5° DECIMALS .XX \pm .25 [.010] .X \pm .5 [.020]	DRAWN R.F.A. CHECKED	DATE 03/05/99	tyco Tyco Electronics Corporation Electronics Menlo Park, Ca 94025 ELCON	TITLE PIN CONNECTOR, FLATPAQ RIGHT ANGLE, SOLDER TAILS PN: 279-0565-00100B	
	APPROVED D. CHAU APPROVED M. ALIM	DATE 06/17/04 07/07/04			SIZE B
	ACAD FILE NUMBER C1646810B1.DWG	DWG SCALE 1 = 1	SH 2 OF 4		

This drawing involves proprietary design rights of Tyco Electronics Corporation, and all design, manufacture, reproduction, use and sale rights regarding the same are expressly reserved. It is submitted for a specific purpose and the recipient by accepting this drawing, assumes custody and control and agrees to take reasonable precautions; (a) that this drawing will not be copied and reproduced, in whole or in part, or its contents revealed in any manner, or to any person except to meet the purpose for which it was delivered and (b) that any special features peculiar to this design will not be incorporated in other projects without the expressed written permission of Tyco Electronics Corporation.

REVISIONS

EC	REV	DESCRIPTION	DATE
		SEE SHEET 1	

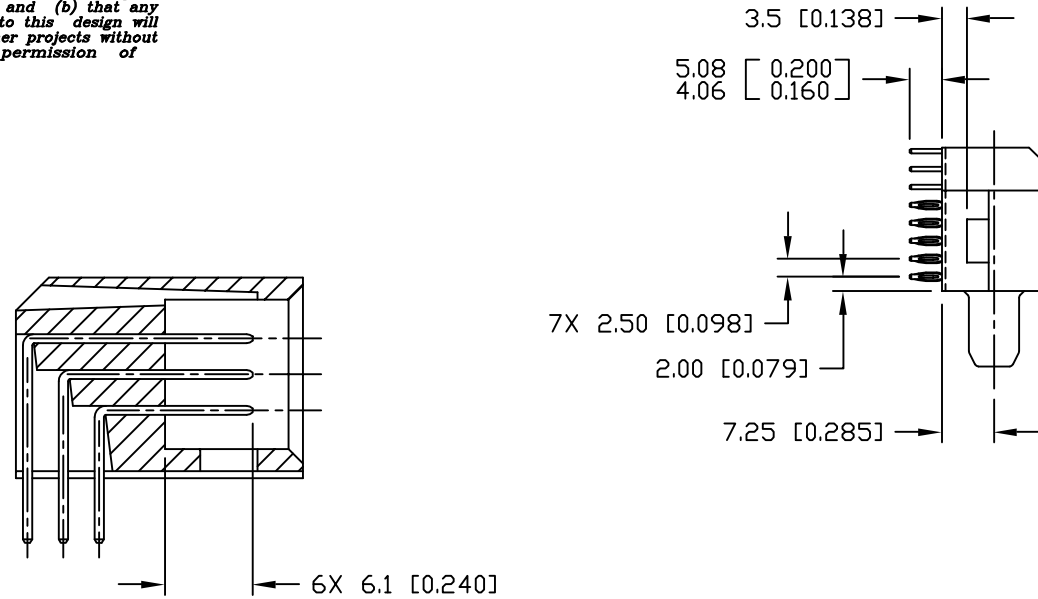

SECTION A-A

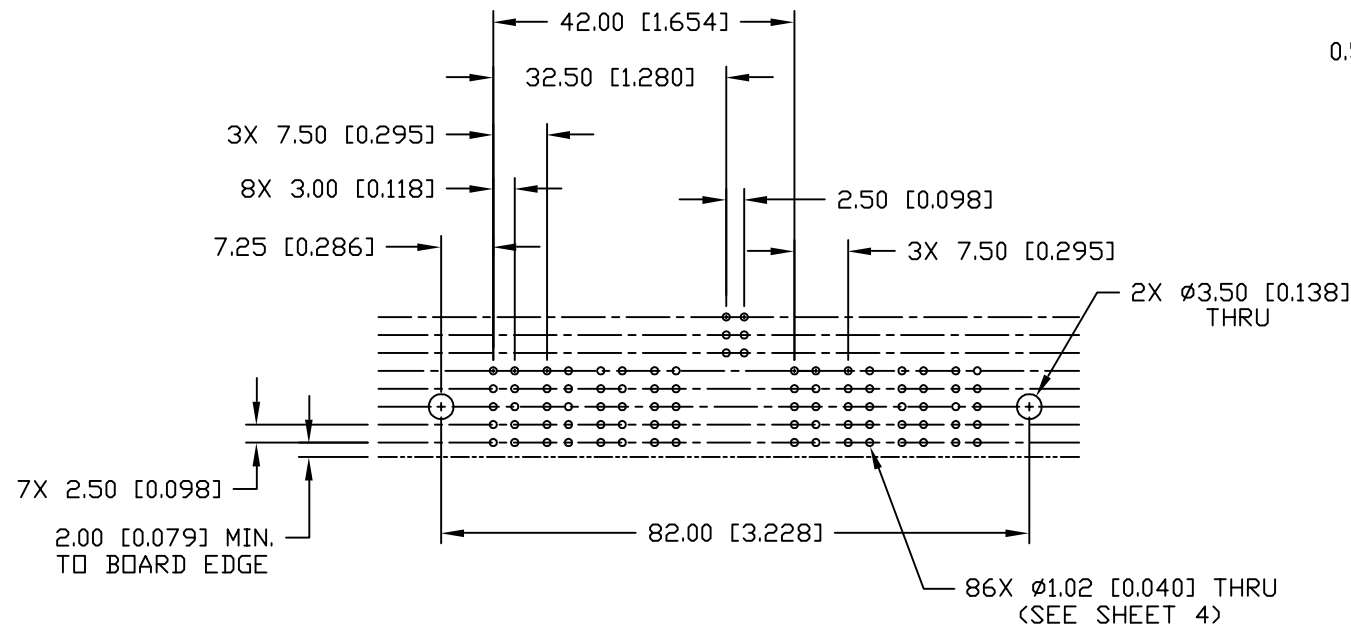
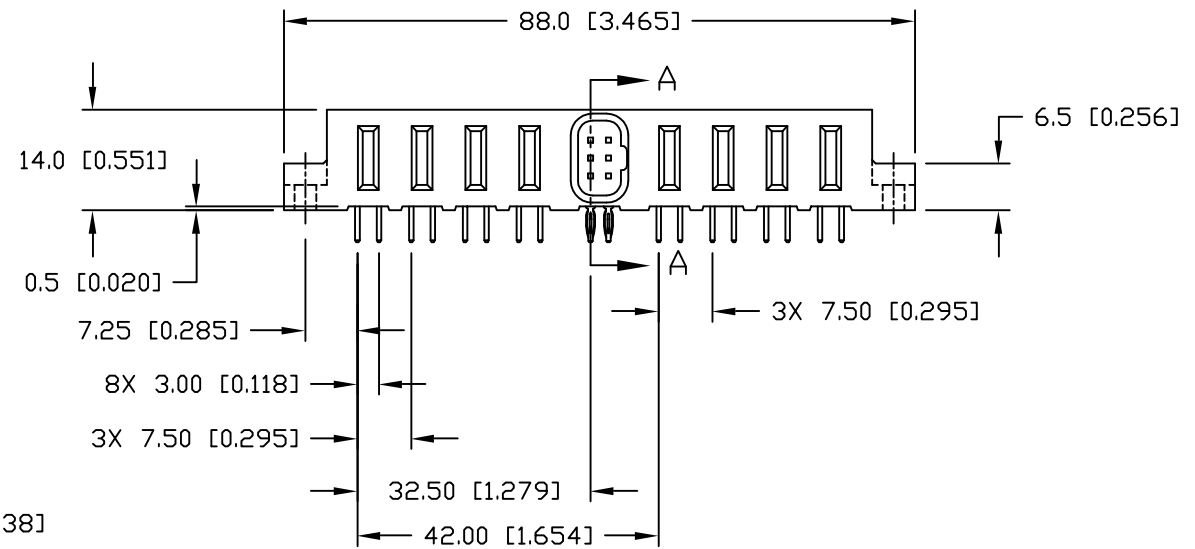
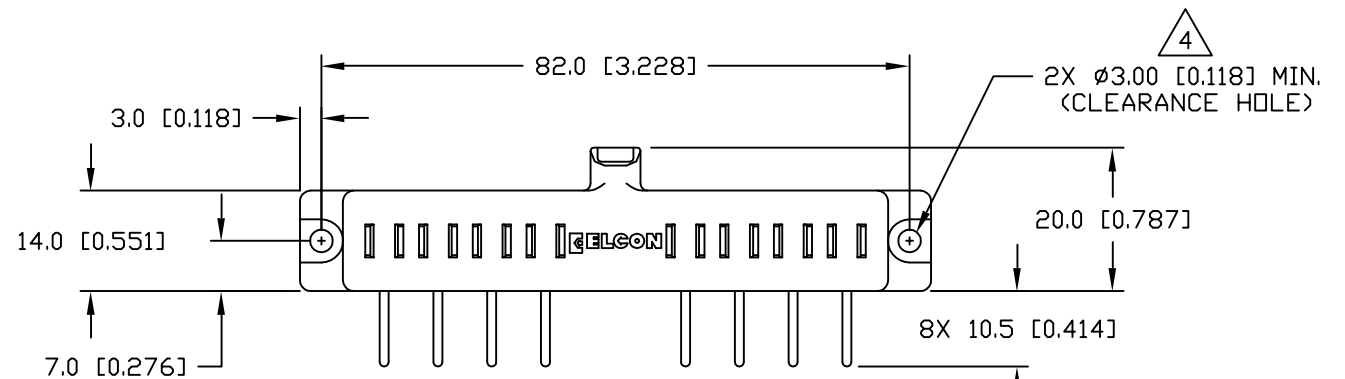

PRINTED CIRCUIT LAYOUT

UNLESS OTHERWISE SPECIFIED DIMENSIONS ARE IN METRIC [INCHES] TOLERANCES ANGLES ± .5° DECIMALS .XX ± .25 [.010] .X ± .5 [.020]	DRAWN R.F.A. CHECKED	DATE 03/05/99	tyco Tyco Electronics Corporation Electronics Menlo Park, Ca 94025 ELCON	TITLE PIN CONNECTOR, FLATPAQ RIGHT ANGLE, COMPLIANT TAILS PN: 279-0565-00300B	
	APPROVED APPROVED D. CHAU DCA APPROVED M. ALIM	DATE 06/17/04 07/07/04			SIZE B
	ACAD FILE NUMBER C1646810B1.DWG	DWG SCALE 1=1	SH 3 OF 4		

This drawing involves proprietary design rights of Tyco Electronics Corporation, and all design, manufacture, reproduction, use and sale rights regarding the same are expressly reserved. It is submitted for a specific purpose and the recipient by accepting this drawing, assumes custody and control and agrees to take reasonable precautions; (a) that this drawing will not be copied and reproduced, in whole or in part, or its contents revealed in any manner, or to any person except to meet the purpose for which it was delivered and (b) that any special features peculiar to this design will not be incorporated in other projects without the expressed written permission of Tyco Electronics Corporation.

REVISIONS			
EC	REV	DESCRIPTION	DATE
		SEE SHEET 1	

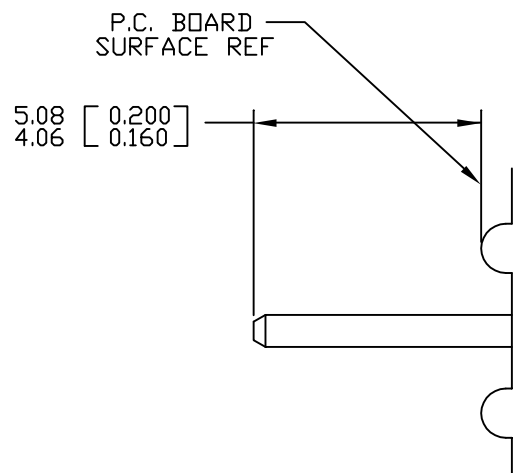

SOLDER PIN DETAIL

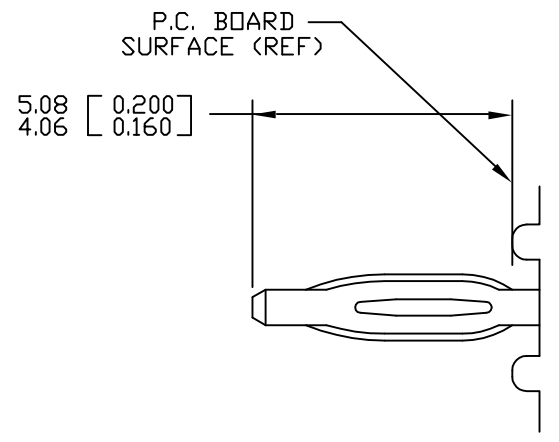

COMPLIANT PIN DETAIL
INSERTION/EXTRACTION FORCES

MAXIMUM PUSH-IN: 133.3N PER PIN [30 LBS]
MINIMUM PUSH-OUT: 44.4N PER PIN [10 LBS]

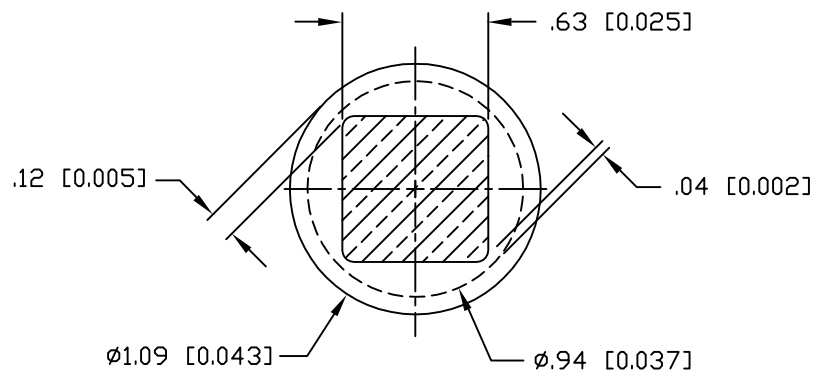

SOLDER TERMINATION AREA

RECOMMENDED PRINTED CIRCUIT HOLE
FINISHED HOLE: ø1.02 [0.040] ±.08 [0.003]
DRILLED HOLE: ø1.15 [0.0453] ±.013 [0.0005]
COPPER PLATE: .025 [0.0010] MINIMUM (PER SURFACE)
TIN PLATE: .008 [0.0003] MINIMUM (PER SURFACE)

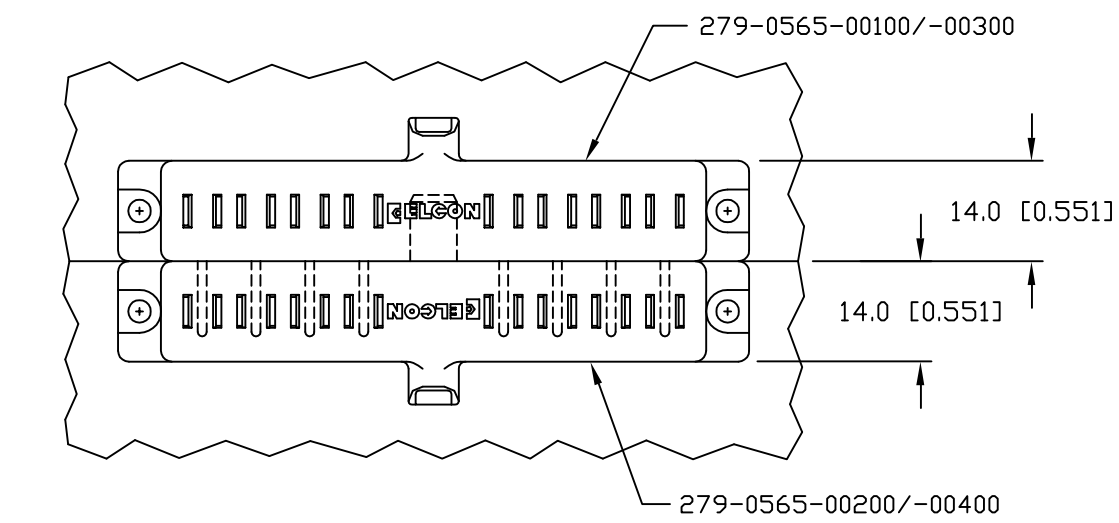
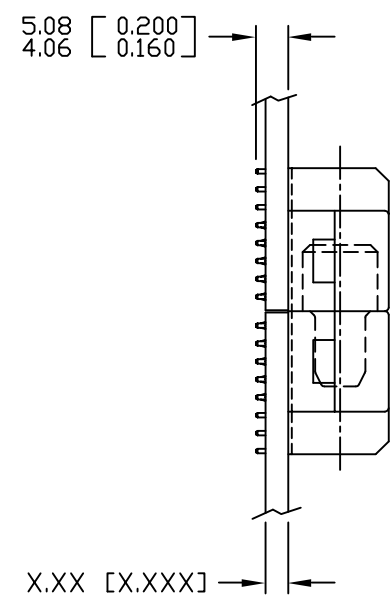

MATED CONDITION

← MM OR MM [INCH] THIRD ANGLE PROJECTION UNLESS OTHERWISE SPECIFIED DIMENSIONS ARE IN METRIC [INCHES] TOLERANCES ANGLES ± .5° DECIMALS .XX ± .25 [.010] .X ± .5 [.020]	DRAWN	DATE	Tyco Electronics Corporation Menlo Park, Ca 94025 	
	R.F.A.	03/05/99		TITLE
	CHECKED		USER INFORMATION SOLDER & COMPLIANT TAIL TERMINATION AND MATED CONDITION	
	APPROVED			
APPROVED	D. CHAU	06/17/04	SIZE	
DCA APPROVED	M. ALIM	07/07/04	DWG NUMBER	
ACAD FILE NUMBER	C1646810B1.DWG		= 1646810	
			REV.	
			B1	
			DWG SCALE 1=1 SH 4 OF 4	