

MALE PCB PINS

WRAPOST TERMINALS

1096

1096-X-05-XX-00-00-01-0

Press-fit in .057 mounting hole

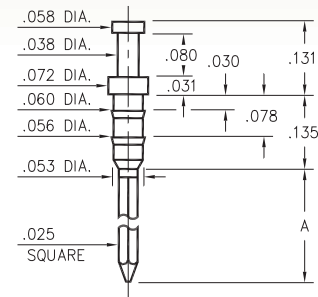

Basic Part Number	# of Wraps	Length A
1096-2	2	.381
1096-3	3	.527

1106

1106-X-23-XX-00-00-01-0

Press-fit in .057 mounting hole

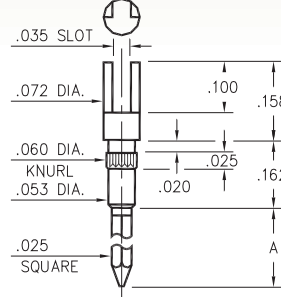

Basic Part Number	# of Wraps	Length A
1106-2	2	.370
1106-3	3	.510

1093

1093-0-05-XX-00-00-01-0

Press-fit in .056 mounting hole

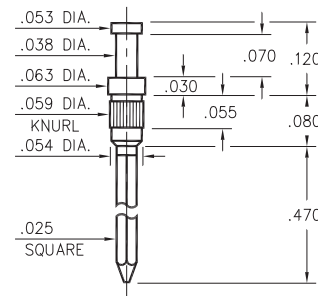

0730

0730-3-05-XX-00-00-01-0

Press-fit in .057 mounting hole

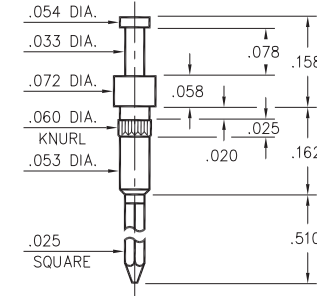

1122

1122-0-22-XX-00-00-01-0

Press-fit in .053 mounting hole

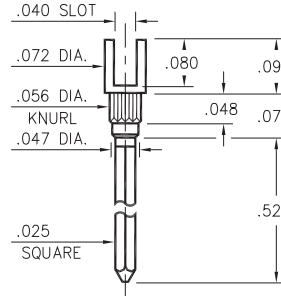

1064

1064-0-23-XX-00-00-01-0

Press-fit in .056 mounting hole

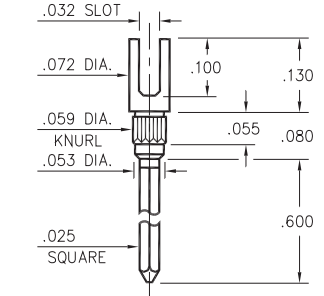

1092

1092-0-05-XX-00-00-01-0

Press-fit in .056 mounting hole

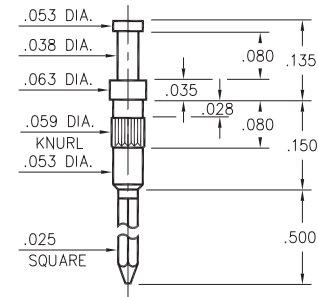

1068

1068-0-23-XX-00-00-01-0

Press-fit in .057 mounting hole

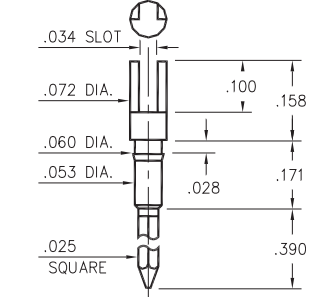

1070 → 1072

107X-X-23-XX-00-00-01-0

Press-fit in .057 mounting hole

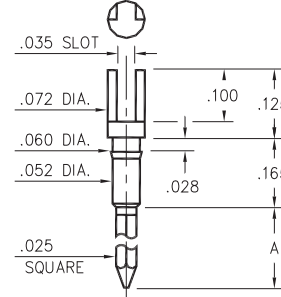

Basic Part Number	# of Wraps	Length A
1072-1	1	.260
1071-2	2	.370
1070-3	3	.510

SPECIFICATIONS:

Pin Material: Brass Alloy 360, 1/2 Hard
(Except where noted)

Dimensions: Inches

Tolerances On: Lengths: ±.005
Diameters: ±.002
Angles: ±2°



ORDER CODE: XXXX - X - XX - XX - 00 - 00 - 01 - 0

BASIC PART #

SPECIFY PIN FINISH:

- 01 200 μ" TIN/LEAD OVER NICKEL
- ◆ 80 200 μ" TIN OVER NICKEL (RoHS)
- ◆ 15 10 μ" GOLD OVER NICKEL (RoHS)
- ◆ 21 20 μ" GOLD OVER NICKEL (RoHS)



Mouser Electronics

Authorized Distributor

Click to View Pricing, Inventory, Delivery & Lifecycle Information:

Mill-Max:

[1092-0-05-80-00-00-01-0](#) [1093-0-05-01-00-00-01-0](#) [1122-0-22-01-00-00-01-0](#) [1106-3-23-01-00-00-01-0](#) [1106-2-23-01-00-00-01-0](#) [1096-3-05-01-00-00-01-0](#) [1096-2-05-01-00-00-01-0](#) [1092-0-05-01-00-00-01-0](#) [1072-1-23-01-00-00-01-0](#) [1071-2-23-01-00-00-01-0](#) [1070-3-23-01-00-00-01-0](#) [1068-0-23-01-00-00-01-0](#) [1064-0-23-01-00-00-01-0](#) [0730-3-05-01-00-00-01-0](#) [0730-3-05-15-00-00-01-0](#) [0730-3-05-21-00-00-01-0](#) [1064-0-23-15-00-00-01-0](#) [1064-0-23-21-00-00-01-0](#) [1068-0-23-15-00-00-01-0](#) [1068-0-23-21-00-00-01-0](#) [1070-3-23-15-00-00-01-0](#) [1070-3-23-21-00-00-01-0](#) [1071-2-23-15-00-00-01-0](#) [1071-2-23-21-00-00-01-0](#) [1072-1-23-15-00-00-01-0](#) [1072-1-23-21-00-00-01-0](#) [1092-0-05-15-00-00-01-0](#) [1092-0-05-21-00-00-01-0](#) [1093-0-05-15-00-00-01-0](#) [1093-0-05-21-00-00-01-0](#) [1096-2-05-15-00-00-01-0](#) [1096-2-05-21-00-00-01-0](#) [1096-3-05-15-00-00-01-0](#) [1096-3-05-21-00-00-01-0](#) [1106-2-23-15-00-00-01-0](#) [1106-2-23-21-00-00-01-0](#) [1106-3-23-15-00-00-01-0](#) [1106-3-23-21-00-00-01-0](#) [0730-3-05-00-00-00-01-0](#) [1071-2-23-00-00-00-01-0](#) [1096-2-05-00-00-00-01-0](#) [1092-0-05-00-00-00-01-0](#) [1064-0-23-00-00-00-01-0](#) [1122-0-22-00-00-00-01-0](#) [1072-1-23-00-00-00-01-0](#) [1070-3-23-00-00-00-01-0](#) [1106-3-23-00-00-00-01-0](#) [1106-2-23-00-00-00-01-0](#) [1096-3-05-00-00-00-01-0](#) [1068-0-23-00-00-00-01-0](#) [1093-0-05-00-00-00-01-0](#)