

Minature Toggle Switches

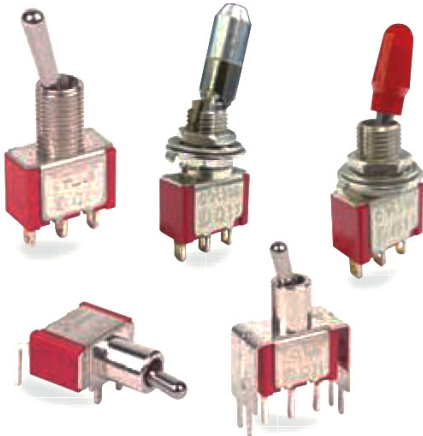

RoHS
Compliant



Specifications:

| | |
|-----------------------|---|
| Mechanical Life | : 40,000 make-and-break cycles |
| Contact Resistance | : 10m Ω max. initial @ 2-4V DC 100mA for both silver and gold plated contacts |
| Insulation Resistance | : 1,000M Ω min. |
| Dielectric Strength | : 1,000V rms min. @ sea level |
| Operating Temperature | : -30°C to +85°C |

Materials:

| | |
|---------------------|--------------------------------|
| Case | : Diallyl phthalate (DAP) |
| Actuator | : Brass,chrome plated |
| Bushing | : Brass, nickel plated |
| Housing | : Stainless steel |
| Switch Support | : Brass, tin plated |
| Contact / Terminals | : Brass, Silver or gold plated |

Minature Toggle Switches



How to Order:

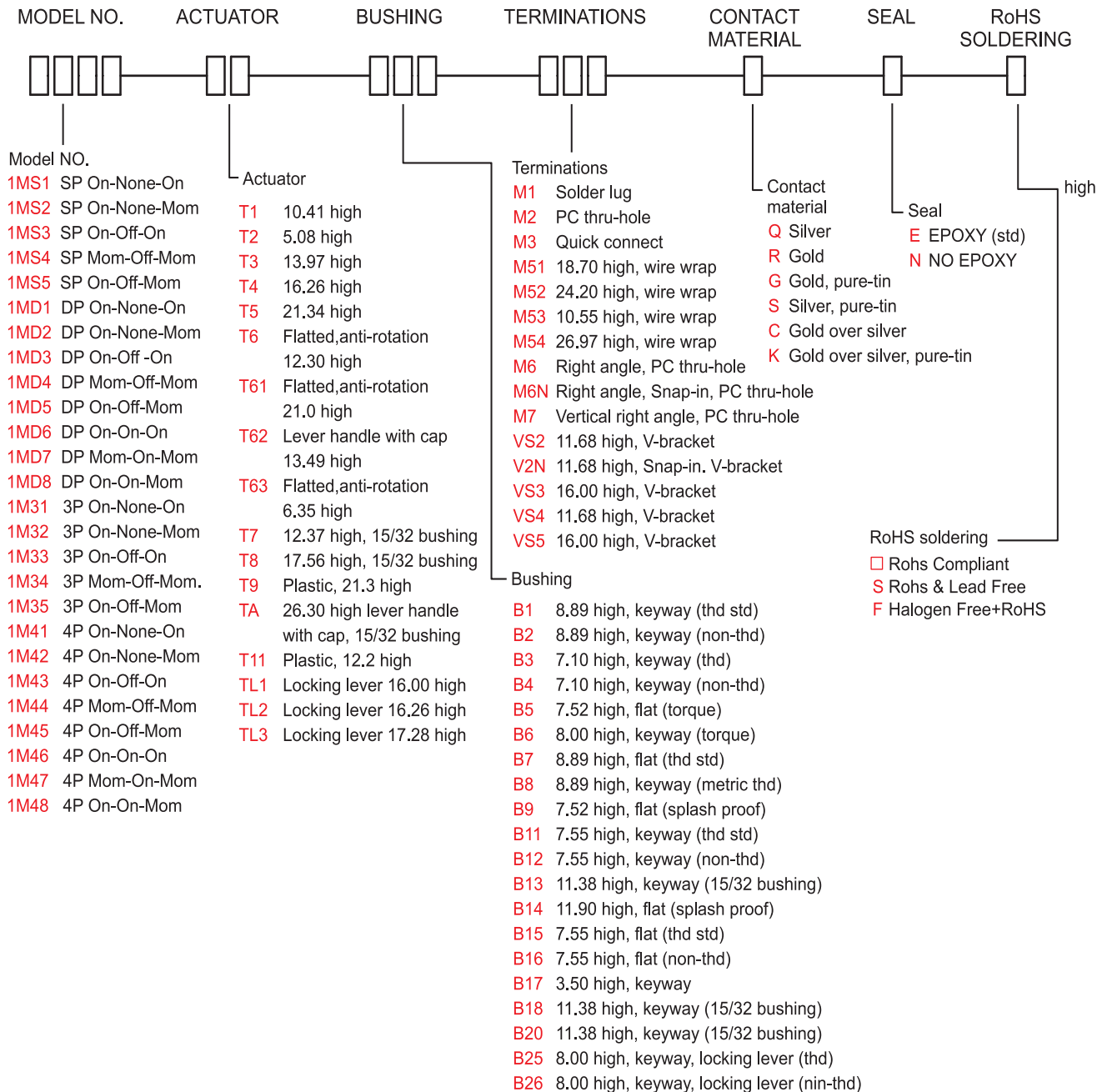

Minature Toggle Switches



Switch Function:

| No. Poles | UL/CSA Model No. | Model No. | Switch Function | | | Connected Terminals / Schematic | | |
|-----------|------------------|-----------|-----------------|-------|-------|---------------------------------|-------|----------------------|
| | | | Pos.1 | Pos.2 | Pos.3 | Pos.1 | Pos.2 | Pos.3 |
| | | | | | | | | |
| SP | Q1111 | 1MS1 | ON | NONE | ON | 2-3 | N/A | 2-1 |
| | Q1112 | 1MS2 | ON | NONE | MOM | | OPEN | |
| | Q1113 | 1MS3 | ON | OFF | ON | | | |
| | Q1114 | 1MS4 | MOM | OFF | MOM | | | |
| | Q1115 | 1MS5 | ON | OFF | MOM | | | |
| DP | Q1121 | 1MD1 | ON | NONE | ON | 2-3, 5-6 | N/A | 2-1, 5-4 |
| | Q1122 | 1MD2 | ON | NONE | MOM | | OPEN | |
| | Q1123 | 1MD3 | ON | OFF | ON | | | |
| | Q1124 | 1MD4 | MOM | OFF | MOM | | | |
| | Q1125 | 1MD5 | ON | OFF | MOM | | | |
| | Q1126 | 1MD6 | ON | ON | ON | | | |
| | * Q1127 | 1MD7 | MOM | ON | MOM | | | |
| | * Q1128 | 1MD8 | ON | ON | MOM | | | |
| 3P | Q1131 | 1M31 | ON | NONE | ON | 2-3, 5-6, 8-9 | N/A | 2-1, 5-4, 8-7 |
| | Q1132 | 1M32 | ON | NONE | MOM | | OPEN | |
| | Q1133 | 1M33 | ON | OFF | ON | | | |
| | Q1134 | 1M34 | MOM | OFF | MOM | | | |
| | Q1135 | 1M35 | ON | OFF | MOM | | | |
| 4P | Q1141 | 1M41 | ON | NONE | ON | 2-3, 5-6, 8-9, 11-12 | N/A | 2-1, 5-4, 8-7, 11-10 |
| | Q1142 | 1M42 | ON | NONE | MOM | | OPEN | |
| | Q1143 | 1M43 | ON | OFF | ON | | | |
| | Q1144 | 1M44 | MOM | OFF | MOM | | | |
| | Q1145 | 1M45 | ON | OFF | MOM | | | |
| | Q1146 | 1M46 | ON | ON | ON | | | |
| | * Q1147 | 1M47 | MOM | ON | MOM | | | |
| | * Q1148 | 1M48 | ON | ON | MOM | | | |

MOM = Momentary

* Please check the availability in advance before order



Minature Toggle Switches



Pole Options:

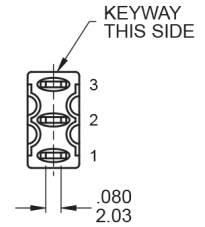
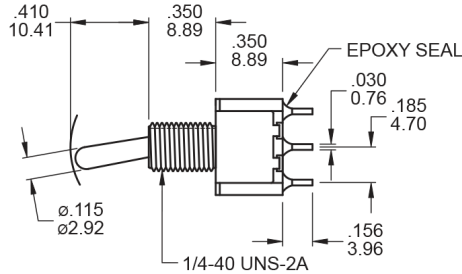
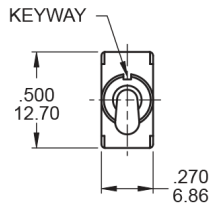

SPDT

Part No. Shown : 1MS1T1B1M1QE

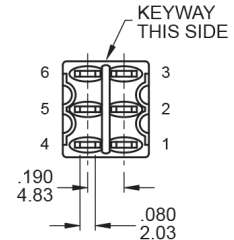
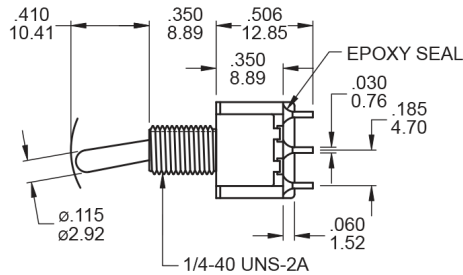
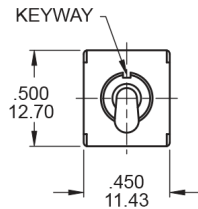

DPDT

Part No. Shown : 1MD1T1B1M1QE

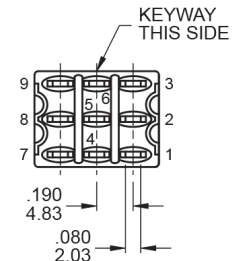
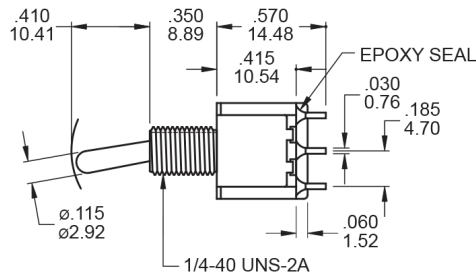
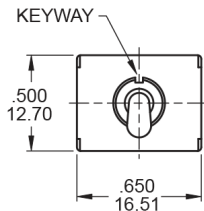

3PDT

Part No. Shown : 1M31T1B1M1QE

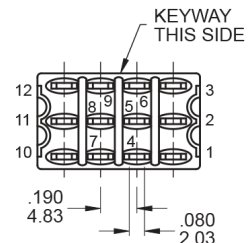
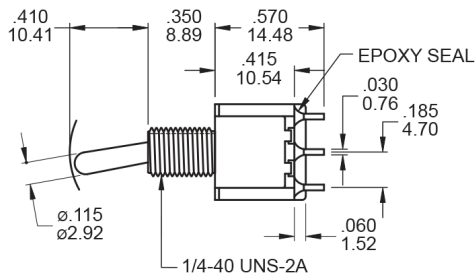
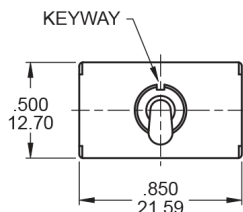

4PDT

Part No. Shown : 1M41T1B1M1QE

www.element14.com
www.farnell.com
www.newark.com



Minature Toggle Switches



3-Way Switch:

SINGLE POLE, 3 POSITION

| Model No. | POS 1 | POS 2 | POS 3 |
|-------------|---------|---------|---------|
| 1MD6 | ON | ON | ON |
| Term. Comm. | 2-3,5-6 | 2-3,5-4 | 2-1,5-4 |

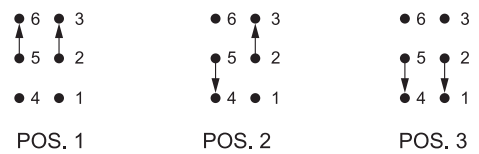
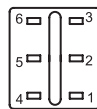
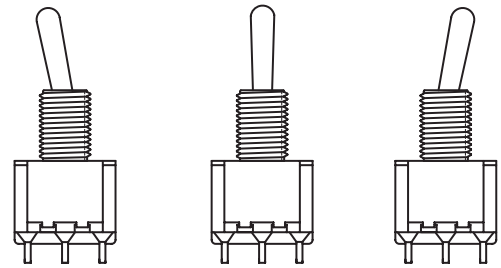
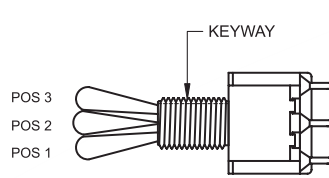

DOUBLE POLE, 3 POSITION

| Model No. | POS 1 | POS 2 | POS 3 |
|-------------|----------------------|----------------------|----------------------|
| 1M46 | ON | ON | ON |
| Term. Comm. | 2-3,5-6 8-9,11-12 | 2-3,5-4 8-9,11-10 | 2-1,5-4 8-7,11-10 |

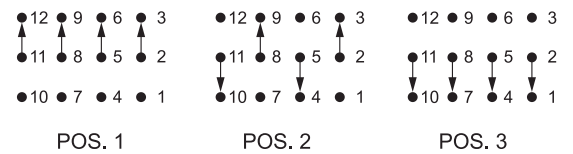
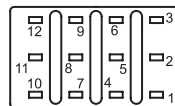

Actuator Options:

T1 STD

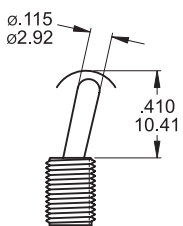

T2

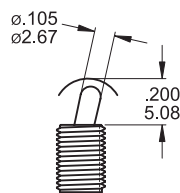

T3

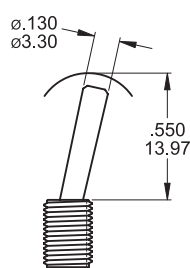

T4

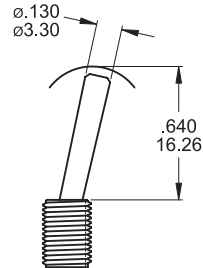

T5

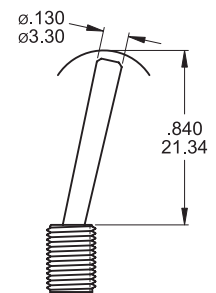

Note: T1 ~ T5 Actuator shown with standard B1 Bushing:

Add .070 (1.78) for B3 Bushing;

Subtract .02 (0.51) for B6 Bushing;

Std for M1 , M2 Terminal sub .016 (0.4) for M6 , M7 , VSX



Minature Toggle Switches

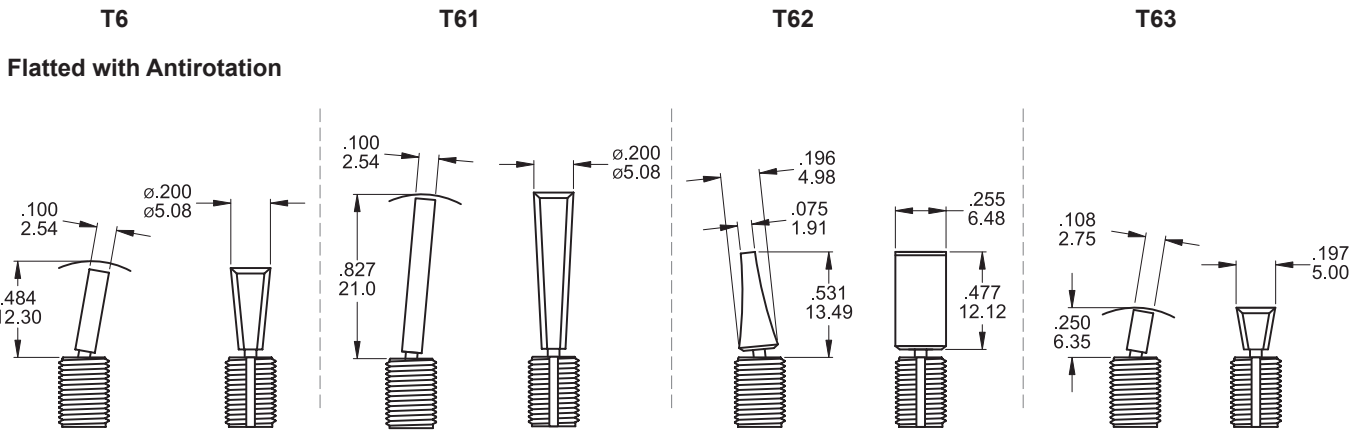

Note T6, T6-1, T6-2, T63 use with B11, B12, B15, B16 bushing only.

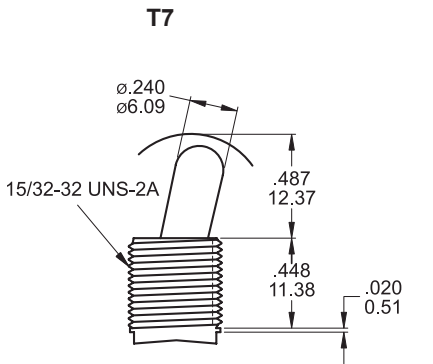

Use with B13 bushing
Use with B18, B20 the lever is antirotation and the size of lever is 13.00mm

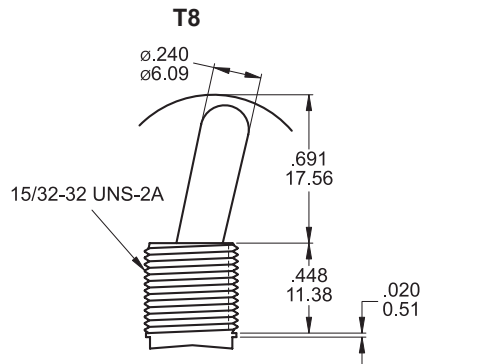

Use with B13 bushing
Use with B18, B20 the lever is antirotation and the size of lever is 18.00mm

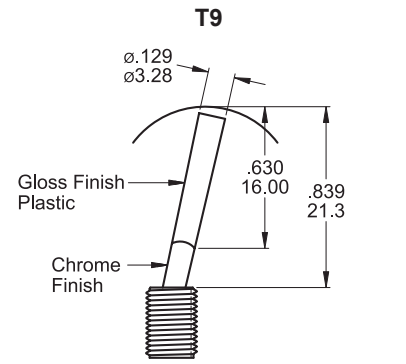

B1 / B2 bushing std
with black and red color only (std.)

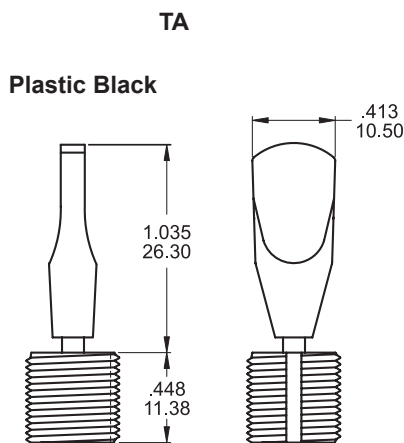

Use with B18 bushing only

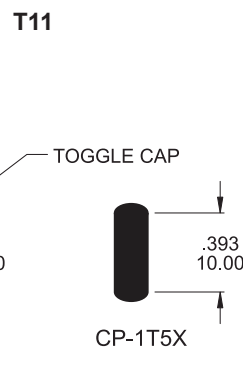

Note T11 Actuator shown with standard B1 Bushing ;
Add .07 (1.78) for B3 Bushing ;
Subtract .02 (0.51) for B6 Bushing.
Std for M1, M2 Terminal sub .016 (0.40) for M6, M7, VSX

Plastic No. Colour :

| ITEM NO | COLOR |
|---------|-------------|
| 1 | White |
| 2 | Black (Std) |
| 3 | Red |
| 4 | Orange |
| 5 | Yellow |
| 6 | Green |
| 7 | Blue |
| 8 | Brown |
| 9 | Gray |

T62, TA, T9, T11
Actuator Only



Minature Toggle Switches



TL1B25

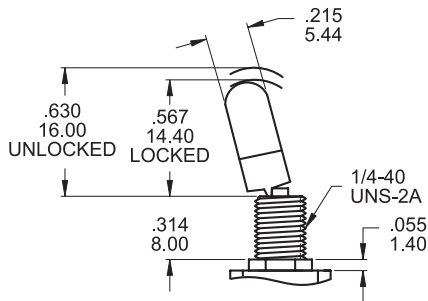

TL2B25

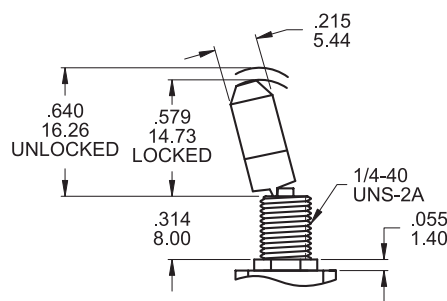

TL3B25

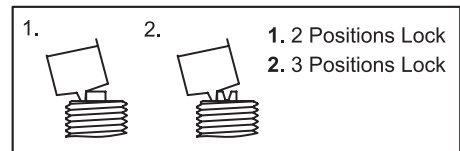
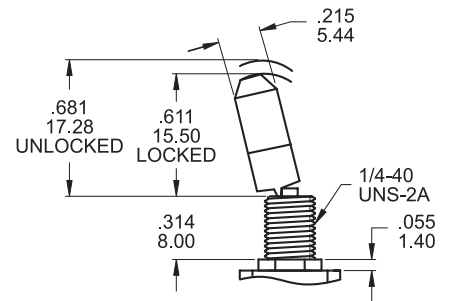

Bushing Options:

**B1 THD STD
B2 NON-THD**

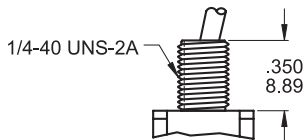
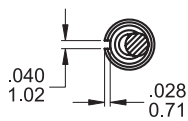

**B3 THD
B4 NON-THD**

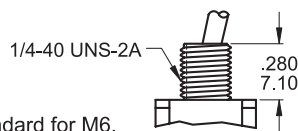
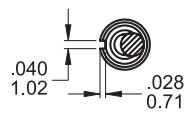

B4 is standard for M6, M7 and VS2~5 termination options.

B5 HIGH TORQUE

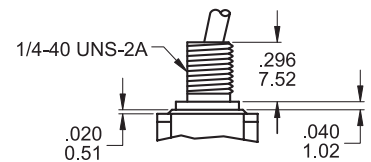
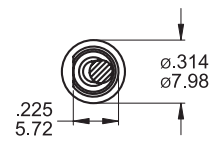

B6 HIGH TORQUE

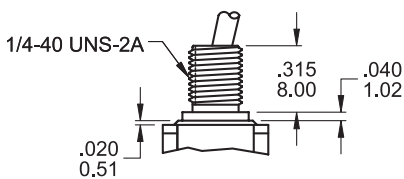
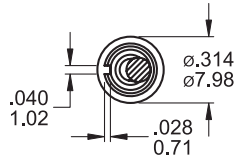

B7 THD STD

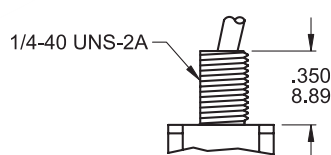
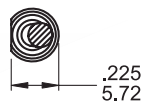

B8 METRIC THD

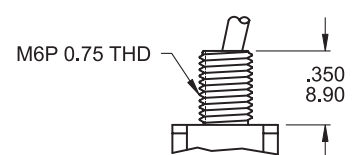
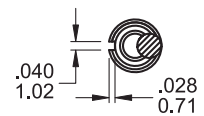

Minature Toggle Switches



B9 SPLASH PROOF

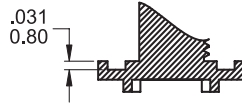
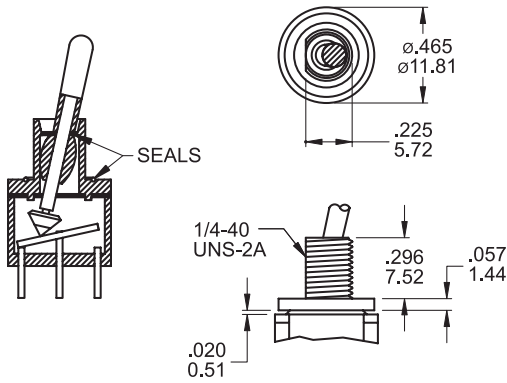

CP-1TEB

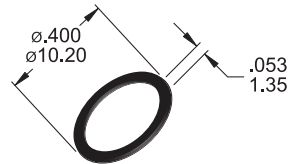

O-Ring
supplied with B9 bushing

B11 THD STD B12 NON-THD

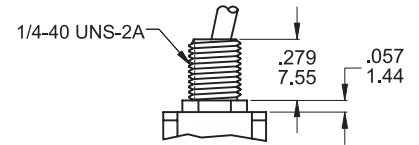
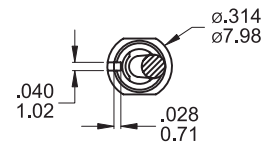

Use with T6 actuators only

B15 THD STD B16 NON-THD

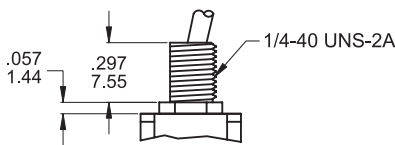
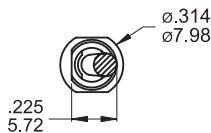

Use with T6 actuators only

B17

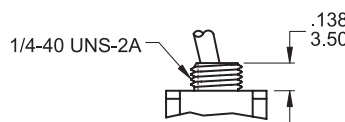
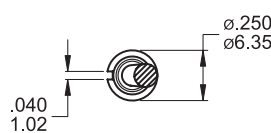

B13

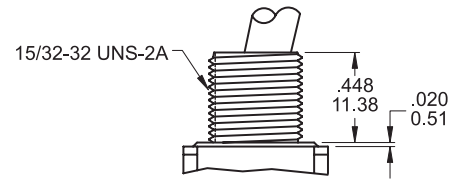
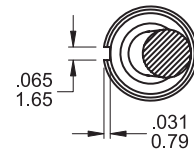

Use with T7, T8 actuators only
B13 Bear strength from top of actuator
up to 10kg aside up to 15kg

B14 SPLASH PROOF

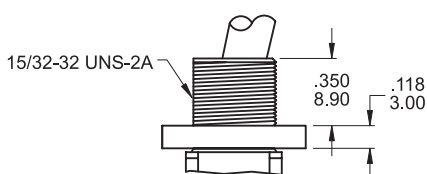
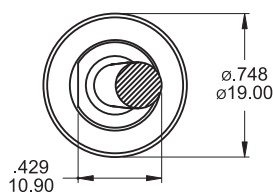

Use with T7, T8 actuators only

B18

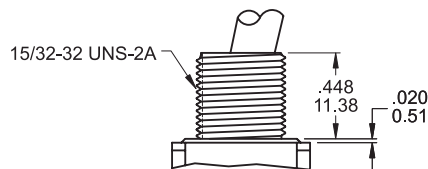
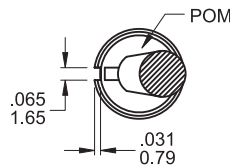

Use with T7, T8 and TA actuators only
with Plastic (POM) Insert

B20

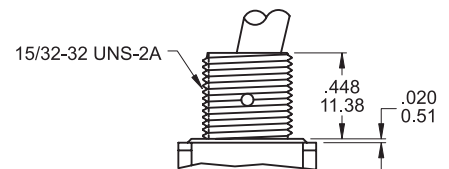
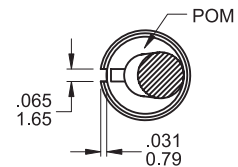

Use with T7, T8 and TA actuators only
with Plastic (POM) Insert

B18, B20 Bear strength from top of actuator up to 20kg aside up to 15kg



Minature Toggle Switches



Panel Mounting:

1/4" Bushing

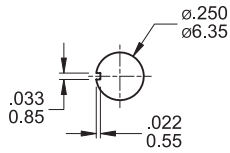

Without locking ring (Keyway)

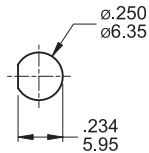

Without locking ring (Flat)

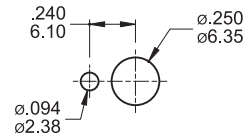

With standard locking ring.

Metric Bushing

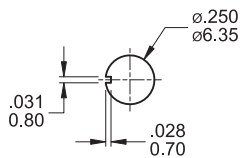

Without locking ring (Keyway)

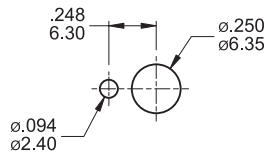

With standard locking ring.

15/32 Bushing

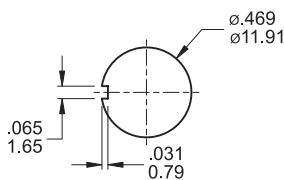

Without locking ring (Keyway)

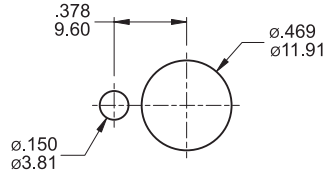

With standard locking ring.

Splash Proof Bushing

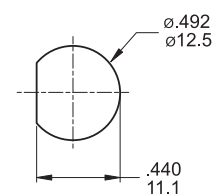

Without locking ring (Flat)

Termination Options:

M1 Solder lug

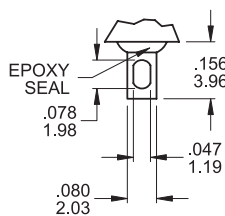

.030(0.76) THK.

M2 PC Thru-hole

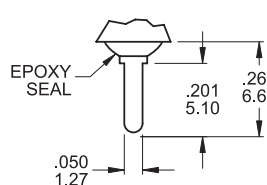

.030(0.76) THK.

M3 Quick connect

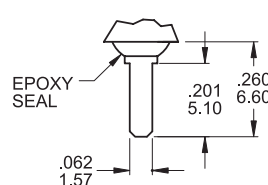

.030(0.76) THK.

M5 Wire Wrap

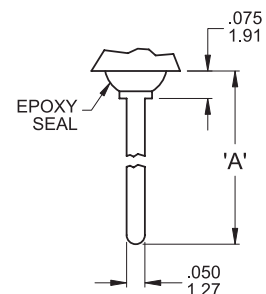

.030(0.76) THK.



Minature Toggle Switches



| Option Code | Dim. A |
|-------------|---------------|
| M5-1 | 0.736 (18.7) |
| M5-2 | 0.953 (24.20) |
| M5-3 | 0.415 (10.55) |
| M5-4 | 1.062 (26.97) |

Other Termination Options:

- M6** Right Angle P.C. Mount
- M7** Right Angle P.C. Mount
- VS2** Vertical Bracket P.C. Mount
- VS3** Vertical Bracket P.C. Mount
- VS5** Vertical Bracket P.C. Mount

M6

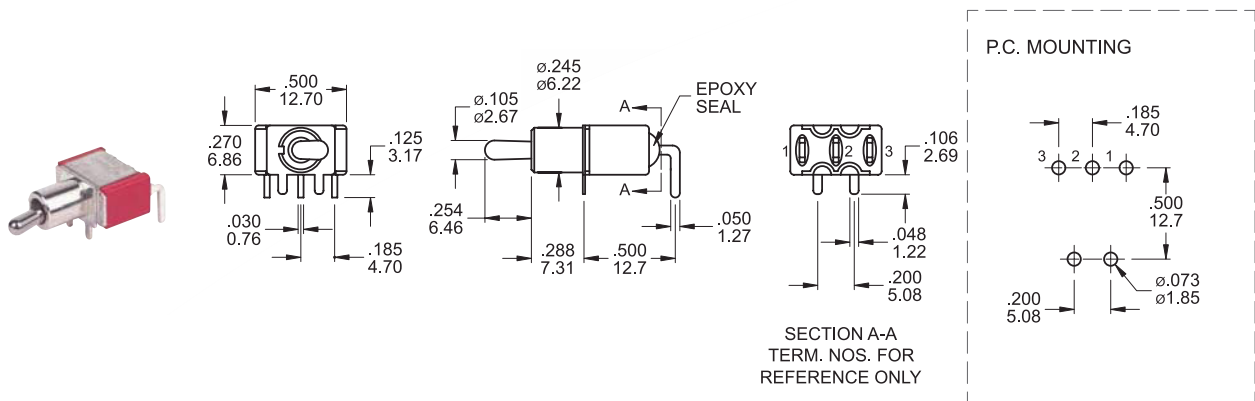

SPDT

Part No. Shown : 1MS1T2B4M6QE

M6

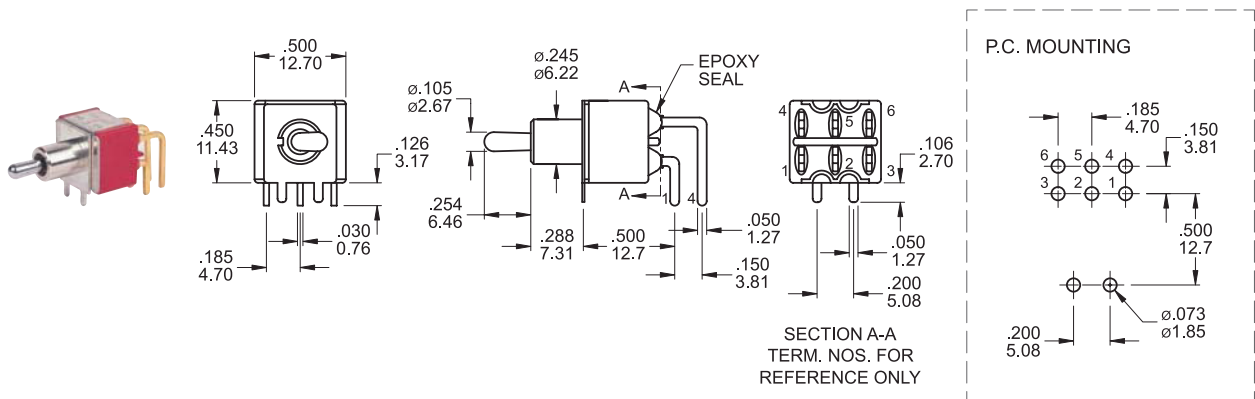

DPDT

Part No. Shown : 1MD1T2B4M6RE

www.element14.com
www.farnell.com
www.newark.com



Minature Toggle Switches



M7

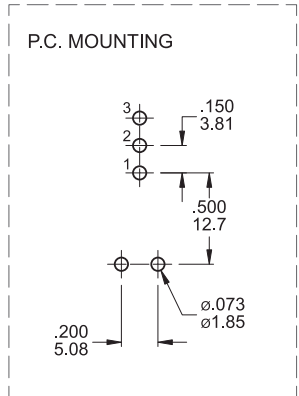
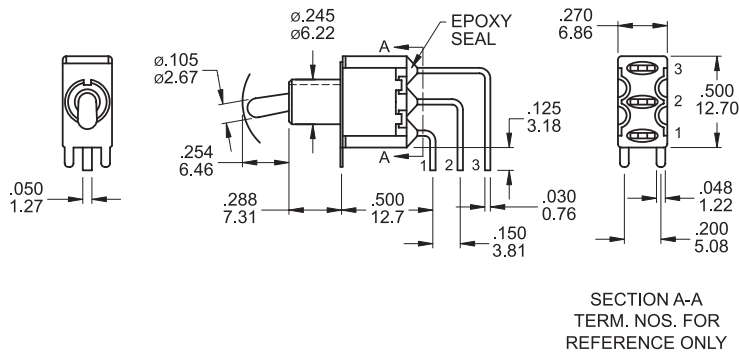
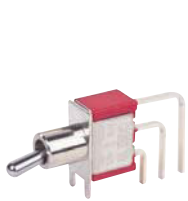

SPDT

Part No. Shown : 1MS1T2B4M7QE

M7

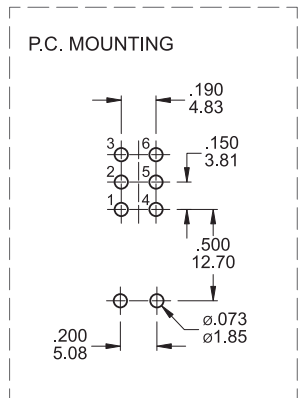
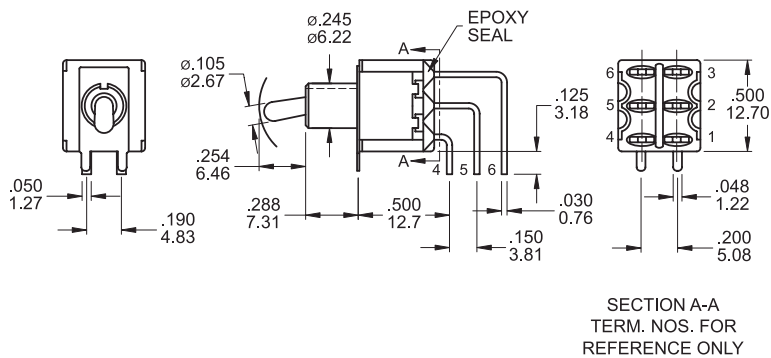

DPDT

Part No. Shown : 1MD1T2B4M7QE

M7

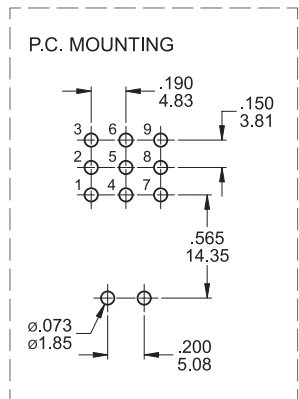
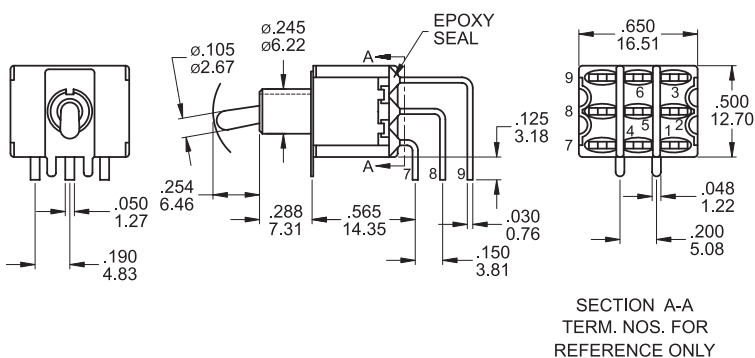

3PDT

Part No. Shown : 1M31T2B4M7QE



Minature Toggle Switches



M7

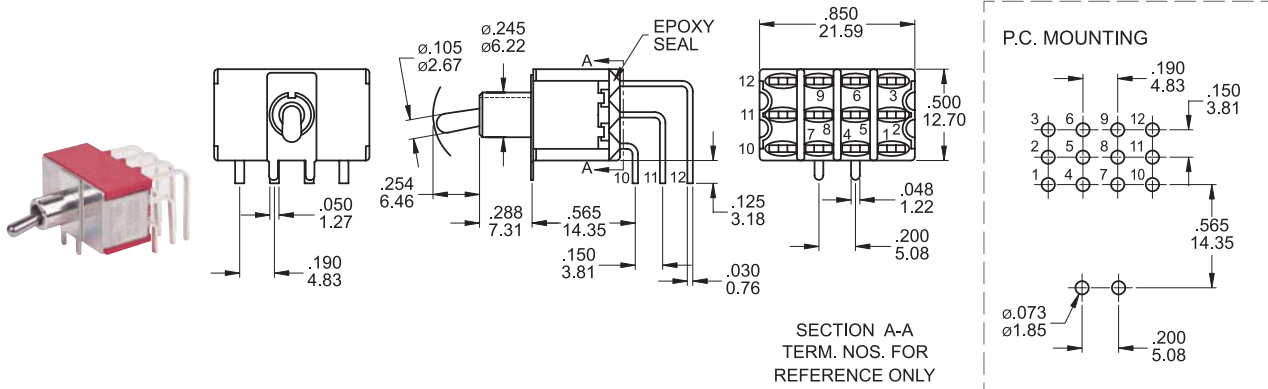

4PDT

Part No. Shown : 1M41T2B4M7QE

VS2 - VS3

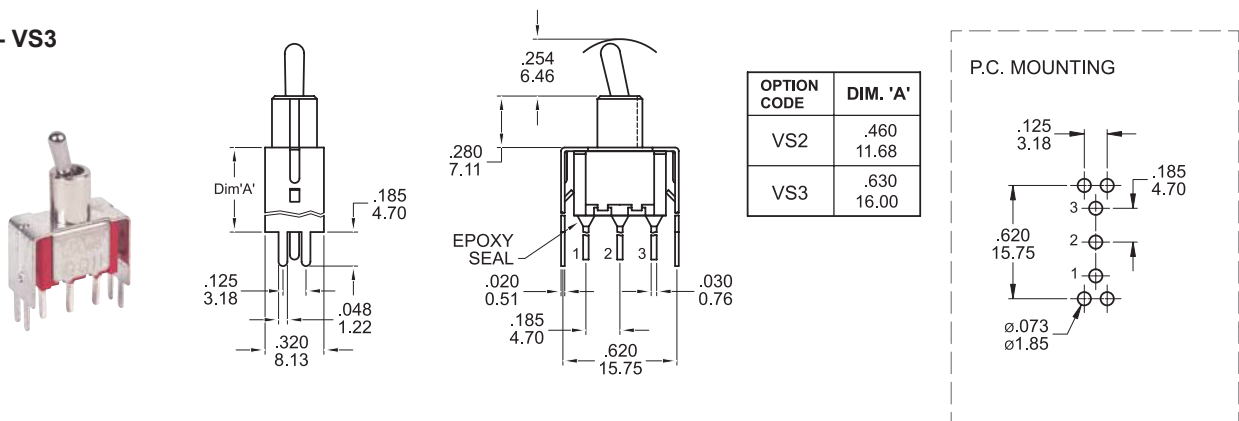

SPDT

Part No. Shown : 1MS1T2B4VS2QE

VS2 - VS3

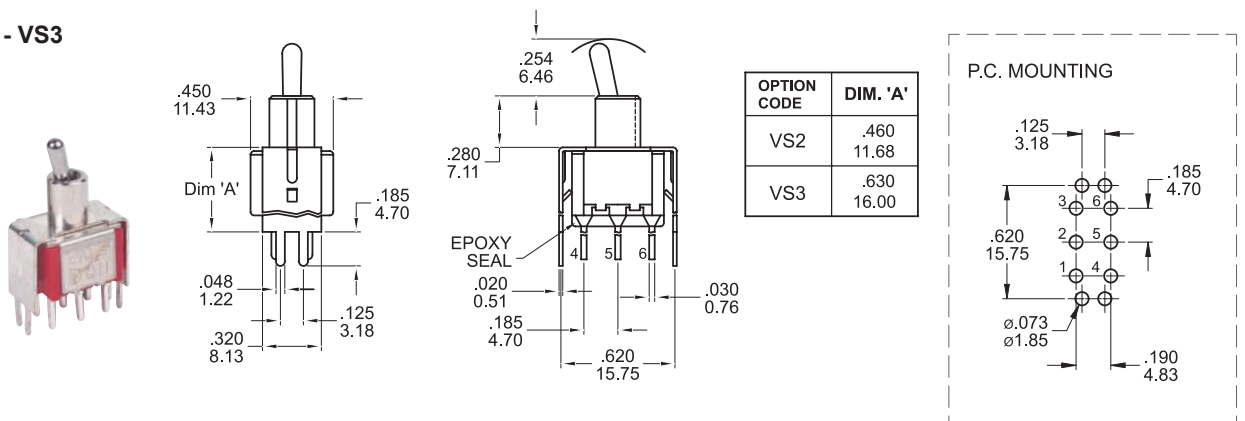

DPDT

Part No. Shown : 1MD1T2B4VS3QE



Miniature Toggle Switches



VS5

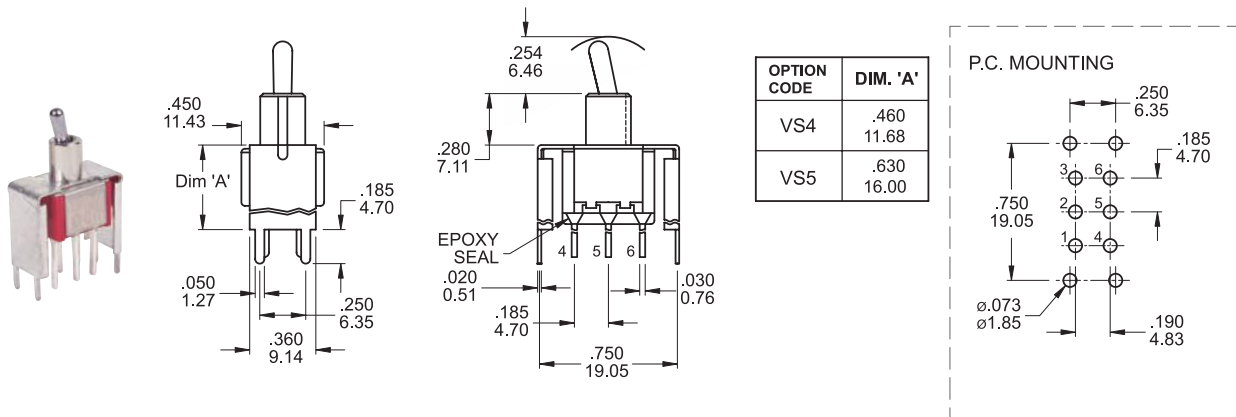

DPDT

Part No. Shown : 1MD1T2B4VS5QE

Snap-In Termination Options:

M6N

V2N



Hardware:

1/4 Nuts HDW2

Dress Nut HDW3

Metric Nut HDW6

Lock Washer HDW11

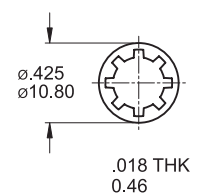
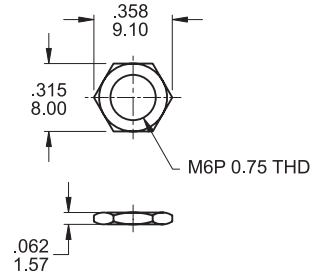
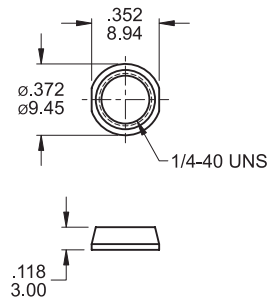
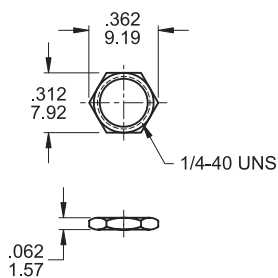

Supplied standard with B1, B3, B5, B6 and B9 options

Supplied standard with B8 metric bushing

Supplied standard with B1 / B3 bushing



Minature Toggle Switches



Optional Rubber Hood Sealing

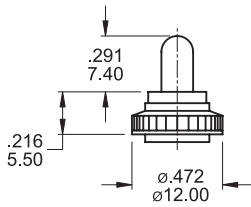

K1=Metric
E1=Inch (Std.)
for actuator T1, T2 and
B1, B3, B5, B6 Bushing only

15/32 Nuts HDW4

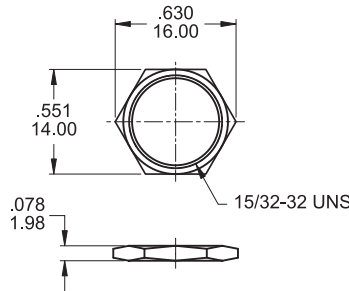

Supplied standard with B13 bushing

Lock Washer HDW12

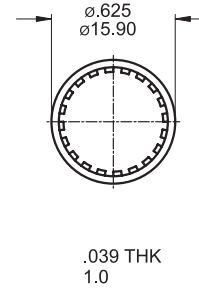

Supplied standard with B13 bushing

HDW15

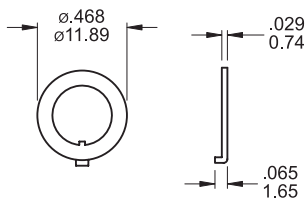

Locking ring supplied standard

HDW16

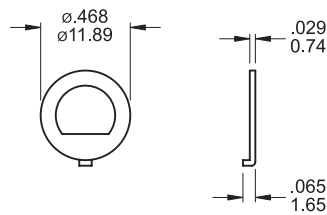

Locking ring
supplied with B5 bushing

HDW17

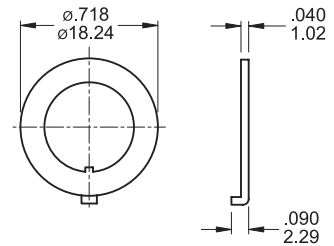

Locking ring
supplied with B13,B18,B20 bushing

HDW18

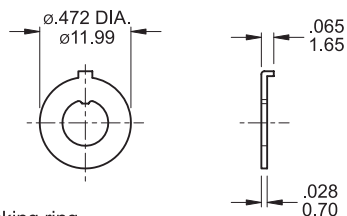

Locking ring
supplied with B8 bushing

HDW19

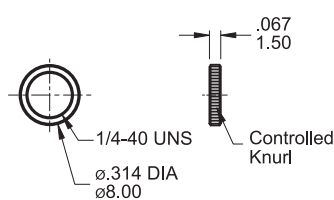

NU-1M18

HDW20

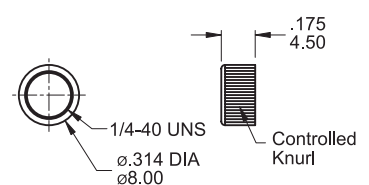

NU-1M24



Minature Toggle Switches



Optional Toggle Cap:

CP-T1XX

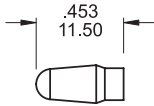

Use with T1

CAP Colour :

| Item No | Colour |
|---------|-------------|
| 1 | White |
| 2 | Black (Std) |
| 3 | Red |
| 5 | Yellow |
| 6 | Green |
| 7 | Blue |
| 9 | Gray |

Contact Material Options:

| | Contact Plating | Terminal Plating | Ratings |
|---|------------------|---------------------------------|---|
| Q | Silver | Q = Silver | 5 Amps with resistant load @ 120VAC or 28VDC 2 Amps with resistant load @ 250VAC |
| S | | S = Silver,pure - tin | |
| C | Gold over Silver | C = Gold over silver | |
| K | | K = Gold over silver,pure - tin | |
| R | Gold | R = Gold | 0.4 Volt - Amps (VA) max. @ 20V max. (AC or DC) |
| G | | G = Gold,pure - tin | |

Soldering Processes:

Manual Soldering: Use soldering iron of 30 watts, controlled at 350°C approximately 5 seconds while applying solder.

Wave Soldering: Recommended Soldering Temperature: 260 ± 5°C Duration of Solder Immersion: Max 5 sec.
(PCB is 1.6mm in thickness)

Important Notice : This data sheet and its contents (the "Information") belong to the members of the Premier Farnell group of companies (the "Group") or are licensed to it. No licence is granted for the use of it other than for information purposes in connection with the products to which it relates. No licence of any intellectual property rights is granted. The Information is subject to change without notice and replaces all data sheets previously supplied. The Information supplied is believed to be accurate but the Group assumes no responsibility for its accuracy or completeness, any error in or omission from it or for any use made of it. Users of this data sheet should check for themselves the Information and the suitability of the products for their purpose and not make any assumptions based on information included or omitted. Liability for loss or damage resulting from any reliance on the Information or use of it (including liability resulting from negligence or where the Group was aware of the possibility of such loss or damage arising) is excluded. This will not operate to limit or restrict the Group's liability for death or personal injury resulting from its negligence. Multicomp is the registered trademark of the Group. © Premier Farnell plc 2012.

www.element14.com
www.farnell.com
www.newark.com

