

DO NOT SCALE  
DIMENSIONS IN mm

METRIC

THIRD ANGLE  
PROJECTION

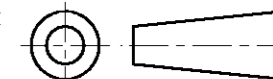

NOTES:

△ PH.BRONZE ACC ASTM B103.

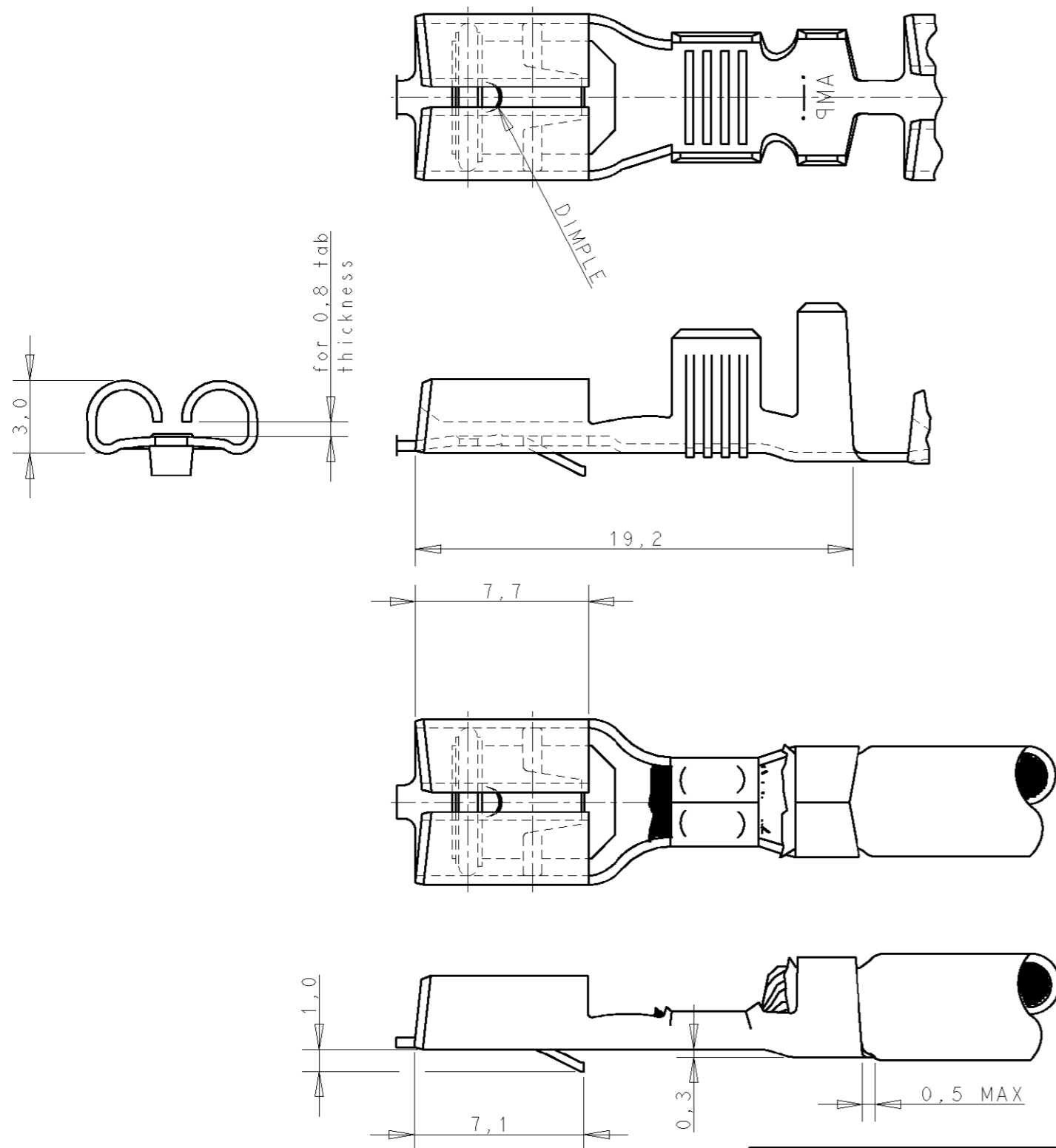

WIRE RANGE :  
4,0-6,0 mm<sup>2</sup>  
INSULATION RANGE :  
3,4-5,1mm DIA.

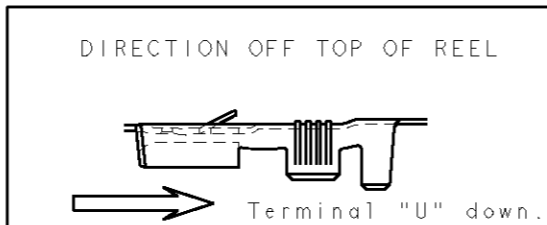

GENERAL TOLERANCES ±0.3

NOTES	FINISH	MATERIAL	PARTNUMBER
△	PRE-TINPLATED	PH.BRONZE	6-160811-8
△	PRE-TINPLATED	BRASS	6-160811-7
△	UNPLATED	PH.BRONZE	160811-8
△	UNPLATED	BRASS	160811-7
△	SILVERPLATED	PH.BRONZE	160811-6
△	SILVERPLATED	BRASS	160811-5
△	TINPLATED	PH.BRONZE	160811-4
△	UNPLATED	PH.BRONZE	160811-3
△	TINPLATED	BRASS	160811-2
△	UNPLATED	BRASS	160811-1

LTR.	REVISION RECORD	DR.	CHK.	DATE	NAME	DWG. No.	REV. LTR.	SHEET
-	-	-	-	-	CUSTOMER DRAWING FOR REFERENCE ONLY WILL NOT BE UPDATED			
-	-	-	-	-	© COPYRIGHT 19- BY AMP HOLLAND B.V. ALL INTERNATIONAL RIGHTS RESERVED. AMP PRODUCTS MAY BE COVERED BY U.S. AND FOREIGN AND/OR PATENTS PENDING.			
-	-	-	-	-	THIS DRAWING IS UNPUBLISHED RELEASED FOR PUBLICATION			
G	ES00-0008-03	JL	JL	17JAN03	<b>AMP</b> Tyco Electronics AMP Barcelona, Spain	6,3 SRS FASTIN-ON RECEPTACLE	G	1 OF 1
F	ES00-0065-01	JC	JL	19JUN01				
E	ES00-0043-01	JC	RS	27APR01				
D	EH-0168-94	DK	PB	21-06-94				
DR. : D.KESSLER					APP. : L.v.SOEST		DWG. No.	
DATE: 21-06-94					DATE: -		160811	
CHK. : P.BEIJNON					DATE: -		REV. LTR.	
					DATE: -		G	
							SHEET	
							1 OF 1	
							A3	