

MAG-MATE Connector With Multispring Pin

Say goodbye to magnet wire soldering and PCB soldering

TE Connectivity introduces the MAG-MATE connector with Multispring pin, a combination of two key technologies that eliminate the customer's need to solder in a motor connection. The MAG-MATE connector with Multispring pin provides the ability to directly connect magnet wire to a PCB with no solder. Traditionally, the process is to solder magnet wire to a pin, assemble the PCB to the pin, and then solder the PCB to the pin. Not anymore! This unique product allows solderless magnet wire termination in the IDC (Insulation Displacement Connection) at the bottom and solderless PCB termination through press-fit Multispring pin on the top.

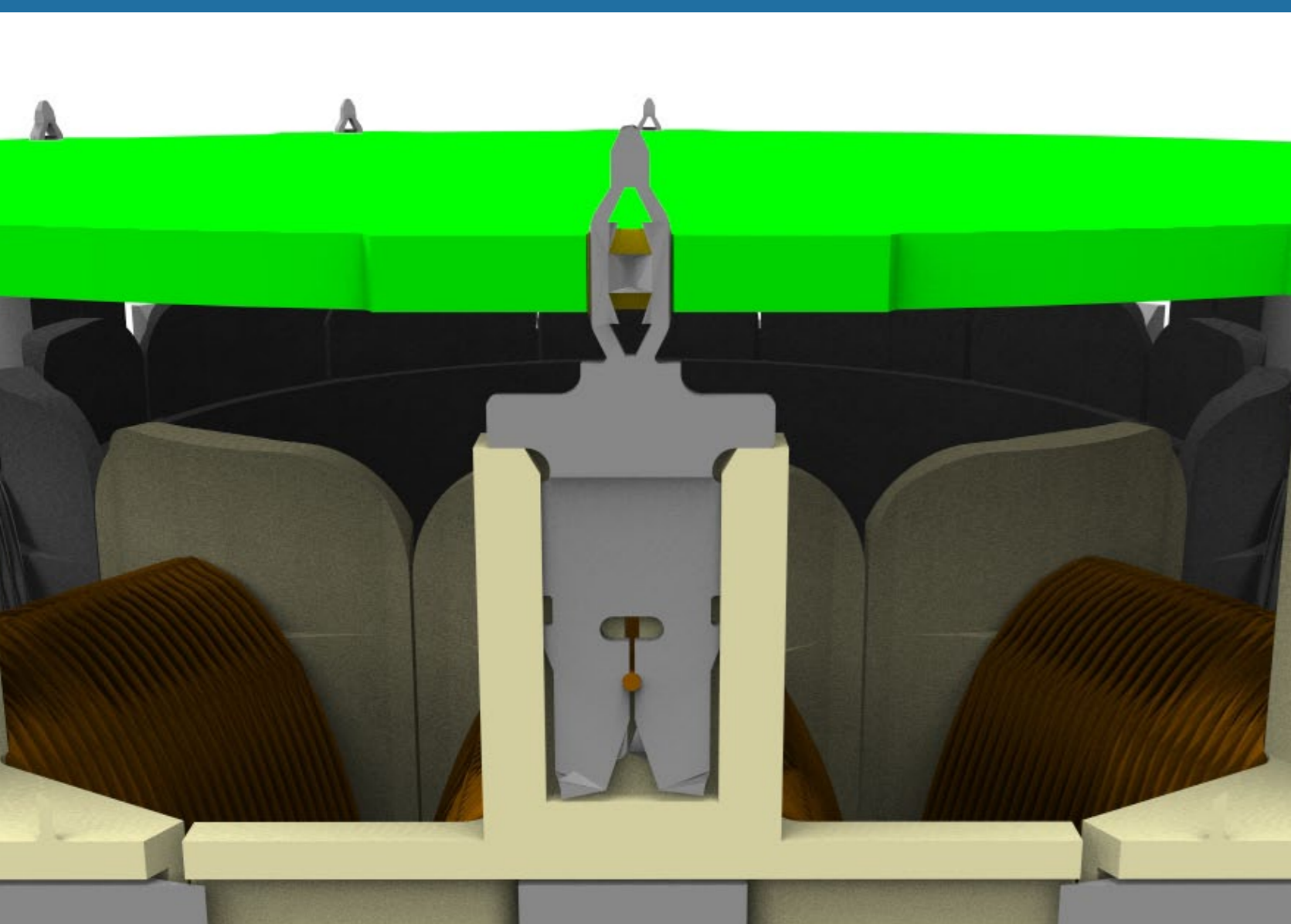

KEY FEATURES

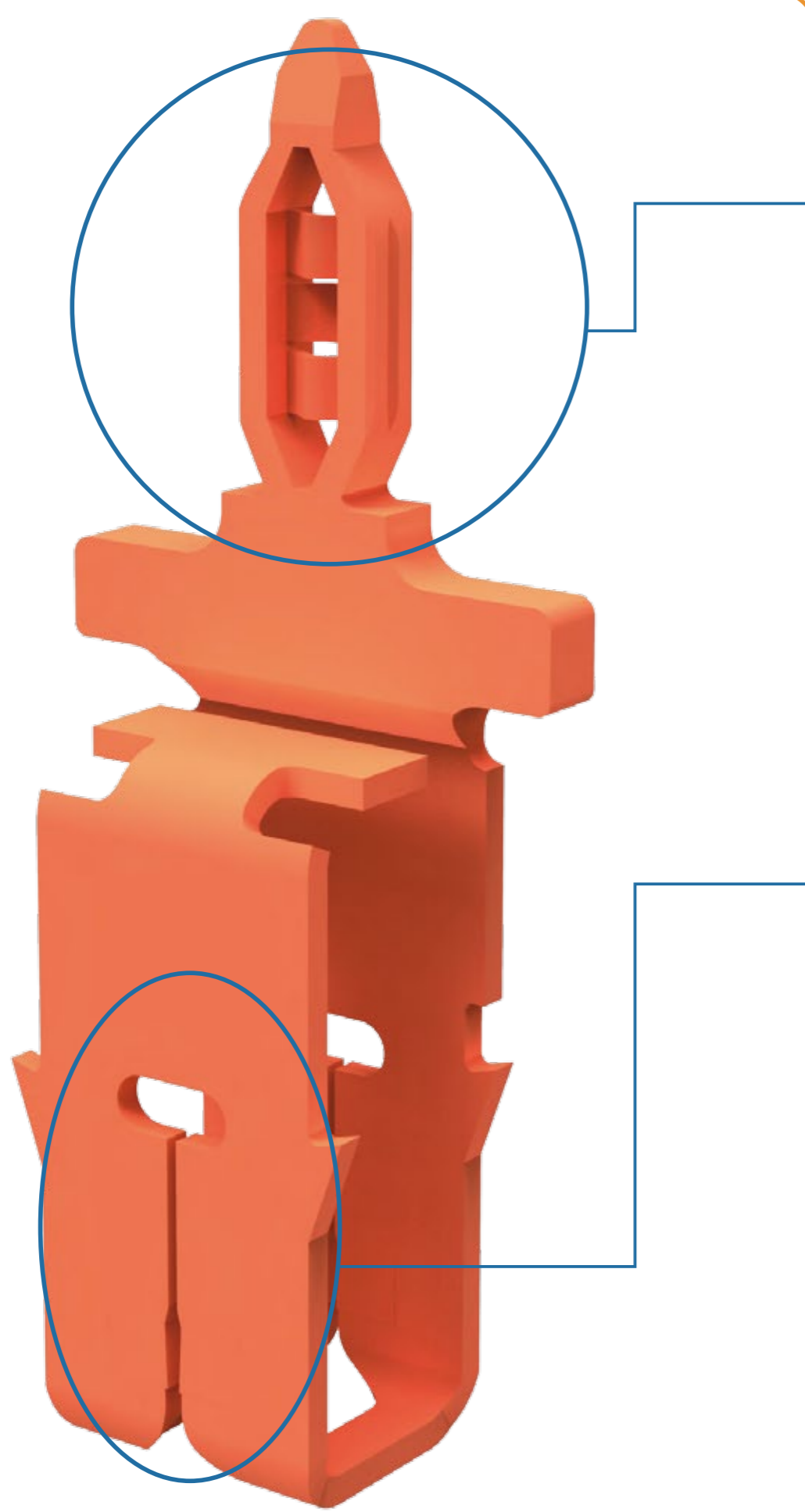

Features of the Multispring Pin

- Large gas-tight contact zone
- High reliability due to stored energy
- Minimum damage to plated-through holes during application
- Especially suited for multi-layer PCBs
- More economic board manufacturing due to larger hole tolerances compared to the use of a solid pin
- Application can be made by the end-user
- High-end TE Connectivity application tooling available
- Extraction force: Pin/PCB min 40N

Features of the MAG-MATE Connector

- Terminates all magnet wire film insulations
- Eliminates need for pre-stripping conductors
- Eliminates need to solder/weld
- Excess magnet wire is automatically trimmed during the termination process
- Simultaneously terminates two magnet wires of the same size in one terminal (for splicing or bi-filing)
- Available in strip form for semi-automatic or fully automatic insertions
- High speed, fully-automated integrated systems provide uniform terminations reliability at the lowest possible applied cost
- Clean metal-to-metal interface produces stable, gas-tight electrical terminations free of oxides and other contaminants

APPLICATIONS

- Any motor or magnet wire application that requires a direct PCB connection

SAMPLES NOW AVAILABLE

te.com/products/multispring



SPECIFICATIONS

- Product Specification: 108-74116
- Application Specification: 114-74109
- Cavity Specification: 114-74109-5

MATERIALS

- Tin over Copper Alloy

PRODUCT OFFERINGS

Designed for standard applications

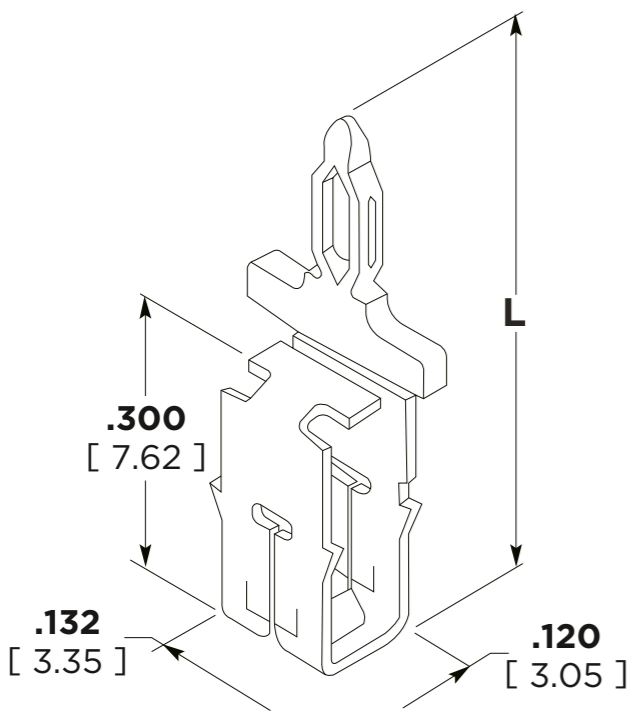
	Type	Copper Magnet Wire Range ¹		Dim L	Stock Thickness		Strip Part Number
		AWG	mm		Tab Section	Mag Wire Section	
	MAG-MATE connector with Multispring pin Solderless PCB 300 Box Terminal	33 - 29.5	0.18 - 0.265	14.80 (0.583)	0.80 (0.031)	0.32 (0.013)	1247000-2
		29.5 - 26	0.265 - 0.40	14.80 (0.583)	0.80 (0.031)	0.32 (0.013)	1247001-2
		26 - 22.5	0.40 - 0.63	14.80 (0.583)	0.80 (0.031)	0.32 (0.013)	1247002-2
		22.5 - 19.5 ²	0.63 - 0.85	14.80 (0.583)	0.80 (0.031)	0.32 (0.013)	1247003-2
		19.5 - 17 ²	0.85 - 1.12	14.80 (0.583)	0.80 (0.031)	0.32 (0.013)	1247004-2

1.Two magnet wires may be terminated in the same IDC slot if dia are equal.

2.Single magnet wire only. 22 awg [0.63 mm] and larger.

Note: PC Board hole size .057 [1.45 mm]

While TE has made every reasonable effort to ensure the accuracy of the information in this flyer, TE does not guarantee that it is error-free, nor does TE make any other representation, warranty or guarantee that the information is accurate, correct, reliable or current. TE reserves the right to make any adjustments to the information contained herein at any time without notice. TE expressly disclaims all implied warranties regarding the information contained herein, including, but not limited to, any implied warranties of merchantability or fitness for a particular purpose. The dimensions in this flyer are for reference purposes only and are subject to change without notice. Specifications are subject to change without notice. Consult TE for the latest dimensions and design specifications.

te.com/products/multispring

