

.250 (6.4) "STURDI-MOUNT" PC QUICK-FIT HEADERS



- Ideal for rugged multi-insertion applications
- Pre-assembled header reduces PC assembly costs
- Increases PC board retention strength
- Keeps terminals perpendicular
- Maintains position for wave soldering

AVAILABLE IN BRASS OR STEEL TABS

SPECIFICATIONS

Material: .032 (.80) thick Brass or Steel, Tin Plated
Insulator: Thermoplastic, UL Rated 94V-0
Current Rating: 15 Amps @ 500V AC
Temperature Rating: -58°F to +292°F (-50°C to +145°C)



.250 (6.4) HORIZONTAL

| BRASS TABS | STEEL TABS | NO. OF TABS | A DIM. |
|------------|------------|-------------|--------------|
| CAT. NO. | CAT. NO. | | |
| 7802 | 7822 | 2 | .362 (9.2) |
| 7803 | 7823 | 3 | .562 (14.3) |
| 7804 | 7824 | 4 | .762 (19.4) |
| 7805 | 7825 | 5 | .962 (24.4) |
| 7806 | 7826 | 6 | 1.162 (29.5) |

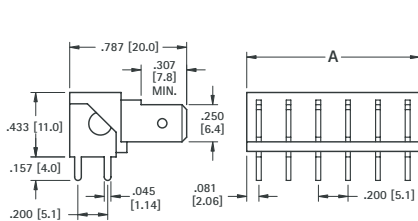

.250 (6.4) VERTICAL

| BRASS TABS | STEEL TABS | NO. OF TABS | A DIM. |
|------------|------------|-------------|--------------|
| CAT. NO. | CAT. NO. | | |
| 7812 | 7832 | 2 | .362 (9.2) |
| 7813 | 7833 | 3 | .562 (14.3) |
| 7814 | 7834 | 4 | .762 (19.4) |
| 7815 | 7835 | 5 | .962 (24.4) |
| 7816 | 7836 | 6 | 1.162 (29.5) |

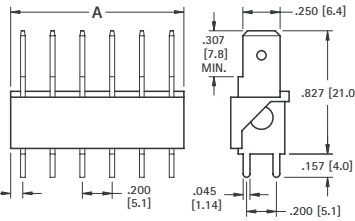

Mtg. Holes: .052 (1.3) Dia. on .200 (5.1) Centers

RIVET MOUNT QUICK-FIT TERMINALS



.110 (2.8) - .187(4.8) - .250 (6.4) TABS

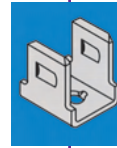
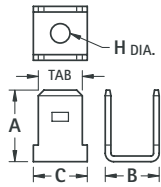
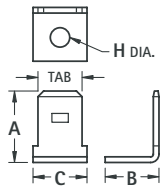

90° TAB

MATERIAL: Bright Brass

| CAT. NO. | TAB SIZE | MAT'L THICK | A | B | C | HOLE DIA. |
|----------|------------|-------------|-------------|------------|------------|------------|
| 2002 | .110 (2.8) | .020 (.51) | .375 (9.5) | .270 (6.9) | .180 (4.6) | .096 (2.4) |
| 1261 | .187 (4.8) | .020 (.51) | .375 (9.5) | .250 (6.4) | .250 (6.4) | .099 (2.5) |
| 1256 | .250 (6.4) | .032 (.81) | .405 (10.3) | .343 (8.7) | .312 (7.9) | .130 (3.3) |

.110 (2.8) - .187 (4.8) - .250 (6.4) TABS

90° TABS

MATERIAL: Bright Brass

| CAT. NO. | TAB SIZE | MAT'L THICK | A | B | C | HOLE DIA. |
|----------|------------|-------------|-------------|------------|------------|------------|
| 2003 | .110 (2.8) | .020 (.51) | .350 (8.9) | .383 (9.7) | .180 (4.6) | .096 (2.4) |
| 1262 | .187 (4.8) | .020 (.51) | .312 (7.9) | .250 (6.4) | .250 (6.4) | .099 (2.5) |
| 1257 | .250 (6.4) | .032 (.81) | .405 (10.3) | .343 (8.7) | .312 (7.9) | .130 (3.3) |

.250 (6.4) TAB

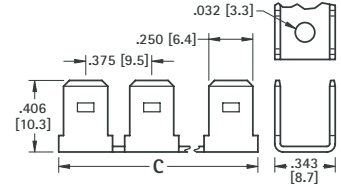

MULTIPLE 90°

MATERIAL: Bright Brass

| CAT. NO. | PAIRS | C | TAB SIZE |
|----------|-------|--------------|------------|
| 1005 | 2 | .687 (17.4) | .250 (6.4) |
| 1006 | 3 | 1.062 (27.0) | |
| 1007 | 4 | 1.441 (36.6) | |
| 1008 | 5 | 1.820 (46.2) | |

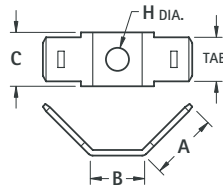
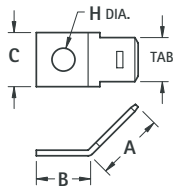

45° TAB

MATERIAL: Bright Brass

| CAT. NO. | TAB SIZE | MAT'L THICK | A | B | C | HOLE DIA. |
|----------|------------|-------------|-------------|------------|------------|------------|
| 2004 | .110 (2.8) | .020 (.51) | .350 (8.9) | .270 (6.9) | .180 (4.6) | .096 (2.4) |
| 1271 | .187 (4.8) | .020 (.51) | .375 (9.5) | .250 (6.4) | .250 (6.4) | .099 (2.5) |
| 1280 | .250 (6.4) | .032 (.81) | .405 (10.3) | .312 (7.9) | .312 (7.9) | .130 (3.3) |

45° TABS

MATERIAL: Bright Brass

| CAT. NO. | TAB SIZE | MAT'L THICK | A | B | C | HOLE DIA. |
|----------|------------|-------------|-------------|------------|------------|------------|
| 2005 | .110 (2.8) | .020 (.51) | .350 (8.9) | .383 (9.7) | .180 (4.6) | .096 (2.4) |
| 1263 | .187 (4.8) | .020 (.51) | .312 (7.9) | .250 (6.4) | .250 (6.4) | .099 (2.5) |
| 1258 | .250 (6.4) | .032 (.81) | .405 (10.3) | .343 (8.7) | .312 (7.9) | .130 (3.3) |

.110 (2.8) TAB

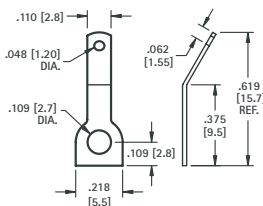

.187 (4.8) - .205 (6.4) TABS

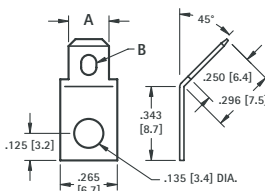

45° TAB MATERIAL: .020 (.51) thick Brass, Tin Plate

| CAT. NO. | A | B |
|----------|------------|-------------------------------|
| 4005 | .205 (5.2) | .132 (3.4) × .070 (1.78) Slot |
| 4095 | .187 (4.7) | .078 (1.98) Dia. Hole |

.250 (6.4) MALE TAB INSERTION TOOL

Designed to install .250 (6.4) male "Quick-Fit" terminals quickly and easily. Refer to pages 44 and 45.

- Insert terminal into slot, spring clip will hold terminal securely for positioning
- Align terminal with mounting holes and "press-fit" to secure firmly in place
- Lift tool to release terminal

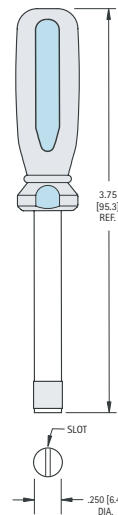

CAT. NO. 1288

QUICK-FIT TERMINALS