

PART NUMBER	REV	FIRST USED	MACHINE REFERENCE	FEED TYPE
566452-1	A	356462-2	G-SPLICE TERM	AIR FEED
566452-2	B	2161300-1	5K CE THRU SPLICE	AIR FEED
7-566452-7	A	356462-2	SPARE PARTS KIT	-
7-566452-8	B	-	CONV KIT FROM -1 TO -2	-

TERMINAL NAME: SPLICE				
TE PN	MFR PN	HU LANE TERMINAL - TE CRIMP SPECS		
2113135	608101-A			
-	-	PAD LTR	CRIMP HEIGHT	WIRE SIZE
-	-	-	2.36±.05mm [.093±.002]	(4) 18 AWG
-	-	-	2.16±.05mm [.085±.002]	(3) 18 AWG
-	-	-	1.95±.05mm [.077±.002]	(2) 18 AWG
-	-	-	-	-
-	-	CRIMP	SIZE	TYPE
-	-	-	3.30mm [.130]	F
-	-	WIRE		
-	-	INS		
WIRE STRIP LENGTH	TERM APPL SPEC	FEED	APPL INSTRUCTIONS	SET UP GAGE
6.70-7.50	NONE	13.50	408-8318(-1) 408-127000(-2)	-

LOC	DIST	REV	DATE	BY	APPV
A	66	A	23SEP2010	BH	BH
		A1	23DEC2011	RS	SX
		B	27OCT2015	XZ	TE

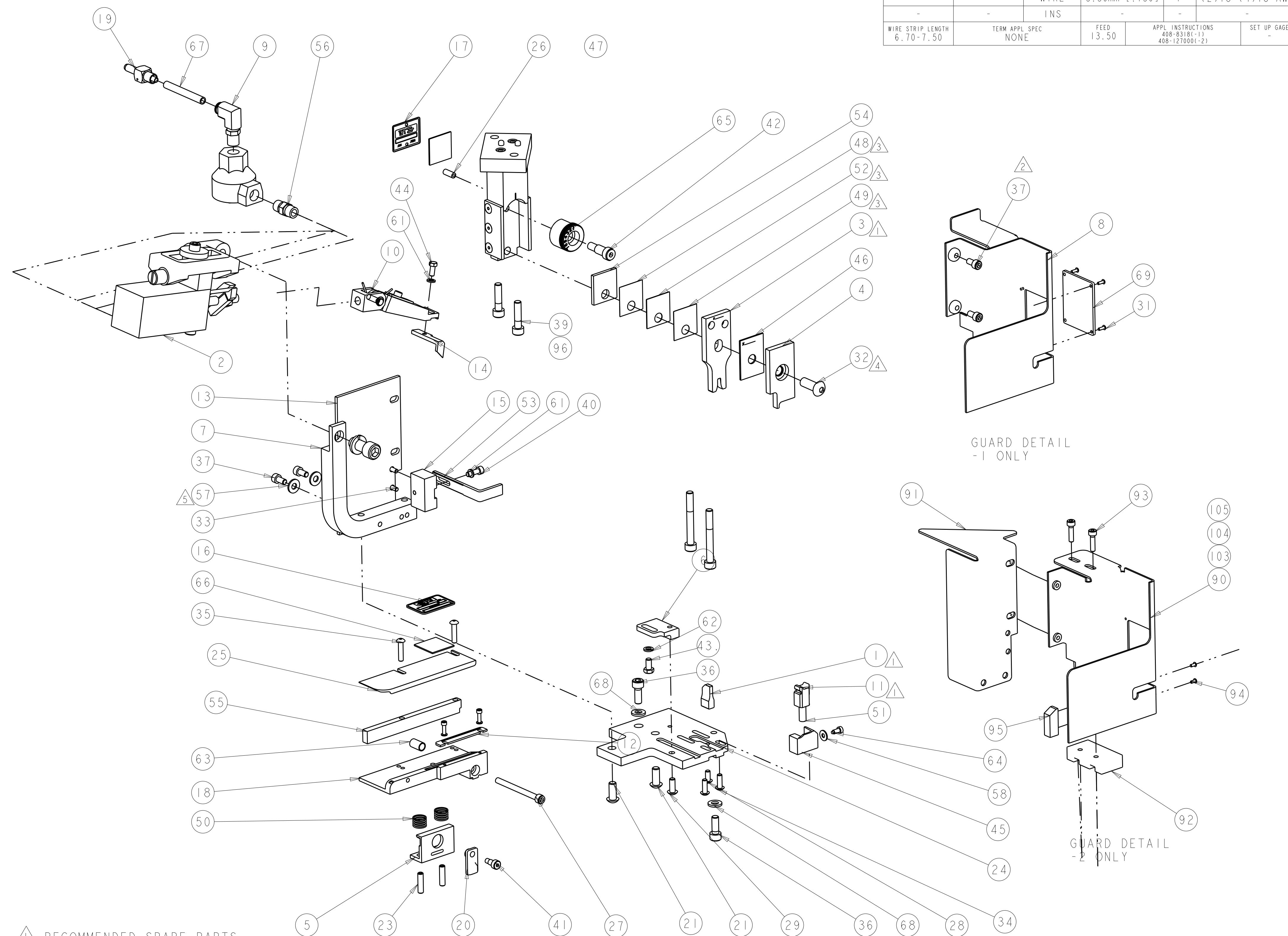

QTY	REV	LOC	DIST	DESCRIPTION	DATE	BY	APPV
2	-	2	-	18029-2	NUT, HEX, REG M4		1105
2	-	2	-	18025-2	WASHER, SPRG LOCK, REG M4		1104
2	-	2	-	18027-2	WASHER, FLAT, REG M4		1103
1	-	1	-	408-32162	THRU SPLICE INSTRUCTION SHEET		1102
-	-	1	1	217238-1	GENERAL INSTRUCTION PKG		99
-	-	1	1	408-8318	THRU SPLICE IS SHEET		98
-	-	1	-	408-127000	THRU SPLICE IS SHEET		97
-	-	2	-	3-18023-3	SCR, SKT HD CAP M6 X 50.0		96
-	-	1	1	1338177-1	DEFLECTOR, CHIP		95
-	-	2	2	21002-9	SCR, BTN SKT HD CAP 2-56 X .188		94
2	-	2	-	1-18023-3	SCR, SKT HD CAP M4 X 16.0		93
1	-	1	-	2168489-1	ACTUATOR, SPARE, MCI		92
1	-	1	-	2161461-1	GUARD, EXTENSION		91
1	-	1	-	2161460-1	GUARD		90
-	-	1	1	1338174-1	WINDOW, GUARD		69
-	-	2	2	18027-4	WASHER, FLAT, REG M6		68
-	-	21	21	27319-4	TUBING, POLY-FLO, NATURAL		67
-	-	AR	AR	982057-2	TAPE, FOAM		66
-	-	1	1	1338124-1	WHEEL, ADJUSTING		65
-	-	1	1	690461-2	STOP, SHEAR		64
-	-	1	1	1-22281-8	SPRING, COMPRESSION		63
-	-	1	1	21024-5	WASHER, SPRG LOCK, REG NO 10		62
-	-	2	2	21024-4	WASHER, SPRG LOCK, REG NO 8		61
-	-	2	2	21024-2	WASHER, SPRG LOCK, REG NO 4		60
-	-	1	1	21024-8	WASHER, SPRG LOCK, REG 3/8		59
-	-	1	1	21055-5	WASHER, FLAT, REG NO 6		58
-	-	AR	AR	21899-2	WASHER, FLAT		57
-	-	1	1	22374-7	VALVE, QUICK EXHAUST		56
-	-	1	1	1320908-4	SPACER, STRIP GUIDE		55
-	-	1	1	1338200-5	SPACER		54
-	-	1	1	1-690472-6	STRIPPER		53
-	-	1	1	1338200-3	SPACER		52
-	-	1	1	3-22280-3	SPRING, COMPRESSION		51
-	-	2	2	1-22284-0	SPRING, COMPRESSION		50
-	-	1	1	1338200-2	SPACER		49
-	-	1	1	1338200-1	SPACER		48
-	-	1	1	1338117-1	SIDE FEED TOOL HOLDER ASS'Y		47
-	-	1	1	1-455888-0	SPACER, CRIMPER		46
-	-	1	1	1-690459-0	SHEAR HOLDER, FRONT		45
-	-	1	1	2-22603-1	SCREW, MACH, HEX HD, 8-32 X .375		44
-	-	1	1	3-22603-1	SCREW, MACH, HEX HD, 10-32 X .375		43
-	-	1	1	21004-9	SCR, SKT HD SHLDR 5/16 DIA X .500		42
-	-	1	1	21989-8	SCR, SKT HD SHLDR 3/16 DIA X .250		41
-	-	1	1	2-21000-7	SCR, SKT HD CAP 8-32 X .500		40
-	-	2	2	3-18023-0	SCR, SKT HD CAP M6 X 25.0		39
-	-	1	1	3-21001-4	SCR, SKT HD CAP 3/8-16 X .875		38
-	-	4	4	3-21000-4	SCR, SKT HD CAP 10-32 X .375		37
-	-	2	2	2-18023-8	SCR, SKT HD CAP M6 X 16.0		36
-	-	2	2	2-21002-4	SCR, BTN SKT HD CAP 8-32 X .750		35
-	-	2	2	2-21002-2	SCR, BTN SKT HD CAP 8-32 X .500		34
-	-	2	2	1-21002-7	SCR, BTN SKT HD CAP 6-32 X .375		33
-	-	1	1	7-21002-8	SCR, BTN SKT HD CAP 5/16-24 X .875		32
-	-	4	4	1-21002-0	SCR, BTN SKT HD CAP 2-56 X .250		31
-	-	2	2	1-21000-4	SCR, SKT HD CAP 4-40 X .375		30
-	-	1	1	2-21002-7	SCR, BTN SKT HD CAP 10-32 X .500		29
-	-	1	1	22733-8	SCR, BHSC, SELF-LOCKING, 8-32 X .375		28
-	-	1	1	7-21000-7	SCR, SKT HD CAP 10-32 X 2.250		27
-	-	1	1	27058-2	PLUNGER, SPRING, STUBBY		26
-	-	1	1	1320928-1	STRIP GUIDE		25
-	-	1	1	1338397-1	PLATE, BASE		24
-	-	2	2	5-21006-6	SCR, SET, CUP POINT 10-32 X .750		23
-	-	1	1	22304-1	NIPPLE, HEX, PIPE FITTING		22
-	-	2	2	2-22733-8	SCR, BHSC, SELF-LOCKING, 1/4-20 X .625		21
-	-	1	1	356835-1	LEVER, DRAG RELEASE		20
-	-	1	1	23238-1	INSERT, COUPLING		19
-	-	1	1	1633087-2	PLATE, STRIP GUIDE		18
-	-	1	1	690701-2	PLATE, IDENTIFICATION		17
-	-	1	1	26704-2	PLATE, IDENTIFICATION		16
-	-	1	1	1338118-1	MOUNT, STRIPPER		15
-	-	1	1	1-694433-7	FEED PAWL		14
-	-	1	1	1338176-1	GUARD, EXTENSION		13
-	-	1	1	690438-1	FRONT STRIP GUIDE		12
-	-	1	1	454276-5	FLOATING SHEAR, FRONT		11
-	-	1	1	461062-1	FEED FINGER ASSEMBLY		10
-	-	1	1	980285-2	CONNECTOR, ELBOW, 90° S/S, MINI		9
-	-	1	1	1338175-1	ASSY, GUARD		8
-	-	1	1	1338116-1	BRACKET, FEED		7
-	-	1	1	455689-1	BLOCK, STRIP GUIDE ADJUST		6
-	-	1	1	240792-1	DRAG, TERMINAL		5
-	-	1	1	1338126-1	DEPRESSOR, MODIFIED		4
-	-	1	1	1-1338125-2	CRIMPER, WIRE		3
-	-	1	1	461065-1	ASSEMBLY, AIR FEED		2
-	-	1	1	1633572-6	ANVIL, WIRE		1

- ▲ RECOMMENDED SPARE PARTS.
- ▲ GAURD MUST BE IN PLACE WHEN OPERATING APPLICATOR IN A BENCH MACHINE.
- ▲ INSTALL ITEMS 49, 52 & 54. SHIP REMAINING ITEM WITH APPLICATOR.
- ▲ CRIMPER BOLT MUST BE LOOSENED TO CHANGE CRIMP HEIGHT ADJUSTING WHEEL. BE SURE TO SEAT THE CRIMPER AGAINST THE ADJUSTING WHEEL AND REALIGN THE TOOLING.
- ▲ PLACE ITEM 57 BETWEEN ITEM 7 AND ITEM 13 ON -1. PLACE ITEM 57 BETWEEN ITEM 7 AND ITEM 91 ON -2.

DIMENSIONS: IN		TOLERANCES UNLESS OTHERWISE SPECIFIED: 0 PLC ±. 1 PLC ±. 2 PLC ±. 3 PLC ±. 4 PLC ±. ANGLES ±.		DWG: R.O. WILSON 22JUL2010 CHK: K.J. STAKEM 27JUL2010 APVD: T.L. ELBIN 27JUL2010		NAME: APPLICATOR, THRU SPLICE G SIDE FEED	
MATERIAL:		FINISH:		WEIGHT:		SIZE: A 100779 C=566452	
Customer Accessible Production Drawing				SCALE: 3:5		SHEET 1 OF 1 REV B	