

MALE/FEMALE THREADED STANDOFFS

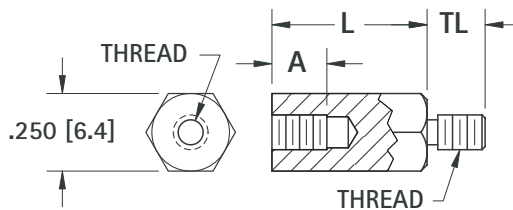

| THREAD SIZE | TL EXTERNAL | A INTERNAL |
|-------------|-------------|------------|
| 4-40 | .187 (4.7) | .250 (6.4) |
| 6-32 | .250 (6.4) | .375 (9.5) |
| 8-32 | .375 (9.5) | .375 (9.5) |

Application Note:
For PC/104 applications use length .600 (15.3) 4-40 Thread

| CHOICE OF: | | |
|----------------------------------|---|--|
| Stainless: ASTM A581/A582 | Brass: ASTM-B16 Plating: Nickel (QQ-N-290) | Aluminum: ASTM B211 Plating: Clear Iridite (Mil-C-5541) |

| 4-40 THREAD | | | |
|---------------|--------------------------|----------------|-------------------|
| L LENGTH | STAINLESS STEEL CAT. NO. | BRASS CAT. NO. | ALUMINUM CAT. NO. |
| .250 (6.4)*** | 8712 | 8713 | 8714 |
| .375 (9.5) | 2087 | 7200 | 8400 |
| .500 (12.7) | 2088 | 1944 | 8401 |
| .600 (15.3)* | 5799 | 8799 | 6799 |
| .625 (15.9) | 2089 | 1945 | 8402 |
| .750 (19.1) | 2090 | 1946 | 8403 |
| .875 (22.2) | 2091 | 7201 | 8404 |
| 1.000 (25.4) | 2092 | 1947 | 8405 |
| 1.125 (28.6) | 2093 | 7202 | 8406 |
| 1.250 (31.8) | 2094 | 1948 | 8407 |
| 1.375 (34.9) | 2095 | 1949 | 8408 |
| 1.500 (38.1) | 2096 | 1950 | 8409 |
| 1.625 (41.3) | 2097 | 7203 | 8410 |
| 1.750 (44.5) | 2098 | 7205 | 8411 |
| 2.000 (50.8) | 2099 | 1951 | 8412 |

*PC/104 Standard Length
***Internal Thread .130 (3.3)/.150 (3.8) Deep

| 6-32 THREAD | | | |
|---------------|--------------------------|----------------|-------------------|
| L LENGTH | STAINLESS STEEL CAT. NO. | BRASS CAT. NO. | ALUMINUM CAT. NO. |
| .250 (6.4)*** | 8715 | 8716 | 8717 |
| .375 (9.5)** | 2119 | 7210 | 8413 |
| .500 (12.7) | 2120 | 1952 | 8414 |
| .625 (15.9) | 2121 | 1953 | 8415 |
| .750 (19.1) | 2122 | 1954 | 8416 |
| .875 (22.2) | 2123 | 7211 | 8417 |
| 1.000 (25.4) | 2124 | 1644 | 8418 |
| 1.125 (28.6) | 2125 | 7212 | 8419 |
| 1.250 (31.8) | 2126 | 1955 | 8420 |
| 1.375 (34.9) | 2127 | 1956 | 8421 |
| 1.500 (38.1) | 2128 | 1645 | 8422 |
| 1.625 (41.3) | 2129 | 7214 | 8423 |
| 1.750 (44.5) | 2130 | 7215 | 8424 |
| 2.000 (50.8) | 2131 | 1646 | 8425 |

** Internal Thread .250 (6.4) Deep
*** Internal Thread .130 (3.3)/.150 (3.8) Deep

| 8-32 THREAD | | | |
|---------------|--------------------------|----------------|-------------------|
| L LENGTH | STAINLESS STEEL CAT. NO. | BRASS CAT. NO. | ALUMINUM CAT. NO. |
| .250 (6.4)*** | 8731 | 8732 | 8733 |
| .375 (9.5)** | 2149 | 7220 | 8426 |
| .500 (12.7) | 2150 | 1957 | 8427 |
| .625 (15.9) | 2151 | 1958 | 8428 |
| .750 (19.1) | 2152 | 1959 | 8429 |
| .875 (22.2) | 2153 | 7221 | 8430 |
| 1.000 (25.4) | 2154 | 1960 | 8431 |
| 1.125 (28.6) | 2155 | 7222 | 8432 |
| 1.250 (31.8) | 2156 | 1961 | 8433 |
| 1.375 (34.9) | 2157 | 1962 | 8434 |
| 1.500 (38.1) | 2158 | 1963 | 8435 |
| 1.625 (41.3) | 2159 | 7224 | 8436 |
| 1.750 (44.5) | 2160 | 7225 | 8437 |
| 2.000 (50.8) | 2161 | 1964 | 8438 |
| 2.500 (63.5) | 2180 | 1965 | 8439 |
| 3.000 (76.2) | 2181 | 1966 | 8440 |

** Internal Thread .250 (6.4) Deep
*** Internal Thread .130 (3.3)/.150 (3.8) Deep

THREADED NYLON STANDOFFS

MATERIAL: Nylon 6/6

FEMALE STANDOFFS
UL RATED 94V-2



| L LENGTH | THREAD SIZE | | |
|--------------|---------------|---------------|---------------|
| | 4-40 CAT. NO. | 6-32 CAT. NO. | 8-32 CAT. NO. |
| .250 (6.4) | 1902A | 1903A | 1904A |
| .375 (9.5) | 1902B | 1903B | 1904B |
| .500 (12.7) | 1902C | 1903C | 1904C |
| .625 (15.8) | 1902F | 1903F | 1904F |
| .750 (19.1) | 1902D | 1903D | 1904D |
| .875 (22.2) | 1902G | 1903G | 1904G |
| 1.000 (25.4) | 1902E | 1903E | 1904E |

FLAME RETARDANT
FEMALE STANDOFFS
UL RATED 94V-0

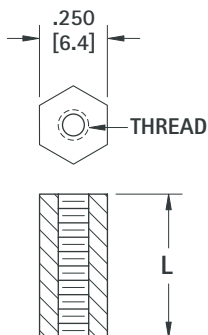

| L LENGTH | THREAD SIZE | | |
|--------------|---------------|---------------|---------------|
| | 4-40 CAT. NO. | 6-32 CAT. NO. | 8-32 CAT. NO. |
| .250 (6.4) | 8440A | 8441A | 8442A |
| .375 (9.5) | 8440B | 8441B | 8442B |
| .500 (12.7) | 8440C | 8441C | 8442C |
| .625 (15.8) | 8440D | 8441D | 8442D |
| .750 (19.1) | 8440E | 8441E | 8442E |
| .875 (22.2) | 8440F | 8441F | 8442F |
| 1.000 (25.4) | 8440G | 8441G | 8442G |

MALE/FEMALE STANDOFFS
UL RATED 94V-2

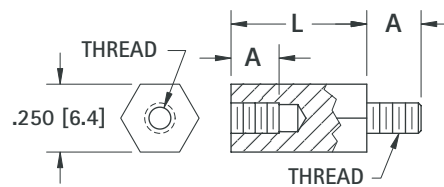

| L LENGTH | THREAD SIZE | | |
|---------------|---------------|---------------|---------------|
| | 4-40 CAT. NO. | 6-32 CAT. NO. | 8-32 CAT. NO. |
| .250 (6.4)*** | 4800 | 4814 | 4828 |
| .375 (9.5) | 4801 | 4815 | 4829** |
| .500 (12.7) | 4802 | 4816 | 4830 |
| .600 (15.3)* | 4799 | - | - |
| .625 (15.9) | 4803 | 4817 | 4831 |
| .750 (19.1) | 4804 | 4818 | 4832 |
| .875 (22.2) | 4805 | 4819 | 4833 |
| 1.000 (25.4) | 4806 | 4820 | 4834 |
| 1.125 (28.6) | 4807 | 4821 | 4835 |
| 1.250 (31.8) | 4808 | 4822 | 4836 |
| 1.375 (34.9) | 4809 | 4823 | 4837 |
| 1.500 (38.1) | 4810 | 4824 | 4838 |
| 1.625 (41.3) | 4811 | 4825 | 4839 |
| 1.750 (44.5) | 4812 | 4826 | 4840 |
| 2.000 (50.8) | 4813 | 4827 | 4841 |

* PC/104 Standard Length
** Internal Thread .250 (6.4) Deep
*** Internal Thread .130 (3.3)/.150 (3.8) Deep

Application Note:
For PC/104 applications use CAT. NO. 4799

| THREAD SIZE | A |
|-------------|------------|
| 4-40 | .187 (4.7) |
| 6-32 | .250 (6.4) |
| 8-32 | .375 (9.5) |

HEX MALE/FEMALE STANDOFFS