

8 7 6 5 4 3 2 1

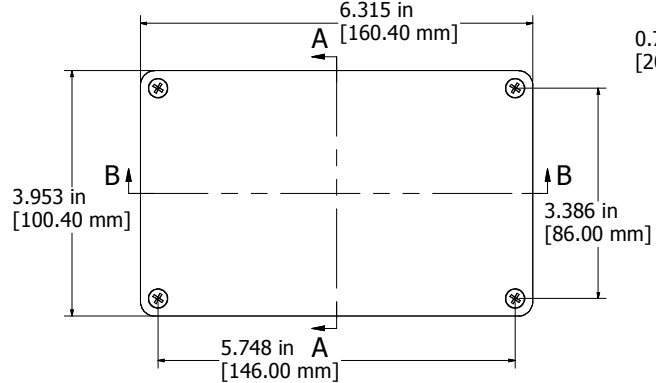

ASSEMBLY

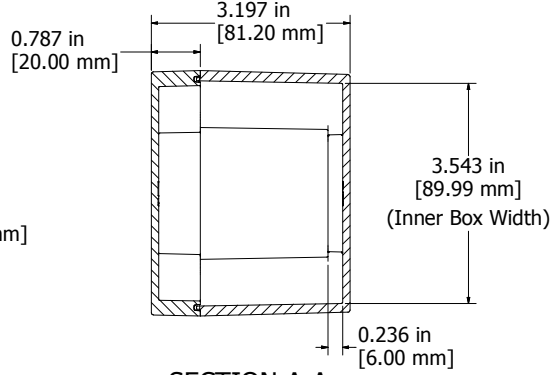

SECTION A-A
End View of Assembly

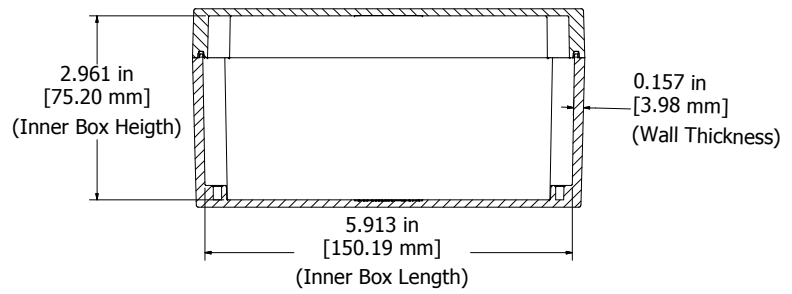
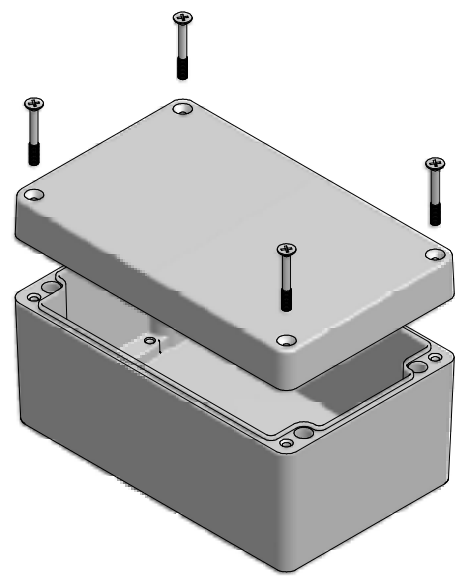

SECTION B-B
Side View of Assembly

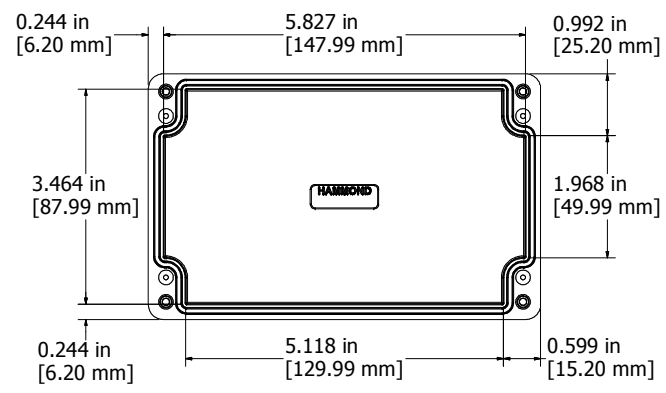
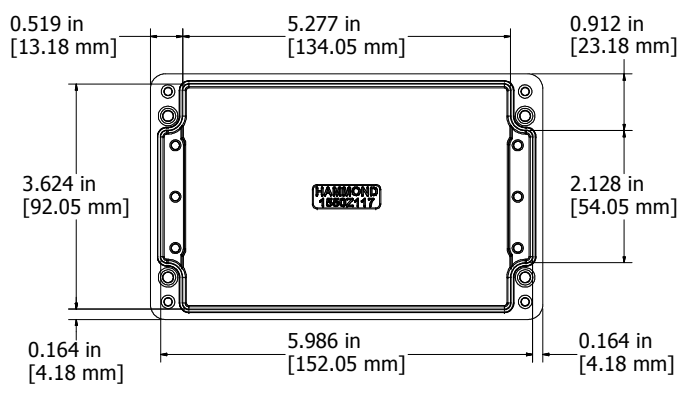

Enclosures can be Factory Modified (Milling, Drilling, Printing etc.)
Contact Factory mjm@hammondmfg.com for quotes
Solid models of this enclosure available in STEP or IGES.

NOTES	
Purchased assembly includes enclosure, M4x30 lid screws	
Gasket - Pre-formed Silicone Rubber	
Cover screws should be torqued to 5-7.5 lbf.in (50-75 cN.m)	

1550Z117	
PART NUMBERS	
Unfinished	1550Z117
Black Textured Powder Paint - RAL 9011	1550Z117BK



8 7 6 5 4 3 2 1