

REV.	DATE	DESCRIPTION
NC	01/01/05	INITIAL RELEASE
A	03/18/05	UPDATE DRAWING FORMAT
B	08/28/06	REVISE BARREL DIMENSIONS TO 2.24mm ID / 3.20mm O.D. CONTACT PIN I.D. TO .60mm/ INSULATOR .50mm I.D. AND 2.2mm O.D.

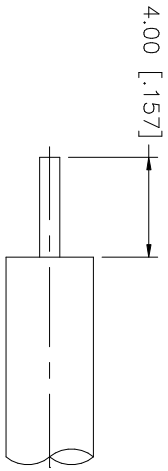

RECOMMENDED  
CABLE STRIPPING DIM'S

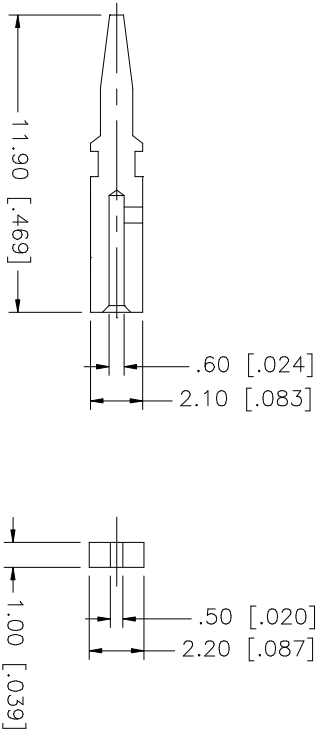
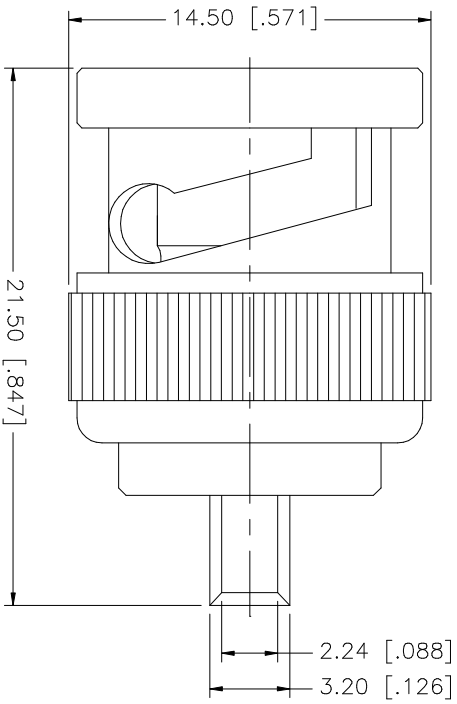

NOTE:  
1. CRIMPED CONTACT PIN  
HEX CRIMP SIZE 1.72 [.068"]

QTY	FINISH	MATERIAL	DESCRIPTION
1	GOLD	BRASS	CONTACT PIN
1	NATURAL	TEFLON	INSULATOR
1	GOLD	BRASS	BODY

APPROVALS	DATE	CAO FILE	DWG. NO.	REV.	SIZE	SCALE
DRAWN G.R.S.	08/28/06	C:/112/112552.DWG	112552.DWG	B	A	NA
CHECKED						
ISSUED						
SHEET 1 OF 1						

UNLESS OTHERWISE SPECIFIED DIMENSIONS ARE IN INCHES UNLESS DIMENSIONS IN PARENTHESES ARE IN MILLIMETERS
TOLERANCES FOR MILLIMETERS ARE: 0.5 - 8mm ± 0.20mm 8 - 30mm ± 0.40mm 30 - 120mm ± 0.50mm
TOLERANCES FOR INCHES ARE: UNLESS OTHERWISE SPECIFIED .020 - .315 = ± 0.007" .315 - 1.180 = ± 0.015" 1.180 - 4.724 = ± 0.020"

APPROVALS	DATE	CAO FILE	DWG. NO.	REV.	SIZE	SCALE
DRAWN G.R.S.	08/28/06	C:/112/112552.DWG	112552.DWG	B	A	NA
CHECKED						
ISSUED						
SHEET 1 OF 1						

**Amphenol Connex**

BNC DIRECT SOLDER PLUG  
(FOR .085", .086" SEMI RIGID CABLE)

PART NO. 112552