

8				7			
THIS DRAWING IS UNPUBLISHED.				RELEASED FOR PUBLICATION			
COPYRIGHT 20				20			
BY TYCO ELECTRONICS CORPORATION. ALL RIGHTS RESERVED.							
PART NUMBER		REV	FIRST USED	POWER UNIT	FEED TYPE	DESCRIPTION	
1852414-1		A	122500-1	LEADMAKER	POST FEED	CUTS CARRIER	
1852414-2		A	565435-5	BENCH MODEL K	PRE FEED	CUTS CARRIER	
1852414-3		A	354500-1	BENCH MODEL G	PRE FEED	CUTS CARRIER	
1852414-6		A	122500-1	LEADMAKER	POST FEED	CONTINUOUS CARRIER	
7-1852414-7		A	-	-	-	SPARE PARTS	

- △ RECOMMENDED SPARE PARTS
- △ GREASE LIGHTLY
- △ GUARD MUST BE IN PLACE WHEN OPERATING APPLICATOR IN A BENCH MACHINE

**\* WARNING**  
ON INSTALLATION, SET WIRE DISC TO LARGEST WIRE SIZE SETTING. USE OF SETTINGS BELOW MIN. REQUIRED CRIMP HEIGHT SETTING WILL CAUSE DAMAGE TO CRIMP TOOLING.

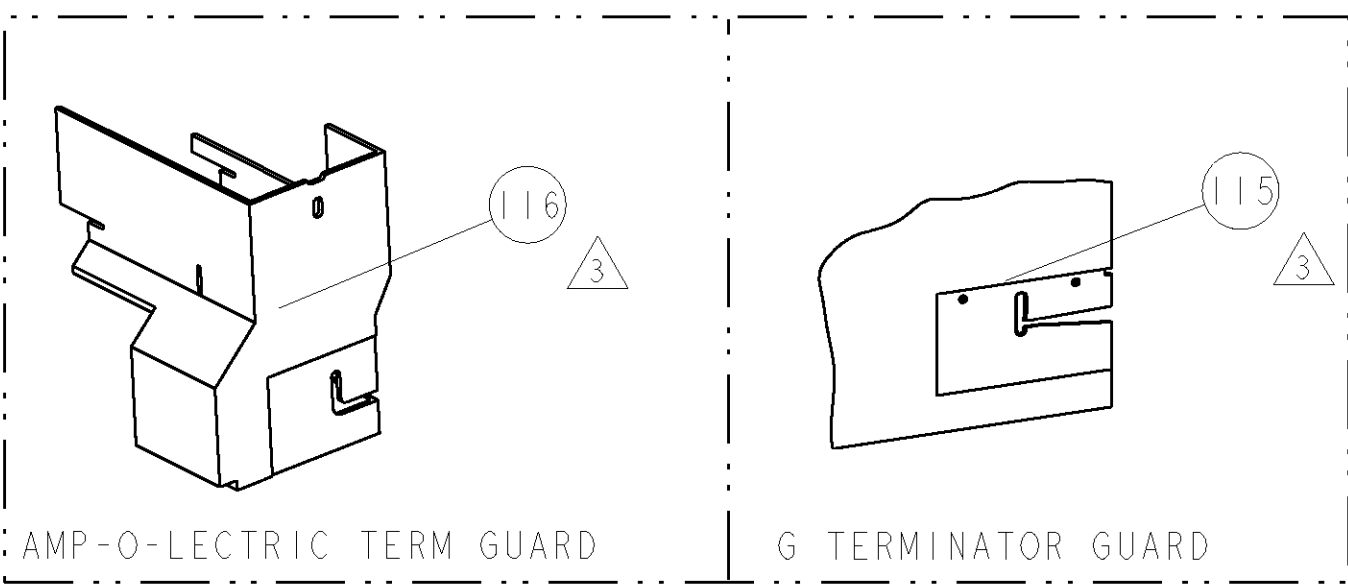
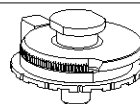

TERMINAL NAME: AMPLVAR						
1930002-1	-	AMP TERMINAL - AMP CRIMP SPECS				
-	-	CRIMP HEIGHT		WIRE SIZE	REF SETTING	
-	-	1.23±0.05[.048±.002]		1.09mm2	C1	
-	-	1.14±0.05[.045±.002]		0.95mm2	C5	
-	-	1.08±0.05[.043±.002]		0.85mm2	D0	
-	-	1.03±0.05[.041±.002]		0.76mm2	D5	
-	-	CRIMP	SIZE	TYPE	RANGE	
-	-	WIRE	.070 [1.78mm]	F	0.68-1.09mm2	
-	-	INSUL	.110 [2.79mm]	O	-	
WIRE STRIP LENGTH .246 - .261	TERM APPL SPEC 114-58501	FEED .374	APPLICATOR INSTRUCTIONS 408-8040		SET UP GAGE 458637-1	
ADDITIONAL CRIMP HEIGHTS						
CRIMP HEIGHT		WIRE SIZE		REF SETTING		
0.99±0.05[.039±.002]		0.68mm2		D8		
-		-		-		
-		-		-		
-		-		-		
-		-		-		
-		-		-		
-		-		-		
-		-		-		
-		-		-		

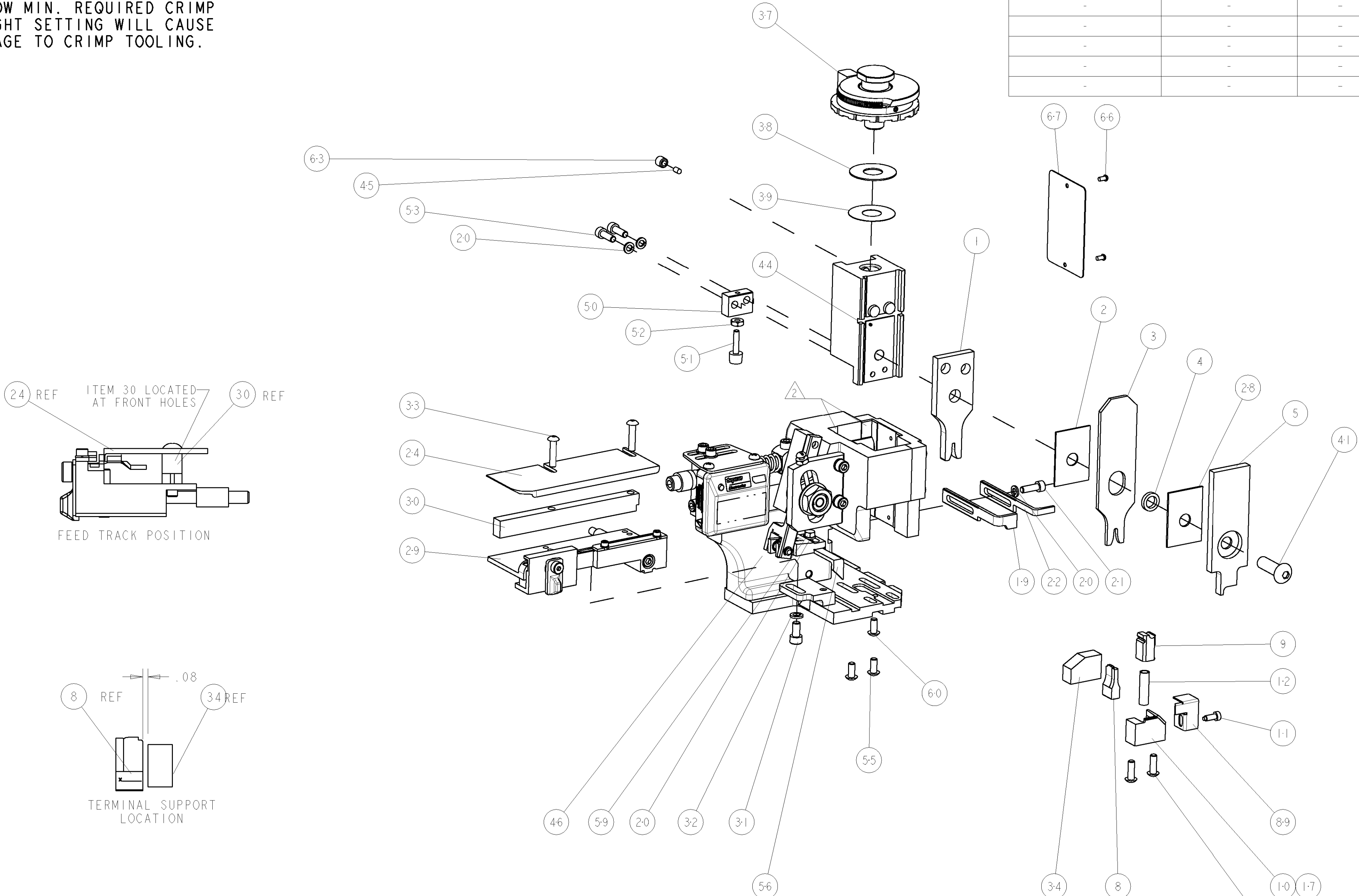

△	-	-	-	REF	-	..	455749-1	GUARD WINDOW	116
△	-	-	REF	-	-	..	679532-1	INSERT, GUARD	115
-	1	1	1	1	1	-	1-21002-7	SCR, BTN SKT HD CAP 6-32 X .375	91
-	1	1	1	1	1	-	318563-1	GUARD, FRONT CHIP	89
-	1	1	1	1	1	-	4088040	SF APPL INST 408-8040	72
-	1	1	1	1	1	-	217238-1	GENERAL INSTRUCTION PKG	71
-	1	1	1	1	1	-	461264-5	PLATE, IDENTIFICATION	67
-	2	2	2	2	-	-	21017-2	SCREW, DRIVE	66
-	1	1	1	1	1	-	21009-2	SCR, SET, SELF LOCKING 1/4-20 X .250	63
-	1	1	1	1	1	-	22733-8	SCR, BHSC, SELF-LOCKING, 8-32 X .375	60
-	1	1	1	1	1	-	2-22603-0	SCR, HEX HD CAP 8-32 X .312	59
-	1	1	1	1	1	-	458537-2	PAWL, FEED	56
-	2	2	2	2	-	-	2-21002-1	SCR, BTN SKT HD CAP 8-32 X .375	55
-	2	2	2	2	-	-	2-21002-2	SCR, BTN SKT HD CAP 8-32 X .500	54
-	2	2	2	2	-	-	2-21000-7	SCR, SKT HD CAP 8-32 X .500	53
-	1	1	1	1	1	-	21018-5	NUT, HEX, REG 6-32	52
-	1	1	1	1	1	-	811242-2	BUMPER, HOLD DOWN	51
-	1	1	1	1	1	-	690753-1	SPACER, TONKER	50
-	-	-	-	-	..	-	690602-6	CAM, PRE FEED, 1 5/8	49
-	-	-	-	-	..	-	690602-5	CAM, PRE FEED, 1 1/8	48
-	1	-	-	-	1	-	690501-4	CAM, POST FEED, 1 5/8	47
-	1	1	1	1	1	-	459456-1	APPL. BASIC SUB ASSY (SIDE WISE MQCA)	46
-	1	1	1	1	1	-	690191-1	PLUG, NYLON	45
-	1	1	1	1	1	-	819307-4	RAM, SIDE FEED	44
-	1	1	1	1	1	-	7-21002-9	SCR, BTN SKT HD CAP 5/16-24 X 1.00	41
-	1	1	1	1	1	-	690125-1	SHIM SUB-ASSY	39
-	1	1	1	1	1	-	469367-8	SHIM	38
-	1	1	1	1	1	-	879103-3	FINE ADJUST HEAD ASSEMBLY	37
-	1	1	1	1	1	-	5-690786-2	TERMINAL SUPPORT	34
-	2	2	2	2	-	-	2-21002-4	SCR, BTN SKT HD CAP 8-32 X .750	33
-	1	1	1	1	1	-	21024-5	WASHER, SPRG LOCK, REG NO 10	32
-	1	1	1	1	1	-	3-21000-4	SCR, SKT HD CAP 10-32 X .375	31
-	1	1	1	1	1	-	1320908-4	SPACER, STRIP GUIDE	30
-	1	1	1	1	1	-	1633091-1	ASSEMBLY, STRIP GUIDE	29
-	1	1	1	1	1	-	1-455888-0	SPACER, CRIMPER	28
-	1	1	1	1	1	-	1320928-3	PLATE, STRIP GUIDE	24
-	1	-	-	-	1	-	690472-2	STRIPPER	22
-	1	1	1	1	1	-	2-21000-7	SCR, SKT HD CAP 8-32 X .500	21
-	4	4	4	4	-	-	21024-4	WASHER, SPRG LOCK, REG NO 8	20
-	-	1	1	1	-	-	691353-1	STRIPPER	19
-	1	-	-	-	-	-	679625-1	SHEAR HOLDER, FRONT (NO CUT)	17
-	1	1	1	1	1	-	3-22280-3	SPRING, COMPRESSION	12
-	1	1	1	1	1	-	690461-1	STOP, SHEAR	11
△	-	-	1	1	1	-	690459-1	SHEAR HOLDER, FRONT	10
△	-	1	1	1	1	-	462006-1	FLOATING SHEAR, FRONT	9
△	1	1	1	1	1	-	1633538-1	ANVIL, WIRE "F"	8
-	1	1	1	1	1	-	2-455889-0	DEPRESSOR, SHEAR	5
-	1	1	1	1	1	-	238011-4	BLOCK, CRIMPER SPACER	4
△	1	1	1	1	1	-	9-456135-3	CRIMPER, INSULATION O PREMIUM	3
△	-	1	1	1	1	-	455888-7	SPACER, CRIMPER	2
△	1	1	1	1	1	-	5-456404-6	CRIMPER, WIRE PREMIUM	1
-77 -6 -3 -2 -1 U/M							PART NO	DESCRIPTION	ITEM NO

THIS IS THE PROPERTY OF TYCO ELECTRONICS CORPORATION. IT IS TO BE USED FOR THE PURPOSES AND DURATION SPECIFIED IN THE ORDER. IT IS TO BE RETURNED TO TYCO ELECTRONICS CORPORATION OR ITS SUCCESSOR OR TO THE CONTROLLING ENGINEERING ORGANIZATION SHOULD BE CONTACTED FOR THE LATEST EDITION.		DWN C. REICHELDT 22FEB2007	<b>tyco</b> Tyco Electronics Harrisburg, PA 17105-3608	
DIMENSIONS: INCHES		CHK T. ELBIN 22FEB2007	NAME T. BENCHOFF	
TOLERANCES UNLESS OTHERWISE SPECIFIED: 9 PLC ±.01 1 PLC ±.01 3 PLC ±.01 4 PLC ±.0001 ANGLES ±.001		PRODUCT SPEC		
MATERIAL		APPLICATION SPEC		
FINISH		WEIGHT		
CUSTOMER DRAWING		SCALE 3:5		REV A

CUSTOMER VIEWABLE ASSEMBLY

# Mouser Electronics

Authorized Distributor

Click to View Pricing, Inventory, Delivery & Lifecycle Information:

[TE Connectivity:](#)

[1852414-6](#)