

PART NUMBER	REV	FIRST USED
1852016-1	C	122500-1
1852016-2	C	565435-5
1852016-3	C	354500-1

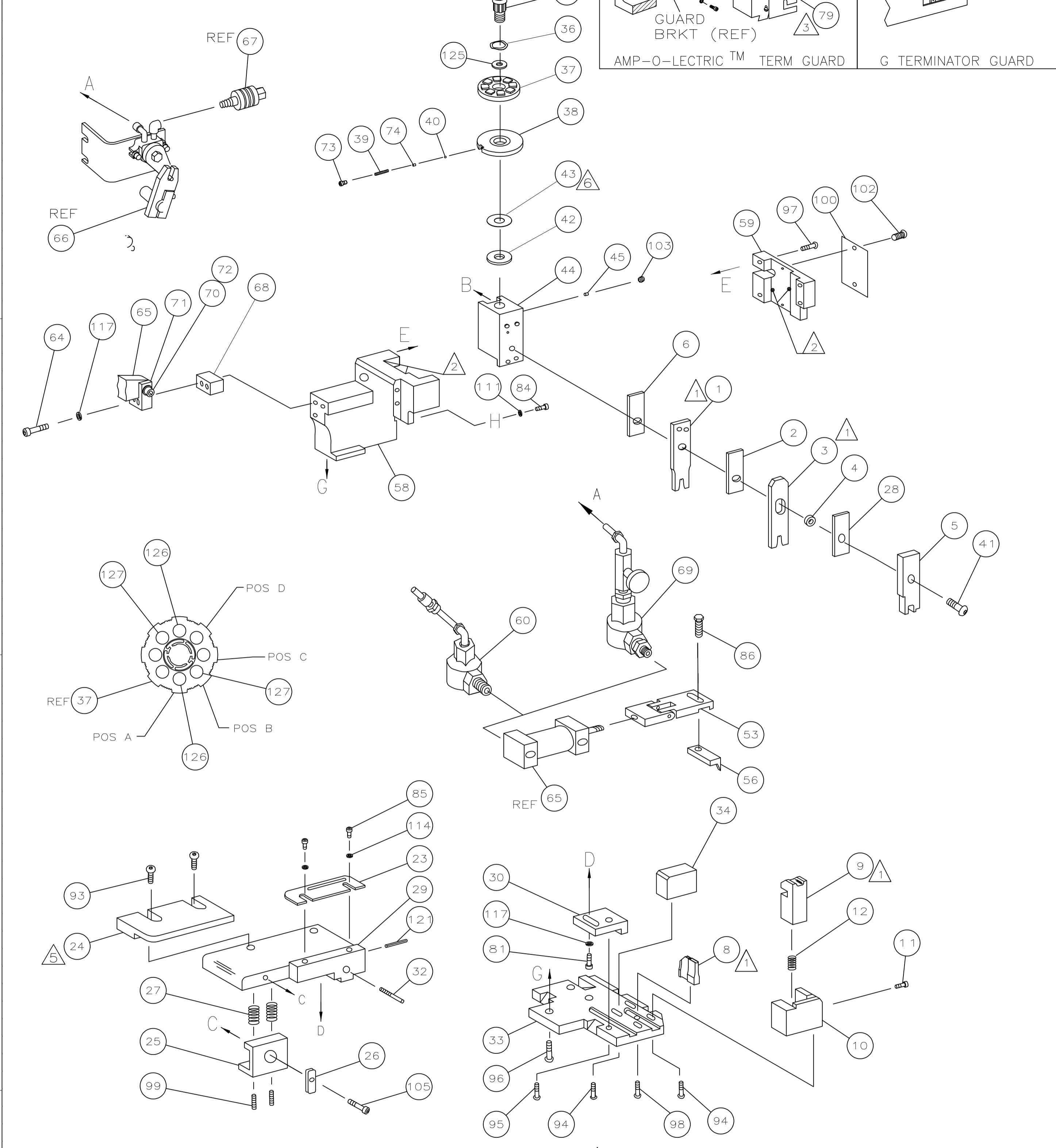

- 1 RECOMMENDED SPARE PARTS.
- 2 GREASE LIGHTLY.
- 3 GUARD MUST BE IN PLACE WHEN OPERATING APPLICATOR IN A BENCH MACHINE.
- 4 SEE DRAWING FOR COMPONENTS
- 5 REAR STRIP GUIDE TO GUIDE ON INSULATION BARREL.
- 6 ITEM 43, TRIM TO FIT OUTSIDE DIAMETER OF ITEM 42 IN ASSY

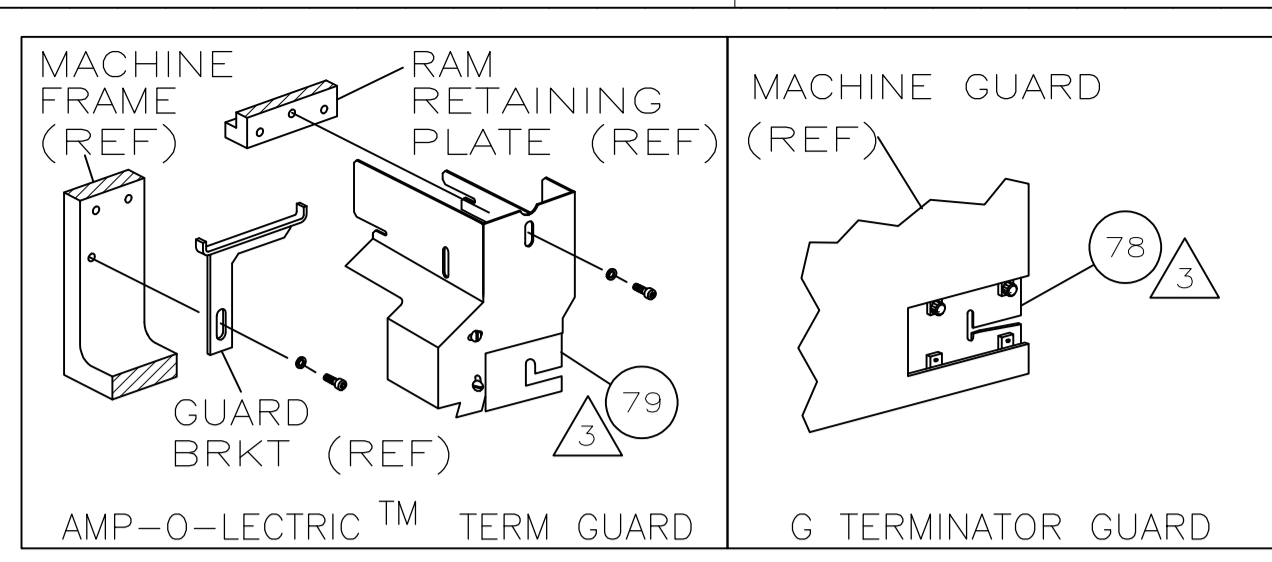

TERMINAL NAME: VERTICAL BULKHEAD CABLE RECP		AMP TERMINAL AMP CRIMP SPECS	
1761386-3		PAD LTR	CRIMP HEIGHT WIRE SIZE
		A	.092 ±.002 [2.34 ±0.05mm] 12
		B	.084 ±.002 [2.13 ±0.05mm] 14
		C	NOT USED
		D	NOT USED
		CRIMP	SIZE TYPE RANGE
		WIRE	.136 [3.45mm] F 12-14
		INSUL	.170 [4.32mm] 0 .120-.156
WIRE STRIP LENGTH	TERM APPL SPEC	FEED	APPL INSTRUCTION SET UP GAGE LAYOUT
.235-.265	NONE	.900	408-8040 458637-1 L2862

QTY	REQD	PER	ASSY	PART NO	DESCRIPTION	ITEM NO
1	1	1	-	4-21028-0	PIN,SLT SPR(Ø.093x.75)ST GDE PL	121
1	1	1	-	4-21028-0	PIN,SLT SPR(Ø.093x.75)ST GDE PL	120
1	1	1	-	4-21028-0	PIN,SLT SPR(Ø.093x.75)ST GDE PL	119
1	1	1	-	4-21028-0	PIN,SLT SPR(Ø.093x.75)ST GDE PL	118
3	3	3	-	21024-5	WASHER, LOCK(#10)ADJ BLOCK	117
2	2	2	-	21024-2	WASHER,LOCK(#4)FRONT STP GUIDE	114
1	1	1	-	21024-4	WASHER,LOCK(#8)STRIPPER	111
1	1	1	-	21024-4	WASHER,LOCK(#8)STRIPPER	110
1	1	1	-	21024-4	WASHER,LOCK(#8)STRIPPER	109
1	1	1	-	21024-4	WASHER,LOCK(#8)STRIPPER	108
1	1	1	-	21024-4	WASHER,LOCK(#8)STRIPPER	107
1	1	1	-	21024-4	WASHER,LOCK(#8)STRIPPER	106
1	1	1	-	22353-8	SCR,SHLD(Ø.187x.25)DRAG LEVER	105
1	1	1	-	21009-2	SCR,SKT SET(1/4-20x.25 LW)RAM	103
2	2	2	-	21017-2	SCR,DRIVE(#2x.19)ID PLATE	102
1	1	1	-	461264-1	PLATE, IDENTIFICATION	100
2	2	2	-	5-21006-6	SCR,SET(10-32x.75)DRAG	99
1	1	1	-	22733-8	SCR,BHC(8-32x.38 LW)ANVIL	98
4	4	4	-	2-21002-9	SCR,BHC(10-32x.50)CAP	97
3	3	3	-	2-22733-8	SCR,BHC(1/4-20x.62)HSG	96
1	1	1	-	2-21002-7	SCR,BHC(10-32x.50)SG ADJ BLK	95
4	4	4	-	2-21002-2	SCR,BHC(8-32x.50)TERM H DWN	94
2	2	2	-	2-21002-4	SCR,BHC(8-32x.75)R STP GDE	93
1	1	1	-	2-21002-0	SCR,BHC(8-32x.25)FEED FINGER	86
2	2	2	-	1-21000-3	SCR,SHC(4-40x.25)FR ST GUIDE	85
1	1	1	-	2-21000-7	SCR,SHC(8-32x.50)STRIPPER	84
1	1	1	-	3-21000-4	SCR,SHC(10-32x.38)SG ADJ BL	81
1	1	1	-	462992-7	GUARD ASSY	79
REF	-	-	-	679532-1	INSERT, GUARD	78
1	1	1	-	690603-1	SPRING, ASSIST	74
1	1	1	-	23030-1	SCR,SHC(6-32x.25 SL)INS DISC	73
1	1	1	-	3-21001-4	SCR,SHC(3/8x.88)FEED MT	72
1	1	1	-	459610-3	MOUNT, FEED BRACKET	71
-3	-2	-1	U/M	PART NO	DESCRIPTION	ITEM NO
QTY	REQD	PER	ASSY	PARTS LIST		

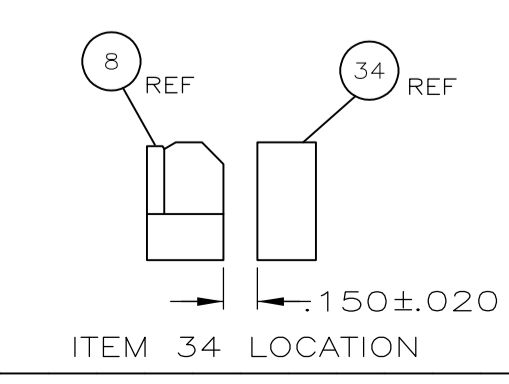

LOC	DIST	REVISIONS			
A	66	REV	DESCRIPTION	DATE	BY
C		ECR-08-023780		9-2008	MY GB

QTY	REQD	PER	ASSY	PART NO	DESCRIPTION	ITEM NO
1	1	1	-	21024-8	WASHER,LOCK(3/8)FEED BRKT	70
1	1	1	-	692655-5	AIR FEED VALVE ASSY	69
1	1	1	-	461690-1	SPACER, AIR FEED	68
1	1	1	-	24042-2	VALVE, SHUT OFF	67
1	1	1	-	692655-6	AIR FEED VALVE ASSY	66
1	1	1	-	461065-2	AIR FEED ASSY (2 INCH)	65
2	2	2	-	4-21000-3	SCR,SHC(10-32x2.00)AIR ASSY	64
1	1	1	-	692655-7	AIR FEED VALVE ASSY	61
1	1	1	-	454220-1	CAP, RAM	59
1	1	1	-	454485-1	HOUSING	58
1	1	1	-	4-694433-6	PAWL, FEED	56
1	1	1	-	461062-1	FEED FINGER ASSY	53
1	1	1	-	690191-1	PLUG, NYLON	45
1	1	1	-	1-819307-0	RAM	44
1	1	1	-	690125-1	WASHER, LAMINATED	43
1	1	1	-	690124-6	WASHER, RAM	42
1	1	1	-	7-21002-9	BOLT, CRIMPER(5/16x1.00)	41
1	1	1	-	23241-6	BALL, STEEL	40
1	1	1	-	690170-1	SPRING, COMPRESSION	39
1	1	1	-	1-690142-1	DISC, INSULATION	38
1	1	1	-	354777-1	WIRE DISC, PLASTIC	37
1	1	1	-	22480-5	WASHER, SPRING	36
1	1	1	-	690212-1	POST, RAM	35
1	1	1	-	690786-3	SUPPORT, TERMINAL	34
1	1	1	-	455675-1	PLATE, BASE	33
1	1	1	-	690432-3	SCREW, ADJUSTMENT	32
1	1	1	-	455689-1	BLOCK, STRIP GUIDE ADJ	30
1	1	1	-	458144-1	PLATE, STRIP GUIDE	29
1	1	1	-	1-455888-6	SPACER, FRONT SHEAR DEP	28
2	2	2	-	1-22284-0	SPRING, DRAG	27
1	1	1	-	356835-1	LEVER, DRAG RELEASE	26
1	1	1	-	240792-1	DRAG, TERMINAL	25
1	1	1	-	4-90765-5	GUIDE, STRIP (REAR)	24
1	1	1	-	693855-8	GUIDE, STRIP (FRONT)	23
1	1	1	-	1-456468-0	STRIPPER	22
1	1	1	-	3-22280-3	SPRING, SHEAR	12
1	1	1	-	690461-1	STOP, SHEAR	11
1	1	1	-	690459-9	HOLDER, SHEAR (FRONT)	10
1	1	1	-	454276-4	SHEAR, FLOAT (FRONT)	9
1	1	1	-	9-662520-5	ANVIL	8
1	1	1	-	1-455888-6	SPACER, CRIMPER	6
1	1	1	-	2-455889-1	DEPRESSOR, SHEAR (FRONT)	5
1	1	1	-	1-238011-2	SPACER, BLOCK CRIMPER	4
1	1	1	-	4-683454-0	CRIMPER, INSULATION	3
1	1	1	-	455888-6	SPACER, CRIMPER	2
1	1	1	-	4-1490019-2	CRIMPER, WIRE	1
-3	-2	-1	U/M	PART NO	DESCRIPTION	ITEM NO
QTY	REQD	PER	ASSY	PARTS LIST		

THIS DRAWING IS A CONTROLLED DOCUMENT.

DIMENSIONS: INCHES	TOLERANCES UNLESS OTHERWISE SPECIFIED:	0 PLC ± .005	1 PLC ± .002	2 PLC ± .001	3 PLC ± .0005	4 PLC ± .0002	ANGLES ± .01
MATERIAL	FINISH	WEIGHT	SIZE	CAGE CODE	DRAWING NO	RESTRICTED TO	
			A1	00779	1852016		

CUSTOMER DRAWING SCALE SHEET 1 of 1 REV C

# Mouser Electronics

Authorized Distributor

Click to View Pricing, Inventory, Delivery & Lifecycle Information:

[TE Connectivity:](#)

[1852016-1](#)